

Edifier Air2

Edifier Air 2 Open Ear Earbuds User Manual

Model: Air2

INTRODUCTION

Welcome to your Edifier Air 2 Open Ear Earbuds. This manual provides detailed instructions for setup, operation, and maintenance to ensure optimal performance and longevity of your device. Please read this manual thoroughly before using the product.



Image: The Edifier Air 2 Open Ear Earbuds, showcasing their ergonomic design and white finish.

PACKAGE CONTENTS

Please verify that all items are present in your package:

- Edifier Air 2 Earbuds (x2)
- Charging Case (x1)
- USB Charging Cable (x1)
- Quick Start Guide (x1)



Image: An illustration of the Edifier Air 2 package contents, including the earbuds, charging case, and accessories.

SETUP

Initial Charging

Before first use, fully charge the earbuds and the charging case to ensure optimal battery performance.

1. Place both earbuds into the charging case.
2. Connect the USB charging cable to the charging case's port and then to a compatible USB power source.
3. The indicator lights on the charging case will illuminate to show the charging status. Once fully charged, the lights may change or turn off.

Bluetooth Pairing

Follow these steps to pair your Edifier Air 2 earbuds with your device:

1. Ensure the earbuds are in the charging case and the case lid is open. This puts them into pairing mode.
2. On your smartphone, tablet, or other Bluetooth-enabled device, navigate to the Bluetooth settings.
3. Enable Bluetooth and search for available devices.
4. Select "Edifier Air 2" from the list of found devices to initiate the connection.
5. A voice prompt from the earbuds will confirm successful pairing.

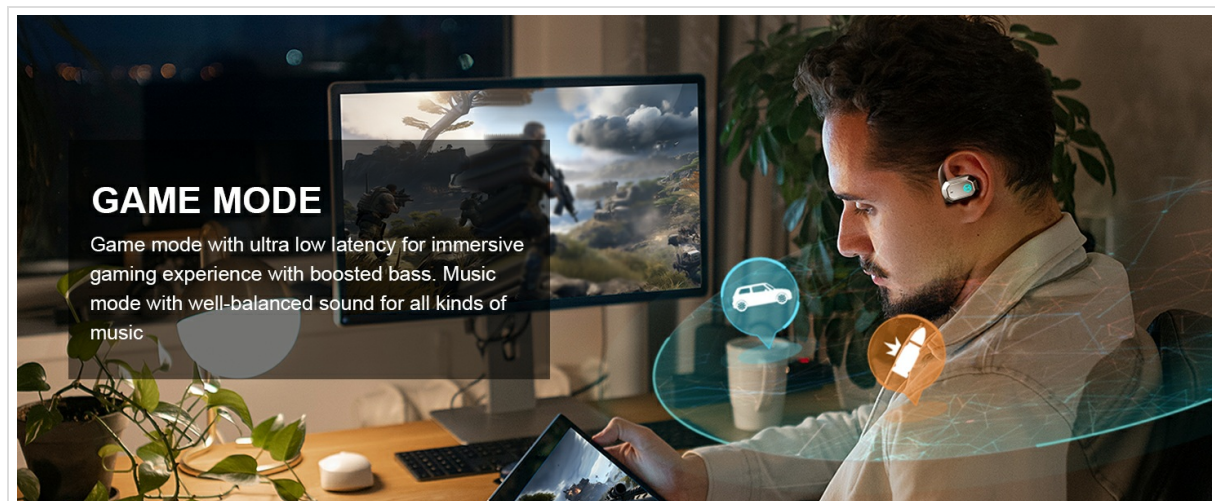

Image: A visual representation of connecting the Edifier Air 2 earbuds via Bluetooth 5.3 to a mobile device.

Wearing the Earbuds

The Edifier Air 2 features an open-ear design with adjustable silicone earhooks for a secure and comfortable fit, allowing you to stay aware of your surroundings.

- 1. Gently place each earbud over your ear, ensuring the silicone earhook wraps comfortably around the back of your ear.
- 2. Adjust the earbud's position so the speaker is aligned with your ear canal without blocking it, allowing for open-ear audio.

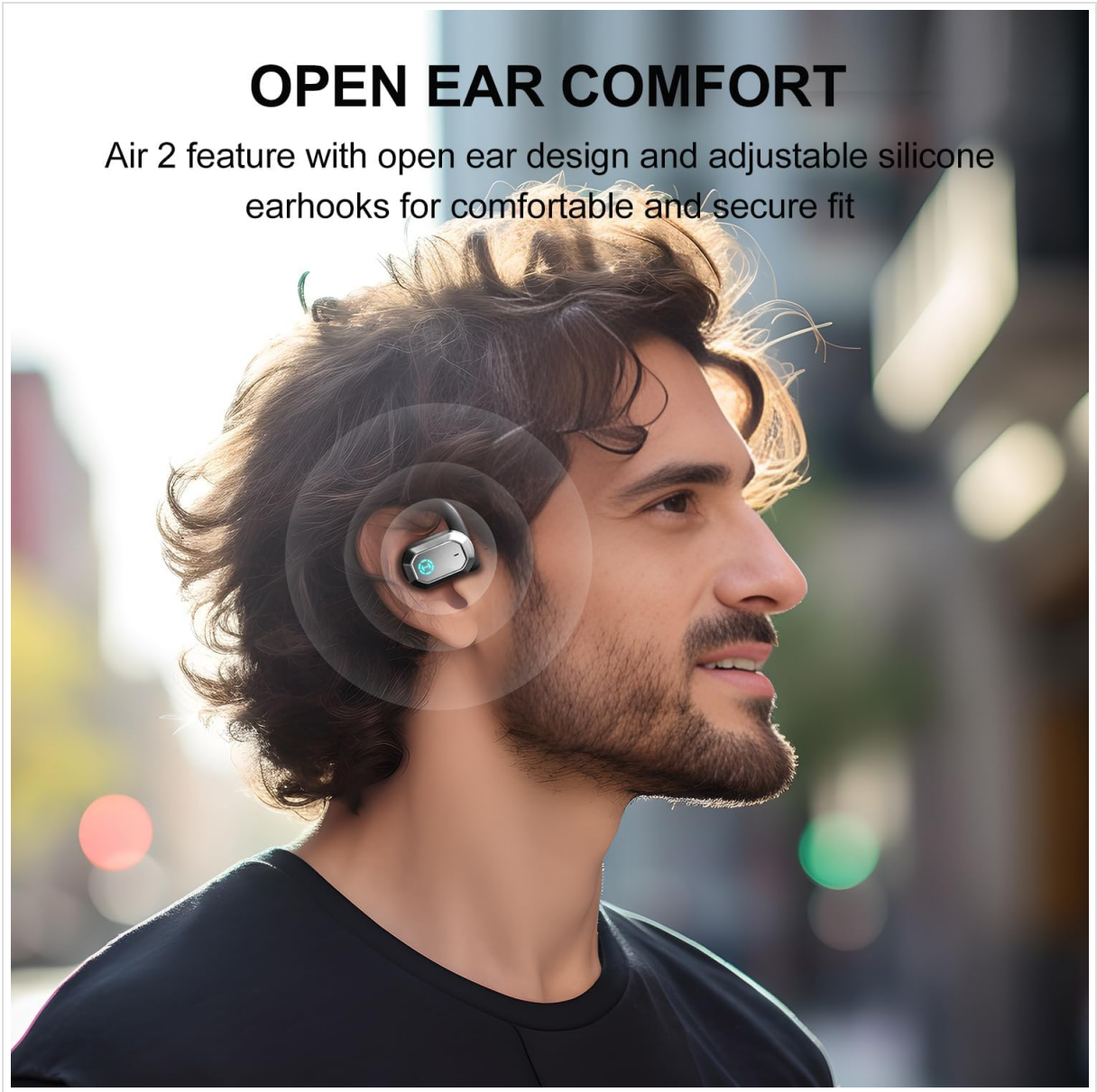

Image: A user demonstrating the comfortable and secure fit of the Edifier Air 2 open-ear earbuds.

Touch Controls

The earbuds feature touch-sensitive controls on their outer surface for easy management of audio playback and calls.

Edifier Air 2 Touch Control Functions

Action	Left Earbud	Right Earbud
--------	-------------	--------------

Action	Left Earbud	Right Earbud
Play/Pause	Double tap	Double tap
Previous Track	Tap and hold 2s	N/A
Next Track	N/A	Tap and hold 2s
Switch Game/Music Mode	Triple tap	Triple tap
Accept/End Call	Double tap	Double tap
Reject Call	Tap and hold 2s	Tap and hold 2s
Light Effects On/Off	Quadruple tap	Quadruple tap

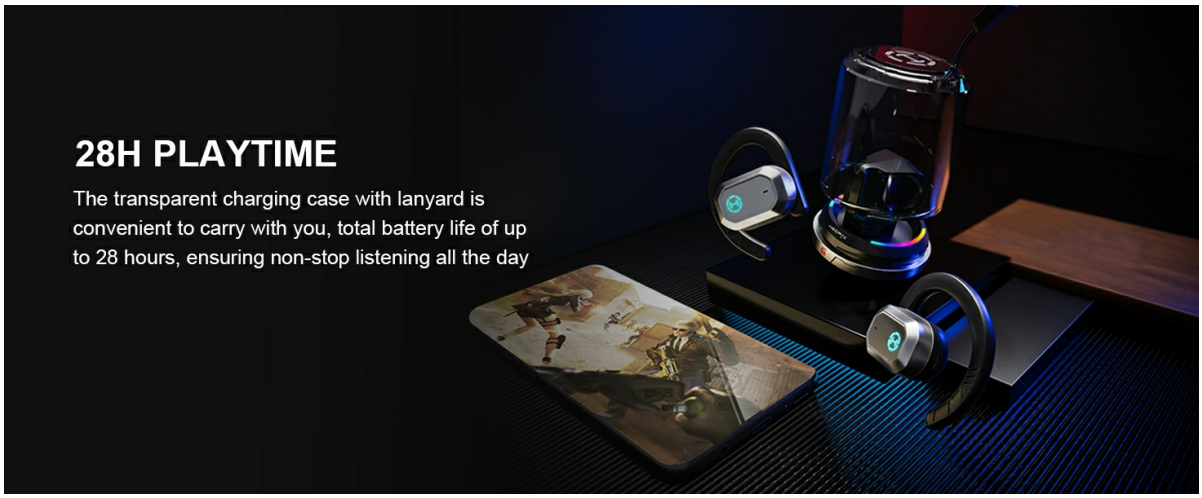

Image: A detailed guide to the touch controls on the Edifier Air 2 earbuds.

Game Mode / Music Mode

The Edifier Air 2 earbuds offer two distinct audio modes:

- **Game Mode:** Provides ultra-low latency for a more immersive gaming experience with boosted bass.
- **Music Mode:** Delivers a well-balanced sound profile suitable for various music genres.

To switch between modes, triple tap either earbud (refer to the Touch Controls table above).

IMMERSIVE GAME MODE

Game mode with ultra low latency and unique RGB light for immersive gaming with boosted bass



Image: A user engaged in gaming, highlighting the benefits of the immersive game mode.

KEY FEATURES

Open Ear Design

The innovative open-ear design ensures that your ear canal remains unblocked, allowing you to hear your audio clearly while also staying aware of your ambient surroundings. This feature is particularly beneficial for outdoor activities such as running, cycling, or commuting, where situational awareness is crucial for safety.

STAY AWARE OF YOUR SURROUNDINGS

Never block your ear, safer for outdoor use

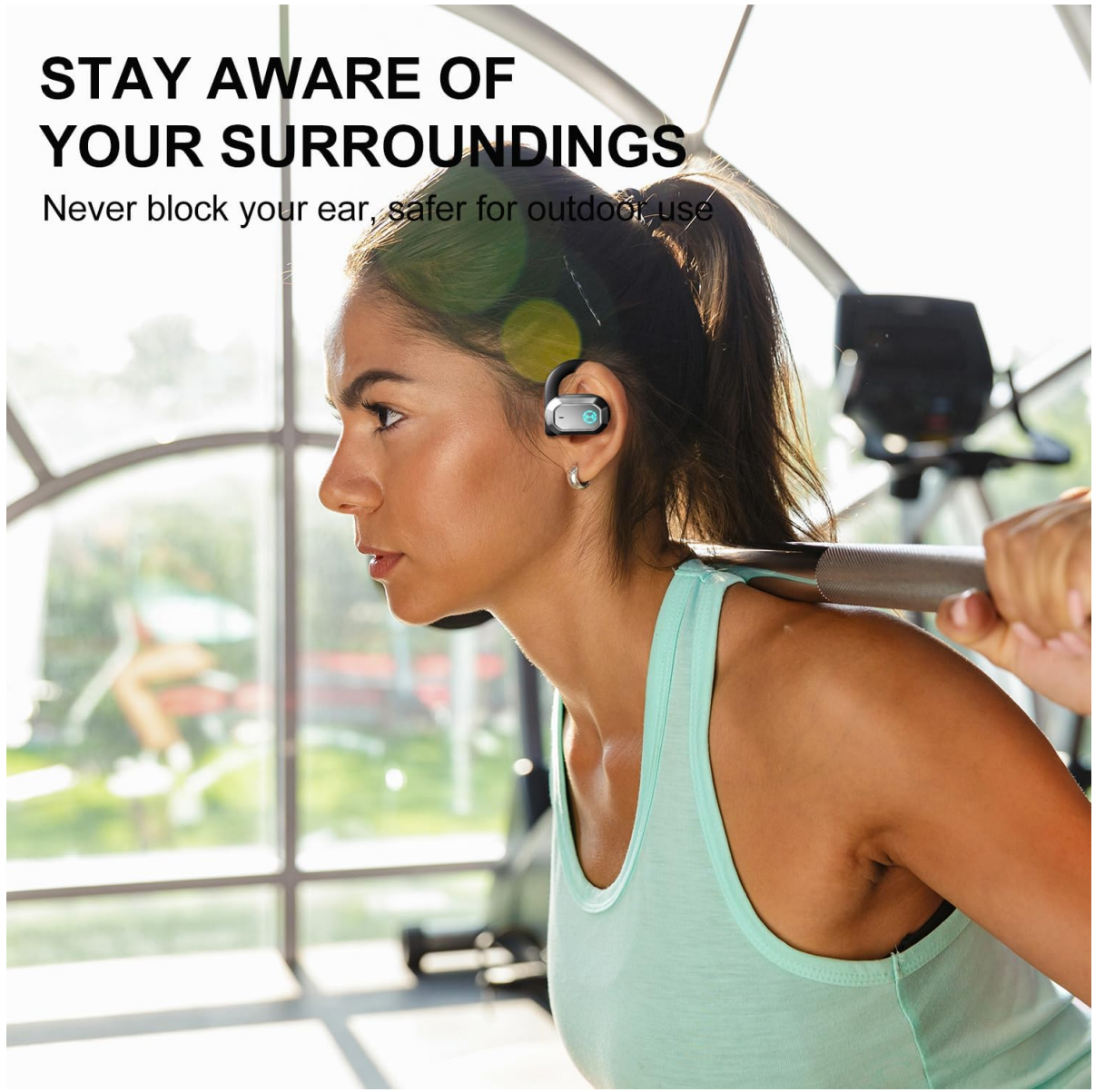

Image: A user enjoying outdoor activity with the Edifier Air 2, emphasizing environmental awareness.

High-Quality Audio

Experience rich and dynamic sound with the Edifier Air 2. It is equipped with 14.2mm dynamic drivers, a DHSB dynamic subwoofer, and a Low-frequency DSP chipset. This combination delivers clear stereo sound with pronounced bass. Advanced directional audio transmission technology minimizes sound leakage, providing a more private listening experience.

HIGH QUALITY AUDIO

Immerse yourself in incredible dynamic audio



14.2 Dynamic Speaker



DSP Chipset



DHSB Dynamic Subwoofer



Less Sound Leakage

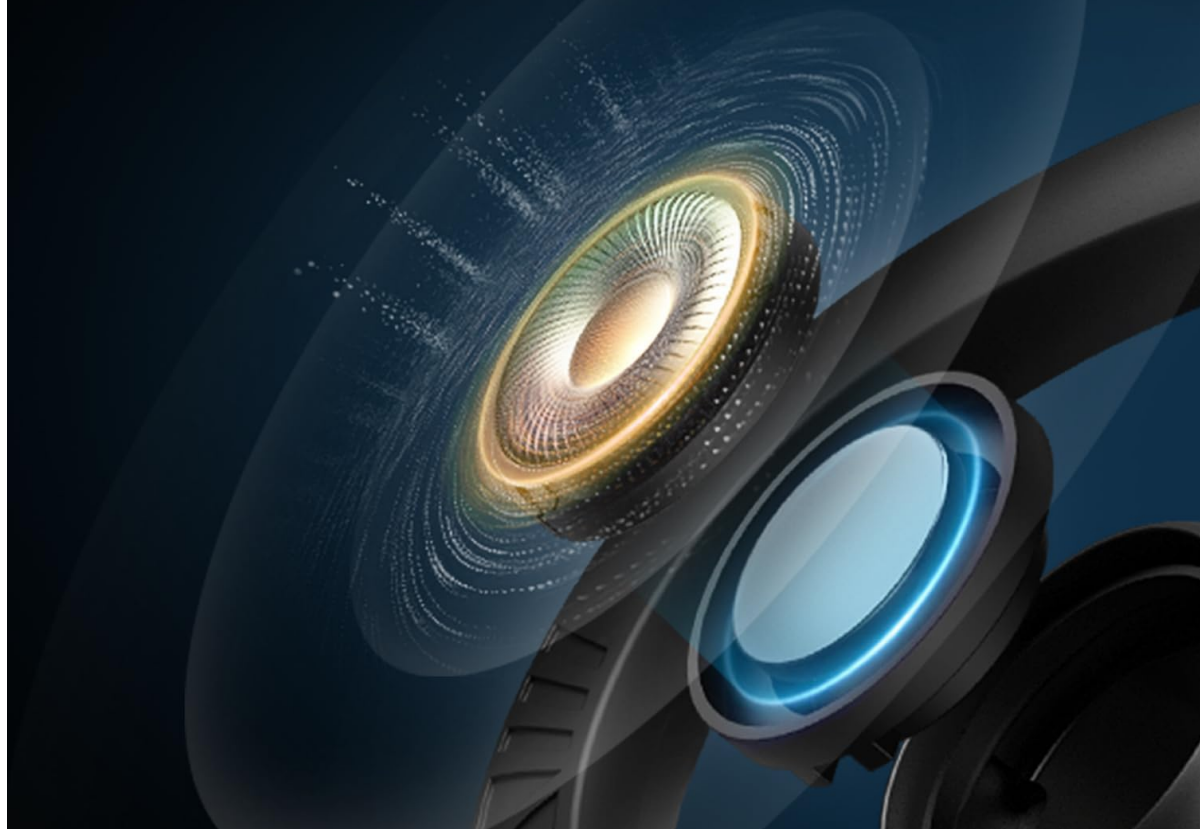

Image: An exploded view diagram showcasing the high-quality audio components of the Edifier Air 2.

Smart Clear Call

The built-in noise-canceling microphones are designed to intelligently separate human voice from ambient background noise. This technology boosts your voice while reducing environmental distractions, ensuring clear and crisp communication during phone calls.

SMART CLEAR CALL

Built-in noise cancelling microphone designed to boost human voice while reducing noise



Image: A scenario depicting clear communication facilitated by the Edifier Air 2's smart clear call technology.

Extended Playtime

Enjoy prolonged listening sessions with the Edifier Air 2. The earbuds, combined with their transparent charging case, provide a total battery life of up to 28 hours, ensuring your music and calls last throughout the day.

DIRECTIONAL AUDIO TRANSMISSION

Directional audio transmission tech ensures no leakage, immersing yourself in private space

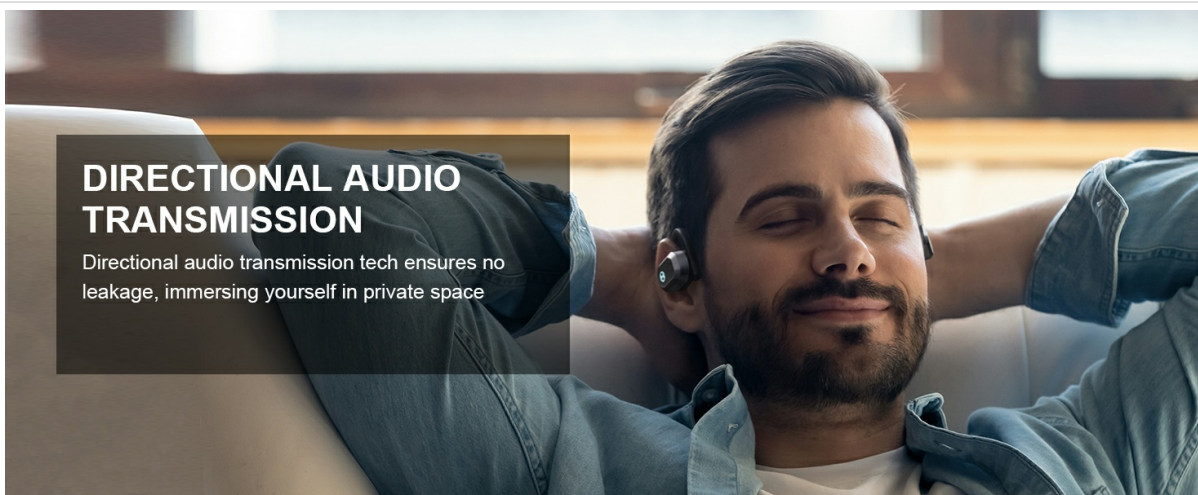

Image: A visual representation of the Edifier Air 2's impressive 28-hour total playtime.

SPECIFICATIONS

Detailed technical specifications for the Edifier Air 2 Open Ear Earbuds:

Feature	Specification
Model Name	Air 2
Connectivity	Bluetooth 5.3
Driver Size	14.2mm Dynamic Driver
Frequency Response	20 Hz - 20,000 Hz
Sensitivity	92 dB
Impedance	24 Ohm
Total Playtime	Up to 28 hours (with charging case)
Charging Case Battery Capacity	500 mAh
Control Type	Touch Control
Microphone	Built-in, Noise Cancelling
Water Resistance Level	Not Water Resistant
Item Weight (Earbuds)	90 Grams
Material	Silicone (earhooks), Plastic (case)

MAINTENANCE

Proper care and maintenance will help extend the life of your Edifier Air 2 earbuds:

- **Cleaning:** Regularly wipe the earbuds and charging case with a soft, dry, lint-free cloth. Avoid using abrasive materials or harsh chemicals.
- **Storage:** When not in use, store the earbuds in their charging case to protect them from dust and damage.
- **Environment:** Avoid exposing the earbuds to extreme temperatures, high humidity, or direct sunlight. Do not immerse the earbuds or charging case in water.
- **Charging:** Use only the provided USB charging cable or a certified equivalent.

TROUBLESHOOTING

If you encounter issues with your Edifier Air 2 earbuds, refer to the following common solutions:

Earbuds not pairing or connecting

- Ensure both earbuds are sufficiently charged.
- Make sure the earbuds are within the Bluetooth range (approximately 33 feet or 10 meters) of your device.

- Turn off and then turn on Bluetooth on your device.
- Try placing the earbuds back into the charging case, closing the lid, waiting a few seconds, and then opening it again to re-enter pairing mode.
- If issues persist, consult the Quick Start Guide for specific earbud reset instructions.

No sound or low volume

- Check the volume level on both your connected device and the earbuds.
- Ensure the earbuds are properly seated in your ears, with the speakers aligned correctly.
- Re-pair the earbuds with your device.
- Test with different audio content or another device to isolate the problem.

Call quality issues

- Ensure the microphone on the earbuds is not obstructed.
- Move to an area with less background noise to improve clarity.
- Check your device's call settings to ensure the Edifier Air 2 is selected as the audio output.

WARRANTY AND SUPPORT

For detailed warranty information, product registration, and technical support, please visit the official Edifier website or contact Edifier customer service directly. It is recommended to retain your proof of purchase for warranty claims.

Edifier Official Website: www.edifier.com

Related Documents - Air2

--	--



Comfo Q
Model: EDP200200
Open-ear True Wireless Earbuds

Manual

EN 1. Power ON/OFF



Open or close the case to power on/off.

2. First pairin



1. Once powered on, the earbuds will automatically enter Bluetooth pairing mode.
2. Select 'EDIFIER Confo Q' from your device list to connect.

3. Pairing for new device



1. Place the earbuds in the case and keep it open.
 2. Press and hold the button on the case for 3s until white and orange LED blink.
- Note: For subsequent use, the earbuds will automatically connect to the device used last time.

4. Multipoint connection



1. Pair device A with the earbuds manually and keep the earbuds in the case.
 2. Re-enter Bluetooth pairing and select "EDIFIER Comfo-Q" in device B settings to connect.
 3. Select "EDIFIER Comfo-Q" again in device A settings to complete the multipoint connection.
- Note: For subsequent use, the earbuds will automatically reconnect to the two devices used last time.

5. Reset/left & right connection



1. Place the earbuds in the case and keep it open.
 2. Press the button on the case 3 times, while LED will blink until the reset is complete.
- Note:** This operation will clear pairing records, reconnect left & right earbuds and restore factory settings.

6. Charging



Input: $V_i = 200\text{mA}$ (External) $V_i = 1\text{A}$ (Charging case)
Note: Make sure the USB port is completely dry before charging.

7. Controls



- | L | R |
|------|---------|
| အပို | ပိုအပို |
| အပို | ပိုအပို |
| အပို | ပိုအပို |
| အပို | ပိုအပို |

Note:
1. "x2" double tap; "x3" triple tap;
2. Download EDIFIER Connect App to customize more control settings.

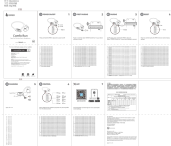

Comprehensive user manual for the Edifier Comfo Q open-ear true wireless earbuds. Learn how to pair, connect to multiple devices, reset, charge, and customize controls.

Comprehensive guide to Edifier Comfo Run Open Ear Wireless Sports Headphones (Model EDF200121). Learn about power, pairing, reset, controls, charging, and app features for your wireless audio experience.



Comfo Run

Open Ear Wireless Sports Headphones

Manual

EN 1. Power ON/OFF



Press and hold the MFB for about 3s to power on/off.

2. First Pairing



Power on and then select "EDIFIER Comfo Run" in your device setting to connect.

3. Pairing For New Device



1. In OFF state, press and hold the MFB for about 5s.
2. Select "EDIFIER Comfo Run" in your device setting to connect.
Note: For subsequent use, the headphones will automatically connect to the device used last time.

4. Reset



Power on and then press the MFB 5 times to reset to factory settings.

5. Charging



Input: 5V --1A.
Note: Please do not charge the headphones when there is music or other signals inside the charging port, which may damage the headphones.

6. Controls



Note: Images are for illustrative purposes only and may differ from the actual product.

For more information, please visit our website

www.edifier.com



Model: EDP200121
Edifier International Limited
2/F, 10th Floor
General Post Office
Hong Kong

www.edifier.com
© 2020 Edifier International Limited. All rights reserved.
Printed in China

NOTICE:
For the need of technical improvement and product upgrade,
Edifier reserves the right to change the product design without notice.
Products of Edifier will be customized for different applications.
Please refer to the product shown on the manual for more details.
We do not accept any responsibility for any damage to the product, the actual
product prevails.

[Edifier Comfo Run Open Ear Wireless Sports Headphones User Manual](#)

User manual for Edifier Comfo Run open-ear wireless sports headphones, covering power, pairing, reset, charging, and controls.



W180T

True Wireless In-Ear Headphones

— Manual —

[Edifier W180T True Wireless In-Ear Headphones User Manual](#)

This manual provides instructions for the Edifier W180T True Wireless In-Ear Headphones, covering power on/off, pairing, resetting, charging, and controls.

X3 Lite

True Wireless In-Ear Headphones

— Manual —



01. Power ON/OFF



- Press the power button on the earbud to turn it on.
- Press the power button on the earbud to turn it off.

Note: The earbuds will automatically turn on when the charging case is opened.

02. Pairing



- Press the pairing button on the earbud to enter pairing mode.
- Press the pairing button on the earbud to exit pairing mode.

Note: The earbuds will automatically connect to the last paired device when the case is opened.

03. Reset



- Press the reset button on the earbud to reset the earbuds.
- Press the reset button on the earbud to reset the earbuds.

Note: The earbuds will automatically connect to the last paired device when the case is opened.

04. Left/Right connection



- Press the left/right connection button on the earbud to connect to the left/right earbud.
- Press the left/right connection button on the earbud to connect to the left/right earbud.

Note: The earbuds will automatically connect to the last paired device when the case is opened.

05. Charging

- Place the earbuds in the charging case.
- Press the charging button on the case to charge the earbuds.

Note: The earbuds will automatically charge when the case is closed.

06. Controls

- Press the touch pad on the earbud to control the earbuds.
- Press the touch pad on the earbud to control the earbuds.

Note: The earbuds will automatically connect to the last paired device when the case is opened.

07. For more information, please visit our website

www.edifier.com

Edifier International Limited

Edifier International Limited

Edifier International Limited

Edifier International Limited

Edifier International Limited

Edifier International Limited

Edifier International Limited

Edifier International Limited

Edifier International Limited

Edifier International Limited

Edifier International Limited

Edifier International Limited

Edifier International Limited

Edifier International Limited

Edifier International Limited

Edifier International Limited

Edifier International Limited

Edifier International Limited

Edifier International Limited

Edifier International Limited

Edifier International Limited

Edifier International Limited

Edifier International Limited

Edifier International Limited

Edifier International Limited

Edifier International Limited

Edifier International Limited

Edifier International Limited

Edifier International Limited

Edifier International Limited

Edifier International Limited

Edifier International Limited

Edifier International Limited

Edifier International Limited

Edifier International Limited

Edifier International Limited

Edifier International Limited

Edifier International Limited

Edifier International Limited

Edifier International Limited

Edifier International Limited

Edifier International Limited

Edifier International Limited

Edifier International Limited

Edifier International Limited

Edifier International Limited

Edifier International Limited

Edifier International Limited

Edifier International Limited

Edifier International Limited

Edifier International Limited

Edifier X3 Lite True Wireless In-Ear Headphones Manual

User manual for the Edifier X3 Lite True Wireless In-Ear Headphones, covering power on/off, pairing, reset, left and right earbud connection, charging, and controls.

X3 Lite

True Wireless In-Ear Headphones

— Manual —



01 1. Power ON/OFF



- Press the power button on the earbud.
- Press the power button on the earbud.

Note: If the earbud is not powered on, the LED indicator will flash red for 10 seconds.

02 2. Pairing



- Press the power button on the earbud.
- Press the power button on the earbud.

Note: The earbuds will automatically connect to the device when in pairing mode.

03 3. Reset



- Press the power button on the earbud.
- Press the power button on the earbud.

04 4. Left & Right connection



- Press the power button on the earbud.
- Press the power button on the earbud.

05 5. Charging

- Press the power button on the earbud.
- Press the power button on the earbud.

Charging Case: Press the power button on the charging case.

Note: The earbuds will automatically connect to the device when in pairing mode.

06 6. Controls

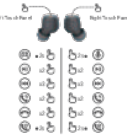

- Press the power button on the earbud.
- Press the power button on the earbud.

For more information, please visit our website.

www.edifier.com



Edifier (Edifier) Co., Ltd.
Edifier International Limited
Edifier International Limited
Edifier International Limited

Edifier (Edifier) Co., Ltd.
Edifier International Limited
Edifier International Limited
Edifier International Limited

Edifier (Edifier) Co., Ltd.
Edifier International Limited
Edifier International Limited
Edifier International Limited

Edifier X3 Lite True Wireless In-Ear Headphones User Manual

This manual provides instructions for the Edifier X3 Lite True Wireless In-Ear Headphones, covering power on/off, pairing, resetting, left and right earbud connection, charging, and controls.

ASUS ASUS NUC 15 Pro and Pro+ NUC15CRK, NUC15CRH and NUC15CRS		
7. Storage		
7.1 PCIe/NVMe Devices		
Type	Model	Description
TRANSCEND	TS512SATF410S	256G ST20GB PCIe Gen 4x4
	TS128NTE120S	256G TTB PCIe Gen 4x4
	MTE7128-512GB	256G ST20GB PCIe Gen 4x4
	MTE7128-1TB	256G TTB PCIe Gen 4x4
SEAGATE	MTE7128-2TB	256G STB PCIe Gen 4x4
	ST-20000AA004	256G STB PCIe Gen 4x4
HYNIX	HP58152GE-8X10T/N/S1000A20	256G ST20GB PCIe Gen 4x4
	HP58152T-16X10T/N/S1000A20	256G TTB PCIe Gen 4x4
	MZ-V6E1T10W	256G TTB PCIe Gen 4x4
	MZVL3212H4D-200BT7	256G TTB PCIe Gen 4x4
SAMSUNG	MZVL3212H4D-200BT7	256G TTB PCIe Gen 4x4
	MZ-V6E1T10W	256G TTB PCIe Gen 4x4
	MZ-V6PCT10W	256G STB PCIe Gen 4x4
	MZ-V6PCT10W	256G TTB PCIe Gen 4x4
T.FORCE	256G	256G STB PCIe Gen 4x4
	CT1000PT10080Q3	256G TTB PCIe Gen 4x4
	CT1000PT10080Q3	256G TTB PCIe Gen 4x4
	CT1000PT10080Q3	256G TTB PCIe Gen 4x4
M.2 SSD	CT1000PT10080Q3	256G TTB PCIe Gen 4x4
	CT1000PT10080Q3	256G TTB PCIe Gen 4x4
	CT1000PT10080Q3	256G TTB PCIe Gen 4x4
	CT1000PT10080Q3	256G TTB PCIe Gen 4x4
MSI	CT1000PT10080Q3	256G TTB PCIe Gen 4x4
	CT1000PT10080Q3	256G TTB PCIe Gen 4x4
	CT1000PT10080Q3	256G TTB PCIe Gen 4x4
	CT1000PT10080Q3	256G TTB PCIe Gen 4x4
MINOSHION	SP4-18.8M-MCT-1TB	256G TTB PCIe Gen 4x4
	SP4-3000S-512G	256G ST0GB PCIe Gen 4x4
	SP4-3000S-512G	256G ST0GB PCIe Gen 4x4
	SP4-3000S-512G	256G ST0GB PCIe Gen 4x4
HIS	FX 100	256G TTB PCIe Gen 4x4
	FX 100	256G TTB PCIe Gen 4x4
	FX 100	256G TTB PCIe Gen 4x4
	FX 100	256G TTB PCIe Gen 4x4
FANXUAN	5000Pp	256G TTB PCIe Gen 4x4
	5000Pp	256G TTB PCIe Gen 4x4
	5000Pp	256G TTB PCIe Gen 4x4
	5000Pp	256G TTB PCIe Gen 4x4
ADATA	AL69-800-1TB	256G TTB PCIe Gen 4x4
	AL69-800-1TB	256G TTB PCIe Gen 4x4
	AL69-800-1TB	256G TTB PCIe Gen 4x4
	AL69-800-1TB	256G TTB PCIe Gen 4x4
TEAMGROUP	256G	256G TTB PCIe Gen 4x4
	256G	256G TTB PCIe Gen 4x4
	256G	256G TTB PCIe Gen 4x4
	256G	256G TTB PCIe Gen 4x4
ZHEHAI	Epica 7100	256G TTB PCIe Gen 4x4
	Epica 7100	256G TTB PCIe Gen 4x4
	Epica 7100	256G TTB PCIe Gen 4x4
	Epica 7100	256G TTB PCIe Gen 4x4
LIGAR	LAM730000T1-RN20G	256G TTB PCIe Gen 4x4
	LAM730000T1-RN20G	256G TTB PCIe Gen 4x4
	LAM730000T1-RN20G	256G TTB PCIe Gen 4x4
	LAM730000T1-RN20G	256G TTB PCIe Gen 4x4
2.1 USB Storage		
2.1.1 Card Readers		
Type	Model	
USB 3.0	Kingston	FCRH54
	SanDisk	SDCR-408-CMS
	LEIAN	LEIAN-SUBUNA
	SONY	MRW-S1
USB 3.1	Transcend	TS-RCFR2
	Transcend	TS-RCFR2
NUC15CR		
PAGE 1		

ASUS NUC 15 Pro & Pro+ Compatibility Report

A comprehensive Qualified Vendor List (QVL) for ASUS NUC 15 Pro and Pro+ models (NUC15CRK, NUC15CRH, NUC15CRS), detailing compatible storage, memory, and peripheral devices.

lang:nl score:12 filesize: 252.93 K page_count: 10 document date: 2025-03-17



[pdf]

AIR 2 12 22 Air2 EDIFIER 2024010314581617042650966465 cn oss edifier Uploads images 2024

01 03 |||

...

lang:nl score:11 filesize: 3.97 M page_count: 1 document date: 2023-12-22

