

Juno 6-Pack 6-inch and 4-inch Wafer LED Downlights

Juno 6-Pack 6-inch and 4-inch Wafer LED Downlights User Manual

Model: 6-Pack 6-inch and 4-inch Wafer LED Downlights

Brand: Juno

1. INTRODUCTION

This manual provides essential information for the safe and efficient installation, operation, and maintenance of your Juno 6-Pack 6-inch and 4-inch Wafer LED Downlights. These energy-efficient LED downlights feature Switchable White technology, allowing adjustment of color temperature, and a slim design for versatile installation.

2. SAFETY INFORMATION

Please read all instructions carefully before installation and retain this manual for future reference. Failure to follow these instructions may result in electric shock, fire, or other hazards.

- Always turn off power at the circuit breaker before beginning installation or performing any maintenance.
- Consult a qualified electrician if you are unsure about the installation process.
- Ensure all electrical connections comply with local codes and ordinances.
- Do not modify the fixture or its components.
- These fixtures are rated for wet locations, making them suitable for various indoor and outdoor applications.
- Do not install near heat sources or in areas with excessive moisture beyond wet location rating.

3. PACKAGE CONTENTS

Verify that all components are present before beginning installation:

- 6x Juno 6-inch Wafer LED Downlights with integrated drivers
- 1x Juno 4-inch Wafer LED Downlight with integrated driver (sold separately, included in this bundle)

- Installation hardware (e.g., junction box, connectors)

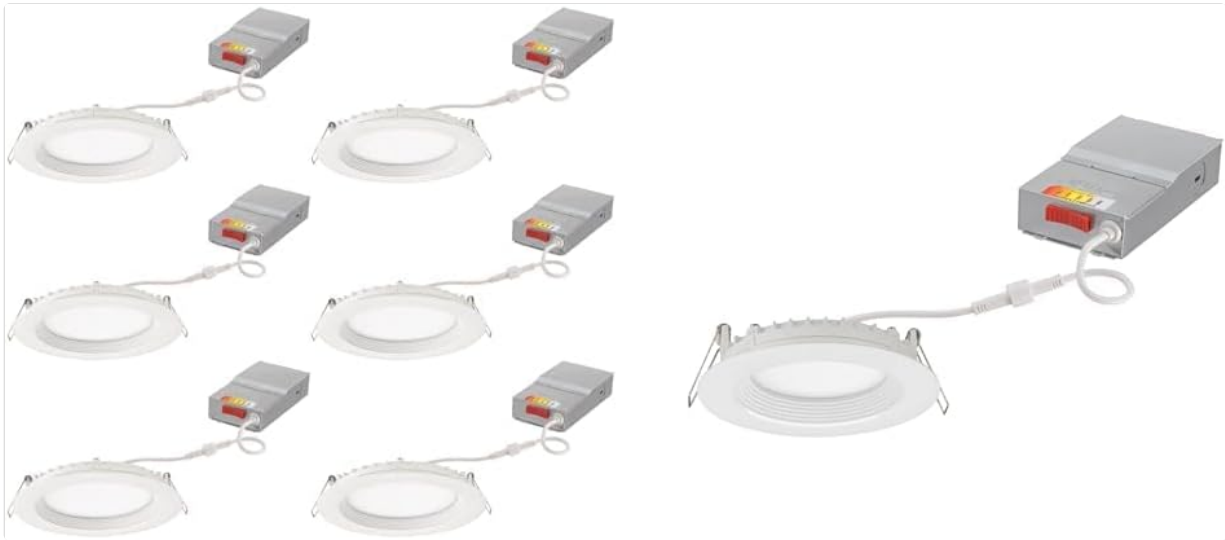

Image: Overview of the Juno 6-pack 6-inch and single 4-inch wafer LED downlights, showing the light fixtures and their associated driver boxes.

4. SPECIFICATIONS

Feature	Specification
Brand	Juno
Model	6-Pack 6-inch and 4-inch Wafer LED Downlights
Light Source	Integrated LED
Color Temperature	Switchable White (3000K, 3500K, 4000K, 5000K)
Color Rendering Index (CRI)	90+
Dimming Capability	Dimmable down to 10% brightness
Lifespan	50,000 hours
Installation Type	Flush Mount, Housing-free
Fixture Height	Slim 2-inch (6-inch models), 1.7-inch (4-inch models)
Usage Environment	Indoor/Outdoor (Wet Location Rated)
Material	Copper (Shade and general material)
Finish	Matte White

5. SETUP AND INSTALLATION

These wafer LED downlights are designed for easy installation in new construction or remodeling projects, eliminating the need for traditional recessed housings. They are suitable for ceilings as shallow as 1.7 inches (4-inch models) or 2 inches (6-inch models).

Installation Steps:

1. **Turn off Power:** Locate the circuit breaker controlling the installation area and turn off the power.
2. **Prepare Opening:** Cut a circular hole in the ceiling according to the specified diameter for your 6-inch or 4-inch fixture. Refer to the template provided with the product packaging for precise sizing.
3. **Connect Wiring:** Open the junction box cover on the integrated LED driver. Connect the household electrical wires (live, neutral, ground) to the corresponding wires inside the junction box using appropriate wire connectors. Ensure all connections are secure.
4. **Secure Junction Box:** Place the junction box into the ceiling opening.
5. **Install Fixture:** Connect the LED downlight fixture to the driver box via the quick-connect cable. Push the spring clips on the sides of the downlight upwards and insert the fixture into the ceiling opening. The clips will spring back down to hold the fixture securely in place.
6. **Restore Power:** Turn the power back on at the circuit breaker.



Image: A close-up view of a single Juno wafer LED downlight connected to its external driver box, illustrating the compact design.

Wafer LED Regressed Downlight



Easy Installation



Affordable Lighting
Solutions



5-Year Limited
Warranty



Ideal for use in a breadth
of indoor and outdoor residential,
hospitality, light commercial and
multi-family applications

Image: Graphic highlighting features of the Wafer LED Regressed Downlight, including easy installation, affordability, and a 5-year limited warranty.

6. OPERATING INSTRUCTIONS

Switchable White Feature:

Your Juno Wafer LED Downlights are equipped with Switchable White technology, allowing you to select from multiple color temperatures to suit your preference or application. The color temperature switch is located on the integrated driver box.

- Before installing the fixture into the ceiling, locate the small switch on the side of the driver box.
- Slide the switch to select your desired color temperature: 3000K (Warm White), 3500K (Neutral White), 4000K (Cool White), or 5000K (Daylight).
- Once the desired setting is chosen, proceed with the installation. The color temperature cannot be changed without accessing the driver box.



Switchable Color Temperatures

2700K Soft White
3000K Warm White
3500K Neutral White
4000K Cool White
5000K Daylight

Image: A close-up of the driver box with a red switch indicating the selectable color temperatures: 2700K, 3000K, 3500K, 4000K, and 5000K.

Dimming Functionality:

These downlights are dimmable down to 10% brightness. To utilize the dimming feature, ensure you connect the fixtures to a compatible LED dimmer switch (sold separately). Refer to the dimmer manufacturer's instructions for proper installation and operation.

7. MAINTENANCE

Juno Wafer LED Downlights are designed for long-term, maintenance-free operation with an extended 50,000-hour service life.

- **Cleaning:** To clean the fixture, ensure the power is off. Use a soft, dry, or slightly damp cloth. Do not use abrasive cleaners or solvents, as they may damage the finish or electrical components.
- **LED Lifespan:** The integrated LEDs are not user-replaceable. The fixture is designed to provide consistent illumination for its rated lifespan.

8. TROUBLESHOOTING

If you encounter issues with your Juno Wafer LED Downlights, refer to the following common troubleshooting steps:

- **Light Does Not Turn On:**

- Check the circuit breaker to ensure power is on.
- Verify all wire connections are secure and correctly wired.
- Ensure the light switch is in the 'ON' position.

- **Light Flickers or Dims Incorrectly:**

- Ensure you are using an LED-compatible dimmer switch.
- Check for loose wiring connections at the fixture or dimmer switch.
- The dimmer may not be compatible with the fixture; consult the dimmer's specifications.

- **Incorrect Color Temperature:**

- The color temperature switch on the driver box must be set before installation. If you need to change it, power off the fixture, carefully remove it from the ceiling to access the driver box, adjust the switch, and reinstall.

If these steps do not resolve the issue, contact customer support.

9. WARRANTY AND SUPPORT

Limited Warranty:

Juno Wafer LED Downlights come with a **5-Year Limited Warranty**. This warranty covers defects in materials and workmanship under normal use. Please retain your proof of purchase for warranty claims.

Customer Support:

For technical assistance, warranty inquiries, or replacement parts, please contact Juno customer support through their official website or the retailer where the product was purchased. Provide your product model number and date of purchase when contacting support.