

LAUNCH X431 Smartlink C 2.0

LAUNCH X431 SmartLink C 2.0 Heavy-Duty Diagnostic Module User Manual

Model: X431 Smartlink C 2.0

1. INTRODUCTION

The LAUNCH X431 SmartLink C 2.0 is a state-of-the-art heavy-duty diagnostic module designed for professional vehicle diagnostics. It serves as an advanced interface for connecting with various commercial vehicles, including trucks, buses, and construction machinery, to perform in-depth system analysis. This module is an upgraded version of the X431 HD3, offering superior performance, broader vehicle coverage, and enhanced diagnostic capabilities.

It is engineered to work seamlessly with LAUNCH X431 V+, X431 PRO5, and X-431 PAD series diagnostic tablets, providing a comprehensive solution for reading and clearing diagnostic trouble codes (DTCs), viewing live data streams, and executing special functions such as component replacement resets and coding.



Image: The LAUNCH X431 SmartLink C 2.0 diagnostic module shown alongside its complete accessory kit, including various cables and adapters, all neatly organized within a durable storage case.

2. SETUP

2.1 Unboxing and Initial Inspection

Upon receiving your LAUNCH X431 SmartLink C 2.0, carefully open the packaging and inspect all components for any signs of damage. Ensure all items listed in the 'What's in the Box' section are present.

2.2 What's in the Box

- X431 SmartLink C 2.0 Diagnostic Module
- Quick Start Guide
- Confidential Letter
- Storage Case
- Various diagnostic cables and adapters (e.g., FUSE, Power Cable Clips, HY 16, M/F 12+16, USB Cable, Jumper 10, Lighter Cable, OBDI Adaptor, Electric switch lines, Network Cable, IV-30, BZ-14, OBD-16, Type II OBD-9, MAN-37, OBD 6, CT-9, IV-38, M-12, VO-8, RE-12, OBDII 16)

FULL SET

 FUSE	 Power Cable Clips	 HY 16	 M/F 12+16	 USB Cable	 Jumper 10
 Lighter Cable	 OBDI Adaptor	 Electric switch line1	 Electric switch line4	 Electric switch line6	 Electric switch line5
 Electric switch line7	 Electric switch line3	 Electric switch line2	 Network Cable	 IV-30	 BZ-14
 Smartlink C	 OBD-16	 Type II OBD-9	 MAN-37	 OBD 6	
	 CT-9	 IV-38	 M-12	 VO-8	
	 RE-12	 OBDII 16	 Instructions	 Password Letter	

Image: A detailed layout of the complete set of components included with the LAUNCH X431 SmartLink C 2.0, showcasing the main module, various diagnostic cables, power adapters, and connectors.

2.3 Connecting the SmartLink C 2.0

The SmartLink C 2.0 module is not a standalone device and requires connection to a compatible LAUNCH diagnostic tablet (X431 V+, PRO5, or PAD series) for operation. Connection can be established via USB, Bluetooth, Wi-Fi, or Ethernet.

- **USB Connection:** Connect the SmartLink C 2.0 to your diagnostic tablet using the provided USB cable.
- **Bluetooth Connection:** Ensure Bluetooth is enabled on both the SmartLink C 2.0 and your diagnostic tablet. Pair the devices through the tablet's settings.
- **Wi-Fi Connection:** Configure the SmartLink C 2.0 to connect to the same Wi-Fi network as your diagnostic tablet.
- **Ethernet Connection:** For stable and high-speed data transfer, connect the SmartLink C 2.0 to your network via an Ethernet cable.

How to Connect with X431 Smartlink C

X431 Pro3S+Smartlink C (As a diagnostic connector for commercial vehicles)

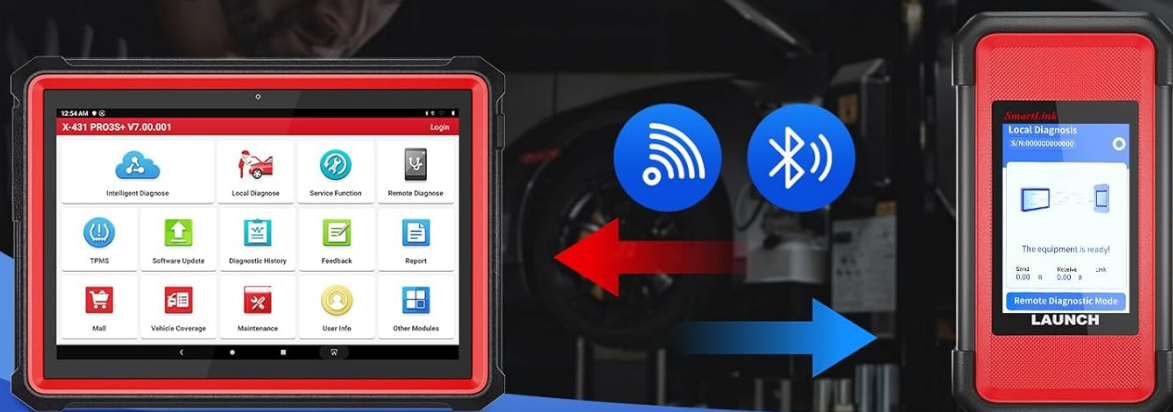

Smartlink C: VCI Module(As a tool for transferring data)



Image: A visual guide illustrating how to connect the X431 SmartLink C 2.0 to a LAUNCH X431 Pro3S+ diagnostic tablet, highlighting the wireless (Wi-Fi and Bluetooth) connection options for data transfer to a commercial vehicle.

3. OPERATING INSTRUCTIONS

3.1 Powering On and Interface Overview

Connect the SmartLink C 2.0 to a power source or the vehicle's OBD port. The 3.97-inch TFT display will illuminate, showing the device status. The module features a diagnostic interface, power interface, USB B interface, and DC interface.

PRODUCT DETAILS



Image: An exploded view of the LAUNCH X431 SmartLink C 2.0, detailing its various interfaces including the diagnostic interface, screen, power interface, USB B interface, and DC interface.

3.2 Diagnostic Functions

Once connected to a compatible LAUNCH tablet and the vehicle, the SmartLink C 2.0 enables a range of diagnostic functions:

- **Code Reading:** Retrieve current, pending, and historic diagnostic trouble codes (DTCs) from various vehicle systems.
- **Code Clearing:** Erase DTCs from the vehicle's ECU after repairs are completed.
- **Data Stream Analysis:** View live data parameters from vehicle sensors and components in real-time, often displayed as graphs or numerical values.
- **Action Tests (Bi-directional Control):** Perform active tests on vehicle components to verify their functionality.
- **Special Functions:** Access specific vehicle functions such as component replacement resets, coding, and adaptations.

SMARTLINK C 2.0

Which is a Heavy Duty Truck Module upgrade from the X431 HDIII



Image: A visual comparison highlighting the upgraded visualization and user interface of the LAUNCH X431 SmartLink C 2.0 compared to its predecessor, the X431 HDIII, indicating an easier diagnostic experience.

3.3 Vehicle Coverage

The SmartLink C 2.0 supports a wide range of heavy-duty vehicles, including but not limited to:

- Trucks (e.g., Hino, FOTIAN, ISUZU Heavy Vehicle, KENWORTH heavy truck, VOLVO heavy truck, Freightliner heavy truck, SCANIA, Mack, Kenworth)
- Buses (e.g., YUTONG BUS, Higer Bus, ZHONGTONG BUS)
- Construction Machinery (e.g., JCB, An Excavator)
- Agricultural Machinery
- Trailers
- Marine Engines

It supports brands such as Mitsubishi, Isuzu, Fuso, Mercedes-Benz Commercial Vehicles, Bosch, Weichai, Shanghai, Yuchai, Xichai, Chaogai, Yangchai, and Quanchai, and over 80 other heavy-duty truck brands.

Support Diagnostic Commercial Vehicles, Please check the compatible for the vehicle brands



Image: A collage demonstrating the diverse range of commercial vehicles supported by the LAUNCH X431 SmartLink C 2.0, including large trucks, buses, construction excavators, and smaller commercial vehicles.

SUPPORT 80+ BRANDS OF HEAVY DUTY TRUCK (STILL GROWING)

Hino	YUTONG BUS	ZF
BONLUCK Bus	FOTIAN	ISUZU Heavy Vehicle
Higer Bus	AUMAN	FUSO
Shanghai Diesel	IRISBUS heavy truck	Xichai
ERF	KENWORTH heavy truck	KNORR ABS
Ashok Leyland	HD_TATA	IVECO Heavy Vehicle
DELPHI	VOITH heavy truck	ASTRA
DAF	Benz heavy truck	Quanchai
DETROIT engine	JAC heavy truck	Dachai Heavy Vehicle
Yangchai engine	CREDO heavy truck	Steyr
King Long bus	Sterling heavy truck	Miller
FAW Jiefang	Doosan engine	Yuchai Special
HD_ABS system	Perkins	BREMACH
WP diesel engine	VOLVO heavy truck	Dongfeng Yufeng
diesel version of Nissan	Freightliner heavy truck	HD_FLEXICOIL
Sinotruk	WANGUO heavy truck	BOSCH
SUNLONG	PETERBILT heavy truck	diesel version Toyota
JCB	DEUTZ	MAN
RENAULT heavy truck	CUMMINS	NEOPLAN heavy-duty truck
IRIZAR heavy truck	SCANIA	SUNWIN
ZHONGTONG BUS	Chaochai	Caterpillar heavy-duty truck
USAFORD diesel version	Xixing Heavy Vehicle	TRAILER heavy-duty truck
AISIN heavy truck	WABCO ABS	More...

Image: A comprehensive list displaying over 80 heavy-duty truck brands that are supported by the LAUNCH X431 SmartLink C 2.0 diagnostic module, indicating its broad compatibility.

3.4 Remote Diagnosis

The SmartLink C 2.0 features advanced remote diagnostic capabilities. This allows expert technicians to connect to your device remotely to assist in resolving complex diagnostic issues, providing real-time support and guidance.

New SmartLink C 2.0 connector, industrial-grade drop-proof design



Image: A conceptual diagram illustrating the cloud and remote diagnosis features of the SmartLink C 2.0, showing data being sent and received between the diagnostic module and a remote server, enabling faster diagnosis.

4. MAINTENANCE

- **Cleaning:** Use a soft, dry cloth to clean the device. Avoid using abrasive cleaners or solvents.
- **Storage:** Store the SmartLink C 2.0 in its provided storage case in a cool, dry place when not in use.
- **Software Updates:** Regularly check for and install software updates to ensure optimal performance and access to the latest vehicle models and diagnostic features. The product includes 2 years of free updates.
- **Cable Inspection:** Periodically inspect all cables and connectors for wear or damage. Replace any damaged components immediately to prevent malfunction.

5. TROUBLESHOOTING

- **Device not powering on:** Ensure the device is properly connected to a power source or the vehicle's OBD port. Check the power cable and vehicle battery.
- **Connection issues (Bluetooth/Wi-Fi):** Verify that Bluetooth/Wi-Fi is enabled on both the SmartLink C 2.0 and the diagnostic tablet. Ensure devices are within range and there is no interference. For Wi-Fi, confirm the network connection is stable.
- **Unable to communicate with vehicle:** Check that the diagnostic cable is securely connected to both the SmartLink C 2.0 and the vehicle's OBD port. Ensure the vehicle's ignition is on. Verify that the correct vehicle make/model is selected on the diagnostic tablet.
- **Software freezing/slow performance:** Ensure the device has sufficient storage space. Perform a software update if available. Restart the device and the diagnostic tablet.
- **Diagnostic results are inconsistent:** Ensure all connections are secure. Verify that the vehicle's battery voltage is stable. Consult the vehicle's service manual for specific diagnostic procedures.

For complex issues not resolved by these steps, utilize the remote diagnosis feature or contact LAUNCH technical support.

6. SPECIFICATIONS

Feature	Specification
Model	X431 Smartlink C 2.0
CPU	Dual Cortex-A7 and Cortex-M7 processors
Operating System	Linux
ROM	8GB
RAM	256MB
Display	3.97-inch TFT, 320x480 resolution
Dimensions	200mm x 110mm x 47mm
Connectivity	USB, Bluetooth, Wi-Fi (2.4/5.0GHz), Ethernet
Power Input	9V DC - 36V DC
Supported Languages	English, German, French, Spanish, Italian, Chinese, Japanese, Russian
Item Weight	12.92 pounds (packaged)
Package Dimensions	16.8 x 14 x 6.65 inches



When used with PRO3S+, it can be used as a product monitor, and can also make PRO3S+ a diagnostic tool for HD

VCI MODULE:
(As a data accessing Vehicle)

Diagnostic cable

Full System Diagnostic Tool For Commercial Car



ECU Brush Writing



Read Code & Clear Code



View Data Stream

Image: An illustration highlighting the multiple transmission modes supported by the SmartLink C 2.0, including USB, Wi-Fi, Bluetooth, and Ethernet, which enhance diagnostic convenience.

7. WARRANTY AND SUPPORT

7.1 Warranty Information

The LAUNCH X431 SmartLink C 2.0 comes with a manufacturer's warranty. Please refer to the 'Confidential Letter' included in your package for specific warranty terms and conditions. Keep your proof of purchase for warranty claims.

7.2 Technical Support



For technical assistance, software updates, or any operational queries, please contact LAUNCH customer support. Leveraging the SmartLink C 2.0's remote diagnostic capabilities, expert technicians can provide online assistance to resolve complex diagnostic issues efficiently.

Visit the official LAUNCH website for support resources, FAQs, and contact information.

© 2025 LAUNCH. All rights reserved.

Related Documents - X431 Smartlink C 2.0

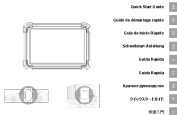
<div><p>FAQs for LAUNCH CRP919X BT</p><p>Q: I connected LAUNCH TECH USA but didn't receive support. A: You can contact us directly via desktop or our Customer Service Team at support@launchusa.com. Please note that our products are designed for LAUNCH TECH (US, LLC), the headquarters of LAUNCH. While LAUNCH TECH USA is a branch in the USA, we are independent and they do not provide after-sales service for products purchased only in the USA. We do not have a local office in the USA.</p><p>Q: My CRP919EBT won't charge or turn on. A: This can be fixed by checking the battery and using the original USB cable for charging. Press the power and volume "+" buttons simultaneously until the screen displays "charging". Select the Recovery mode interface using the volume buttons, confirm with the power button. Choose "help data/factory reset" and then "help cache partition", confirming each step with "Yes". Afterward, power off and then turn the power on the device.</p><p>Q: How do I register the CRP919EBT? A: To register, select "New Registration". Follow the steps to create an account, and activate the ID. Use the password envelope included in the package.</p></div>	<p>LAUNCH CRP919X BT: FAQs, Troubleshooting, and Support</p> <p>Comprehensive FAQs for the LAUNCH CRP919X BT automotive diagnostic tool. Find answers on setup, software updates, language settings, troubleshooting charging issues, and more.</p>
<div><p>FAQS for LAUNCH X431 PRO ELITE</p><p>Before registering and updating the software, please read the following instructions:</p><p>1. Check the registration and update instructions and update the application via the Internet or use the USB to connect to the PC and then use the USB to update the application.</p><p>2. If you can't connect, try from Registration to enter the registration page.</p><p>3. Check the instructions in each step. Don't use "Reset to Default" after updating. Use the USB to update the application.</p><p>4. After the X431 Pro Elite is updated, use the USB to update the application. Use the USB to update the application.</p></div>	<p>LAUNCH X431 PRO ELITE FAQs and User Guide</p> <p>Frequently asked questions and guidance for the LAUNCH X431 PRO ELITE automotive diagnostic tool, covering registration, updates, subscriptions, troubleshooting, and features.</p>
<div><p>FAQS for LAUNCH CRP919EBT</p><p>Q: Connected to LAUNCH TECH USA but didn't get any support. A: Please contact us via desktop or our Customer Service Team at support@launchusa.com. Please note that our products are designed for LAUNCH TECH (US, LLC), the headquarters of LAUNCH. While LAUNCH TECH USA is a branch in the USA, we are independent and they do not provide after-sales service for products purchased only in the USA. We do not have a local office in the USA.</p><p>Q: My CRP919EBT won't charge or turn on. A: This can be fixed by checking the battery and using the original USB cable for charging. Press the power and volume "+" buttons simultaneously until the screen displays "charging". Select the Recovery mode interface using the volume buttons, confirm with the power button. Choose "help data/factory reset" and then "help cache partition", confirming each step with "Yes". Afterward, power off and then turn the power on the device.</p></div>	<p>LAUNCH CRP919EBT FAQs and Troubleshooting Guide</p> <p>Frequently Asked Questions and troubleshooting steps for the LAUNCH CRP919EBT diagnostic scan tool, covering software updates, registration, password reset, and common issues.</p>

	<p>LAUNCH X431 Quick Start Guide</p> <p>This Quick Start Guide provides essential instructions for setting up and using the LAUNCH X431 vehicle diagnostic tool, covering initial charging, language settings, WLAN setup, registration, vehicle connection, and basic diagnostics.</p>
	<p>LAUNCH X431 PRO DYNO User Manual</p> <p>Comprehensive user manual for the LAUNCH X431 PRO DYNO OBD2 diagnostic scan tool, covering features like intelligent diagnosis, local diagnosis, remote diagnosis, service functions, software updates, and toolbox modules. Includes safety precautions and FCC statements.</p>
<p>FAQS FOR LAUNCH CRP919E</p> <p>Q1: How to use the CRP919E?</p> <p>A1: The CRP919E can be used as a standalone unit or connected to a computer.</p> <p>Q2: How to connect the CRP919E to the vehicle?</p> <p>A2: Connect the CRP919E to the vehicle's OBD2 port. The CRP919E can be used as a standalone unit or connected to a computer.</p> <p>Q3: How to use the CRP919E to read and clear DTCs?</p> <p>A3: Select the function to read and clear DTCs. The CRP919E can be used as a standalone unit or connected to a computer.</p> <p>Q4: How to use the CRP919E to perform a full system scan?</p> <p>A4: Select the function to perform a full system scan. The CRP919E can be used as a standalone unit or connected to a computer.</p> <p>Q5: How to use the CRP919E to perform a full system scan?</p> <p>A5: Select the function to perform a full system scan. The CRP919E can be used as a standalone unit or connected to a computer.</p>	<p>LAUNCH CRP919E FAQs: Your Guide to Advanced Automotive Diagnostics</p> <p>Frequently Asked Questions about the LAUNCH CRP919E OBD2 scanner, covering usage, updates, features like bidirectional control, ECU coding, special services, and troubleshooting.</p>