

Manuals+

[Q & A](#) | [Deep Search](#) | [Upload](#)

manuals.plus /

› [Samsung](#) /

› [SAMSUNG ViewFinity S6 \(S60UD\) 24-inch QHD Monitor Instruction Manual](#)

Samsung LS24D606UANXZA

SAMSUNG ViewFinity S6 (S60UD) 24-inch QHD Monitor Instruction Manual

Model: LS24D606UANXZA

1. INTRODUCTION

This manual provides comprehensive instructions for the SAMSUNG ViewFinity S6 (S60UD) 24-inch QHD High Resolution Computer Monitor. It covers essential information regarding product setup, operation, maintenance, and troubleshooting to ensure optimal performance and user experience. Please read this manual thoroughly before using your monitor.



Front view of the SAMSUNG ViewFinity S6 (S60UD) 24-inch QHD Monitor, showcasing its sleek design and vibrant display.



Angled side view of the SAMSUNG ViewFinity S6 monitor, highlighting its slim profile and stable stand.

2. SETUP

2.1 Unpacking and Stand Assembly

Carefully remove all components from the packaging. The Easy Setup Stand is designed for tool-free assembly, allowing for quick and convenient setup.

1. Place the monitor panel face down on a soft, clean surface to prevent scratches.
2. Align the stand neck with the slot on the back of the monitor panel.

- Gently push the stand neck into the slot until it clicks securely into place.
- Attach the base to the stand neck by aligning the tabs and pressing down until it locks.

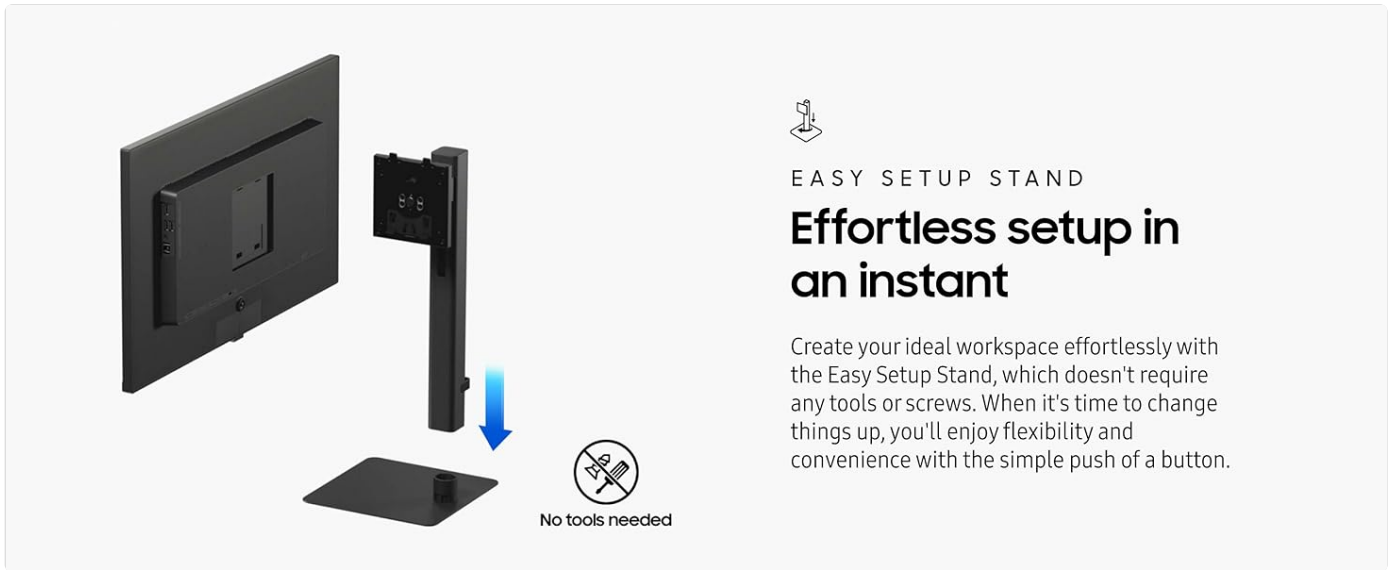
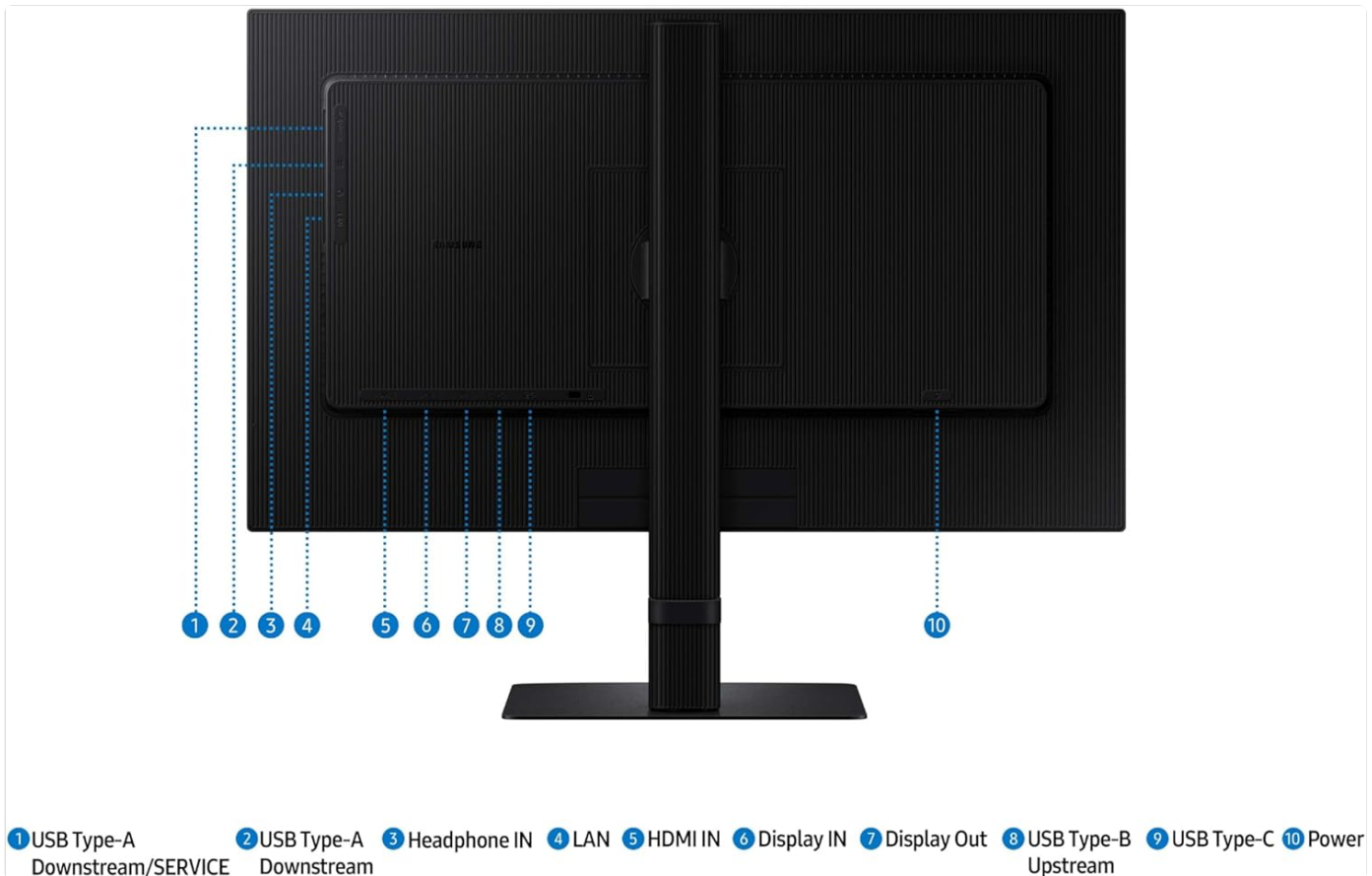

Illustration demonstrating the simple, tool-free assembly process for the monitor stand, showing the stand components separating from the monitor.

2.2 Connecting Cables

Connect the necessary cables to the monitor and your computer or other devices. Ensure all connections are secure.



Rear view of the monitor displaying various input and output ports, including USB Type-A, Headphone, LAN, HDMI, Display In, Display Out, USB Type-B, USB Type-C, and Power.

- Power Cable:** Connect the power cable to the monitor's power input and then to a wall outlet.
- USB-C Cable:** For simultaneous video, data transfer, and 90W charging, connect a USB-C cable from your laptop to

the monitor's USB Type-C port.

- **HDMI/DisplayPort (DP) Cable:** Connect an HDMI or DisplayPort cable from your computer's video output to the corresponding input on the monitor for video signal.
- **LAN Port:** For seamless Ethernet connectivity, connect an Ethernet cable to the monitor's built-in LAN port.
- **USB Type-A Ports:** Use the USB Type-A downstream ports for connecting peripherals like keyboards, mice, or USB drives.
- **Headphone Jack:** Connect headphones or external speakers to the headphone output.

2.3 Daisy Chain Setup

The monitor supports daisy chaining, allowing you to connect a second monitor to expand your workspace without needing additional adapters or docking stations.

1. Connect your primary computer to the first monitor using a USB-C or DisplayPort cable.
2. Connect a DisplayPort cable from the **Display Out** port of the first monitor to the **Display In** port of the second monitor.
3. Ensure both monitors are powered on and configured correctly in your operating system's display settings.

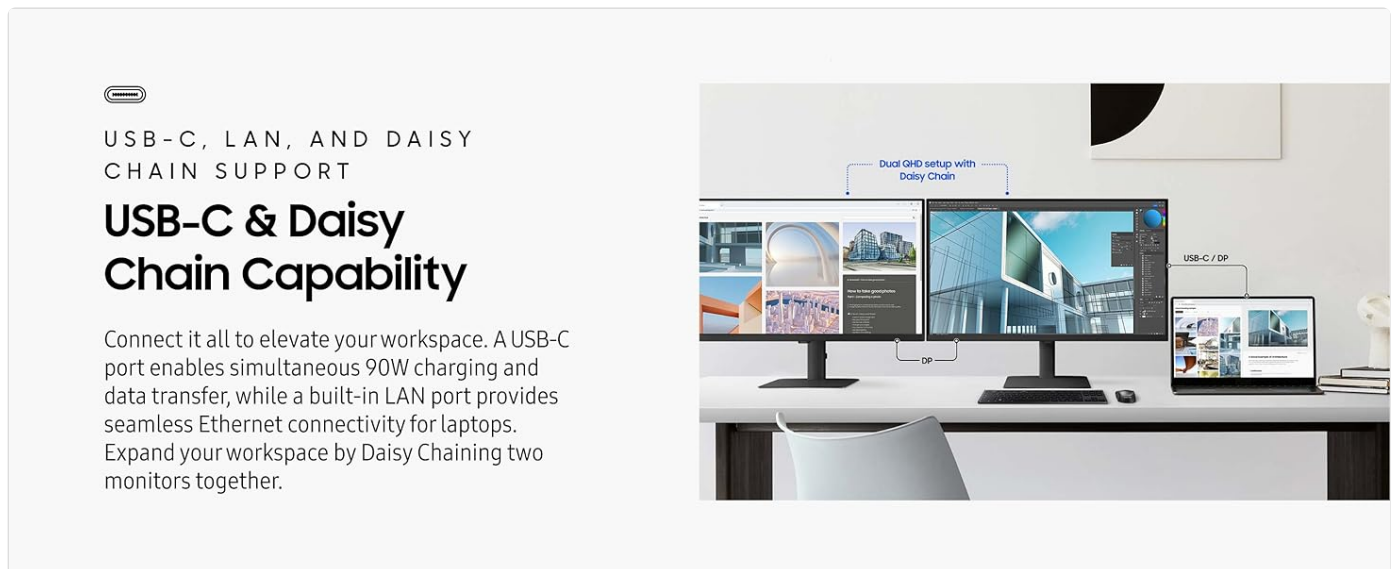

Visual representation of a dual QHD monitor setup, demonstrating how to connect two monitors using the daisy chain feature with USB-C and DisplayPort connections.

3. OPERATING INSTRUCTIONS

3.1 Power On/Off

Press the power button, typically located on the back or bottom of the monitor, to turn the monitor on or off. The power indicator light will illuminate when the monitor is on.

3.2 Input Selection and KVM Switch

The built-in KVM switch allows you to control two monitor sources with a single keyboard and mouse. Use the On-Screen Display (OSD) menu to switch between connected input sources (USB-C, HDMI, DisplayPort).

- Access the OSD menu using the joystick or buttons on the monitor.
- Navigate to the 'Input' or 'Source' section.
- Select the desired input source (e.g., USB-C, HDMI, DP).
- For KVM functionality, ensure your keyboard and mouse are connected to the monitor's USB ports, and switch the input source to control the corresponding computer.

Master Multiple Sources

A built-in KVM switch enables you to connect and control two monitor sources at once with a single keyboard and mouse. With your choice of split screen, Picture-in-Picture, or Picture-by-Picture, you'll be more efficient. Eliminate multi-device hassle with easy input switching and multitasking.

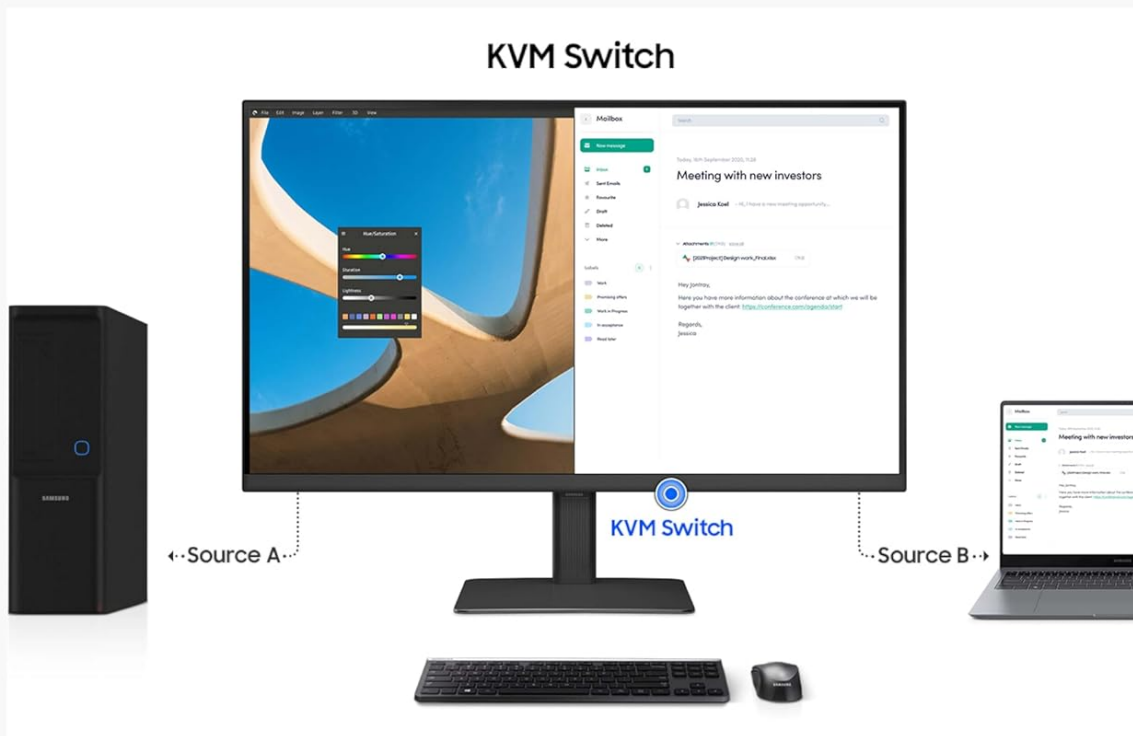
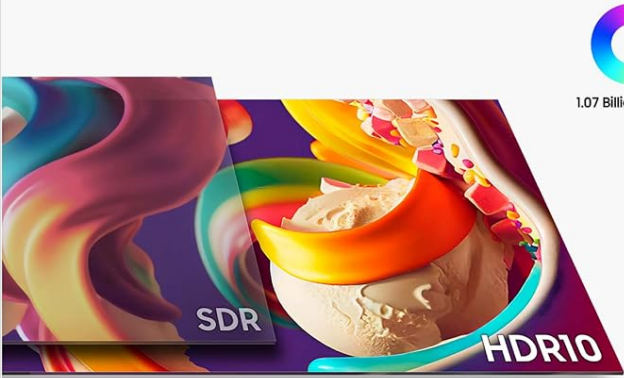

Illustration of the KVM switch in action, allowing a single keyboard and mouse to control both a desktop PC and a laptop connected to the monitor.

3.3 Display Settings

Adjust various display settings through the OSD menu to optimize your viewing experience.

- **Resolution and Refresh Rate:** The monitor supports QHD (2560x1440) resolution and a 100Hz refresh rate. Ensure these settings are enabled in your computer's display settings for optimal clarity and smoothness.
- **HDR10:** This monitor supports HDR10, providing enhanced contrast and a wider color gamut. Enable HDR in your operating system and compatible applications for a more realistic visual experience.
- **Intelligent Eye Care & Eye-Saver Mode:** TÜV-certified features reduce screen flickering and protect against excessive blue light. These settings can be adjusted in the OSD menu to automatically optimize brightness and color temperature based on your environment.



1.07 BILLION COLORS WITH HDR10

Enhanced realism through more color

See a wider gamut of colors for stunning accuracy and detail. HDR10 provides near-limitless hues and true-to-life color representation, with darker darks and brighter brights. Every piece of content becomes a joy to look at and can be experienced exactly as intended.*

* Images simulated for illustrative purposes.

Visual comparison demonstrating the enhanced realism and wider color gamut provided by HDR10 compared to SDR, showcasing 1.07 billion colors.



QHD

QHD RESOLUTION WITH 100HZ REFRESH RATE

Savor smooth visuals and performance

Delivers the crystal-clear visual excellence that is demanded by designers and creators everywhere. QHD (2560x1440) resolution and 100Hz refresh rate work together to reveal hidden details through higher pixel density, while reducing stuttering and tearing. A smoother workflow enables the seamless creation of intricate designs, complex diagrams, and dynamic video content.

* Images simulated for illustrative purposes.

An image illustrating the smooth visuals and performance achieved with QHD (2560x1440) resolution and a 100Hz refresh rate.

3.4 Ergonomic Adjustments

The height-adjustable stand offers versatile positioning for optimal viewing comfort.

- **Height Adjustment:** Gently push or pull the monitor panel up or down to adjust its height.
- **Tilt:** Tilt the monitor panel forward or backward to find your preferred viewing angle.
- **Swivel:** Rotate the monitor left or right on its base.
- **Pivot:** The screen can pivot 90 degrees for vertical viewing, ideal for long documents or coding.



ERGONOMIC STAND

Adjust your view with versatile angles

A height-adjustable screen that swivels and tilts enables optimal viewing at versatile angles for ultimate utility. The screen can be pivoted 90 degrees, which is perfect for viewing longer documents with less scrolling.

Illustrations demonstrating the ergonomic flexibility of the monitor stand, including tilt, swivel, height adjustment, and 90-degree pivot functionality.





The SAMSUNG ViewFinity S6 monitor displayed in a vertical (portrait) orientation, showcasing its pivot capability.

4. MAINTENANCE

Proper maintenance ensures the longevity and optimal performance of your monitor.

- **Cleaning the Screen:** Gently wipe the screen with a soft, lint-free cloth. For stubborn marks, lightly dampen the cloth with water or a specialized screen cleaner. Avoid using harsh chemicals, alcohol, or abrasive materials.
- **Cleaning the Casing:** Use a soft, dry cloth to wipe the monitor casing.
- **Ventilation:** Ensure the monitor's ventilation openings are not blocked to prevent overheating.
- **Power Off When Not in Use:** Turn off the monitor when not in use for extended periods to conserve energy and prolong its lifespan.

5. TROUBLESHOOTING

If you encounter issues with your monitor, refer to the following common troubleshooting steps.

Problem	Possible Solution
---------	-------------------

Problem	Possible Solution
No image on screen	<ul style="list-style-type: none"> • Ensure the power cable is securely connected and the monitor is turned on. • Verify that the video cable (USB-C, HDMI, DP) is properly connected to both the monitor and the computer. • Check the input source selection in the OSD menu to ensure it matches the connected cable. • Restart the computer.
Image is blurry or distorted	<ul style="list-style-type: none"> • Ensure the display resolution and refresh rate are set correctly (2560x1440, 100Hz) in your computer's display settings. • Check the video cable for damage or loose connections.
Monitor does not detect signal after sleep	<ul style="list-style-type: none"> • Press any key on the keyboard or move the mouse to wake the computer. • Manually switch the input source using the OSD menu. • Check power management settings on your computer.
KVM switch not working	<ul style="list-style-type: none"> • Ensure your keyboard and mouse are connected to the monitor's USB ports. • Verify that the input source is correctly selected for the desired computer. • Some KVM functions may require specific driver installations or software. Refer to Samsung's support website.

6. SPECIFICATIONS

Detailed technical specifications for the SAMSUNG ViewFinity S6 (S60UD) 24-inch QHD Monitor.

Feature	Detail
Model Number	LS24D606UANXZA
Screen Size	24 Inches
Screen Resolution	2560x1440 (QHD)
Max Screen Resolution	2560 x 1440 Pixels
Refresh Rate	100Hz
Aspect Ratio	16:9
Screen Surface Description	Flat
HDR Support	HDR10
Color	Black
Item Weight	11.9 pounds

Feature	Detail
Product Dimensions (LxWxH)	8.66 x 21.29 x 21.1 inches
Voltage	110 Volts
USB 3.0 Ports	3
Connectivity	HDMI, USB-C, DisplayPort, LAN Port

6.1 What's in the Box

- DP Cable
- USB Type-C Cable
- Power Cable

7. WARRANTY AND SUPPORT

7.1 Warranty Information

For specific warranty details, please refer to the warranty card included with your product or visit the official Samsung website. Warranty terms and conditions may vary by region and product.

7.2 Customer Support

If you require further assistance or encounter issues not covered in this manual, please contact Samsung Customer Support. You can find contact information and additional resources on the official Samsung website:

[Samsung Support Website](#)