



[Manuals.plus](#) /

> [MOES](#) /

> MOES 2nd Generation Smart Touch Wall Switch User Manual (Model B0D5Y3ZCS4)

MOES B0D5Y3ZCS4

MOES 2nd Generation Smart Touch Wall Switch User Manual

Model: B0D5Y3ZCS4

[Introduction](#) [Safety Information](#) [Package Contents](#) [Product](#)
[Overview](#) [Setup](#) [Operation](#) [Maintenance](#) [Troubleshooting](#) [Specifications](#) [Warranty & Support](#)

1. INTRODUCTION

Thank you for choosing the MOES 2nd Generation Smart Touch Wall Switch. This device offers advanced control over your lighting, featuring Wi-Fi connectivity, touch control, and compatibility with smart home platforms like Alexa and Google Home. This manual provides detailed instructions for installation, operation, and troubleshooting to ensure optimal performance and safety.



Image 1.1: MOES Smart Touch Wall Switch and its packaging.

2. SAFETY INFORMATION

WARNING: RISK OF ELECTRIC SHOCK. Improper installation can be dangerous or illegal. Consult a qualified electrician if you are unfamiliar with electrical wiring.

- Always turn off power at the circuit breaker before installation, removal, or maintenance.
- Ensure the switch is installed in a standard electrical wall box.
- This device is designed for indoor use only.
- Do not exceed the maximum load rating of the switch.
- Keep out of reach of children.
- The switch operates on 110V AC.

3. PACKAGE CONTENTS

Verify that all items are present in your package:

- MOES Smart Touch Wall Switch (1 Gang)
- Mounting Screws

- Capacitor (for no neutral wire installations)
- User Manual

4. PRODUCT OVERVIEW

4.1 Key Features

- **Flexible Wiring:** Supports installation with or without a neutral wire.
- **Remote APP Control:** Manage your lighting from anywhere using the MOES APP.
- **Voice Control:** Compatible with Alexa and Google Home for hands-free operation.
- **Scheduling & Timer Functions:** Automate lighting with custom schedules and countdown timers.
- **Enhanced Safety:** Constructed with fire-retardant materials and advanced no electric arc technology.
- **Fast Pairing:** Utilizes Wi-Fi + BLE for 30% faster pairing.
- **Durable Design:** Features tempered glass panel and brand components for reliability.

4.2 Internal Components & Quality

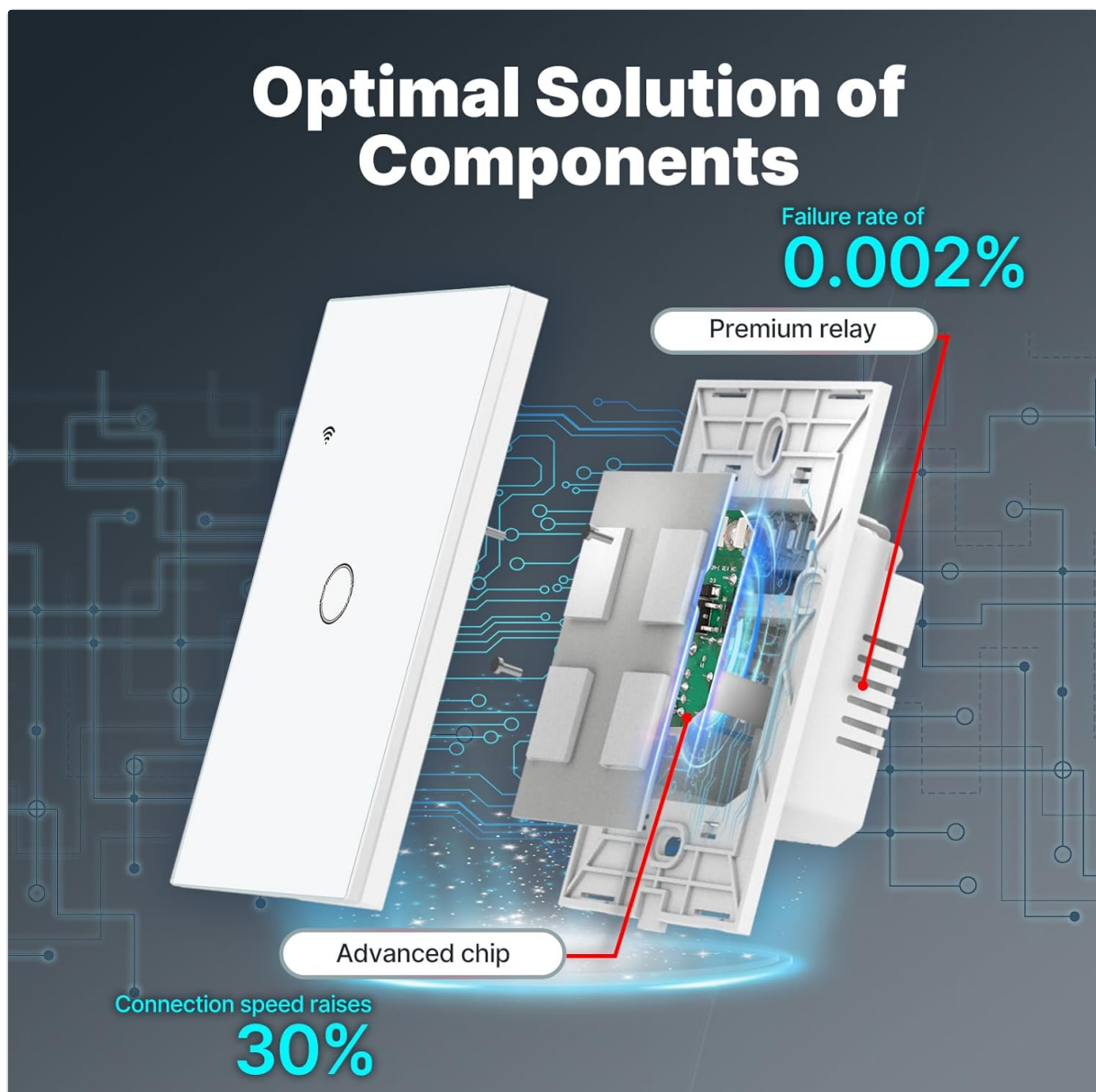
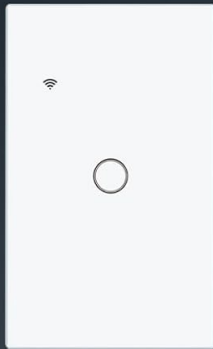

Image 4.1: Illustration of the smart switch's internal components, highlighting the advanced chip and premium relay for reliable performance.

Budget-friendly in Its Class



Ours

VS



Others

✓	UL94 V-0: Highest level of fireproof materials	✗
✓	Durable tempered glass	✗
✓	Brand components	✗
✓	99.9% of products have a service life of more than 5 years	✗
✓	100% product testing and aging spot testing	✗

Image 4.2: Feature comparison demonstrating the MOES switch's adherence to UL94 V-0 fireproof standards, durable tempered glass, and extensive product testing.

5. SETUP

5.1 Wiring Installation

Before proceeding, ensure the power is OFF at the circuit breaker. This switch supports both neutral wire and no neutral wire configurations.

Two Wiring Optional

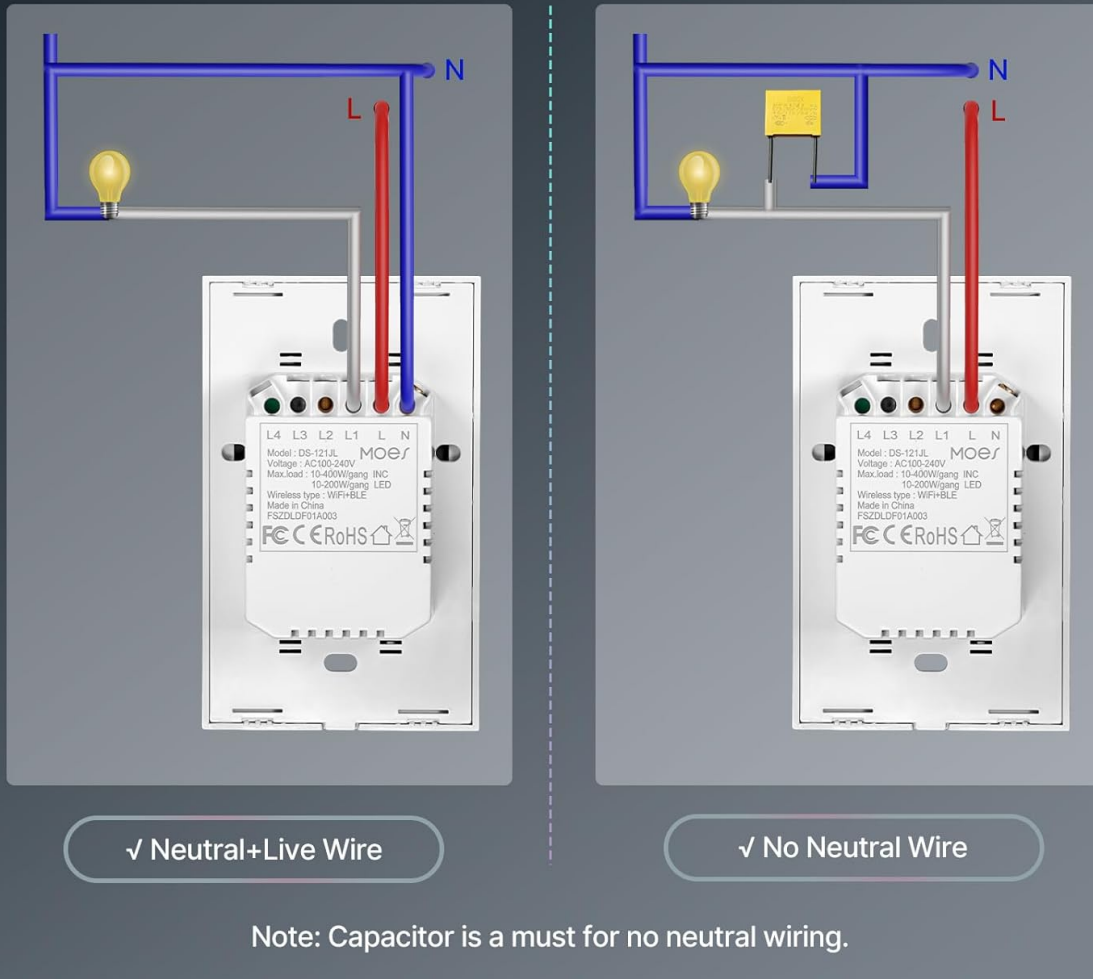

Image 5.1: Wiring diagrams for installations with Neutral+Live Wire (left) and No Neutral Wire (right). Note: A capacitor is required for no neutral wiring.

1. **Turn off Power:** Locate your circuit breaker and turn off the power to the light switch you are replacing.
2. **Remove Old Switch:** Carefully remove the existing wall plate and switch. Disconnect the wires.
3. **Identify Wires:** Identify the Live (L), Load (L1, L2, L3, L4), and Neutral (N) wires. If no neutral wire is present, you will use the provided capacitor.
4. **Connect Wires:**
 - **With Neutral Wire:** Connect the Live wire to the 'L' terminal, the Load wire(s) to the 'L1' (and L2, L3, L4 if applicable) terminals, and the Neutral wire to the 'N' terminal.
 - **Without Neutral Wire:** Connect the Live wire to the 'L' terminal and the Load wire(s) to the 'L1' (and L2, L3, L4 if applicable) terminals. Install the provided capacitor across the light fixture's Live and Neutral terminals.
5. **Mount Switch:** Secure the MOES Smart Switch into the wall box using the provided screws. Attach the wall plate.
6. **Restore Power:** Turn the power back on at the circuit breaker.

5.2 App Pairing

The MOES Smart Switch uses Wi-Fi and Bluetooth Low Energy (BLE) for faster pairing with the MOES APP.

Dimensions

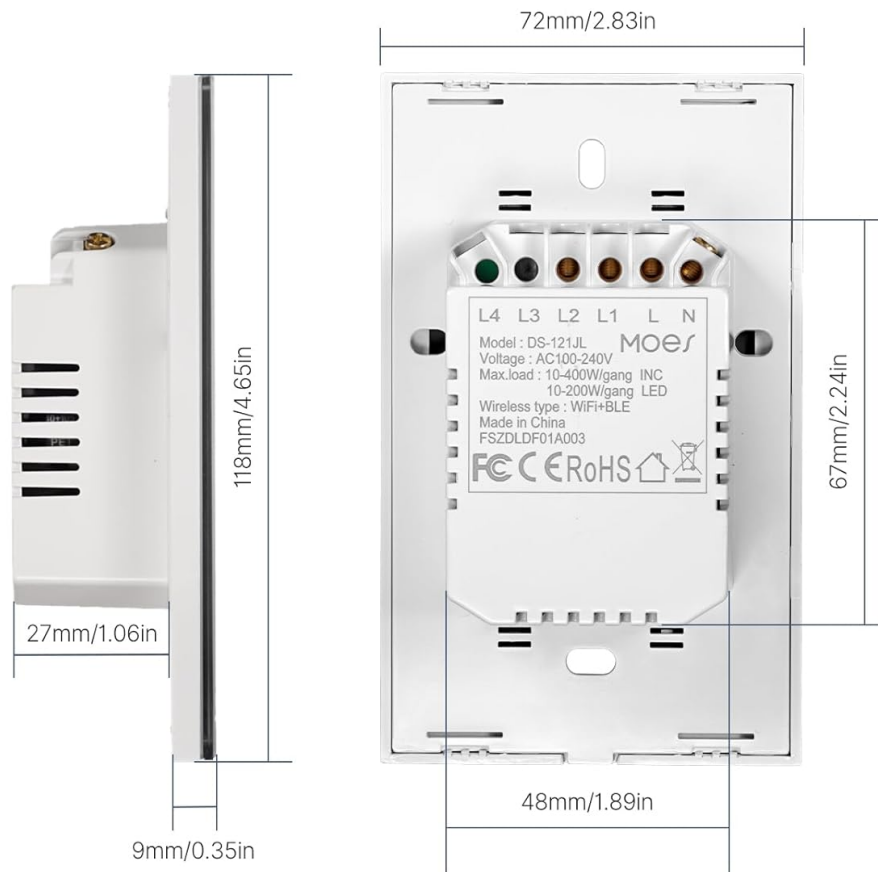

Image 5.2: Illustration of the Wi-Fi + BLE pairing process, indicating a 30% faster connection.

1. **Download MOES APP:** Search for 'MOES' in your smartphone's app store (iOS or Android) and download the application.
2. **Register/Login:** Open the app and register a new account or log in with an existing one.
3. **Add Device:** Tap the '+' icon in the top right corner of the app to add a new device.
4. **Enter Pairing Mode:** On the smart switch, press and hold the touch button for approximately 5-10 seconds until the indicator light starts blinking rapidly. This indicates pairing mode.
5. **Connect:** The app should automatically detect the switch via BLE. Follow the on-screen prompts to connect the switch to your 2.4GHz Wi-Fi network. (Note: The switch only supports 2.4GHz Wi-Fi).
6. **Rename Device:** Once connected, you can rename the switch for easier identification (e.g., 'Living Room Light').

6. OPERATING INSTRUCTIONS

6.1 Manual Touch Control

The smart switch features a responsive touch panel for direct control. Simply tap the touch button to turn the connected light(s) ON or OFF.

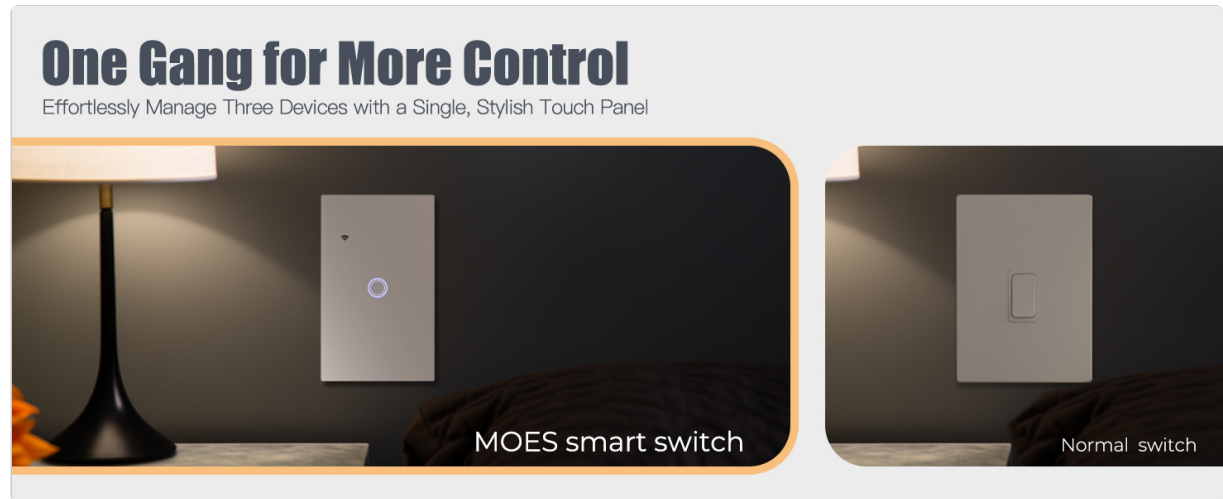

Image 6.1: Comparison of the sleek touch interface of the MOES smart switch with a traditional mechanical switch.

6.2 Remote APP Control

Control your lights from anywhere using the MOES APP on your smartphone or tablet.



Image 6.2: A user controlling their light remotely using the MOES APP on a smartphone.

- Open the MOES APP and select your smart switch.
- Tap the ON/OFF button to toggle the light status.
- Access advanced settings for scheduling, timers, and other customizations.

6.3 Voice Control

Integrate your MOES Smart Switch with Amazon Alexa or Google Home for convenient voice commands.

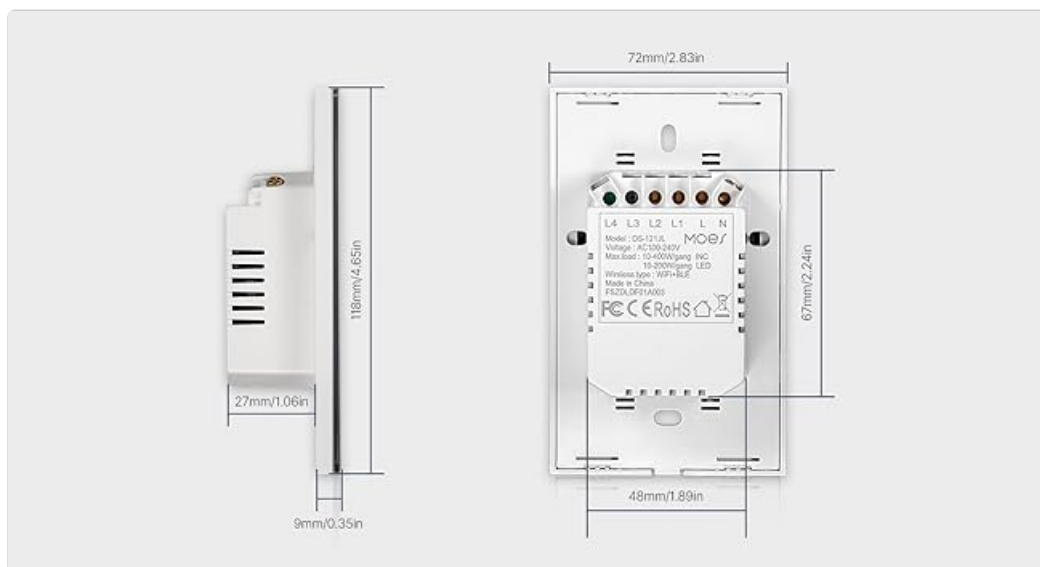

Image 6.3: Example of voice command interaction with a smart speaker to control lighting.

1. **Link Account:** In the Alexa or Google Home app, enable the 'MOES' skill/service and link your MOES account.
2. **Discover Devices:** Ask Alexa or Google Assistant to 'Discover devices'.
3. **Use Voice Commands:** Once discovered, you can use commands like:

- "Alexa, turn on [Light Name]"
- "Hey Google, turn off [Light Name]"

6.4 Scheduling and Timer Functions

Automate your lighting to suit your daily routine or enhance home security.



Image 6.4: Visual representation of setting a timer for automatic light operation.

- In the MOES APP, select your switch and navigate to the 'Schedule' or 'Timer' section.
- Set specific times for the light to turn ON or OFF daily or on selected days.
- Use the countdown timer to automatically turn off the light after a set duration.

6.5 Multiple Control & Family Sharing

The MOES APP allows for multiple users to control the same device or for one user to control multiple devices.



Image 6.5: Illustration of multiple users controlling a single switch and one user controlling multiple switches.

- **Family Sharing:** Share control of your smart switch with family members through the MOES APP's sharing feature.
- **Group Control:** Group multiple MOES smart switches together in the app to control them simultaneously with a single command.

7. MAINTENANCE

The MOES Smart Touch Wall Switch requires minimal maintenance.

- **Cleaning:** To clean the glass panel, gently wipe it with a soft, dry, or slightly damp cloth. Do not use abrasive cleaners or solvents.
- **Firmware Updates:** Periodically check the MOES APP for available firmware updates to ensure optimal performance and access to new features.
- **Power Cycle:** If the switch becomes unresponsive, try turning off the power at the circuit breaker for 10 seconds, then turning it back on.

8. TROUBLESHOOTING

Problem	Possible Cause	Solution
---------	----------------	----------

Problem	Possible Cause	Solution
Switch not responding to touch	No power; Incorrect wiring; Switch malfunction.	Check circuit breaker. Verify wiring connections. Power cycle the switch. If issue persists, contact support.
Light flickering (no neutral wire)	Capacitor not installed or faulty; Minimum load not met.	Ensure the capacitor is correctly installed across the light fixture. Verify the connected light meets the minimum 5W load requirement.
Cannot connect to Wi-Fi	Incorrect Wi-Fi band; Weak signal; Incorrect password; Switch not in pairing mode.	Ensure your router is 2.4GHz. Move closer to the router. Double-check Wi-Fi password. Put the switch into pairing mode (rapidly blinking indicator).
Voice control not working	MOES account not linked; Device not discovered; Incorrect device name.	Ensure MOES skill/service is enabled and linked in Alexa/Google Home app. Ask to 'Discover devices'. Use the exact device name configured in the MOES app.
Switch appears offline in app	Wi-Fi disconnected; Router issues; Power outage.	Check your Wi-Fi router and internet connection. Power cycle the switch. Re-pair if necessary.

9. SPECIFICATIONS

Feature	Detail
Model	DS-121L (B0D5Y3ZCS4)
Operating Voltage	AC 100-240V
Max Load	10-200W/Gang (INC), 10-200W/Gang (LED)
Wireless Type	Wi-Fi 2.4GHz + BLE
Operation Mode	ON-OFF-ON
Contact Type	Normally Closed
Connector Type	Screw Terminals
Circuit Type	1-way
Actuator Type	Push Button (Touch)
Contact Material	Glass
Dimensions	118mm (H) x 72mm (W) x 27mm (D) / 4.65in (H) x 2.83in (W) x 1.06in (D)
Minimum Control	5 watts

WiFi+BLE Pairing 30% Faster than Only WiFi Pairing



Image 9.1: Detailed dimensions of the MOES Smart Touch Wall Switch.

10. WARRANTY & SUPPORT

MOES products are designed for reliability and performance. For warranty information, technical support, or further assistance, please refer to the official MOES website or contact their customer service directly.

Manufacturer: WENZHOU NOVA NEW ENERGY CO.,LTD

Online Support: Visit the [MOES Store on Amazon](#) for product information and support resources.