

manuals.plus /

› [Oticon](#) /

› [Oticon TV Adapter 3.0 User Manual](#)

Oticon TV Adapter 3.0

Oticon TV Adapter 3.0 User Manual

Model: TV Adapter 3.0 | Brand: Oticon

INTRODUCTION

The Oticon TV Adapter 3.0 is a wireless device designed to stream high-quality audio directly from your television to your compatible Oticon hearing aids. This manual provides detailed instructions to help you set up, operate, and maintain your TV Adapter for an enhanced listening experience.

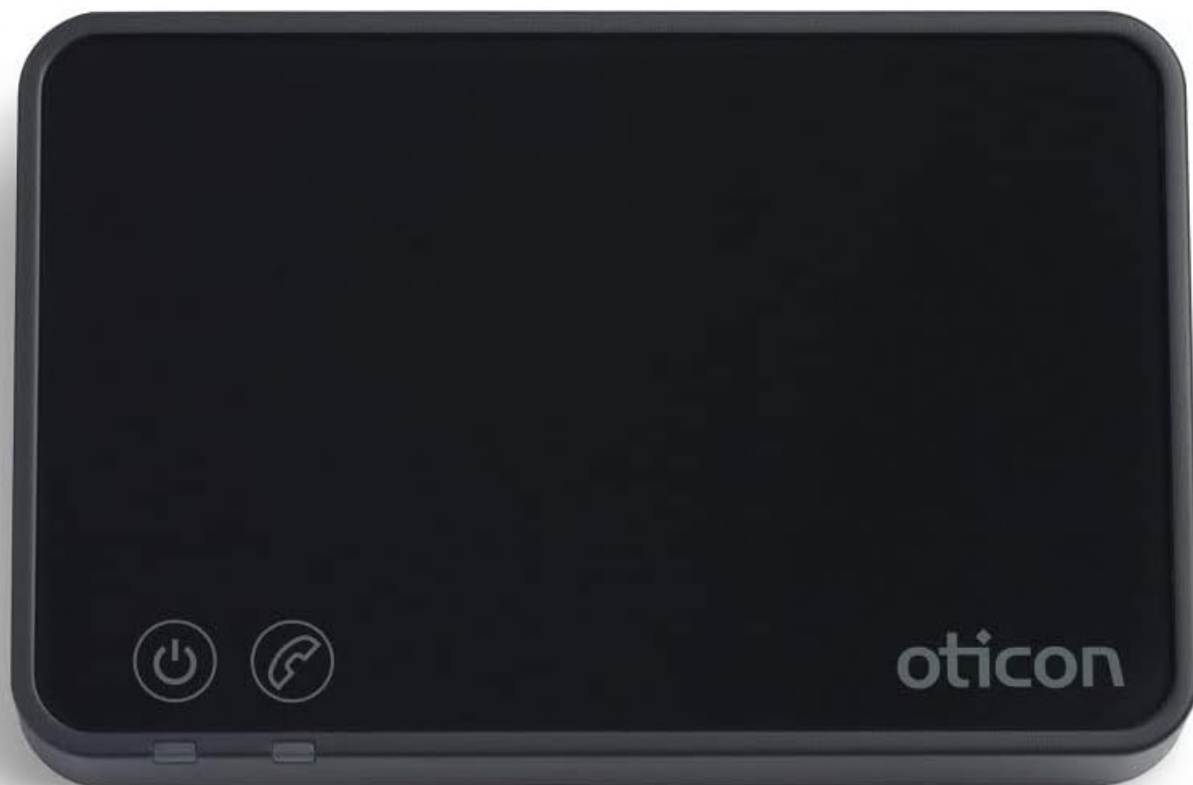

Image: The Oticon TV Adapter 3.0, a compact black rectangular device with indicator lights and the Oticon logo.

WHAT'S IN THE BOX

Upon unboxing your Oticon TV Adapter 3.0, please ensure all the following components are present:

- Oticon TV Adapter 3.0
- Power Adapter
- Optical Audio Cable (TOSLINK)
- RCA Cable
- 3.5 mm Jack Cable
- User Manual (this document)

COMPATIBILITY

The Oticon TV Adapter 3.0 is compatible with the following Oticon hearing instruments and processors:

- Oticon Opn
- Oticon Engage
- Oticon More
- Oticon Siya
- Oticon Xceed hearing aids
- Ponto 4 & 5 processors

Note: This device is **not** compatible with Oticon Streamers. If you have a Streamer, you will need the TV Adapter 2.0. All Oticon Bluetooth hearing aids can be paired with up to four TV Adapters, except Oticon Opn and Oticon Siya, which can only be paired with a single TV Adapter.

PRODUCT OVERVIEW

Familiarize yourself with the Oticon TV Adapter 3.0's indicators and ports:



Image: Front view of the TV Adapter showing the Power indicator (left) and TV indicator (right).



TV Adaptor

Image: Back view of the TV Adapter showing the SelectMe button, Power input, RCA L+R audio inputs, TOSLINK In, and TOSLINK Out ports.

The TV Adapter features indicator lights that provide status information:

Connect using TOSLINK

1. Use the TOSLINK cable from box no. 3 (A).
2. Remove the plastic cap from the TOSLINK cable. (B)
3. Connect the TOSLINK cable to the TOSLINK output on your TV/home theatre system (C).
4. Connect the TOSLINK cable to the pink TOSLINK input (D) on the TV Adapter.
5. The TOSLINK output (E) may be used to connect other TOSLINK devices such as external Dolby® Decoders and surround sound systems.
6. Refer to page 24 for pairing of the TV Adapter with your hearing aid.

Note

It may be necessary to configure your TV, DVD player or home theatre system so that the correct audio output is available on the TOSLINK output.

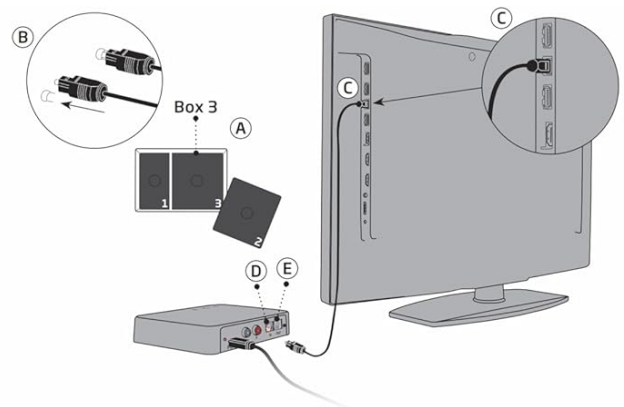

Image: A diagram illustrating the different states of the Power and TV indicator lights (No light, Blinking, Fading, Steady) corresponding to various modes and fault conditions.

SETUP

1. Power Connection

1. Connect the power adapter to the 'Power' port on the back of the TV Adapter.
2. Plug the power adapter into a wall outlet. The Power indicator light on the TV Adapter will illuminate.

2. Audio Connection

The TV Adapter supports multiple audio input options. Choose the one that best suits your television or audio system.

Using RCA Cables

Connect your TV to the Oticon TV Adapter using the supplied RCA cables. This method is suitable for TVs with RCA

audio output ports (red and white).

Video: Demonstrates how to connect the Oticon TV Adapter to a television using RCA cables, showing the connection points on both the adapter and the TV.

1. Connect the red and white RCA plugs from the RCA cable to the corresponding red and white 'RCA L+R' input ports on the back of the TV Adapter.
2. Connect the other end of the RCA cable to the red and white audio output ports on your television.

Using TOSLINK (Optical) Cable

For digital audio output, use the TOSLINK optical cable. This provides high-quality digital sound.

TV Adapter overview

Mode	Power indicator	TV indicator
Power on, not paired to any hearing aids		
Pairing complete (steady light 30 seconds)		
Power on, not streaming		
RCA inserted and streaming		
No RCA/Audio input		
TOSLINK inserted and streaming (digital)		
TOSLINK inserted and streaming (invalid signal)*		
Fault condition **		

No light

Red

Green

 Blinking

Fading

Steady

* Try other input connection

** Contact your hearing care professional

Image: A diagram illustrating the connection of the TOSLINK cable from the TV's optical output to the TV Adapter's TOSLINK input.

1. Remove the plastic caps from both ends of the TOSLINK cable.
2. Connect one end of the TOSLINK cable to the 'TOSLINK In' port on the back of the TV Adapter.
3. Connect the other end of the TOSLINK cable to the optical audio output port on your television or home theatre system.

Note: It may be necessary to configure your TV, DVD player, or home theatre system so that the correct audio output is available on the TOSLINK port.

3. Pairing Hearing Aids

Pairing your Oticon hearing aids with the TV Adapter is a simple process:

Video: Demonstrates how to pair Oticon hearing aids with the TV Adapter by turning them off and on while placing them on the adapter.

1. Ensure the TV Adapter is powered on and connected to your TV.
2. Turn your Oticon hearing aids off and then on again.
3. Place your hearing aids on top of the TV Adapter. They will automatically enter pairing mode.
4. The pairing process should complete within 60 seconds. The TV indicator light on the adapter will turn steady blue, and you will hear a confirmation sound in your hearing aids.

An unlimited number of users with compatible hearing aids can listen to the sound from one TV Adapter. Just pair each hearing aid to the adapter.

OPERATING THE TV ADAPTER

Once paired, the TV Adapter becomes an available program on your hearing aids. You can switch to this program to

begin streaming audio from your TV.

- **Volume Control:** Adjust the volume of the streamed audio directly using the volume controls on your hearing aids.
- **Interruption-Free Listening:** The adapter provides a stable wireless connection, ensuring clear audio without dropouts.
- **Environmental Awareness:** You can choose to hear the TV only through your hearing instruments or keep your hearing aid microphones active to join in conversations while still hearing the TV audio.
- **Switching Adapters:** If you have multiple TV Adapters (e.g., in different rooms), you can easily switch between them using the Oticon ON app on your smartphone (for compatible hearing aids).

MAINTENANCE

To ensure the longevity and optimal performance of your Oticon TV Adapter 3.0, follow these maintenance guidelines:

- Keep the device clean by wiping it with a soft, dry cloth. Avoid using harsh chemicals or abrasive materials.
- Protect the device from extreme temperatures, humidity, and direct sunlight.
- Ensure all cables are securely connected and not bent or crimped.
- Store the adapter in a safe place when not in use to prevent accidental damage.

TROUBLESHOOTING

If you experience issues with your Oticon TV Adapter 3.0, try the following steps before contacting support:

Problem	Possible Solution
No sound from TV Adapter	Check if the TV Adapter is powered on. Verify that the audio cables (RCA or TOSLINK) are securely connected to both the TV and the adapter. Ensure your TV's audio output settings are correctly configured for the connected port. Confirm your hearing aids are paired and set to the TV Adapter program.
Sound is intermittent or distorted	Ensure the TV Adapter is within the recommended 15-meter range of your hearing aids. Check for potential interference from other wireless devices. Restart both the TV Adapter and your hearing aids.
Hearing aids not pairing	Ensure hearing aids are turned off and then on before placing them on the adapter for pairing. Verify compatibility of your hearing aids with TV Adapter 3.0. Try pairing one hearing aid at a time if you have a pair.

If the problem persists after attempting these solutions, please contact your hearing care professional or Oticon support for further assistance.

SPECIFICATIONS

Feature	Detail
Package Dimensions	7.52 x 5.51 x 2.52 inches

Feature	Detail
Item Weight	1 pounds
Hardware Interface	Bluetooth
Color	Black
Compatible Devices	Oticon Opn, Engage, More, Siya, Xceed hearing aids, Ponto 4 & 5 processors
Data Link Protocol	Bluetooth

WARRANTY AND SUPPORT

For warranty information and technical support, please refer to the documentation provided with your purchase or visit the official Oticon website. Keep your proof of purchase for warranty claims.

© 2025 Oticon. All rights reserved.

Related Documents - TV Adapter 3.0

	<p>Oticon Companion App: Empowering Patients and Supporting Hearing Care Professionals</p> <p>Discover the Oticon Companion app, designed to enhance the hearing aid experience for patients with intuitive control, noise management, personalization, and remote support. Learn about its benefits for both users and hearing care professionals.</p>
	<p>Oticon Companion App: User Guide for Hearing Aid Control and Remote Care</p> <p>Explore the Oticon Companion app's features for managing your hearing aids, including volume control, program selection, RemoteCare visits, HearingFitness tracking, and troubleshooting. Compatible with iOS and Android devices.</p>
	<p>Oticon Companion</p> <p>Oticon Companion , RemoteCare , Tinnitus SoundSupport Oticon .</p>



[Oticon Genie 2 2021.2: Fitting Software Instructions for Hearing Care Professionals](#)

Comprehensive instructions for using Oticon Genie 2 2021.2 fitting software. Learn about installation, system requirements, fitting steps, tools like In-situ Audiometry and RemoteCare, and important warnings for hearing care professionals.

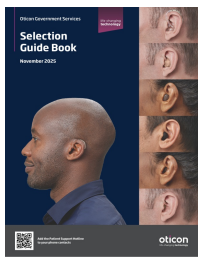

[Oticon Selection Guide Book - November 2025](#)

Oticon's comprehensive Selection Guide Book for November 2025, detailing hearing aid styles (RITE, BTE, Custom), CROS family, chargers, and wireless accessories for optimal hearing solutions.

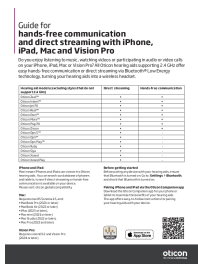

[Oticon Hearing Aids: Hands-Free & Direct Streaming Guide for Apple Devices](#)

Learn how to enable hands-free communication and direct audio streaming from your iPhone, iPad, Mac, and Vision Pro to Oticon hearing aids using Bluetooth Low Energy technology. This guide covers compatibility, pairing steps, and troubleshooting.