

## Manuals+

[Q & A](#) | [Deep Search](#) | [Upload](#)

[manuals.plus](#) /

› [FIOCCO](#) /

› [FIOCCO Elevated Dog Bed Instruction Manual](#)

### FIOCCO EDB001

## FIOCCO Elevated Dog Bed Instruction Manual

Model: EDB001

### PRODUCT OVERVIEW

The FIOCCO Elevated Dog Bed is designed to provide a comfortable and supportive resting area for your canine companion. Featuring a chew-proof and breathable mesh fabric, it promotes air circulation to keep your pet cool, especially during warmer months. The robust metal frame ensures durability and stability, accommodating dogs up to 110 pounds. Its versatile design allows for both indoor and outdoor use, and the lightweight structure makes it easily portable. This elevated design is particularly beneficial for dogs with joint issues or arthritis, offering pressure relief and improved comfort.



Image: The FIOCCO Elevated Dog Bed in blue, with a Border Collie comfortably resting on it, showcasing its elevated design.

## PACKAGE CONTENTS

---

- Mesh Fabric Bed Surface (Blue)
- Long Metal Bars (for length)
- Short Metal Bars (for width)
- Corner Connectors (4 pieces)
- Legs (4 pieces)
- Instruction Manual (this document)

## ASSEMBLY INSTRUCTIONS (SETUP)

---

Assembly of the FIOCCO Elevated Dog Bed is straightforward and requires no additional tools. Please follow the steps below:

### 1. Step 1: Unpack and Identify Parts

Carefully remove all components from the packaging. Lay them out on a clean, flat surface and identify each part according to the package contents list.



Image: An exploded view diagram illustrating the various components of the dog bed, including bars, connectors, and fabric.

### 2. Step 2: Assemble the Frame

Connect the long metal bars to the short metal bars using the corner connectors. Ensure that the foot of each leg is inserted into the hole with the cylinder on the corner connectors. Press firmly until they click into place.

Your browser does not support the video tag.

Video: A demonstration of assembling the frame components, including connecting bars and inserting legs into the corner pieces.

### 3. Step 3: Attach the Mesh Fabric

Slide the assembled metal frame into the sleeves of the mesh fabric bed surface. Ensure all bars are fully inserted into their respective sleeves.

A circle with a shaded sector representing  $\frac{1}{4}$  of the circle.

**STEP 1**

Diagram illustrating the initial alignment of two DNA sequences (A and B) for Step 1. The sequences are represented by horizontal bars. The top sequence is labeled 'A' and the bottom sequence is labeled 'B'. The alignment shows the sequences starting at the same position, with arrows indicating the direction of alignment.

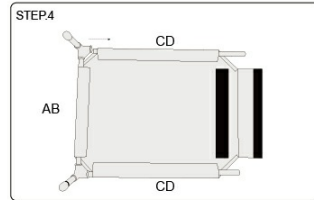
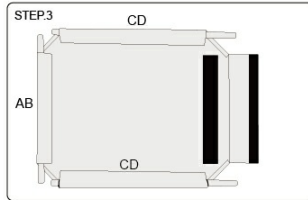
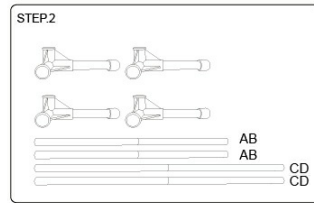

#### 4. Step 4: Secure the Velcro

Your browser does not support the video tag.

## OPERATING INSTRUCTIONS (USAGE GUIDELINES)

- **Placement:**

Place the bed on a flat, stable surface. It can be used in living areas, patios, yards, or even inside a dog crate if space permits.



M



Size: 30" x 23" x 7.7"  
Weight: Up to 110lbs

L



Size: 36" x 29.7" x 7.7"  
Weight: Up to 150lbs

XL

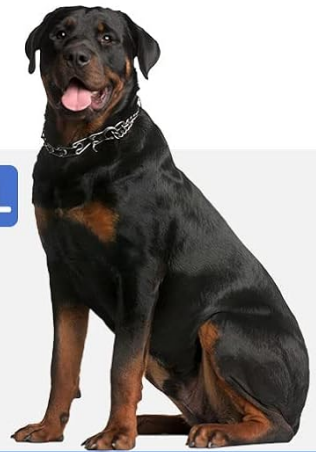

Size: 46.9" x 34.3" x 9.6"  
Weight: Up to 200lbs

Image: A beagle resting comfortably on the elevated dog bed inside a home, demonstrating indoor use.





Image: A golden retriever lying on the elevated dog bed in a grassy backyard, illustrating outdoor use.

- **Cooling Benefit:**

The breathable mesh fabric allows air to circulate underneath and around your dog, helping to regulate their body temperature and keep them cool, especially beneficial during hot weather.

- **Joint Support:**

The elevated design keeps your dog off hard surfaces, reducing pressure on joints and providing orthopedic support, which is ideal for older dogs or those with arthritis.



## Smooth Fence

Relieving Joint Stress In Dogs



Image: A husky resting on the bed, highlighting the smooth fence design and its benefit in relieving joint stress.

Your browser does not support the video tag.

Video: A comprehensive overview of the FIOCCO Elevated Dog Bed, demonstrating its features and benefits for dogs.

## CARE AND MAINTENANCE

Keeping your FIOCCO Elevated Dog Bed clean is simple, ensuring a hygienic environment for your pet.

- **Cleaning the Mesh Fabric:**

The mesh fabric is removable and machine washable. For best results, machine wash on a gentle cycle with cold water and a mild detergent. Air dry or tumble dry on low heat. Do not bleach.





# Superior Quality Teslin Mesh

Breathable



Easy to Clean



Anti-Scratch



Water Permeable

Image: A close-up view of the Teslin mesh fabric, illustrating its easy-to-clean, anti-scratch, and water-permeable qualities.

- **Frame Cleaning:**

Wipe down the metal frame with a damp cloth and mild soap as needed. Rinse thoroughly and dry completely to prevent rust.

## TROUBLESHOOTING

If you encounter any issues with your FIOCCO Elevated Dog Bed, please refer to the common solutions below:

- **Issue: Velcro cannot be closed / Fabric is not taut.**

Ensure that all metal bars are fully inserted into the fabric sleeves and that the frame is correctly assembled and locked into place. Sometimes, applying gentle pressure on the frame while securing the Velcro can help achieve the desired tautness.

Your browser does not support the video tag.

Video: A demonstration addressing the issue of Velcro not closing properly, showing how to adjust the fabric for a secure fit.

- **Issue: Bed feels unstable or wobbly.**

Verify that all frame connections are securely fastened and that the legs are fully inserted into the corner connectors. Ensure the bed is placed on a level surface.

PRODUCT SPECIFICATIONS

Feature	Detail
Brand	FIOCCO
Model Number	EDB001
Dimensions (Medium)	30"L x 23"W x 7.7"H (76x58x20 cm)
Weight Capacity	Up to 110 lbs (50 kg)
Material	Mesh Fabric, Metal Frame
Color	Blue
Care Instructions	Machine Washable Fabric
Special Features	Travel, Cooling, Chew Resistant, Easy to Clean, Durable





**Rubber Feet**  
Anti-Slip & Design for indoor

**Off The Ground**  
7.7"

Image: A visual representation of the medium-sized dog bed with its dimensions (30"L x 23"W x 7.7"H) clearly marked.

## WARRANTY INFORMATION





There is no stated warranty for this product.

## CUSTOMER SUPPORT

For any questions, concerns, or assistance with your FIOCCO Elevated Dog Bed, please contact our customer support team. Refer to your purchase documentation for specific contact details or visit the official FIOCCO website.

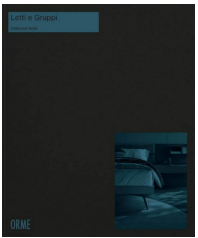

## Related Documents - EDB001

	<p><a href="#">FIOCCO Elevated Dog Cot - Assembly and Installation Guide</a></p> <p>Comprehensive installation guide for the FIOCCO Elevated Dog Cot. Learn how to assemble your pet's comfortable and durable elevated bed with clear steps, parts list, and helpful tips. Suitable for indoor and outdoor use.</p>
	<p><a href="#">FIOCCO Elevated Dog Cot - Assembly and Installation Guide</a></p> <p>Comprehensive installation guide for the FIOCCO Elevated Dog Cot. Learn how to assemble your pet's comfortable and durable elevated bed with clear steps, parts list, and helpful tips. Suitable for indoor and outdoor use.</p>
	<p><a href="#">Erbesi Baby Furniture Technical Specifications and Product Overview</a></p> <p>Detailed technical specifications, safety regulations, and product features for Erbesi baby cribs, changing tables, chests of drawers, and wardrobes. Includes information on materials, safety standards, and collection compatibility.</p>
	<p><a href="#">ORME Collezione Notte: Letti e Gruppi di Arredo per la Camera da Letto</a></p> <p>Scopri le raffinate collezioni notte e armadi ORME, parte del Gruppo Homes. Design contemporaneo e moderno, finiture materiche e laccate per creare ambienti personalizzati e funzionali.</p>
	<p><a href="#">Catalogo Rivadossi Sandro Collezione 2025: Posate di Alta Qualità</a></p> <p>Scopri il catalogo completo delle posate Rivadossi Sandro Collezione 2025. Design italiano, materiali pregiati e una vasta gamma di modelli per la tua tavola.</p>
	<p><a href="#">HORIBA France Application Training Catalog 2025</a></p> <p>This catalog details the training courses offered by HORIBA France for 2025. It covers personalized training, method development and optimization support, and catalog training programs focused on various HORIBA Scientific instruments and techniques such as AFM, Raman Spectroscopy, GD-OES, ICP-OES, and Fluorescence Spectroscopy. The document lists expert trainers, course objectives, schedules, prerequisites, locations, and pricing.</p>