



Manuals.plus /

› DistinQ /

› DistinQ Electric Cooler with Heating Function User Manual

DistinQ DQCB25GY

DistinQ Electric Cooler with Heating Function User Manual

Brand: DistinQ | Model: DQCB25GY

1. INTRODUCTION

Thank you for choosing the DistinQ Electric Cooler. This versatile appliance is designed to keep your food and beverages at optimal temperatures, whether you need them chilled or warm. With a generous 25-liter capacity and dual 12V/230V power options, it's perfect for use in your car, at home, or during camping trips. Please read this manual carefully before use to ensure safe and efficient operation.

2. SAFETY INSTRUCTIONS

- Always ensure the power supply matches the voltage specified on the cooler (12V DC or 230V AC).
- Do not immerse the cooler in water or expose it to excessive moisture.
- Keep ventilation openings clear and unobstructed to prevent overheating.
- Do not use the cooler if the power cord or plug is damaged. Contact customer support for assistance.
- Avoid placing hot items directly into the cooler when in cooling mode, or cold items when in heating mode, as this can reduce efficiency.
- Unplug the cooler from the power source before cleaning or when not in use.
- This appliance is not intended for use by persons (including children) with reduced physical, sensory or mental capabilities, or lack of experience and knowledge, unless they have been given supervision or instruction concerning use of the appliance by a person responsible for their safety.
- Do not use abrasive cleaners or sharp objects to clean the interior or exterior of the cooler.

3. PACKAGE CONTENTS

Please check the package for the following items:

- DistinQ Electric Cooler
- 12V DC Car Power Cable
- 230V AC Home Power Cable
- Internal Divider

- User Manual (English)

4. PRODUCT OVERVIEW

Familiarize yourself with the key features of your DistinQ Electric Cooler.



Figure 4.1: Front view of the DistinQ Electric Cooler, showcasing its sleek grey design and integrated handle.

DISTINQ

AFMETINGEN



Figure 4.2: Dimensions of the cooler. It measures approximately 40 cm in length, 24 cm in width, and 42 cm in height, offering a compact yet spacious design.

AANSLUITING

De koelbox van DistinQ is aan te sluiten op 12 Volt en op 230 Volt



Figure 4.3: The cooler supports both 12V DC (car lighter socket) and 230V AC (standard wall outlet) power connections, providing versatile usage options.

DISTINQ

INCLUSIEF OPBERGVAK

Super handig voor alle kabels

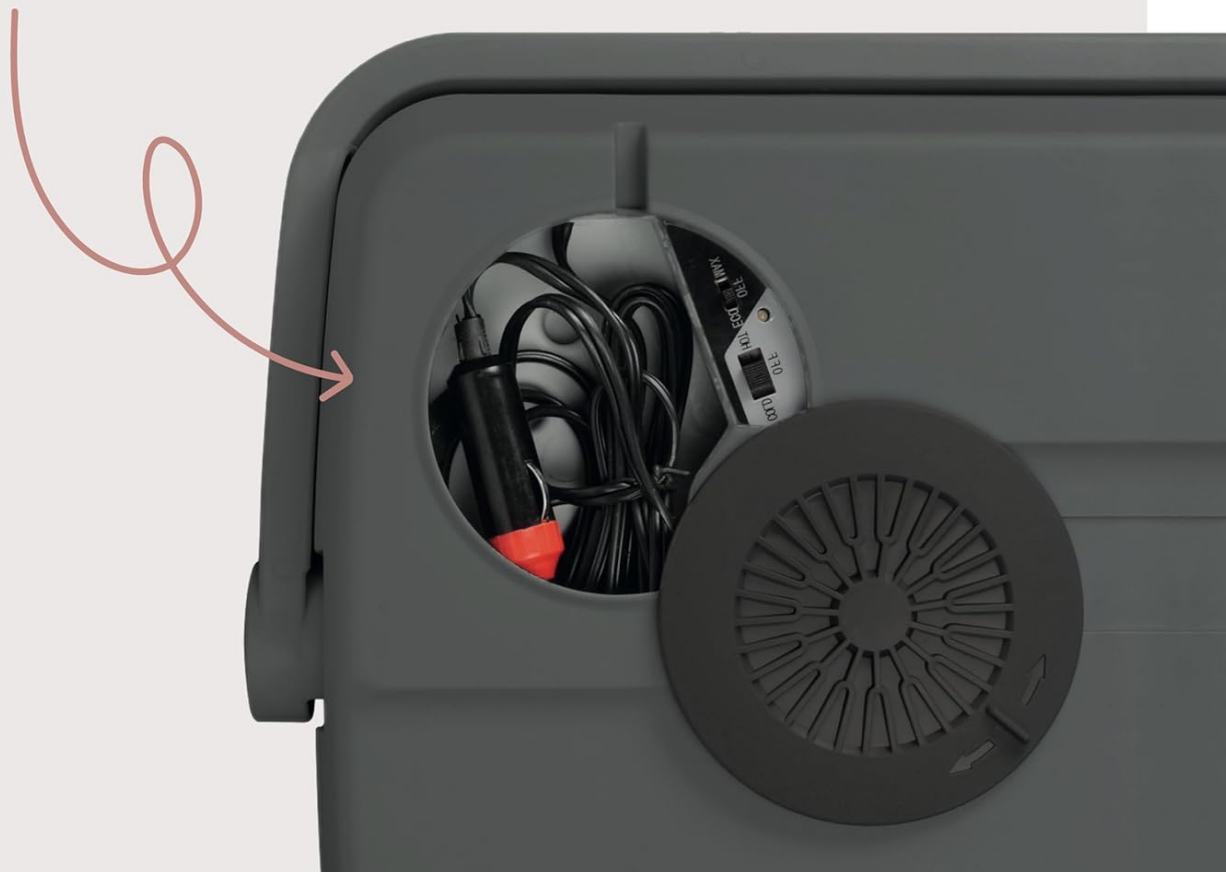

Figure 4.4: Convenient integrated storage compartment for neatly stowing away power cables when not in use or during transport.

DISTINQ

STEVIG HANDVAT



Figure 4.5: The robust, foldable handle ensures easy and comfortable portability of the cooler.

WARME MAALTIJD

Verwam eenvoudig
maaltijden, soep
en dranken.



KOUDE MAALTIJD

Verkoel eenvoudig
salades, sandwiches
en snacks.



Figure 4.6: The cooler supports both cooling and heating functions, allowing you to keep various foods and drinks at their desired temperature.

5. SETUP

1. **Unpacking:** Carefully remove the cooler and all accessories from the packaging. Retain packaging for future storage or transport.
2. **Initial Cleaning:** Before first use, wipe the interior and exterior of the cooler with a damp cloth and mild detergent. Ensure it is completely dry before plugging in.
3. **Placement:** Place the cooler on a stable, flat surface. Ensure there is adequate ventilation around the unit, especially around the fan vents on the lid.
4. **Power Connection:**
 - For **12V DC (Car Use):** Connect the 12V car power cable to the cooler's DC input port, then plug the other end into your vehicle's cigarette lighter socket.
 - For **230V AC (Home/Camping Site Use):** Connect the 230V AC power cable to the cooler's AC input port, then plug the other end into a standard wall outlet.

6. OPERATION

6.1. Cooling Function

The cooler can cool contents to approximately 18°C below the ambient temperature.

1. Ensure the cooler is connected to a suitable power source (12V DC or 230V AC).
2. Locate the mode switch on the control panel.
3. Set the switch to the "COOL" position. The indicator light will illuminate, indicating that the cooling function is active.
4. For best results, pre-chill items before placing them in the cooler.
5. Keep the lid closed as much as possible to maintain the internal temperature.

6.2. Heating Function

The cooler can heat contents up to approximately 65°C.

1. Ensure the cooler is connected to a suitable power source (12V DC or 230V AC).
2. Locate the mode switch on the control panel.
3. Set the switch to the "HEAT" position. The indicator light will illuminate, indicating that the heating function is active.
4. For best results, place pre-heated items into the cooler to maintain their warmth.
5. Keep the lid closed as much as possible to maintain the internal temperature.

6.3. Power Modes

- **12V DC Mode:** Used for connecting to a vehicle's cigarette lighter socket. Ideal for road trips and car use.
- **230V AC Mode:** Used for connecting to standard household power outlets. Suitable for home, hotel rooms, or powered campsites.
- Ensure the correct cable is used for the respective power source.

7. MAINTENANCE

- **Cleaning:**
 - Unplug the cooler before cleaning.
 - Wipe the interior and exterior surfaces with a soft cloth dampened with mild soap and water.
 - Do not use abrasive cleaners, solvents, or harsh chemicals.
 - Ensure the cooler is completely dry before storing or reconnecting to power.
- **Ventilation:** Regularly check that the ventilation grilles on the lid are free from dust and debris. Use a soft brush or vacuum cleaner to clear any blockages.
- **Storage:** When not in use, store the cooler in a clean, dry place, away from direct sunlight and extreme temperatures. Leave the lid slightly ajar to prevent odors and mildew.

8. TROUBLESHOOTING

Problem	Possible Cause	Solution
Cooler not turning on.	No power supply; loose connection; damaged cable.	Check power outlet/car socket; ensure cables are securely plugged in; inspect cables for damage.
Cooling/Heating not effective.	Blocked ventilation; lid not properly closed; ambient temperature too high/low; too many items inside.	Clear vents; ensure lid is sealed; allow more time for temperature change; do not overfill.
Unusual noise from fan.	Dust or debris in fan; fan malfunction.	Clean fan area; if noise persists, contact customer support.
Condensation inside cooler.	Normal operation, especially in humid conditions.	Wipe dry periodically.

9. SPECIFICATIONS

Feature	Detail
Brand	DistinQ
Model Number	DQCB25GY
Product Dimensions (L x W x H)	24 x 40 x 42 cm
Weight	5.3 Kilograms
Capacity	25 Liters
Color	Grey
Material	Polyethylene
Heating Function	Yes (up to 65°C)
Cooling Function	Yes (down to 18°C below ambient)
Connection Type	12V DC, 230V AC
Special Feature	Foldable Handle, Integrated Cable Storage
Recommended Uses	Camping, Car, Home
Spare Parts Availability	2 Years

10. WARRANTY AND SUPPORT

DistinQ is committed to providing high-quality products and excellent customer service. Your DistinQ Electric Cooler comes with a 2-year availability for spare parts, indicating long-term support for your product.

If you encounter any issues, have questions, or are not satisfied with your purchase, please do not hesitate to contact DistinQ customer support directly. We are dedicated to finding an appropriate solution for you.

For support, please refer to the contact information provided on the product packaging or the official DistinQ website.