



[Manuals.plus](#) /

› [DiDimo](#) /

› DiDimo Electric Food Warming Tray User Manual

DiDimo JN-N01A

DiDimo Electric Food Warming Tray User Manual

Model: JN-N01A | Brand: DiDimo

1. INTRODUCTION

This manual provides essential information for the safe and efficient operation of your DiDimo Electric Food Warming Tray. Please read this manual thoroughly before first use and retain it for future reference. This appliance is designed to keep food warm and can also be used for various other heating tasks.

The DiDimo Electric Food Warming Tray features a flexible silicone design, adjustable temperature settings from 40°C to 120°C, and a programmable timer from 1 to 180 minutes. Its large 61 x 40 cm heating surface and NTC heating technology ensure rapid and even heat distribution. It is compatible with various types of tableware and is designed for easy cleaning and storage.

2. IMPORTANT SAFETY INSTRUCTIONS

WARNING: To reduce the risk of fire, electric shock, or injury, always follow basic safety precautions.

- Read all instructions before using the appliance.
- Do not touch hot surfaces. Use handles or knobs.
- To protect against electrical hazards, do not immerse cord, plugs, or the appliance in water or other liquid.
- Close supervision is necessary when any appliance is used by or near children. The product includes a safety lock function to prevent accidental operation by children.
- Unplug from outlet when not in use and before cleaning. Allow to cool before putting on or taking off parts, and before cleaning the appliance.
- Do not operate any appliance with a damaged cord or plug, or after the appliance malfunctions or has been damaged in any manner. Contact customer service for examination, repair, or adjustment.
- The use of accessory attachments not recommended by the appliance manufacturer may cause injuries.
- Do not use outdoors.
- Do not let cord hang over edge of table or counter, or touch hot surfaces.
- Do not place on or near a hot gas or electric burner, or in a heated oven.
- Always attach plug to appliance first, then plug cord into the wall outlet. To disconnect, turn any control to "off", then remove plug from wall outlet.

- Do not use appliance for other than intended use.
- Ensure the appliance is placed on a stable, heat-resistant surface.
- Avoid placing empty containers on the warming tray when it is active.
- The appliance has an automatic shut-off function after 3 hours of continuous operation for safety and energy saving.

3. PRODUCT OVERVIEW

The DiDimo Electric Food Warming Tray is a versatile appliance designed to keep your food at optimal serving temperatures. Its flexible silicone construction allows for easy storage.



Figure 3.1: DiDimo Electric Food Warming Tray in use and rolled for storage. The image shows the blue silicone mat laid out with multiple food dishes on top, including a pot, a baking tray with meat, and various plates. Above it, the mat is shown rolled up, indicating its portability and ease of storage.

Key Features:

- **Adjustable Temperature:** 17 settings from 40°C (104°F) to 120°C (248°F), with each click increasing by 9°F.
- **Adjustable Timer:** Set heating duration from 1 to 180 minutes.
- **Large Heating Surface:** 61 x 40 cm (approximately 24 x 15.7 inches) for ample space.
- **Rapid Heating:** NTC heating technology ensures quick warming within 10 seconds.
- **High-Quality Material:** Made from flexible, nano-coated silicone, which is waterproof, stain-resistant, and oil-drop

resistant.

- **Safety Lock:** Prevents accidental operation, especially by children.
- **Automatic Shut-off:** Powers off after 3 hours of inactivity for energy saving and safety.
- **Versatile Compatibility:** Suitable for ceramic, glass, stainless steel, frying pans, enamelware, and even baby bottles.
- **Multifunctional Use:** Ideal for keeping food warm, defrosting, melting chocolate, fermenting dough, and warming facial masks.
- **Easy to Clean and Store:** Wipe clean with a damp cloth and roll up for compact storage in the provided bag (40 x 12 x 12 cm).

4. SETUP

1. **Unpack:** Carefully remove the warming tray and all accessories from the packaging.
2. **Inspect:** Check the appliance for any signs of damage. Do not use if damaged.
3. **Placement:** Unroll the warming tray and place it on a flat, stable, and heat-resistant surface, such as a countertop or table. Ensure there is adequate space around the tray for ventilation.
4. **Power Connection:** Plug the power cord into a standard 220V electrical outlet.
5. **Initial Cleaning:** Before first use, wipe the surface of the warming tray with a damp cloth. Do not immerse the unit in water.

5. OPERATING INSTRUCTIONS

The control panel is located on the side of the warming tray and features intuitive buttons for temperature, timer, and lock functions.



Figure 5.1: Close-up of the control panel, highlighting the temperature display, 'Temp' button, 'Time' button, 'Lock' button, and power button. The display shows '120°C'.

5.1 Powering On/Off

- Press the **Power Button** (usually indicated by a circle with a vertical line) to turn the appliance on. The display will light up.
- Press and hold the **Power Button** for a few seconds to turn the appliance off.

5.2 Setting Temperature

- With the tray powered on, press the **Temp Button**. The temperature display will flash.
- Each press of the **Temp Button** will cycle through the 17 available temperature settings, ranging from 40°C to 120°C.
- Stop pressing when your desired temperature is displayed. The setting will be confirmed automatically after a few seconds, and the display will show the current temperature.

5.3 Setting Timer

- Press the **Time Button**. The timer display will flash.
- Each press of the **Time Button** will cycle through the available time settings, from 1 to 180 minutes.
- Stop pressing when your desired heating duration is displayed. The setting will be confirmed automatically after a few seconds. The tray will operate for the set duration and then automatically shut off.

Adjustable Time 1 minute - 180 minutes

To meet the needs of family life and party



Figure 5.2: Image illustrating the adjustable timer function (1-180 minutes) and showing the warming tray being used in two different settings: a party with people gathered around a table, and a home setting with a pot on the warming tray.

5.4 Safety Lock Function

- To activate the safety lock, press the **Lock Button**. An indicator light or symbol may appear on the display.
- When the lock is active, other buttons will not respond, preventing accidental changes to settings or powering off.
- To deactivate the safety lock, press the **Lock Button** again.

5.5 Automatic Shut-off

For safety and energy conservation, the warming tray will automatically shut off after 3 hours of continuous operation if no timer is set or if the set timer exceeds 3 hours. This feature helps prevent overheating and saves power.

5.6 Compatible Tableware

The warming tray is designed to work with a wide range of heat-resistant tableware. Ensure your dishes are suitable for heating.



Figure 5.3: The warming tray shown with various types of dishes, including stainless steel pots, a frying pan, glass cups, enamelware, ceramic bowls, and a baby bottle, demonstrating its compatibility with different materials.

- Ceramic dishes
- Glass containers
- Stainless steel pots and pans
- Frying pans
- Enamelware
- Baby bottles

Avoid using plastic containers that are not explicitly marked as heat-resistant or microwave-safe, as they may melt or deform.

6. MAINTENANCE AND CLEANING

Proper maintenance ensures the longevity and optimal performance of your warming tray.

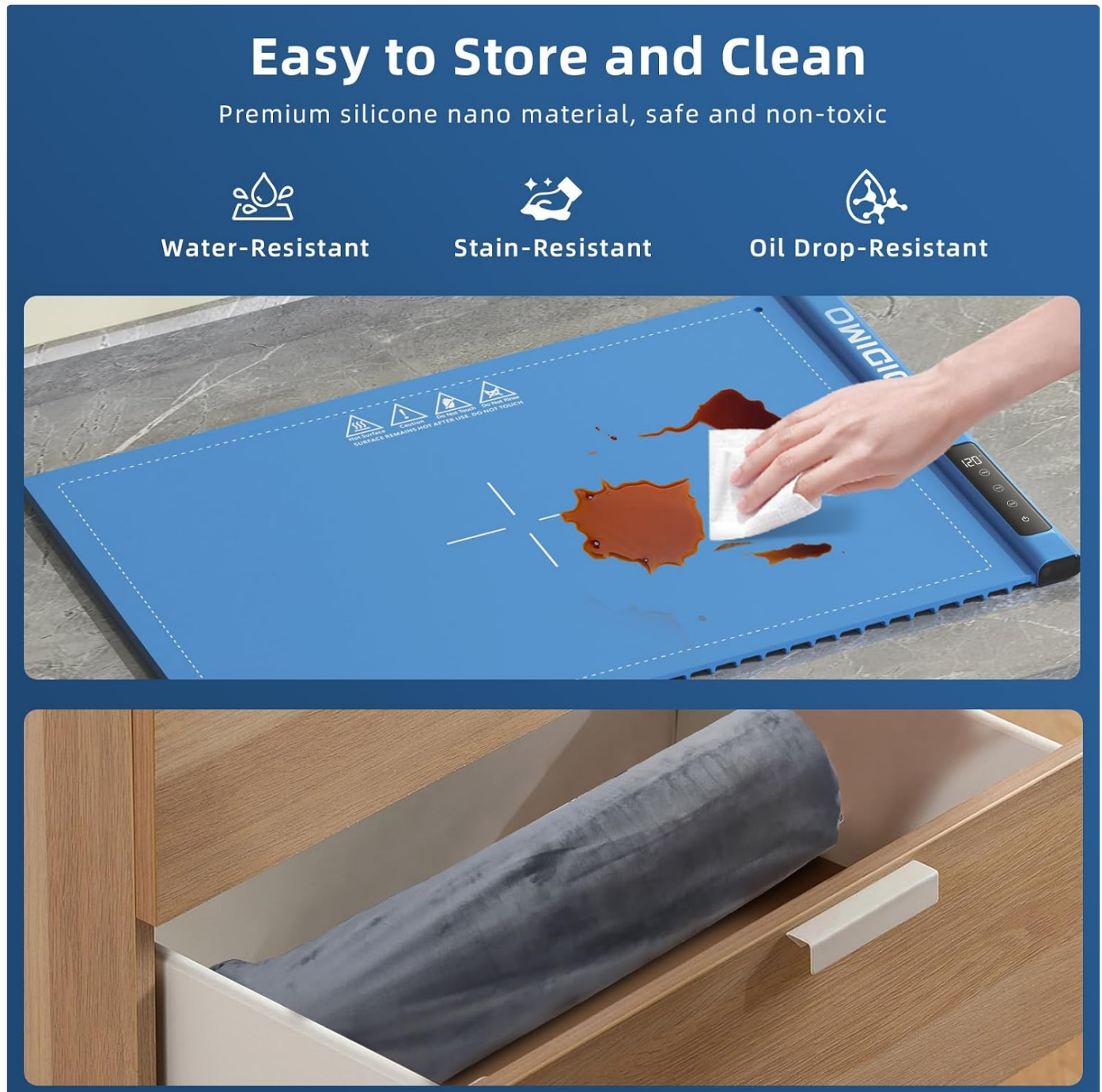

Figure 6.1: The top panel shows a hand wiping a spill on the warming tray, demonstrating its easy-to-clean, water-resistant, stain-resistant, and oil-drop-resistant surface. The bottom panel shows the rolled-up warming tray being placed into a drawer for compact storage.

6.1 Cleaning

1. **Unplug:** Always unplug the warming tray from the power outlet and allow it to cool completely before cleaning.
2. **Wipe Surface:** The silicone surface is waterproof, stain-resistant, and oil-drop resistant. Wipe any spills or food residue with a soft, damp cloth. For stubborn stains, a mild detergent can be used, followed by wiping with a clean, damp cloth.
3. **Do Not Immerse:** Never immerse the warming tray or its power cord in water or any other liquid.
4. **Avoid Abrasives:** Do not use abrasive cleaners, scouring pads, or harsh chemicals, as these can damage the silicone surface.
5. **Dry Thoroughly:** Ensure the warming tray is completely dry before storing or reconnecting to power.

6.2 Storage

- Once clean and dry, the flexible silicone design allows the warming tray to be rolled up for compact storage.
- Store it in the provided storage bag (dimensions: 40 x 12 x 12 cm) to protect it from dust and damage.
- Keep the appliance in a cool, dry place, away from direct sunlight and extreme temperatures.

7. TROUBLESHOOTING

If you encounter any issues with your DiDimo Electric Food Warming Tray, please refer to the following troubleshooting guide before contacting customer service.

Problem	Possible Cause	Solution
Appliance does not turn on.	Not plugged in. Power outlet malfunction. Safety lock is active.	Ensure the power cord is securely plugged into a working outlet. Test the outlet with another appliance. Deactivate the safety lock by pressing the Lock Button.
Food is not warming sufficiently.	Temperature setting is too low. Too many cold dishes placed at once. Lid not used on dishes.	Increase the temperature setting. Allow more time for warming or reduce the number of items. Cover dishes with lids to retain heat more effectively.
Appliance turns off unexpectedly.	Automatic 3-hour shut-off activated. Timer setting expired.	This is a safety feature. Restart the appliance if further warming is needed. Check the timer setting. If it expired, restart the appliance and set a new timer or operate without a timer.
Control buttons are unresponsive.	Safety lock is active.	Press the Lock Button to deactivate the safety lock.

If the problem persists after trying these solutions, please contact DiDimo customer support.

8. SPECIFICATIONS

Feature	Detail
Brand	DiDimo
Model	JN-N01A
Color	Blue
Product Dimensions	61P x 40.6l x 2.5H cm (approx. 24 x 16 x 1 inches)
Material	Silicone
Wattage	300.00 Watts
Voltage	220 Volts

Feature	Detail
Temperature Settings	17 (40°C to 120°C / 104°F to 248°F)
Timer Range	1 to 180 minutes
Special Features	Programmable, Automatic Shut-off (3 hours), Safety Lock
Item Weight	1.32 Kilograms (approx. 2.9 lbs)

9. WARRANTY AND CUSTOMER SUPPORT

DiDimo products are manufactured to high-quality standards. For information regarding warranty coverage, please refer to the warranty card included with your purchase or visit the official DiDimo website.

If you have any questions, require technical assistance, or need to report a problem with your product, please contact DiDimo customer support:

- **Website:** www.didimo.com (Placeholder link, please refer to actual product documentation for correct URL)
- **Email:** support@didimo.com (Placeholder email, please refer to actual product documentation for correct address)

Please have your model number (JN-N01A) and purchase date ready when contacting support.