

TRANYA ES11

Tranya ES11 Smartwatch User Manual

Model: ES11

1. INTRODUCTION

Thank you for choosing the Tranya ES11 Smartwatch. This device combines style and technology to enhance your daily life and fitness journey. With its 1.47-inch HD touch screen and sleek design, it fits comfortably on your wrist. The IP68 water-resistant design, coupled with precise activity monitoring, makes it an excellent choice for sports enthusiasts and anyone seeking to stay connected and track their health.



Image: Front view of the Tranya ES11 Smartwatch.

2. WHAT'S IN THE BOX?

Before you begin, please ensure all components are present in your Tranya ES11 Smartwatch package:

- Tranya ES11 Smartwatch (with strap)
- Magnetic Charging Cable
- User Manual / Quick Start Guide



Image: The Tranya ES11 Smartwatch, its magnetic charging cable, and a small instruction card.

For additional support and resources, you may scan the QR code found on the included guide or visit the official support page: <https://qrco.de/bbTuUU>

3. SETUP

3.1 Initial Charging

Before first use, fully charge your Tranya ES11 Smartwatch. Connect the magnetic charging cable to the charging points on the back of the watch and plug the USB end into a standard USB power adapter (not included) or a computer's USB port.

- Charging Time: Approximately 1 hour for a full charge.
- Battery Life: Up to 5-7 days on a single charge, depending on usage.

Mais detalhes do produto



IP68 à prova
d'água



Relógio fino e leve



1.47 Polegadas
172x320
Pixels Resolução



Image: The Tranya ES11 Smartwatch being charged with its magnetic cable.

3.2 App Installation and Pairing

To unlock the full potential of your Tranya ES11, download and install the companion app on your smartphone. The app is typically named "GloryFit" and can be found on your device's app store (Google Play Store for Android, Apple App Store for iOS).

1. Download the "GloryFit" app from your smartphone's app store.
2. Open the app and follow the on-screen instructions to create an account or log in.
3. Ensure Bluetooth is enabled on your smartphone.
4. In the app, navigate to the device pairing section and search for your Tranya ES11.
5. Select "ES11" from the list of available devices to initiate pairing.
6. Confirm the pairing request on both your smartphone and the smartwatch if prompted.

4. OPERATING THE SMARTWATCH

4.1 Basic Navigation

The Tranya ES11 features a responsive touch screen for easy navigation:

- **Swipe Up/Down:** Scroll through menus and notifications.
- **Swipe Left/Right:** Access quick functions or different data screens.
- **Tap:** Select an item or confirm an action.
- **Side Button:** Press to wake the screen, return to the home screen, or access the main menu.

4.2 Activity Tracking

The ES11 accurately tracks your daily activities and exercise sessions:

- **Steps, Distance, Calories:** The watch automatically records your steps, calculates distance covered, and estimates calories burned throughout the day.
- **Exercise Modes:** Select from over 24 exercise modes, including outdoor running, cycling, skipping, and badminton, for detailed tracking of your workouts.

Suor, saúde e estilo





24+
Modo de
exercício





Passos &
Distância



Contagem
de calorias



Image: The Tranya ES11 Smartwatch showing different exercise modes.

Descanse melhor, viva mais leve

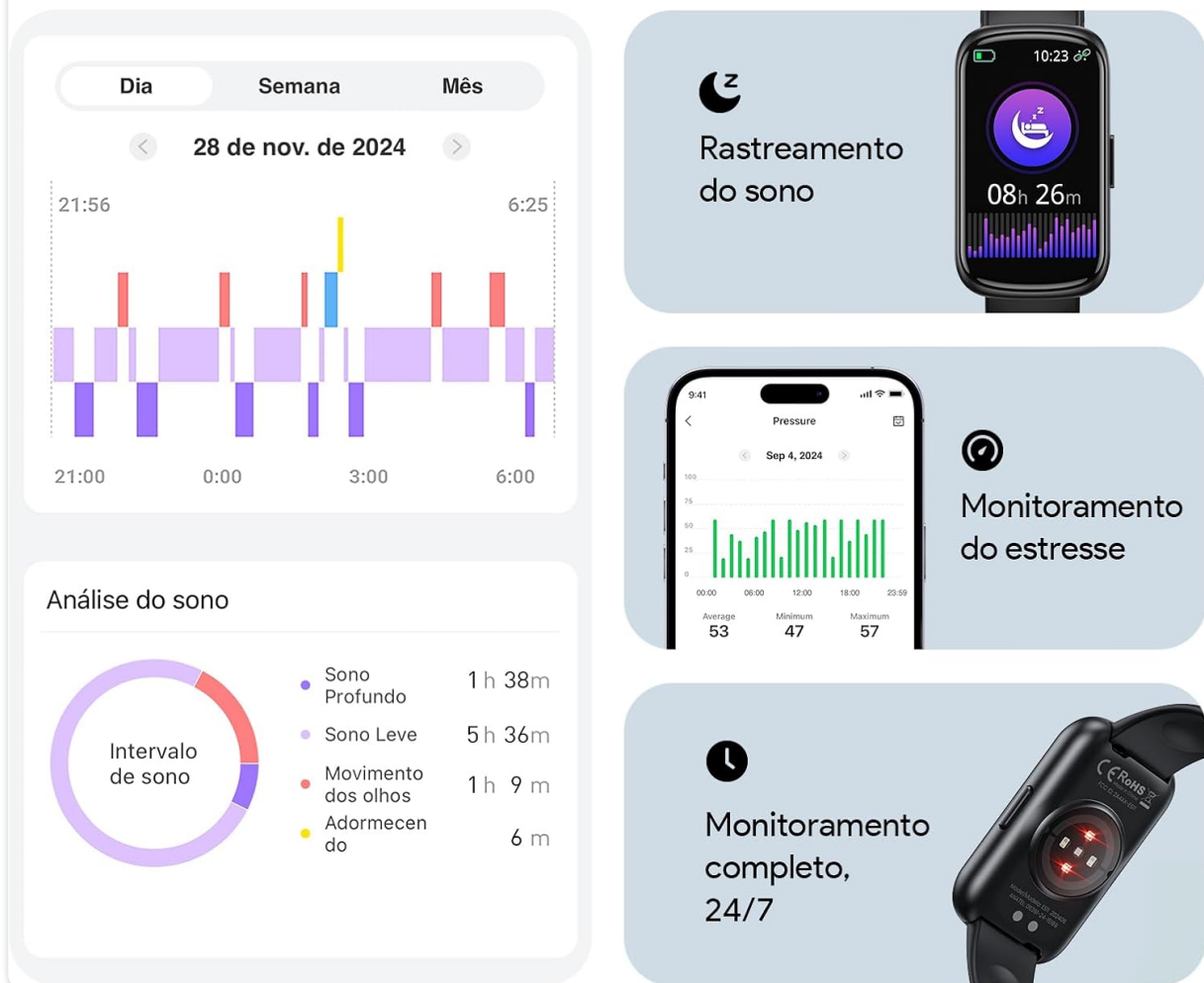

Image: The Tranya ES11 Smartwatch displaying steps, distance, and calorie count.

4.3 Health Monitoring

Monitor your well-being with the ES11's health tracking features:

- **Sleep Tracking:** The watch monitors your sleep patterns, including deep sleep, light sleep, and REM, providing insights into your sleep quality.
- **Stress Monitoring:** Track your stress levels throughout the day to help manage your mental well-being.

Estilo e tecnologia em perfeita harmonia



Lembrete de
chamada

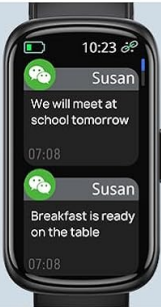

Notificações de
mensagens
e apps



Lembrete de
inatividade

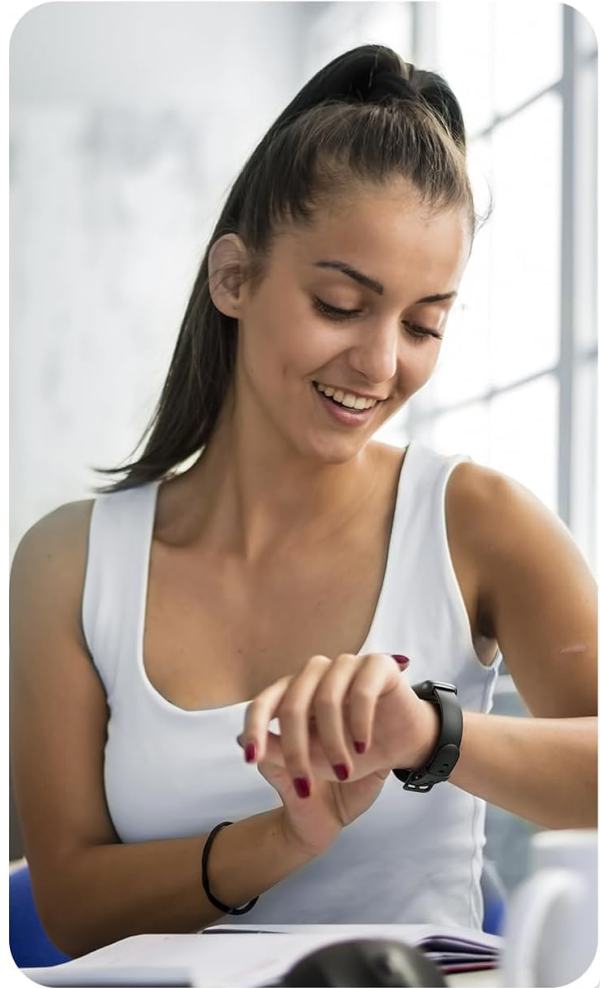

Image: The Tranya ES11 Smartwatch showing sleep analysis and stress monitoring.

4.4 Notifications

Stay connected with instant notifications directly on your wrist:

- Receive alerts for incoming calls, messages, and social media updates.
- The watch also provides inactivity reminders to encourage movement.



5-7 Dias
Duração da
bateria



1 Hora
Tempo de
carregamento

Image: The Tranya ES11 Smartwatch showing call, message, and inactivity notifications.

4.5 Other Useful Functions

The Tranya ES11 includes several convenient features:

- **Stopwatch:** For timing activities.
- **Weather:** Get real-time weather updates.
- **Alarm:** Set alarms to wake up or for reminders.
- **Music Control:** Control music playback on your connected smartphone.

O que tem dentro da caixa?



Image: The Tranya ES11 Smartwatch showing various utility functions.

5. MAINTENANCE

5.1 Water Resistance (IP68)

The Tranya ES11 is IP68 water-resistant, meaning it can withstand submersion in water up to 1.5 meters for up to 30 minutes. It is suitable for daily use, including hand washing, rain, and shallow water activities. However, it is not recommended for hot showers, saunas, or diving, as steam and high temperatures can affect the seals.

Mais funções úteis

Cronômetro



Clima



Despertador



Controle de Música



Image: The Tranya ES11 Smartwatch demonstrating its IP68 water resistance.

5.2 Cleaning and Care

- Regularly clean your smartwatch and strap with a soft, damp cloth.
- Avoid using harsh chemicals or abrasive materials, as these can damage the device.
- Ensure the charging contacts are clean and dry before charging to prevent corrosion.
- Store the watch in a cool, dry place when not in use.

6. TROUBLESHOOTING

If you encounter any issues with your Tranya ES11 Smartwatch, please refer to the following common solutions:

Issue	Possible Solution
Watch not turning on	Ensure the watch is fully charged. Connect it to the charger for at least 10 minutes.

Issue	Possible Solution
Unable to pair with phone	Ensure Bluetooth is enabled on your phone. Restart both the watch and your phone. Make sure the watch is within Bluetooth range. Check if the "GloryFit" app is updated.
Inaccurate activity data	Ensure the watch is worn snugly on your wrist. Calibrate the app settings if available.
Notifications not received	Check app notification permissions on your phone. Ensure the watch is connected via Bluetooth. Verify notification settings within the "GloryFit" app.
Screen unresponsive	Restart the watch by pressing and holding the side button until it powers off, then power it back on.

If the issue persists after trying these steps, please contact Tranya customer support for further assistance.

7. SPECIFICATIONS

Feature	Specification
Model	ES11
Display	1.47-inch HD Touch Screen (172x320 pixels)
Water Resistance	IP68
Battery Life	5-7 Days (typical usage)
Charging Time	Approx. 1 Hour
Connectivity	Bluetooth
Operating System	Tranya OS
Memory Capacity	127.98 MB
Battery Capacity	190 mAh (Amperes Hours)
Product Weight	110 g
Compatible Devices	Smartphone
Certification	ANATEL: 06391-24-15189



8. WARRANTY AND SUPPORT

The Tranya ES11 Smartwatch comes with a standard manufacturer's warranty. Please refer to the warranty card included in your product packaging for specific terms and conditions, including coverage duration and claim procedures.

For technical support, product inquiries, or warranty claims, please visit the official Tranya support website or contact their customer service. The QR code provided in the "What's in the Box?" section links to additional support resources.

Please retain your proof of purchase for warranty purposes.

Related Documents

	<p>Tranya ES11 Smart Band User Manual</p> <p>User manual for the Tranya ES11 Smart Band, covering product introduction, connection, operation, functions, charging, FAQs, and safety instructions.</p>
	



[Tranya ES11 Smart Band User Manual - Setup, Connection, and Operation Guide](#)

Comprehensive user manual for the Tranya ES11 Smart Band, covering setup, device connection, app installation, operation, and features. Learn how to pair your device, manage settings, and use its functions.

1. **CONEXÃO DO DISPOSITIVO**
Após a conexão, siga as instruções para conectar seu dispositivo inteligente.

2. **CONEXÃO DO DISPOSITIVO**
Após a conexão, siga as instruções para conectar seu dispositivo inteligente.

3. **CONEXÃO DO DISPOSITIVO**
Após a conexão, siga as instruções para conectar seu dispositivo inteligente.

4. **CONEXÃO DO DISPOSITIVO**
Após a conexão, siga as instruções para conectar seu dispositivo inteligente.

5. **CONEXÃO DO DISPOSITIVO**
Após a conexão, siga as instruções para conectar seu dispositivo inteligente.

6. **CONEXÃO DO DISPOSITIVO**
Após a conexão, siga as instruções para conectar seu dispositivo inteligente.

7. **CONEXÃO DO DISPOSITIVO**
Após a conexão, siga as instruções para conectar seu dispositivo inteligente.

8. **CONEXÃO DO DISPOSITIVO**
Após a conexão, siga as instruções para conectar seu dispositivo inteligente.

9. **CONEXÃO DO DISPOSITIVO**
Após a conexão, siga as instruções para conectar seu dispositivo inteligente.

10. **CONEXÃO DO DISPOSITIVO**
Após a conexão, siga as instruções para conectar seu dispositivo inteligente.

11. **CONEXÃO DO DISPOSITIVO**
Após a conexão, siga as instruções para conectar seu dispositivo inteligente.

12. **CONEXÃO DO DISPOSITIVO**
Após a conexão, siga as instruções para conectar seu dispositivo inteligente.

13. **CONEXÃO DO DISPOSITIVO**
Após a conexão, siga as instruções para conectar seu dispositivo inteligente.

14. **CONEXÃO DO DISPOSITIVO**
Após a conexão, siga as instruções para conectar seu dispositivo inteligente.

15. **CONEXÃO DO DISPOSITIVO**
Após a conexão, siga as instruções para conectar seu dispositivo inteligente.

[illegible]

Put the screen into landscape mode when you place it on the screen and then slide it into place.

After the screen is in the position of the display, do not touch the screen, do not touch the screen, do not touch the screen.

CHARGE YOUR WATCH

Connect the USB charging cable with the watch according to the picture.



WEARING

Wear the device with a finger 10mm from the wrist bone and adjust the tightness of the wrist band to a comfortable position.



POWER ON/OFF

Long press the button on the upper right for 4-5 seconds to power on/off.

INSTALL THE APP



PERSONAL INFORMATION AND EXERCISE GOALS



DEVICE CONNECTION

Before connecting, ensure the following method:



DEVICE CONNECTION

Then follow the below steps to connect your smart watch:

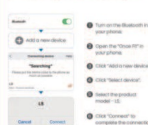

Note: If you can't find "GT" in step 1, please check whether the device has been selected in the Bluetooth of your mobile phone. If so, please click "Ignore GT" and search again.

BLUETOOTH CALL FUNCTION CONNECTION

1. After connecting the phone with the watch, you will be prompted to pair with Audio Bluetooth (BT) and click "Pair" to connect.

2. On iPhone (iOS 10 and above) and some Android Phones, after pairing the app with the watch, manually go to Settings -> Bluetooth -> search for Audio Bluetooth (BT) and click "Pair" to connect. The call function will work after successful pairing.

TIPS

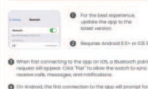

TIP

1. During pairing, ensure your phone's network, GPS, and Bluetooth are on and in a stable connection between the watch and phone.

2. If you can't find the device or if connection is slow, try turning the watch off and on again. If it doesn't work, try restarting the phone. If it still doesn't work, try restarting the device.

OPERATION

1. Press your hand on the button on the upper right to light up the screen.

2. The screen will turn off without operation in 10 seconds by default. You can modify this default value in the smart watch.

3. The watch will automatically turn on and off by itself. You can turn it off in the settings.

4. Press the button on the upper right at any time to turn on the watch.

DATA SYNCHRONISM

The watch will store 1 day of GT data, and you can synchronize the data to the app manually. The maximum storage for synchronization is 10 days. The data will be deleted after 10 days.

NOTIFICATION

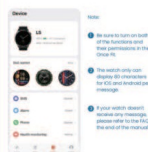

PHYSICAL HEALTH

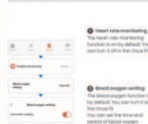

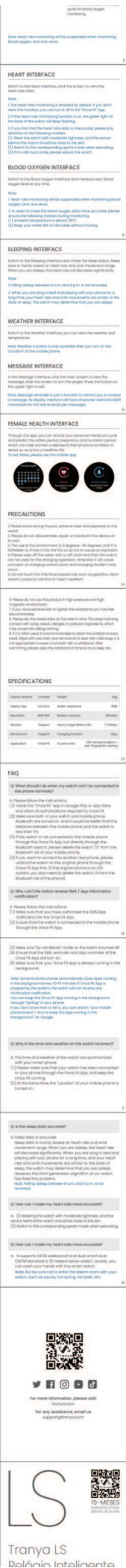

Tranya LS Smart Watch User Manual

User manual for the Tranya LS Smart Watch (V20240705). Covers package contents, band replacement, charging, wearing, power operations, app installation, device connection (including Bluetooth calls), data synchronization, notifications, physical health monitoring (heart rate, blood oxygen, sleep, weather, female health), precautions, specifications, and FAQs.

V20240705

Smart Support@honor.com
honor.com/honorh2

CONTÉUDO DA CAIXA



Relógio inteligente H2



Manual do usuário H2



Cabo de Carregamento H2

SUBSTITUA A PULSEIRA

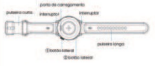

Entenda o funcionamento, ajuste funcionalidade, ajuste inicial, ajuste.

Se você encontrar algum problema ao usar o relógio, consulte as páginas de suporte e suporte ao cliente. Se você encontrar algum problema ao usar o relógio, consulte as páginas de suporte e suporte ao cliente.

CARREGUE SEU RELÓGIO

Conecte o cabo de carregamento USB ao relógio conforme a imagem.

Quando o dispositivo estiver conectado, o ícone de carregamento será exibido.



USO

Use o dispositivo com a distância de um dedo do dedo do dedo.



LIGAR/DESLIGAR

Pressione e segure o botão no canto superior direito por 5 segundos para ligar/desligar.

INSTALAR O APLICATIVO



Se você não quiser instalar o aplicativo, vá para a página de suporte e suporte ao cliente.

INFORMAÇÕES PESSOAIS E METAS DE EXERCÍCIO



CONEXÃO DO DISPOSITIVO

Antes de conectar, verifique se o dispositivo está ligado.



CONEXÃO DO DISPOSITIVO

Se você não quiser conectar o dispositivo, vá para a página de suporte e suporte ao cliente.

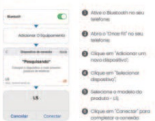

Nota: Se você não quiser conectar o dispositivo, vá para a página de suporte e suporte ao cliente.

CONTROLE DA FUNÇÃO DE CHAMADA VIA BLUETOOTH

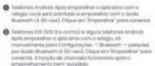

DICA



Se você não quiser conectar o dispositivo, vá para a página de suporte e suporte ao cliente.

DICA

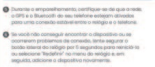

OPERAÇÃO

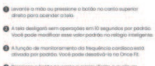



SINCRONIZAÇÃO DE DADOS

Se você não quiser sincronizar os dados, vá para a página de suporte e suporte ao cliente.

NOTIFICAÇÃO



[illegible]

	
	<p>Tranya X3 Sports Open Earbuds User Manual</p> <p>Comprehensive user manual for Tranya X3 Sports Open Earbuds, covering setup, smart touch controls, charging, troubleshooting, and FAQs.</p>

Documents - TRANYA – ES11



[Tranya ES11 Smart Band User Manual](#)

User manual for the Tranya ES11 Smart Band, covering product introduction, connection, operation, functions, charging, FAQs, and safety instructions.

lang:en score:31 filesize: 4.54 M page_count: 2 document date: 2024-07-04