

## GREADIO D11

# Greadio Portable DAB/DAB+/FM Solar Radio User Manual

Model: D11

## 1. INTRODUCTION

---

This stylish and all-in-one DAB radio utilizes the latest DAB+ and FM technology, offering easy setup and fast auto-scanning to automatically search and save up to 80 available radio stations (40 DAB and 40 FM). Its extra-long antenna ensures clear listening indoors or outdoors. Featuring a military-inspired design, the upgraded and innovative materials enhance its durability and robustness.

This manual provides detailed instructions for the operation, maintenance, and troubleshooting of your Greadio Portable DAB/DAB+/FM Solar Radio with Bluetooth 5.3.

## 2. WHAT'S IN THE BOX

---

- DAB/DAB+/FM Radio
- Type-C Cable
- Owner's Manual

## 3. PRODUCT OVERVIEW

---

Familiarize yourself with the components of your Greadio radio.



Figure 3.1: Front view of the Greadio Portable Radio, showing the display, speaker, and controls.



Figure 3.2: Side view highlighting key features and dimensions including DAB+/FM Radio, Bluetooth 5.3, USB Driver, TF/SD Card slot, Flashlight, Earphone Jack, White Noise function, 4000mAh battery, and SOS alarm.





Figure 3.3: Rear view showing the solar panel, hand crank, Type-C charging port, USB port, and TF/SD card slot.

## 4. SETUP

### 4.1 Initial Charging

Before first use, it is recommended to fully charge the radio. The radio features a built-in 4000mAh rechargeable battery.

1. **Type-C Charging:** Connect the supplied Type-C cable to the radio's Type-C port and a compatible USB power adapter (not included).
2. **Solar Charging:** Place the radio with the solar panel facing direct sunlight. This method is ideal for maintaining charge or slow charging.
3. **Hand-Crank Charging:** Rotate the hand crank on the back of the radio. Rotate for 3-5 minutes to activate the battery if the radio cannot be turned on due to battery protection.

# 4000mAh Rechargeable Battery

The battery can last for 16 hours.



Figure 4.1: Illustration of the three charging methods: Hand Crank, Solar Charge, and Type-C Charge, highlighting the 4000mAh rechargeable battery.

## 4.2 Antenna Extension

Extend the telescopic antenna for optimal radio reception. The antenna extends up to 7 inches.



# Up To 80 Preset Stations

40 FM Mode, 40 DAB Mode



Figure 4.2: The radio with its 7-inch extended antenna, showing FM (87.5-108MHz) and DAB (168-240MHz) frequency ranges and the ability to store up to 80 preset stations.

## 5. OPERATING INSTRUCTIONS

### 5.1 Power On/Off

Press and hold the power button to turn the radio on or off.

### 5.2 Radio Mode (DAB/DAB+/FM)

Press the "Mode" button to switch between DAB/DAB+ and FM radio modes.

- **Auto Scan:** In radio mode, press the "Scan" button to automatically search and save available stations. The radio can store up to 40 DAB and 40 FM stations.
- **Manual Tuning:** Use the tuning knob or navigation buttons to manually tune to desired frequencies.
- **Preset Stations:** Recall saved stations using the preset buttons or navigation.

## 5.3 Bluetooth Mode

The radio features Bluetooth 5.3 for wireless audio streaming.

1. Switch the radio to Bluetooth mode using the "Mode" button.
2. On your device (e.g., smartphone, tablet), enable Bluetooth and search for "Greadio D11".
3. Select "Greadio D11" to pair. A confirmation sound will indicate successful pairing.

The maximum connection distance for Bluetooth is approximately 26 feet (8 meters).



Figure 5.1: The radio connected via Bluetooth 5.3 to a smartphone, demonstrating its wireless audio streaming capability.

## 5.4 USB & TF/SD Card Playback

Insert a USB flash drive or TF/SD card (up to 256GB) into the respective slot to play audio files.

- Supported formats include MP3, WAV, APE, and FLAC.
- Use the navigation buttons to browse and select tracks.



## 5.5 White Noise Function

The radio offers eight types of white noise to aid relaxation and sleep.

- Access the white noise function through the menu or a dedicated button (refer to device specific controls).
- Select from various sounds such as firewood, thunderstorms, oceans, streams, birdsong, cicadas, music, and wind chimes.



**HIFI Sound & Sleep Timer**

**8 TYPES OF WHITE NOISE**  
This radio has 8 high quality white noises to help you better drift to sleep.

**HIGH QUALITY SPEAKER**  
Built-in 5W high-quality bass speaker, which makes the radio sound clear and thick.

**SLEEP TIMER**  
Set a sleep time of 15-90 minutes, help the radio save power and protects the battery.

Figure 5.2: A person sleeping peacefully with the radio nearby, illustrating the white noise feature and its eight sound options.

## 5.6 Flashlight and SOS Alarm

The radio includes a built-in flashlight and an SOS alarm for emergency situations.

- **Flashlight:** Activate the flashlight via its dedicated button. It provides illumination in dark environments.
- **SOS Alarm:** Press the SOS button to activate a loud alarm and flashing light, signaling for help.

## 5.7 USB Output (Power Bank Function)



The radio can be used to charge external devices.

- Connect your device to the radio's USB output port.
- Ensure the radio has sufficient charge.

## 6. MAINTENANCE

- **Cleaning:** Use a soft, dry cloth to clean the radio's surface. Avoid using abrasive cleaners or solvents.
- **Storage:** Store the radio in a cool, dry place away from direct sunlight and extreme temperatures.
- **Battery Care:** To prolong battery life, avoid fully discharging the battery frequently. If storing for extended periods, charge the battery to approximately 50% every few months.

## 7. TROUBLESHOOTING

Problem	Possible Cause	Solution
Radio does not turn on.	Battery protection mode activated.	Hand-crank the radio for 3-5 minutes to activate the battery. Ensure the battery is charged.
Poor radio reception.	Antenna not fully extended or weak signal area.	Fully extend the telescopic antenna. Move to an area with better signal reception.
Bluetooth connection issues.	Device too far, not in pairing mode, or interference.	Ensure devices are within 26 feet. Re-enter Bluetooth pairing mode on the radio and your device. Reduce interference.
USB/SD card not playing.	Unsupported file format or card not inserted correctly.	Ensure files are MP3, WAV, APE, or FLAC. Reinsert the card/USB drive. Check card capacity (max 256GB).

## 8. SPECIFICATIONS



Feature	Detail
Model Number	D11
Dimensions	8.1L x 5.2W x 13.2H cm
Weight	530 g
Battery	4000mAh Lithium Ion (included)
Charging Options	Type-C, Solar, Hand-Crank
Radio Bands	DAB+/DAB/FM (87.5-108MHz FM, 168-240MHz DAB)
Bluetooth Version	5.3
USB/TF/SD Card Support	Up to 256GB (MP3, WAV, APE, FLAC)
Speaker Output	5W
Special Features	Flashlight, SOS Alarm, White Noise, USB Output (Power Bank)

9. WARRANTY AND SUPPORT

Greadio offers a 12-month warranty and a 30-day money-back guarantee for this product.

For technical support or warranty claims, please contact Greadio customer service through the retailer's platform or visit the official Greadio store on Amazon: [Greadio Amazon Store](#).

Related Documents - D11

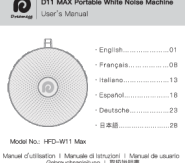
 <p>仅限APP使用 App only APP Download</p> <p>Not waterproof and cannot come into contact with water; If it comes into contact with water, it needs to be treated immediately.</p>	<p><a href="#">D11 Smartwatch User Manual and Connection Guide</a></p> <p>Comprehensive guide for the D11 smartwatch, covering initial setup, app connection, Bluetooth pairing, earphone usage, NFC functionality, troubleshooting, and specifications. Learn how to connect and use your D11 smartwatch effectively.</p>
	<p><a href="#">Greadio GR-090P Owner's Manual: Features, Operation, and Specifications</a></p> <p>Comprehensive guide to the Greadio GR-090P emergency weather radio, covering radio operation, SOS alarm, flashlight, reading lamp, motion sensor, charging methods (solar, hand crank, USB), battery protection, specifications, and warranty.</p>
	<p><a href="#">Dreamegg D11 Portable White Noise Machine User's Manual</a></p> <p>User's manual for the Dreamegg D11 Portable White Noise Machine, covering package contents, technical information, safety guidelines, operation, charging, sound selection, night light, volume adjustment, timer functions, child lock, memory function, warranty, and customer service.</p>
	<p><a href="#">Dreamegg D11 MAX Portable White Noise Machine User Manual</a></p> <p>User manual for the Dreamegg D11 MAX Portable White Noise Machine, covering package contents, technical specifications, safety information, usage instructions, warranty, and customer support.</p>



仅限APP使用



App only  
APP Download

Not waterproof and cannot come into contact with water; if it comes into contact with water, it needs to be treated immediately.

### [D11 Smartwatch User Manual and Connection Guide](#)

Comprehensive guide for the D11 smartwatch, covering initial setup, app connection, Bluetooth pairing, earphone usage, NFC functionality, troubleshooting, and specifications. Learn how to connect and use your D11 smartwatch effectively.

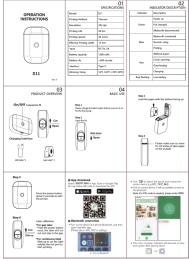

### [PikDik D11 Mini Label Maker: Operation Manual and Guide](#)

Comprehensive guide for the PikDik D11 mini label maker, covering specifications, basic operation, troubleshooting, warnings, and support. Learn how to print labels efficiently with this portable device.