

AUTOONE JS02

AUTOONE 6000A Car Battery Jump Starter User Manual

Model: JS02 | Brand: AUTOONE

1. INTRODUCTION AND PACKAGE CONTENTS

The AUTOONE JS02 is a powerful and portable car battery jump starter designed for emergency vehicle starts. It also functions as a versatile power bank for your electronic devices and includes an integrated LED flashlight for convenience and safety.

What's in the Box

- JS02 Jump Starter Unit
- Smart Jumper Cables
- USB-C Charging Cable
- High-Quality EVA Protection Case
- User Manual (this document)

WHAT'S IN THE BOX



Figure 1: All items included in the AUTOONE JS02 Jump Starter package.

2. SETUP AND INITIAL CHARGING

Before first use, it is crucial to fully charge your AUTOONE JS02 Jump Starter to ensure optimal performance and battery longevity. Use the provided USB-C charging cable to charge the unit.

Charging the Unit

1. Connect the USB-C charging cable to the 'In (Out)' port on the jump starter.
2. Connect the other end of the USB-C cable to a compatible USB wall adapter (not included) or a powered USB port.

3. The LED indicator lights on the unit will illuminate to show the charging progress. All lights will be solid when fully charged.

TIP: For optimal performance, please fully charge the device before its first use. This will ensure the jump starter works properly when you need it most.



Figure 2: The JS02 unit features multiple output ports for charging various devices.

3. OPERATING INSTRUCTIONS

Jump Starting a Vehicle

The AUTOONE JS02 is designed to jump start any 12V vehicle, including all gasoline and 12L diesel engines, with a peak current of 6000 amps.

1. Ensure the jump starter is fully charged.
2. Connect the smart jumper cables to the jump starter unit. Ensure a secure connection.
3. Connect the red (+) clamp to the positive terminal of the vehicle's battery.
4. Connect the black (-) clamp to the negative terminal of the vehicle's battery.
5. Wait for the indicator on the smart jumper clamp to turn green, indicating a safe and ready connection.
6. Start your vehicle's engine.
7. Once the engine starts, immediately remove the jumper clamps from the vehicle battery, then disconnect the cables from the jump starter unit.

BACK ON THE ROAD IN TWO MINUTES



① Insert the Cable to the Starter

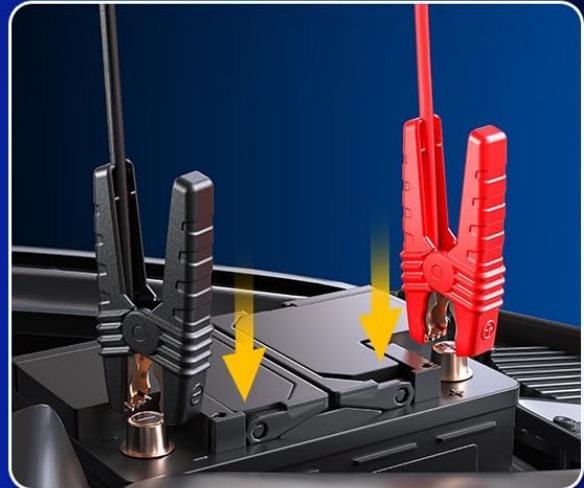

**② Connect the Clamps to
Battery Polarities**



**③ Wait for the Indicator
to Turn Green**



④ Start Engine

Figure 3: Visual guide for the jump starting process.

Your browser does not support the video tag.

Video 1: Official demonstration of the AUTOONE JS02 Jump Starter in action, reviving a dead car battery.

Using as a Power Bank

The JS02 features dual USB output ports, including one for quick charging, allowing you to charge smartphones, tablets, and other USB-powered devices.

- Connect your device's USB charging cable to one of the USB output ports on the jump starter.
- The jump starter will automatically begin charging your device.

Using the LED Flashlight

The integrated LED flashlight offers three modes for various situations:

- **Flashlight Mode:** Provides steady illumination for general use.
- **SOS Mode:** Emits a Morse code SOS signal for emergency situations.
- **Strobe Mode:** Produces a rapid flashing light for signaling or attracting attention.

To activate the flashlight, press and hold the power button for approximately 3 seconds. Press the power button momentarily to cycle through the different modes. Press and hold again to turn off.

EMERGENCY FLASHLIGHT



FLASHLIGHT
MODE



SOS
MODE



STROBE
MODE



Figure 4: The multi-mode LED flashlight provides illumination and emergency signaling.

4. SAFETY INFORMATION

The AUTOONE JS02 is equipped with an intelligent jumper clamp that provides 10 layers of safety protection to ensure user safety and protect the device and vehicle.

- **Overcharging Protection:** Prevents battery damage from excessive charging.
- **Over-discharge Protection:** Protects the internal battery from being fully depleted.
- **Overcurrent Protection:** Safeguards against excessive current flow.
- **Short Circuit Protection:** Automatically cuts off power in case of a short circuit.

- **Reverse Polarity Protection:** Prevents damage if clamps are connected incorrectly.
- **Power Surge Protection:** Shields against sudden voltage spikes.
- **Sparking Protection:** Minimizes the risk of sparks during connection.
- **Overheat Protection:** Prevents the unit from overheating during operation.
- **Reverse Connection Protection:** Ensures correct connection before operation.
- **Low Voltage Protection:** Prevents operation if the unit's internal battery is too low.



Figure 5: The intelligent jumper clamp provides comprehensive safety features.

5. MAINTENANCE AND STORAGE

Proper maintenance and storage will extend the life of your AUTOONE JS02 Jump Starter.

Recharging

It is recommended to recharge the jump starter every 3-6 months, even if not used, to maintain its internal battery health. The unit boasts an impressive 48-month standby time, but periodic recharging is still beneficial.

Cleaning and Storage

- Clean the unit with a soft, dry cloth. Do not use harsh chemicals or abrasive materials.
- Store the jump starter and all accessories in the provided high-quality EVA protection case.
- Keep the unit in a cool, dry place, away from direct sunlight, heat sources, and moisture.
- The compact size allows it to fit neatly in armrests or small storage pockets in your vehicle.

"JUST IN CASE"



Figure 6: The included EVA case provides convenient and safe storage.

6. TROUBLESHOOTING

If you encounter issues with your AUTOONE JS02 Jump Starter, please refer to the following common solutions:

- **Unit not turning on:** Ensure the unit is fully charged. If the battery is completely depleted, it may take a few minutes of charging before the indicator lights appear.
- **Vehicle not starting:**
 - Check that the smart jumper cables are securely connected to both the jump starter and the vehicle

battery terminals.

- Ensure the red (+) clamp is on the positive terminal and the black (-) clamp is on the negative terminal.
 - Verify that the indicator light on the smart clamp is green before attempting to start the vehicle.
 - If the vehicle's battery is severely damaged or completely dead, multiple attempts or a longer connection time may be required.
- **Device not charging from USB ports:** Ensure the jump starter unit is powered on and has sufficient charge. Try a different USB cable or port.

If the problem persists after following these steps, please contact customer support for further assistance.

7. SPECIFICATIONS

Feature	Specification
Brand	AUTOONE
Model	JS02
Peak Current	6000 Amps
Engine Compatibility	All Gas & 12L Diesel Engines (12V vehicles)
Battery Type	Lithium Polymer
Product Dimensions	9.65"D x 5.12"W x 4.13"H
Item Weight	0.5 Kilograms (1.1 pounds)
USB Output	Dual USB (one quick charging)
Standby Time	Up to 48 months
Safety Protections	10 layers (Overcharging, Short Circuit, Reverse Polarity, etc.)
Flashlight	LED with Flashlight, SOS, and Strobe modes

8. WARRANTY AND SUPPORT

AUTOONE stands behind the quality of its products. The JS02 Jump Starter comes with comprehensive support:

- **Warranty:** Backed by a 48-month warranty.
- **After-Sales Support:** 24-hour online after-sales support.
- **Technical Assistance:** Lifetime technical assistance.

For any inquiries or support needs, please refer to the contact information provided in your physical user manual or visit the official AUTOONE website.

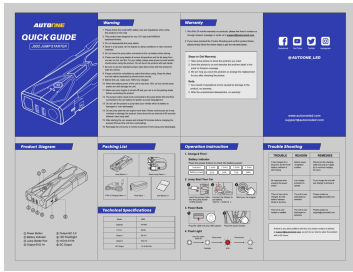

[AUTOONE JS02 Jump Starter Quick Guide: Operation, Safety & Troubleshooting](#)

A concise and SEO-optimized guide to the AUTOONE JS02 Jump Starter. This document provides essential information on product features, operation instructions, packing list, technical specifications, and troubleshooting tips for safe and effective use.

lang: **score:13** filesize: 2.46 M page_count: 1 document date: 2024-09-11