

Manuals.plus /

› Acquaer /

› Acquaer Shallow Well Jet Pump (Model CCJC, 1HP) Instruction Manual

## Acquaer CCJC

# Acquaer Shallow Well Jet Pump (Model CCJC, 1HP) Instruction Manual

Model: CCJC

## 1. INTRODUCTION

---

This manual provides essential information for the safe and efficient operation, installation, and maintenance of your Acquaer Shallow Well Jet Pump, Model CCJC. This 1HP electric motor pump is designed for wells up to 25 feet deep, providing strong suction and water flow. It is suitable for various applications including irrigation systems, sprinkler setups, gardens, and supplying water to homes or small farms.



Acquaer Shallow Well Jet Pump overview, highlighting its performance capabilities.

## 2. SAFETY INFORMATION

---



Please read and understand all safety warnings and instructions before installing, operating, or performing maintenance on this pump. Failure to follow these instructions may result in electric shock, fire, serious injury, or death.

- Always disconnect power before servicing the pump.
- Ensure proper grounding to prevent electrical shock.
- Do not operate the pump dry; always ensure it is primed with water before starting.
- Install the pump in a well-ventilated area, protected from freezing temperatures and direct sunlight.
- Use appropriate personal protective equipment (PPE) during installation and maintenance.

## 3. PRODUCT FEATURES

---

- **Powerful 1HP Motor:** Provides strong suction and high water flow, suitable for wells up to 25 feet deep.
- **Dual Voltage Operation (115V/230V):** The pump motor is designed to operate safely on either 115V or 230V power supplies. It is factory-set for 230V.
- **Automatic Overheat Protection:** An intelligent system automatically shuts off the pump if it runs out of water or the motor overheats, preventing damage and extending product life.
- **Automatic Pressure Switch:** Functions as a pressure booster, activating the pump when pressure drops below 20 PSI and deactivating it when pressure exceeds 40 PSI, ensuring consistent water supply. A pressure gauge is included on the casing for monitoring.
- **Durable Cast Iron Volute:** Constructed with a rugged cast iron casing for enhanced durability and reliable performance.

<p><b>Capacitor Motor</b></p> <p>High efficiency with strong suction and high flow.</p>		<p><b>High Quality</b></p> <p>Detailed installation manual &amp; professional advice on installation and maintenance.</p>
	<p><b>Caution</b></p> <p>Please select the correct voltage for the first time using</p>	

Key features including the capacitor motor, quality construction, and warranty information.

## 4. COMPONENTS OVERVIEW

Familiarize yourself with the main components of your Acquaer Shallow Well Jet Pump:



- **Priming Port:** Used to fill the pump with water before initial operation.
- **1" NPT Outlet:** Connection point for the discharge pipe.
- **1-1/4" NPT Inlet:** Connection point for the suction pipe from the well.
- **Voltage Box:** Contains the electrical connections and voltage selection switch.
- **Power Box:** Houses the motor's electrical components.
- **Pressure Gauge:** Displays the current water pressure.

## 5. SETUP AND INSTALLATION

### 5.1. Voltage Selection

Your pump is factory-set to 230V. If your power supply is 115V, you must adjust the voltage switch before initial use. Refer to the diagram below:



- **For 115V operation:** Ensure the switch is in the "115V" (down) position.
- **For 230V operation:** Ensure the switch is in the "230V" (up) position.

**CAUTION:** Please select the correct voltage for the first time using to prevent damage to the pump.

## 5.2. Priming the Pump

Before starting the pump for the first time or after it has been drained, it must be primed with water to ensure proper operation and prevent damage from dry running.

# PRIME THE PUMP

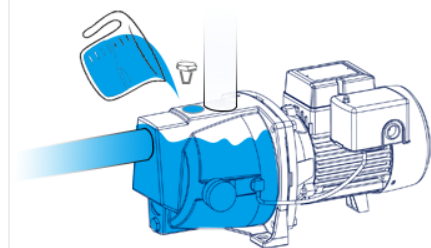

### Step 1

Unscrew the priming port and pour water into the cavity from the hole.

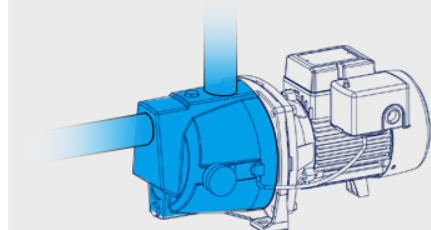

### Step 2

Until the cavity is fully filled with water, reinstall the cap and the pump is ready for startup.

1. **Step 1:** Unscrew the priming port cap located on the top of the pump casing. Carefully pour water into the cavity until it is completely full.

- Step 2:** Once the cavity is fully filled with water, reinstall the priming port cap securely. The pump is now ready for startup.

## 6. OPERATING INSTRUCTIONS

---

The Acquaer Shallow Well Jet Pump features an automatic pressure switch for convenient operation. Once properly installed and primed, the pump will manage water pressure automatically.

- The pump will automatically start when the system pressure drops below 20 PSI.
- The pump will automatically shut off when the system pressure reaches or exceeds 40 PSI.
- Monitor the built-in pressure gauge to observe system pressure.
- Ensure a continuous water supply to the pump inlet to prevent dry running.

## 7. MAINTENANCE

---

Regular maintenance ensures the longevity and optimal performance of your pump.

- **Winterization:** In areas subject to freezing temperatures, drain the pump completely to prevent damage. Disconnect power, open drain plugs, and remove the priming cap to allow all water to escape.
- **Inspect Connections:** Periodically check all pipe connections for leaks and tighten as necessary.
- **Clean Vents:** Ensure motor cooling vents are free from debris to prevent overheating.
- **Pressure Tank (if applicable):** If used with a pressure tank, regularly check the air pressure in the tank, ensuring it is 2 PSI below the pump's cut-in pressure.

## 8. TROUBLESHOOTING

---

If you encounter issues with your pump, refer to the following common troubleshooting steps:

Problem	Possible Cause	Solution
Pump does not start	No power; Incorrect voltage setting; Motor overload.	Check power supply; Verify voltage switch position; Allow motor to cool and reset.
Pump runs but no water	Pump not primed; Air leak in suction line; Well dry.	Re-prime the pump; Check all suction line connections; Check well water level.
Low pressure/flow	Partially clogged impeller; Air in system; Worn pump components.	Clean impeller; Bleed air from system; Inspect and replace worn parts.
Pump cycles too frequently	Leaking plumbing; Low air pressure in pressure tank.	Check for leaks and repair; Adjust pressure tank air charge.

If problems persist, contact qualified service personnel.

## 9. SPECIFICATIONS

---

Detailed technical specifications for the Acquaer Shallow Well Jet Pump, Model CCJC:

## TECHNICAL SPECIFICATIONS

**MODEL**  
SJC100-1

**DISCHARGE**  
1 inch NPT

**VOLTAGE**  
115 V/230 V

**HP**  
1.0 HP

**MAX HEAD**  
180'

**AMP**  
9.6 A/4.8 A

### GPH OF WATER @ FT. OF HEAD

5'	50'	100'	150'
1200	901	511	90



Specification	Value
Brand	Acquaer
Model Number	CCJC
Style	1HP
Material	Cast Iron
Voltage	115V/230V (Dual Voltage)
Power Source	Corded Electric
Maximum Lifting Height	180 Feet
Product Dimensions (L x W x H)	16" x 8" x 8"
Well Depth Capability	Up to 25 feet
Included Components	Shallow Well Pump

## 10. WARRANTY AND SUPPORT

Your Acquaer Shallow Well Jet Pump comes with a 24-month warranty, ensuring peace of mind regarding product quality and performance.

- **Warranty Period:** 24 months from the date of purchase.
- **Support:** For technical assistance, warranty claims, or service inquiries, please refer to the contact information provided with your product packaging or visit the official Acquaer website.

