



[Manuals.plus](#) /

› [INFANS](#) /

› INFANS HY10251 Kids Adjustable Table and 4 Chairs Set User Manual

## INFANS HY10251

# INFANS HY10251 Kids Adjustable Table and 4 Chairs Set User Manual

Model: HY10251 | Brand: INFANS

## 1. INTRODUCTION

---

Thank you for choosing the INFANS Kids Adjustable Table and 4 Chairs Set. This manual provides important information regarding the assembly, operation, maintenance, and safety of your new furniture set. Please read these instructions carefully before assembly and use, and retain them for future reference.

This set is designed to provide a versatile and comfortable space for children aged 18 months and older for various activities such as learning, drawing, crafts, and play. It features adjustable height settings for both the table and chairs to accommodate growing children, a unique graffiti-friendly tabletop, and a durable, safe construction.

## 2. IMPORTANT SAFETY INFORMATION

---

**WARNING: Failure to follow these safety instructions could result in injury.**

- Always supervise children when they are using the table and chairs.
- Ensure all parts are correctly assembled and securely fastened before use. Regularly check all fasteners to ensure they remain tight.
- Place the table and chairs on a stable, level surface to prevent tipping.
- Do not allow children to stand on the table or chairs.
- Do not place heavy objects on the table that could cause it to tip over.
- Keep the table and chairs away from heat sources, open flames, and direct sunlight to prevent material degradation.
- Inspect the product regularly for any signs of wear, damage, or loose parts. Discontinue use if damage is found and repair or replace components as necessary.
- This product is certified by ASTM and CPSIA, made from BPA-free PP material.

## 3. PACKAGE CONTENTS

---

Please verify that all components are present before beginning assembly.

- 1 x Table
- 4 x Chairs
- 1 x Instruction Manual
- Hardware (screws, tools if included)



**Figure 3.1:** Overview of the INFANS Kids Table and Chairs Set components and dimensions. The image shows the table and four chairs, with measurements indicating the table's length (47"), width (23.5"), and adjustable height range (18.9"-23.6"). Chair dimensions include seat width (12.5"), depth (12"), and adjustable seat height (10.2"-11.8").

## 4. ASSEMBLY INSTRUCTIONS

---

Assembly is required. Please follow these steps carefully. It is recommended to assemble the product on a soft, clean surface to prevent scratches.

### 4.1 Table Assembly

1. Unpack all table components and lay them out.
2. Attach the table legs to the tabletop. Ensure the adjustable leg sections are oriented correctly. Secure with the provided screws and tools.
3. Tighten all screws firmly, but do not overtighten.

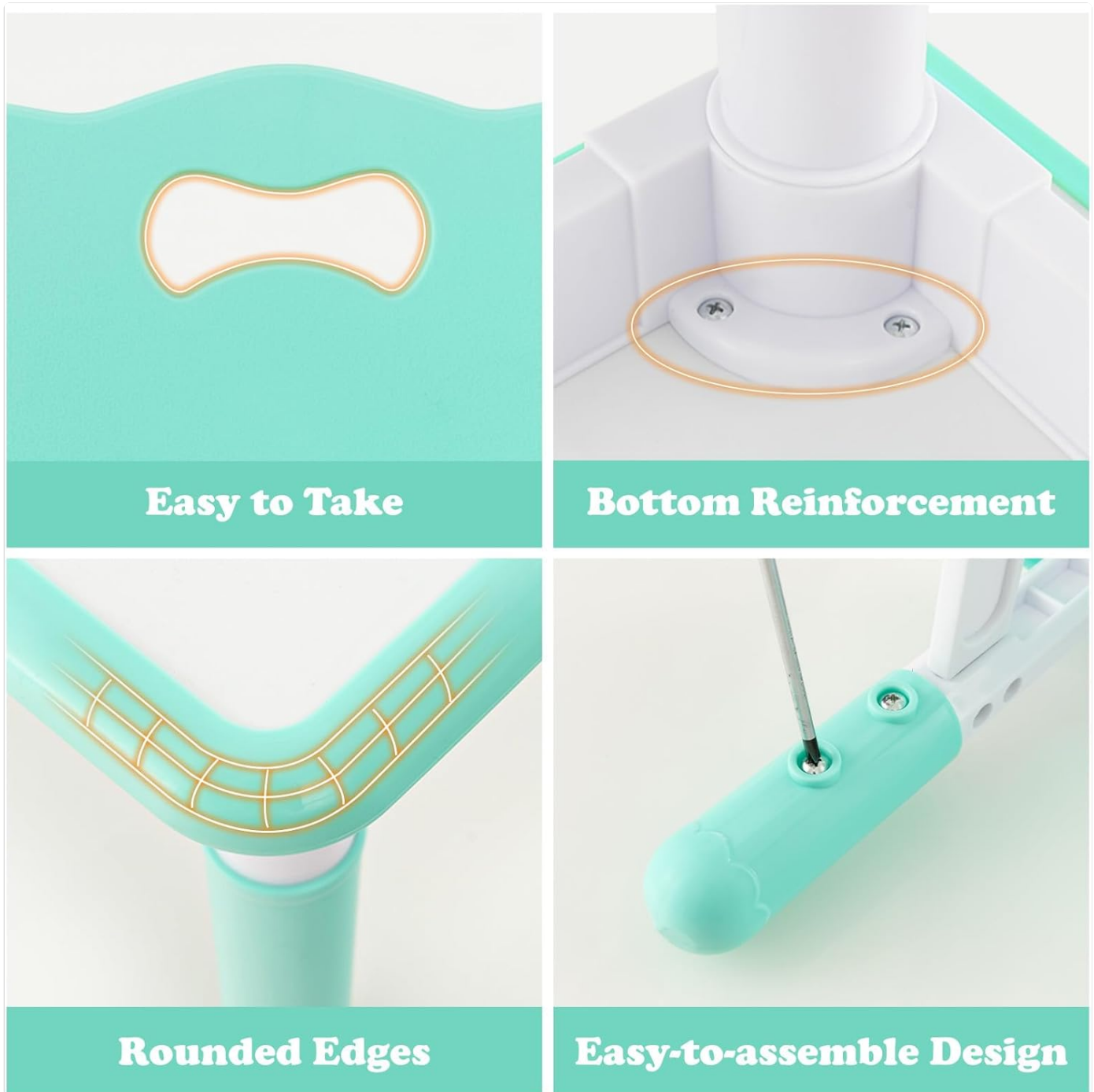

**Figure 4.1:** Detail showing the bottom reinforcement of the table legs with two screws at each corner for enhanced stability, and the rounded edges of the tabletop for safety. This image also illustrates the easy-to-assemble design.

## 4.2 Chair Assembly

1. Unpack all chair components for one chair.
2. Attach the chair backrest to the seat.
3. Connect the chair legs to the seat. Ensure the adjustable leg sections are oriented correctly. Secure with the provided screws.
4. Repeat for the remaining three chairs.

5. Verify all screws are tight and the chairs are stable before use.

## 5. OPERATING INSTRUCTIONS

### 5.1 Adjusting Table Height

The table offers seven height settings, ranging from 18.9 inches to 23.6 inches.

1. To adjust the table height, locate the adjustment mechanisms on each table leg.
2. Press the release buttons or twist the locking collars (depending on design) on all four legs simultaneously.
3. Carefully raise or lower the tabletop to the desired height.
4. Ensure all four legs click securely into place at the chosen height before use. Verify the table is level and stable.



**Figure 5.1:** Illustration of the height adjustment feature for both the table (7 heights) and chairs (3 heights). The image shows close-ups of the leg adjustment mechanisms and diagrams indicating suitable ages for different height settings (e.g., 3 years for 18.9"-20.5" table height).

## 5.2 Adjusting Chair Height

Each chair offers three height options: 10.2 inches, 11 inches, and 11.8 inches.

1. To adjust a chair's height, locate the adjustment mechanisms on each chair leg.
2. Press the release buttons or twist the locking collars on both legs simultaneously.
3. Raise or lower the chair seat to the desired height.
4. Ensure both legs click securely into place at the chosen height before use.

## 5.3 Using the Graffiti Tabletop

The tabletop is designed for creative expression using specific art supplies.

- Only use **watercolor pens** on the graffiti tabletop.
- **Do NOT use** oil pens, crayons, or colored pencils, as these may permanently stain the surface.
- To clean, simply wipe the surface with a damp cloth or use an eraser for watercolor pen marks.



Figure 5.2: A child drawing on the graffiti tabletop. The image clearly indicates that only watercolor pens are suitable for use on the surface,

while oil pens, crayons, and colored pencils are not recommended to prevent permanent marks.

## 6. CARE AND MAINTENANCE

- **Cleaning:** Wipe the table and chairs with a damp cloth and mild soap if necessary. Avoid abrasive cleaners or harsh chemicals that could damage the material.
- **Inspection:** Periodically check all screws and fasteners to ensure they are tight. Retighten as needed.
- **Storage:** The chairs are stackable for convenient, space-saving storage when not in use. Store the set in a dry, cool place away from direct sunlight.



**Figure 6.1:** Illustration demonstrating how the chairs can be stacked for efficient, space-saving storage, ideal for smaller rooms or when the set is not in active use.

## 7. TROUBLESHOOTING

Problem	Possible Cause	Solution
---------	----------------	----------

Problem	Possible Cause	Solution
Table/Chair is wobbly	Loose fasteners; uneven surface; legs not fully locked into adjustment.	Ensure all screws are tightened. Move to a level surface. Verify all adjustable legs are securely locked at the same height setting.
Difficulty adjusting height	Mechanism stuck; debris in the adjustment slot.	Ensure release buttons are fully pressed. Clean any debris from the leg adjustment mechanism. Do not force adjustment.
Stains on graffiti tabletop	Incorrect art supplies used (e.g., oil pen, crayon).	Attempt to clean with a damp cloth and mild soap. For stubborn marks, a gentle, non-abrasive cleaner might be used with caution, but permanent stains from non-recommended materials may not be removable.

## 8. PRODUCT SPECIFICATIONS

---

Feature	Detail
Model Number	HY10251
Color	Green (as per current product)
Materials	BPA-free PP, Engineered Wood
Table Dimensions (L x W x H)	47" x 23.5" x 18.9"-23.6" (Adjustable)
Chair Dimensions (L x W x H)	12.5" x 14" x 20"-21.6"
Seat Height Range	10.2" / 11" / 11.8" (Adjustable)
Net Weight of Table	25.5 lbs
Net Weight of Each Chair	3.5 lbs
Weight Capacity of Table	220 lbs
Weight Capacity of Each Chair	220 lbs
Recommended Ages	18+ Months Old
Certifications	ASTM, CPSIA Approved

# Enhance Load Capacity

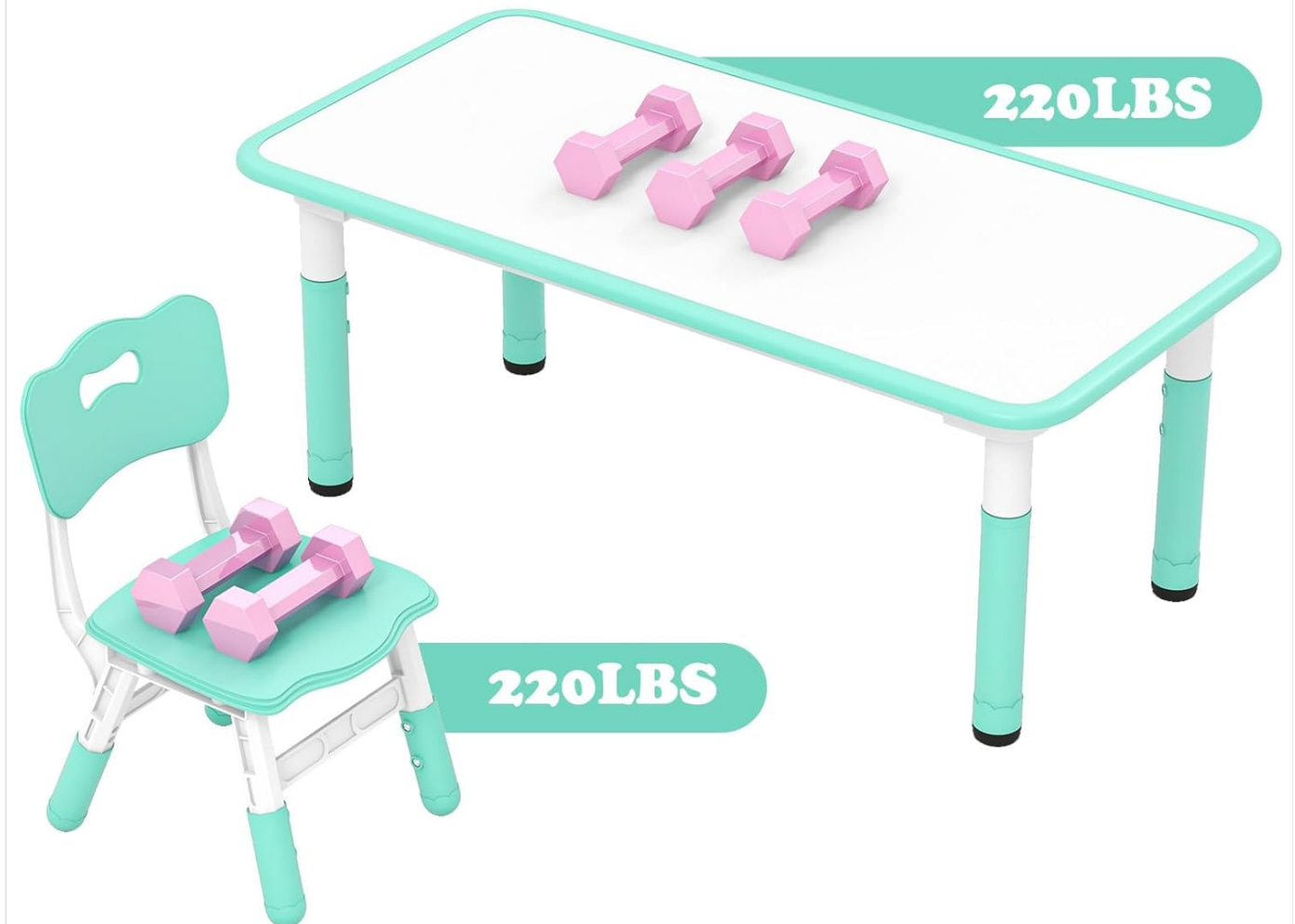

**Figure 8.1:** Visual representation of the enhanced load capacity, indicating that both the table and each chair can support up to 220 lbs, highlighting the product's durability and stability.

## 9. WARRANTY AND CUSTOMER SUPPORT

For any questions, concerns, or issues regarding your INFANS Kids Adjustable Table and 4 Chairs Set, please contact INFANS customer support. Please have your model number (HY10251) and purchase information ready when contacting support.

Contact information can typically be found on the INFANS official website or through your retailer's customer service portal.

For more information about INFANS products, visit the official [INFANS Store on Amazon](#).

