

## WYWNA Solar Lights Outdoor-2

# WYWNA Solar Lights Outdoor Instruction Manual

MODEL: SOLAR LIGHTS OUTDOOR-2

## 1. INTRODUCTION

This manual provides essential information for the safe and efficient operation of your WYWNA Solar Lights Outdoor. These lights are designed for outdoor use, featuring solar power, motion sensing, and remote control capabilities. Please read this manual thoroughly before installation and use.



Image 1.1: WYWNA Solar Lights Outdoor, designed for a safer night.

## 2. WHAT'S IN THE BOX

Each package contains the following components:

- 2x Solar Lights
- 2x Remote Controls
- 2x Mounting Hardware (screws and anchors)
- 2x Mounting Brackets
- 1x Instruction Manual

## WHAT'S IN THE BOX



Image 2.1: Contents of the product package, including two solar lights, two remote controls, mounting hardware, and an instruction manual.

### 3. PRODUCT OVERVIEW

The WYWNA Solar Lights Outdoor are equipped with advanced features for reliable and efficient outdoor illumination.

- **Super Bright Lighting:** Each light provides 6500K daylight illumination with 150 super bright SMD3030 LED beads, covering an area of up to 120-150 sq. feet without dark spots. The working life is over 50,000 hours.
- **Energy Efficient Solar Powered:** Features newly upgraded 6V/5W polycrystalline silicon solar panels, converting 24% of sunlight into energy. Equipped with 2400mAh batteries, fully charging in 4-6 hours in strong sunlight.
- **Durable & Waterproof:** Constructed with a new ABS plastic casing and an IP66 waterproof rating, designed to withstand extreme weather conditions from -10°C to 40°C, including rain and snow.



Image 3.1: Overview of key product features.

## A One-Cell WYWNA Battery is Stronger than a six-Cell Battery

★ 2 YEAR ★

>

- Offering Efficient Energy Conversion
- Long-Life Cycling Safe, Reliable Performance

Image 3.2: The advanced battery technology ensures efficient energy conversion and long-lasting performance.



# **SOLAR LIGHTS OUTDOOR WATERPROOF**



*IP66  
waterproof*



*Anti riot  
mine*



*Anti snow  
storms*



*High temperature  
resistant*

Image 3.3: The IP66 waterproof rating ensures durability in various weather conditions.



Image 3.4: High brightness and wide illumination area for effective outdoor lighting.

Your browser does not support the video tag.

Video 3.1: An overview of the WYWNA Solar Lights Outdoor, demonstrating key features and applications.

## 4. SETUP & INSTALLATION

The WYWNA Solar Lights Outdoor feature an all-in-one design for quick and easy installation without the need for troublesome wires or accessories. These lights are only suitable for wall installation.

1. Attach the mounting bracket to the solar light unit using the provided screws and nuts.
2. Choose an installation location that receives ample direct sunlight throughout the day for optimal charging. Avoid shaded or sunless areas.
3. Screw the base of the mounting bracket to the wall using the provided mounting hardware.  
Recommended installation heights are 6.56-13.12 feet.



### *All-in-One Design, Easy Installation, No Wiring Required*



Image 4.1: Easy, all-in-one installation process.



#### ***Tips:***

Please install in an unobstructed area directly facing sunlight for optimal charging. Installing in shaded or sunless areas may hinder solar panel absorption, potentially damaging the charging function and preventing proper illumination of the solar street light.

Image 4.2: Important tips for selecting the optimal installation location to maximize solar charging efficiency.

## **5. INITIAL USE & CHARGING**

For first-time use, ensure the solar panel is charged in ample sunlight for 12-15 hours before turning on the lights. To ensure sufficient sunlight, install the solar street lights outdoor waterproof in an unobstructed area. During daytime operation, cover the solar panel with a shading object to test the light's functionality.

# A-GRADE POLYSILICON SOLAR PANELS

CONVERSION RATE INCREASED by **25%**

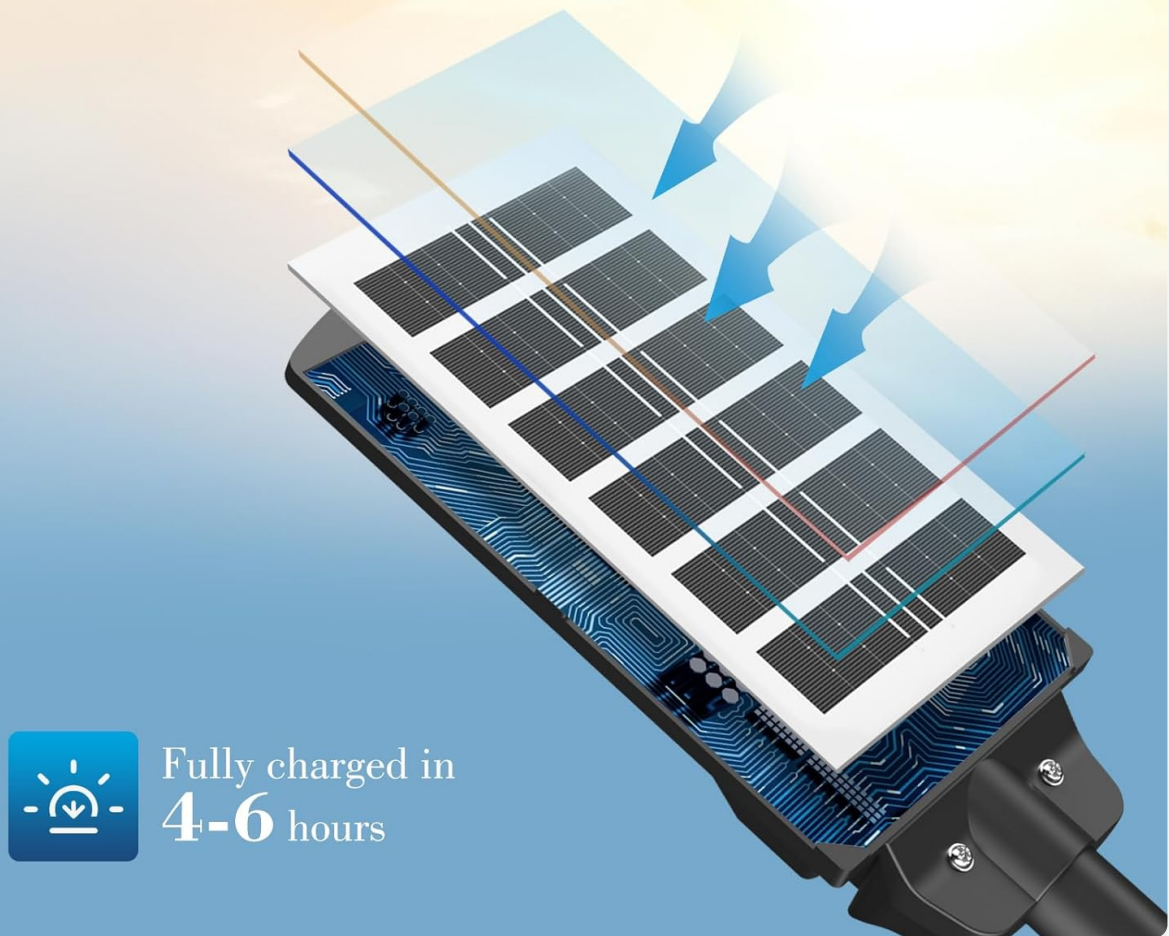

Image 5.1: High-efficiency solar panels ensure quick charging.

## 6. OPERATING MODES

Your solar flood lights offer multiple smart control modes, adjustable via the included remote control:

- **Mode 1: Dusk to Dawn Mode:** The light automatically turns on at dusk and off at dawn.
- **Mode 2: Motion Sensor Mode:** Provides 100% brightness when motion is detected, and dims to 30% brightness when no motion is present. This mode can be timed for 3-4 hours.
- **Mode 3: Timing Setting:** Offers 100% brightness for a set duration (e.g., 4 hours) and then turns off.



Image 6.1: Dusk to Dawn functionality ensures automatic operation.



# MOTION SENSING

**Motion Sensor Mode 1:** Sense motion detection brightness is 100%, no motion brightness is 30%.



**Motion Sensor Mode 2:** Sense motion detection brightness is 100%, no motion turn off.

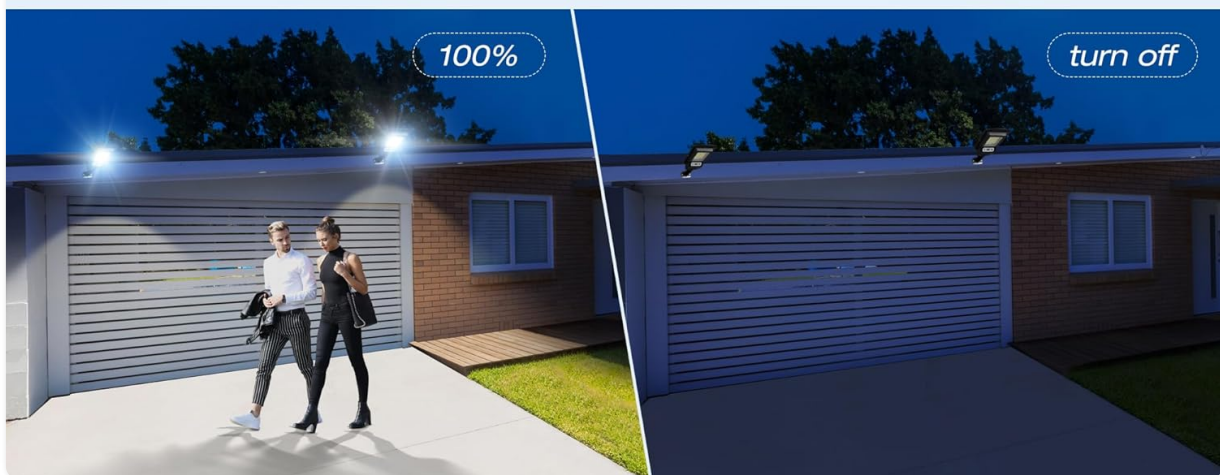

Image 6.2: Detailed explanation of motion sensing modes.

**3H / 4H / 5H**

You can set different timer durations according to your preference.

After the timer ends, 3H/5H Timer Mode:

After the set time expires, the light will switch to Motion Sensor Mode 1.

4H Timer Mode: After the set time expires, the light will automatically turn off.

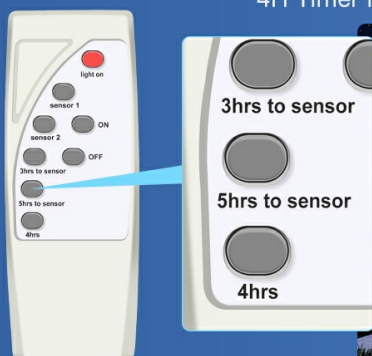

Image 6.3: Remote control for setting various timer durations.

## 7. MAINTENANCE

To ensure optimal performance and longevity of your solar lights, follow these maintenance guidelines:

- Regularly clean the solar panel surface to remove dust, dirt, and debris. A clean panel ensures

maximum sunlight absorption.

- Inspect the mounting hardware periodically to ensure it remains secure.
- In areas with heavy snowfall, clear snow from the solar panel to allow for charging.

## 8. TROUBLESHOOTING

If your solar light is not functioning as expected, consider the following:

- **Light not turning on at night:** Ensure the solar panel is receiving sufficient direct sunlight during the day (12-15 hours for initial charge). Check if the switch is in the ON position.
- **Dim light or short illumination time:** This may indicate insufficient charging. Relocate the light to an area with more direct sunlight. Ensure the solar panel is clean.
- **Motion sensor not working:** Verify the light is in Motion Sensor Mode. Ensure the sensor area is clear of obstructions.

## 9. SPECIFICATIONS

Feature	Specification
Brand	WYWNA
Model Name	Solar Lights Outdoor-2
Light Source Type	LED (150 SMD3030 beads)
Color Temperature	6500 Kelvin (Daylight)
Brightness	20000 Lumen
Power Source	Solar Powered (6V/5W polycrystalline silicon panel)
Battery Capacity	2400mAH
Water Resistance Level	IP66 Waterproof
Control Method	Remote Control, Motion Sensor
Material	Acrylonitrile Butadiene Styrene (ABS)
Product Dimensions	11.8"L x 6"W x 6.3"H
Item Weight	2.64 pounds
Installation Type	Wall Mount

## 10. WARRANTY & SUPPORT

WYWNA provides 24 months of worry-free after-sales service for your solar lights. If you have any questions, concerns, or require assistance with your product, please contact our customer service team for support.