

PAKITE 850

PAKITE 850 Wireless HDMI Receiver Instruction Manual

Model: PAKITE 850

1. INTRODUCTION

The PAKITE 850 Wireless HDMI Receiver is designed to provide a seamless high-definition video and audio transmission experience. This additional receiver unit is intended for use with an existing PAKITE 850 transmitter, allowing you to extend your display to multiple locations. It supports long-range transmission, advanced dual-band Wi-Fi, full HD 1080P resolution with low latency, and convenient features like HDMI loop-out and IR remote control extension.

2. PRODUCT OVERVIEW

2.1. Components and Indicators

The PAKITE 850 system consists of a Transmitter (TX) and one or more Receiver (RX) units. Each unit features various ports and indicator lights for easy setup and monitoring.



Figure 1: Transmitter (TX) and Receiver (RX) units with labeled ports and indicators. Key indicators include Power, Video, Link, Reset, IR-Out/In, HDMI Out/In, and USB-C 5V power supply.

- **Power Indicator:** Shows the power status of the unit.
- **Video Indicator:** Lights up when a video signal is detected.
- **Link Indicator:** Indicates a successful wireless connection between TX and RX.
- **Reset Button:** Used to reset the device (press for 5 seconds).
- **IR-Out (Transmitter):** Connects to the IR emission cable to control the source device.
- **IR-In (Receiver):** Connects to the IR receiving cable to receive remote signals.
- **HDMI In (Transmitter):** Connects to the HDMI source device.
- **HDMI Out (Transmitter & Receiver):** Connects to the display device.
- **USB-C 5V:** Power input port.

3. SETUP AND INSTALLATION

Follow these steps to set up your PAKITE 850 Wireless HDMI Receiver with a compatible transmitter:

1. **Connect Antennas:** Screw the provided antennas onto both the Transmitter (TX) and Receiver (RX)

units.

2. **Power Connection:** Plug the provided USB-C power cables into the USB-C 5V ports on both the TX and RX units, then connect them to power adapters and a power outlet.
3. **Transmitter (TX) Connection:**
 - Connect an HDMI cable from your video source (e.g., laptop, set-top box) to the **HDMI In** port on the TX unit.
 - If using the HDMI Loop-out feature, connect an HDMI cable from the **HDMI Out** port on the TX unit to a local display.
4. **Receiver (RX) Connection:** Connect an HDMI cable from the **HDMI Out** port on the RX unit to your display device (e.g., TV, projector, monitor).
5. **IR Remote Extender Setup:**
 - Connect the IR emission cable to the **IR-Out** port on the TX unit and place the emitter near the IR sensor of your source device.
 - Connect the IR receiving cable to the **IR-In** port on the RX unit and place the receiver in a location where your remote control can easily send signals to it.
6. **Power On:** Ensure both TX and RX units are powered on. The units are designed for plug-and-play convenience and should automatically connect within 18-22 seconds. The Link indicator will light up when connected.

Video 1: Demonstrates the basic connection process for the transmitter and receiver units, including power and HDMI cables, and shows a successful connection to a display.

Video 2: Illustrates the setup and application of the Wireless HDMI Transmitter and Receiver 850, including IR remote control functionality and cross-room transmission.

Video 3: Shows how to connect a MacBook (iOS) to the wireless HDMI system using a USB-C to HDMI adapter, demonstrating both extended and mirror display modes.

Video 4: Demonstrates the 1 TX to 2 RXs capability, showing how to connect multiple receivers to a single transmitter for simultaneous display on two monitors.

Video 5: Illustrates two connection modes (SW and SP) for the wireless HDMI extender, showing how to set up the transmitter and receiver for auto streaming.

4. OPERATING INSTRUCTIONS

4.1. Wireless Transmission

Once connected, the PAKITE 850 system automatically establishes a stable wireless link. It utilizes 5G/2.4GHz dual-band Wi-Fi for faster, more stable connections with anti-interference capabilities. The system supports Full HD 1080P 60Hz video playback with ultra-low latency.



Figure 2: Enjoy unlimited video freedom with wireless access to all your streaming devices in 1080P Full HD.

4.2. Extended Range and Through-Wall Capability

The system offers a transmission range of up to 657 feet (200m) in open spaces and up to 165 feet (50m) through walls, making it suitable for various home environments and even farm monitoring.

WIDE RANGE TRANSMISSION

Break Through the Limits of Distance and Space

150-200m
(open space)

30-50m
(through a wall)



Figure 3: Wide range transmission capabilities, showing effective distances in open spaces and through walls. Note that actual transmission distance may vary based on environmental factors.

4.3. Multi-Receiver Support (1 TX to 4 RXs)

A single transmitter can connect to up to four receivers simultaneously, allowing you to duplicate or extend your screen to multiple rooms like the living room, bedroom, and kitchen.

EXTEND YOUR VISION

Connect One Source to Four Screens Wirelessly



Figure 4: Extend your vision by connecting one source to four screens wirelessly, ideal for multi-room viewing or presentations.

4.4. HDMI Loop-out

The transmitter features an HDMI loop-out port, enabling the source device (e.g., set-top box) to display video on a local monitor while simultaneously transmitting to other receivers.

HDMI LOOP-OUT

Add 1 Extra Screen for TX



Figure 5: HDMI Loop-out function allows you to add an extra screen for the transmitter, providing local viewing while broadcasting wirelessly.

4.5. IR Remote Control Extension

Control your source device from the receiver's location using the IR remote extension function. This allows you to change channels or navigate menus of your set-top box from another room.

IR EXTEND FUNCTION

Control Your TV Box in Two Room

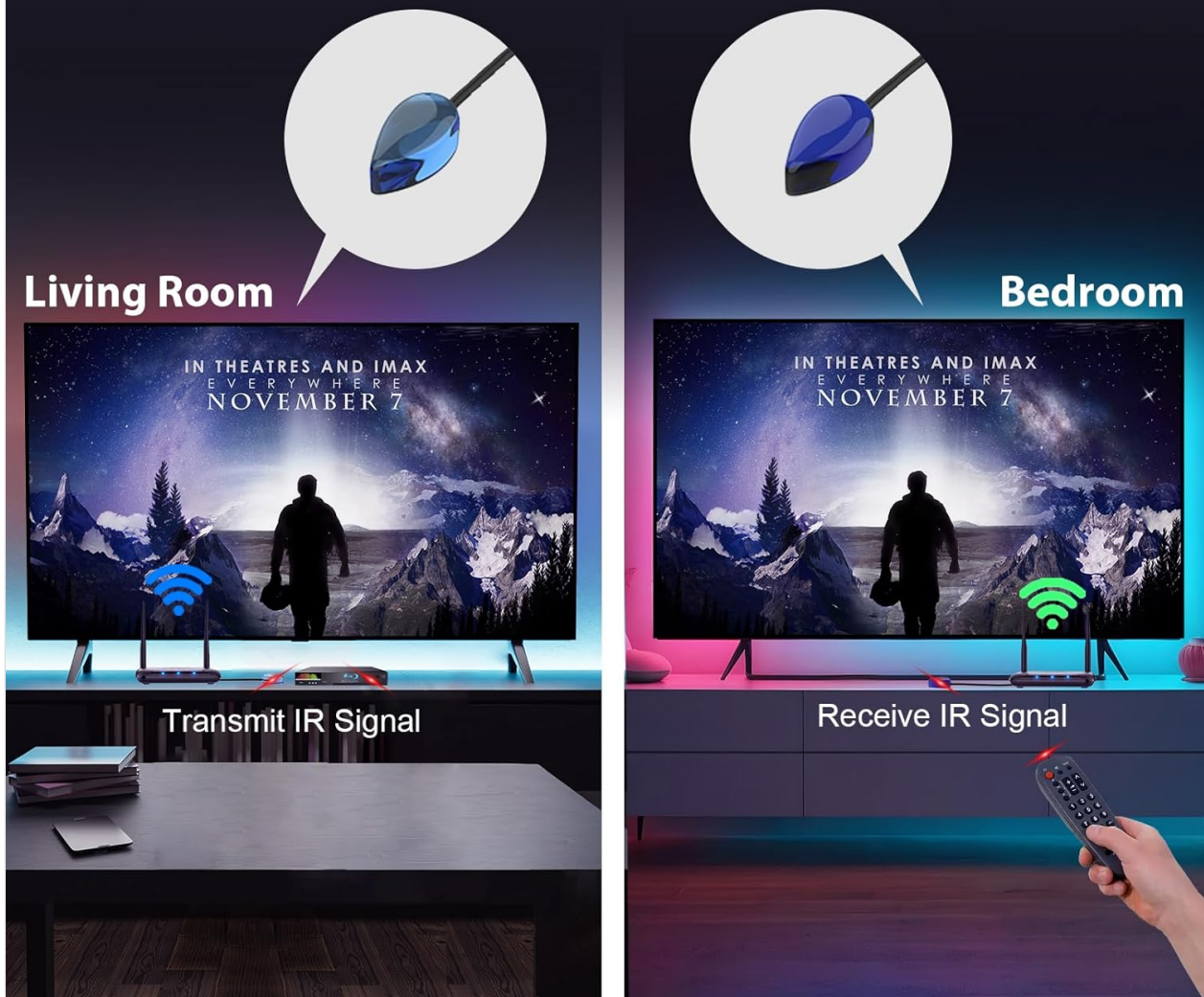

Figure 6: IR Extend Function allows you to control your TV box or other source device from a different room using its original remote control.

5. MAINTENANCE

To ensure optimal performance and longevity of your PAKITE 850 Wireless HDMI Receiver, follow these maintenance guidelines:

- Keep the devices in a cool, dry place, away from direct sunlight and excessive heat.
- Ensure proper ventilation around the units to prevent overheating. The design includes excellent heat dissipation features.
- Clean the devices with a soft, dry cloth. Avoid using liquid cleaners or aerosols.
- Do not block the ventilation holes.

6. TROUBLESHOOTING

If you encounter issues with your PAKITE 850 Wireless HDMI Receiver, refer to the following common solutions:

- **No Signal/Connection:**

- Ensure both the transmitter and receiver are powered on and their Link indicators are lit.
- Verify all HDMI cables are securely connected to the correct ports (HDMI In on TX, HDMI Out on RX).
- Check the signal source connection. If the display shows "Please check the signal source connection", ensure your source device is active and outputting a signal.
- Try resetting both units by pressing the Reset button for 5 seconds.

- **No Picture/Incorrect Resolution:**

- The device supports progressive scan resolutions up to 1080P (e.g., 1080P). It does not support interlaced resolutions such as 1080i. Ensure your source device is set to a supported progressive scan resolution.
- Verify your display device is set to the correct HDMI input.

- **IR Remote Control Not Working:**

- Ensure the IR emission cable is correctly positioned near the IR sensor of your source device.
- Ensure the IR receiving cable is connected to the RX unit and is in line-of-sight of your remote control.
- The IR function supports various infrared frequencies. If it does not work, try adjusting the IR frequency switch on the unit to select a matching frequency (e.g., 30KHz, 38KHz, 47KHz, 56KHz).
- Note: This function is not compatible with Bluetooth remotes.

- **Poor Signal/Interference:**

- Ensure the antennas on both units are securely attached and oriented correctly.
- Minimize obstacles (especially thick walls or metal objects) between the transmitter and receiver.
- Avoid placing the units near other wireless devices that might cause interference.

7. SPECIFICATIONS

| Feature | Description |
|-----------------------------|--|
| Brand | PAKITE |
| Model Name | HDMI Wireless Transmitter and Receiver |
| Model Number | BIN-850 |
| Connectivity Technology | HDMI, USB, Wi-Fi |
| Connector Type | HDMI |
| Resolution | 1080p |
| Video Output Resolution | 1920x1080 |
| Video Codec | H.264, H.265/HEVC |
| Special Feature | Chromecast |
| Supported Internet Services | Netflix, Hulu, YouTube |

| | |
|---------------------------------------|---|
| Controller Type | Remote Control |
| Form Factor | TV Box |
| Color | Black |
| Compatible Devices | Television, Personal Computer, Laptop, Tablet |
| Transmission Distance (Open Area) | 657 ft (200m) |
| Transmission Distance (Through Walls) | 165 ft (50m) |
| Item Dimensions L x W x H | 4.72"L x 3.15"W x 4.84"H |

8. WARRANTY AND SUPPORT

PAKITE stands behind its products with a comprehensive warranty and support:

- **365-Day Free Replacement:** We offer a 365-day free replacement service for non-artificial damage.
- **30-Day Return Policy:** Enjoy a 30-day no-questions-asked return policy.
- **Manufacturer Warranty:** A 1-year free replacement warranty is provided.

For further assistance or technical support, please refer to the contact information provided with your product packaging or visit the official PAKITE website.