



[Manuals.plus](#) /

> [SUYEE](#) /

> [SUYEE C36 Bluetooth 5.3 Receiver Instruction Manual](#)

SUYEE C36

SUYEE C36 Bluetooth 5.3 Receiver Instruction Manual

Model: C36

PRODUCT OVERVIEW

The SUYEE C36 Bluetooth 5.3 Receiver is designed to wirelessly stream audio from your Bluetooth-enabled devices to your existing wired home or car stereo systems and speakers. It features the latest Bluetooth 5.3 technology for high-definition sound performance with low latency and stable transmission. The C36 supports multiple output interfaces including RCA, 3.5mm AUX, and digital optical, along with USB drive music playback.



Image: SUYEE C36 Bluetooth 5.3 Receiver with its various connection cables.

SETUP GUIDE

What's in the Box?

Please check the package contents to ensure all items are present:

- 1 x SUYEE C36 Bluetooth Receiver
- 1 x RCA Audio Cable
- 1 x USB Power Cable (Type-C)
- 1 x 3.5mm Audio Cable
- 1 x User Manual

WHAT`S IN THE BOX?



C36 Bluetooth Receiver



Image: All items included in the SUYEE C36 product package.

Connecting the Device

Follow these steps to connect your SUYEE C36 Bluetooth Receiver:

- Power Connection:** Connect the provided USB Power Cable (Type-C) to the 'DC-5V' port on the receiver and plug the other end into a USB power source (e.g., USB wall adapter, computer USB port).
- Audio Output Connection:** Choose one of the following audio output methods to connect the receiver to your stereo system or speakers:
 - RCA Output:** Use the RCA Audio Cable to connect the red and white RCA ports on the C36 to the corresponding audio input ports on your amplifier or speakers.
 - 3.5mm AUX Output:** Use the 3.5mm Audio Cable to connect the 'AUX' port on the C36 to the 3.5mm audio input on your stereo system or portable speaker.
 - Digital Optical Output:** Connect an optical fiber cable (not included) from the 'SPDIF' optical fiber output port on the C36 to the optical input on your audio system.
- Power On:** Long press the multifunction knob on the receiver to power it on. The display screen will light up.



Plug

Insert the power cable and audio cable into the device
Long press the power button to power on

Pair
Turn on the Bluetooth on your phone and Pair it with C36

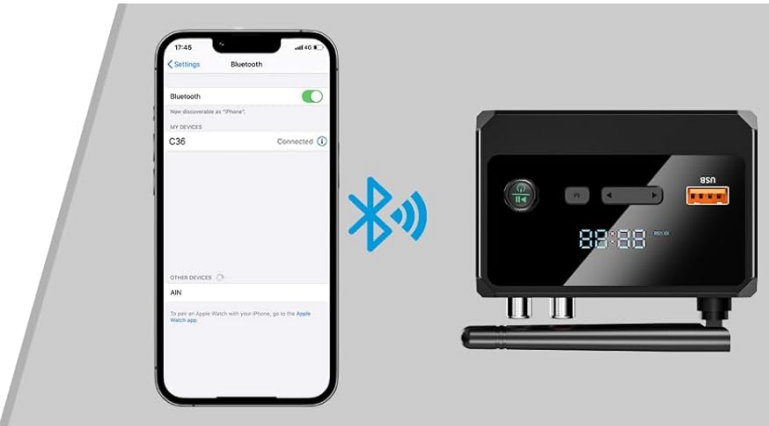

Enjoy

Hit the play button on Your Phone to play music; the Button on the device can also pause and play the music

Image: Visual guide for plugging in the power and audio cables to the receiver.

FLEXIBLE CONNECTIVITY



Image: Close-up of the receiver's flexible connectivity options, highlighting each port.

OPERATING INSTRUCTIONS

Pairing with Bluetooth Devices

Once the C36 receiver is powered on, it will automatically enter pairing mode (indicated by a flashing Bluetooth icon on the display). To connect your audio device:

1. Enable Bluetooth on your smartphone, tablet, or other audio device.
2. Search for available Bluetooth devices and select "C36" from the list.
3. Once connected, the Bluetooth icon on the C36 display will become solid, indicating a successful pairing.
4. You can now play music from your device, and the audio will be streamed to your connected stereo system.

Immersive High-Definition Audio

 Bluetooth 5.3



Image: A smartphone displaying the Bluetooth settings, showing the C36 device as connected.

Using the Multifunction Knob and Buttons

The SUYEE C36 features intuitive controls for easy operation:

- **Multifunction Knob:** Long press to power on/off. Rotate to adjust volume. Press to play/pause music.
- **Mode Switch Key (M):** Press to switch between different input modes (e.g., Bluetooth, USB).
- **Previous Song Button:** Press to go to the previous track.
- **Next Song Button:** Press to go to the next track.
- **USB Disk Socket:** Insert a USB drive to play music directly from it.
- **Display Screen:** Shows current mode, pairing status, and other relevant information.



Image: An annotated diagram highlighting the various buttons, ports, and features of the C36 receiver.

USB Playback

The C36 supports playing music directly from a USB drive. Simply insert your USB drive into the 'USB' socket on the receiver. Use the mode switch key to select USB playback mode. The receiver will automatically detect and play compatible audio files from the drive.

CARE AND MAINTENANCE

To ensure the longevity and optimal performance of your SUYEE C36 Bluetooth Receiver, please follow these guidelines:

- **Cleaning:** Use a soft, dry cloth to clean the surface of the device. Do not use liquid cleaners, aerosols, or solvents, as they may damage the finish or internal components.
- **Storage:** Store the device in a cool, dry place away from direct sunlight, extreme temperatures, and humidity.

- **Handling:** Avoid dropping or subjecting the device to strong impacts.
- **Ventilation:** Ensure proper ventilation around the device to prevent overheating.

TROUBLESHOOTING

If you encounter issues with your SUYEE C36 Bluetooth Receiver, refer to the following common problems and solutions:

Problem	Possible Cause	Solution
Device does not power on.	Power cable not connected properly or power source issue.	Ensure the USB power cable is securely connected to the receiver and the power source. Try a different USB port or power adapter.
No audio output.	Incorrect audio cable connection, wrong input selected on stereo, or low volume.	Verify audio cables are correctly connected to the C36 and your stereo system. Select the correct input source on your stereo. Increase volume on both the C36 and your audio device.
Cannot pair with Bluetooth device.	C36 not in pairing mode, device out of range, or already connected to another device.	Ensure the C36 is powered on and the Bluetooth indicator is flashing (pairing mode). Move your device closer to the C36. Disconnect the C36 from any other paired devices.
Poor sound quality or intermittent connection.	Interference, distance from device, or obstacles.	Reduce the distance between the C36 and your Bluetooth device. Remove any obstacles between them. Avoid placing the C36 near other wireless devices that may cause interference.

PRODUCT SPECIFICATIONS

- **Product Dimensions:** 2 x 1.5 x 1 inches
- **Item Weight:** 5 ounces
- **Item Model Number:** C36
- **Special Features:** Built-In Bluetooth, Music Streaming, RCA, Volume Control, Digital Display Screen
- **Brand:** SUYEE
- **Connectivity Technology:** RCA, Bluetooth, AUX
- **Power Source:** Corded Electric
- **Material:** Plastic, Metal, Acrylonitrile Butadiene Styrene (ABS)

WARRANTY INFORMATION

The SUYEE C36 Bluetooth Receiver comes with a lifetime warranty. This warranty supports permanent replacement for damaged, defective, or lost products. You do not need to return the original item for replacement.

CUSTOMER SUPPORT

For further assistance, technical support, or warranty claims, please refer to the contact information provided on the

product packaging or the official SUYEE website. Our customer service team is ready to help you with any questions or issues you may have.

© 2024 SUYEE. All rights reserved.