

[Manuals.plus](#) /

› [ELECTRO WOLF](#) /

› [ELECTRO WOLF Bluetooth Wireless Mouse Tri-Mode User Manual](#)

ELECTRO WOLF EW07

ELECTRO WOLF Bluetooth Wireless Mouse Tri-Mode User Manual

Model: EW07

INTRODUCTION

Thank you for choosing the ELECTRO WOLF Tri-Mode Wireless Mouse. This advanced mouse offers versatile connectivity options (Dual Bluetooth 5.1 and 2.4GHz USB), a transparent design, silent clicks, and a rechargeable battery, making it ideal for various computing environments. This manual provides detailed instructions for setup, operation, maintenance, and troubleshooting to ensure optimal performance and longevity of your device.

SAFETY INFORMATION

- Keep the device away from water and other liquids to prevent electric shock.
- Avoid exposing the mouse to extreme temperatures or direct sunlight.
- Do not attempt to disassemble or repair the mouse yourself. This will void the warranty.
- Use only the provided Type-C charging cable for recharging.
- Dispose of the battery according to local regulations. Do not incinerate.

PACKAGE CONTENTS

Please check the package for the following items:

- ELECTRO WOLF Tri-Mode Wireless Mouse (Green)
- USB 2.4GHz Receiver (stored inside the mouse)
- USB Type-C Charging Cable
- User Manual

PRODUCT OVERVIEW

Familiarize yourself with the components of your ELECTRO WOLF mouse.



Figure 1: ELECTRO WOLF Tri-Mode Wireless Mouse (Green) - Top View

The mouse features a full transparent design, allowing visibility of its internal circuitry. Key components include the scroll wheel, left and right click buttons, a DPI adjustment button, and a dedicated "One-Click Desktop" button. The USB receiver is conveniently stored magnetically within the mouse body.

Magnetic Top Cover Magnetic Receiver



Figure 2: Magnetic Top Cover and USB Receiver

The mouse is designed with a magnetic top cover for easy access to the USB receiver and a secure fit. The ambidextrous design ensures comfortable use for both right and left-handed users.

SETUP

1. Charging the Mouse

Before first use, it is recommended to fully charge the mouse.

1. Locate the USB Type-C charging port on the front of the mouse.
2. Connect the provided Type-C charging cable to the mouse and the other end to a USB power source (e.g., computer USB

port, wall adapter).

3. The battery indicator light will show the current battery level and flash while charging.

4. Once fully charged, the indicator light will change (refer to the specific light behavior in the operating section).

Battery Indicator Light

Say goodbye to battery anxiety



Figure 3: USB-C Charging and Battery Indicator

The mouse features a built-in rechargeable battery, eliminating the need for disposable batteries. The battery indicator provides real-time status.

2. Connecting via 2.4GHz USB Mode

This mode is compatible with devices that have a USB port.

1. Remove the 2.4GHz USB receiver from its magnetic storage slot inside the mouse.
2. Plug the USB receiver into an available USB port on your computer or laptop.
3. Turn on the mouse using the power switch located on the bottom.
4. Switch the mode button on the bottom of the mouse to the 2.4GHz icon.
5. The mouse should automatically connect to your device.



Figure 4: 2.4GHz USB Receiver Connection

3. Connecting via Bluetooth Mode (BT1 / BT2)

Bluetooth mode works with Windows, Android, MAC OS, iPad iOS 13 and above systems.

1. Turn on the mouse using the power switch on the bottom.
2. Switch the mode button on the bottom of the mouse to either BT1 or BT2. The corresponding indicator light will flash, indicating it's in pairing mode.
3. On your device (computer, tablet, etc.), go to Bluetooth settings.
4. Search for new devices. You should see "ELECTRO WOLF Mouse" or similar in the list.
5. Select the mouse to pair. Once paired, the indicator light on the mouse will stop flashing and remain solid.
6. Repeat steps for BT2 if you wish to connect to a third device.

Wireless Bluetooth Mouse

2.4G USB | Bluetooth 1 | Bluetooth 2 | Type C Adapter

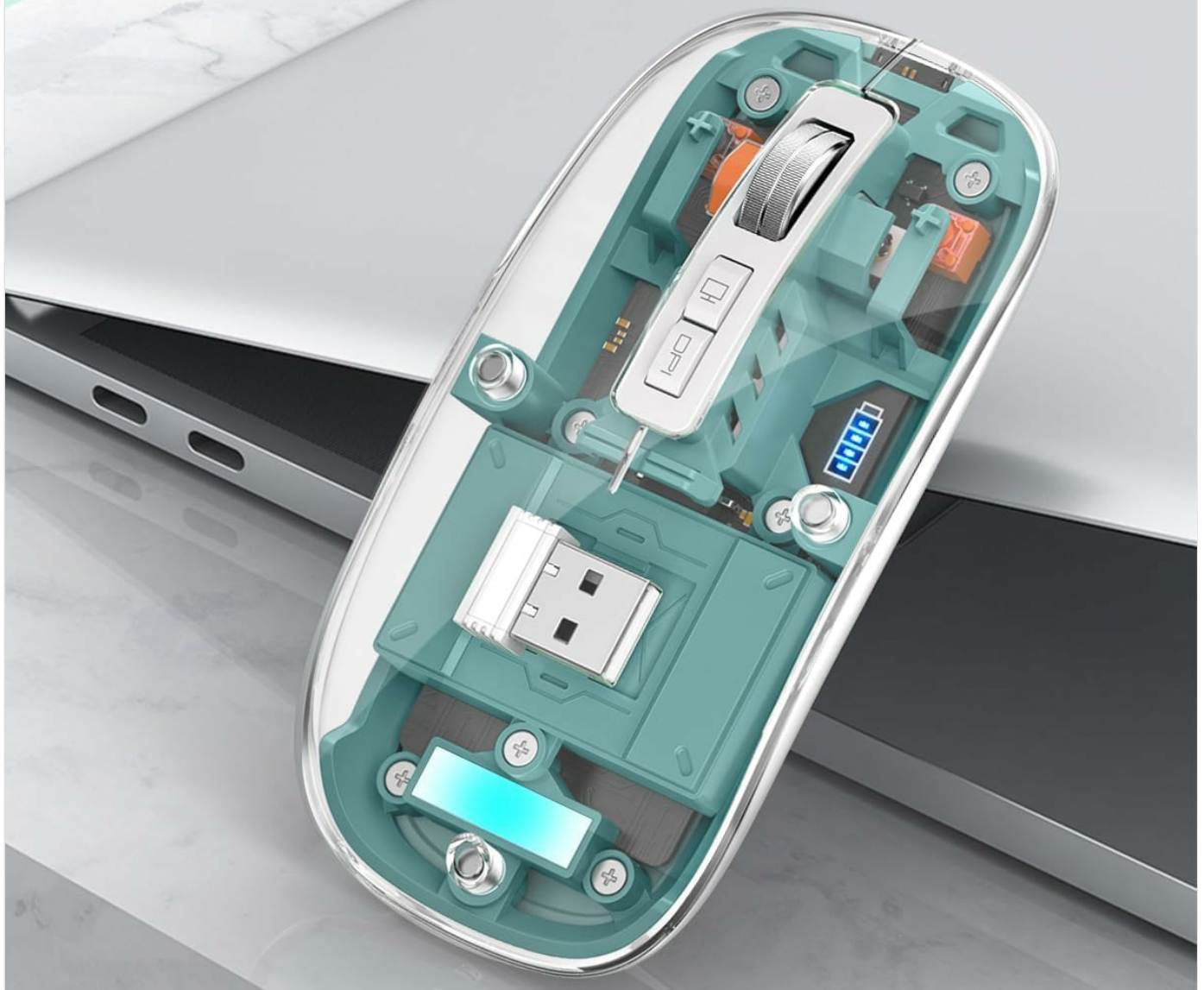

Figure 5: Wireless Bluetooth Mouse Connectivity

OPERATING INSTRUCTIONS

1. Switching Between Modes

The mouse supports Tri-Mode connection. Use the switch button on the bottom of the mouse to toggle between 2.4GHz, BT1, and BT2 modes.



Figure 6: Tri-Mode Switch on Mouse Bottom

2. Adjusting DPI (Sensitivity)

The mouse offers 4 adjustable DPI levels (800-1200-1600-2400). Press the DPI button located on the top of the mouse, below the scroll wheel, to cycle through the settings. An indicator light will show the current DPI level.

3. One-Click Desktop Function

The mouse features a dedicated "One-Click Desktop" shortcut button. Press this button to instantly switch to your computer's desktop, useful for quick access or privacy.

Windows: One click back to homepage

Mac: ⌘D (Command + D)

New Function Home Button



Win: One click back to homepage

Mac: ⌘D

Figure 7: One-Click Desktop Button

4. Silent Click Feature

The left and right buttons are designed for silent clicks, providing a quiet working environment without disturbing others.

SILENT CLICKS

Without disturbing others while using



Figure 8: Silent Click Mechanism

5. Breathing Light

The mouse logo features a colorful breathing light that changes randomly during use, adding a stylish aesthetic.

6. Power Saving Mode

To conserve battery, the mouse automatically enters sleep mode after 5 minutes of inactivity. To wake it up, simply click any button.

MAINTENANCE

- **Cleaning:** Use a soft, dry cloth to wipe the surface of the mouse. For stubborn dirt, a slightly damp cloth can be used, but ensure no moisture enters the internal components.
- **Storage:** When not in use for extended periods, store the mouse in a cool, dry place. Ensure the USB receiver is securely stored inside the mouse.
- **Battery Care:** Avoid fully discharging the battery frequently. Charge the mouse regularly to maintain battery health.

TROUBLESHOOTING

Problem	Possible Cause	Solution
Mouse not responding	Low battery; Incorrect mode selected; USB receiver not connected; Bluetooth not paired.	Charge the mouse; Ensure correct mode (2.4GHz/BT1/BT2) is selected; Re-insert USB receiver; Re-pair Bluetooth.
Lagging or erratic cursor movement	Interference; Dirty optical sensor; Surface issues.	Move closer to the receiver/device; Clean the optical sensor; Use on a clean, non-reflective mouse pad.
Cannot connect via Bluetooth	Mouse not in pairing mode; Device Bluetooth off; Already connected to another device.	Ensure mouse is in BT pairing mode (flashing light); Turn on Bluetooth on your device; Disconnect from other devices if necessary.
Battery drains quickly	Frequent use; Old battery; Mouse not entering sleep mode.	Ensure mouse is turned off when not in use for long periods; Contact support if battery life is significantly shorter than expected.

SPECIFICATIONS

Feature	Detail
Model	EW07
Connectivity	Tri-Mode (Dual BT5.1 + 2.4GHz USB)
DPI Levels	800 / 1200 / 1600 / 2400 (Adjustable)
Power Source	Rechargeable Lithium Ion Battery (included)
Charging Port	USB Type-C
Click Type	Silent Click (Left/Right buttons)
Hand Orientation	Ambidextrous
Special Features	Full Transparent Design, One-Click Desktop Button, Breathing Light, Battery Indicator
Compatible OS	Windows, Mac OS, Android, iPad iOS 13 and above
Product Dimensions	11 x 6 x 0.1 cm

Feature	Detail
Item Weight	100 g

WARRANTY AND SUPPORT

For warranty information and technical support, please contact ELECTRO WOLF customer service at the number provided on the product packaging or visit our official website. Please have your model number (EW07) and purchase details ready when contacting support.

Customer Support No.: 7801806979

