

OHY XVX G75

OHY XVX G75 Rapid Trigger Gaming Keyboard User Manual

Model: XVX G75

[Instructions](#) [Introduction](#) [Package Contents](#) [Setup](#) [Key Features](#) [Operating](#)
[Maintenance](#) [Troubleshooting](#) [Specifications](#) [Warranty & Support](#) [Safety](#)
[Information](#)

1. INTRODUCTION

The OHY XVX G75 Rapid Trigger Gaming Keyboard is a 75% layout wired mechanical keyboard designed for high-performance gaming and efficient typing. It features adjustable Hall effect magnetic switches, customizable actuation points, and an 8K Hz polling rate for rapid response. This manual provides detailed instructions for setting up, operating, and maintaining your keyboard.

2. PACKAGE CONTENTS

Ensure all items are present in the package:

- OHY XVX G75 Rapid Trigger Gaming Keyboard
- USB Cable (Type-C)
- User Manual

3. SETUP

3.1 Connecting the Keyboard

1. Locate the USB-C port on the back of the keyboard.
2. Connect one end of the provided USB-C cable to the keyboard.
3. Connect the other end of the USB cable to an available USB port on your computer.

4. The keyboard will automatically be recognized by your operating system.



Figure 3.1: Connecting the USB-C cable to the keyboard's 3-side conductor groove for organized cable management.

3.2 Adjusting Keyboard Angle

The keyboard features two double-layer foot supports, allowing for three different typing angles (0°, +10°, +15°). Adjust these to your preferred ergonomic position.



Figure 3.2: Adjustable foot pads provide multiple elevation angles for ergonomic comfort.

4. KEY FEATURES

4.1 Rapid Trigger Magnetic Switches

The XVX G75 keyboard is equipped with Hall effect magnetic switches, offering a customizable dynamic keystroke and rapid trigger function. The actuation point can be precisely adjusted between 0.3mm and 4.0mm. This allows for ultra-precise actuation and dynamic activation/deactivation, which is beneficial for fast-paced gaming.

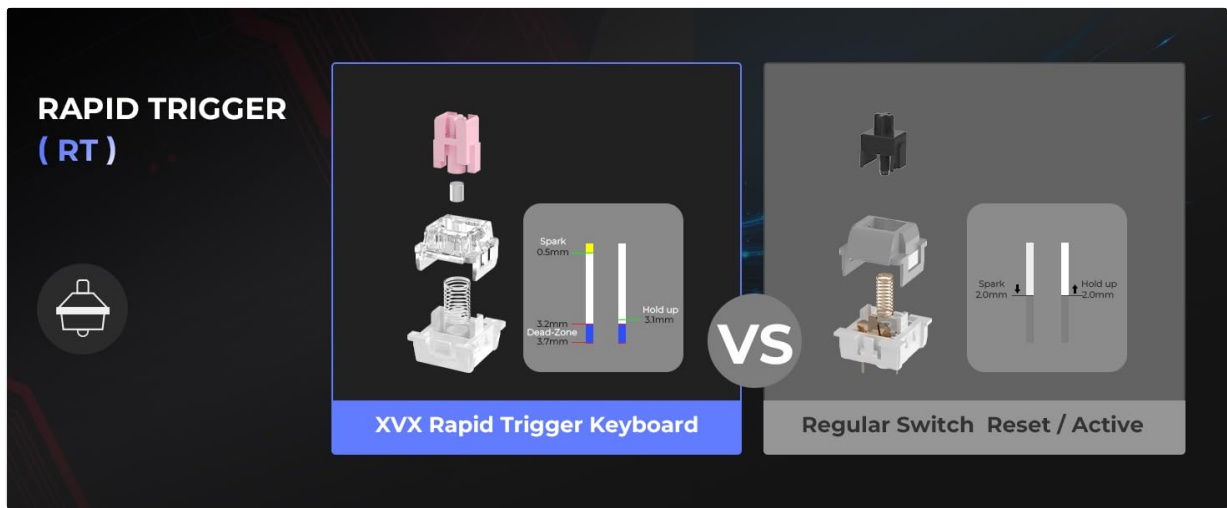

Figure 4.1: Comparison of traditional mechanical switches and magnetic switches, illustrating the adjustable actuation of magnetic switches.

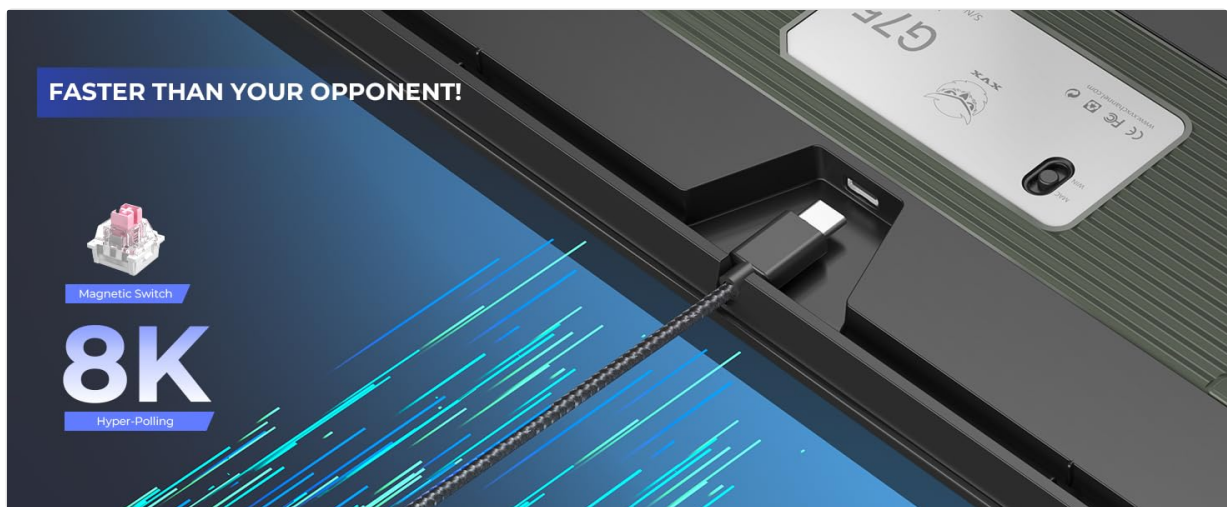

Figure 4.2: Visual representation of Rapid Trigger (RT) functionality, showing continuous activation compared to the fixed reset/active points of a regular switch.

Video 4.1: Demonstration of the Rapid Trigger functionality of the XVX G75 keyboard, showcasing its responsiveness in gaming scenarios.

4.2 Programmable NKRO ANSI Keyboard

The keyboard supports N-Key Rollover (NKRO) and can be programmed using dedicated software. This allows for key remapping, macro creation, hotkey assignment, and custom lighting effects. Advanced functions like Dynamic Keystroke (DKS), Mod-Tap (MT), and Toggle Key (TGL) can be applied to individual keys.



Figure 4.3: Explanation of Dynamic Keystrokes (DKS), allowing two distinct actions from a single keypress based on actuation depth.

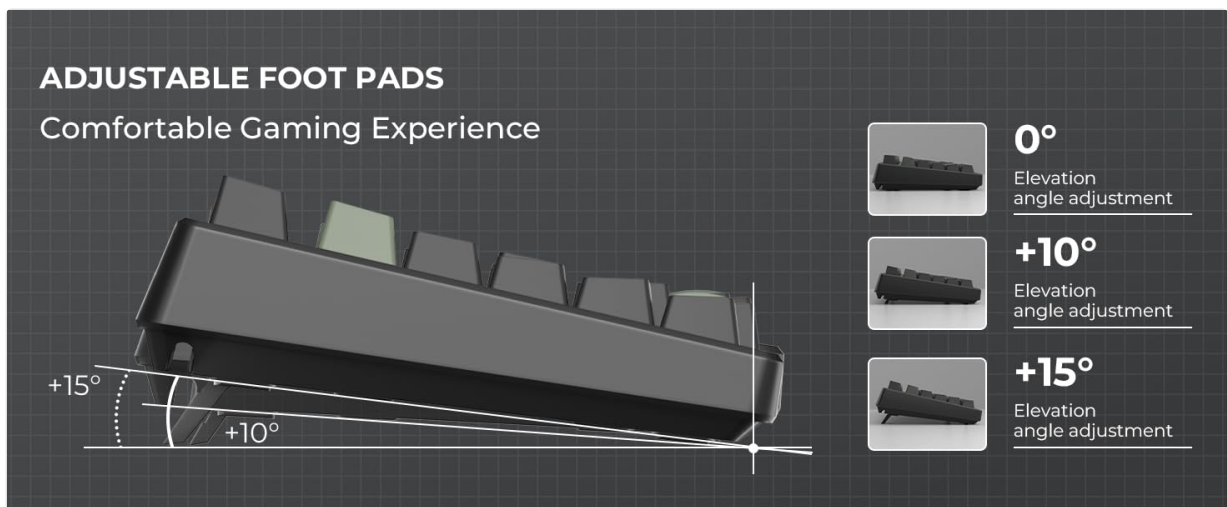

Figure 4.4: Explanation of Mod-Tap (MT), demonstrating how a key can have different functions based on whether it is tapped or held.

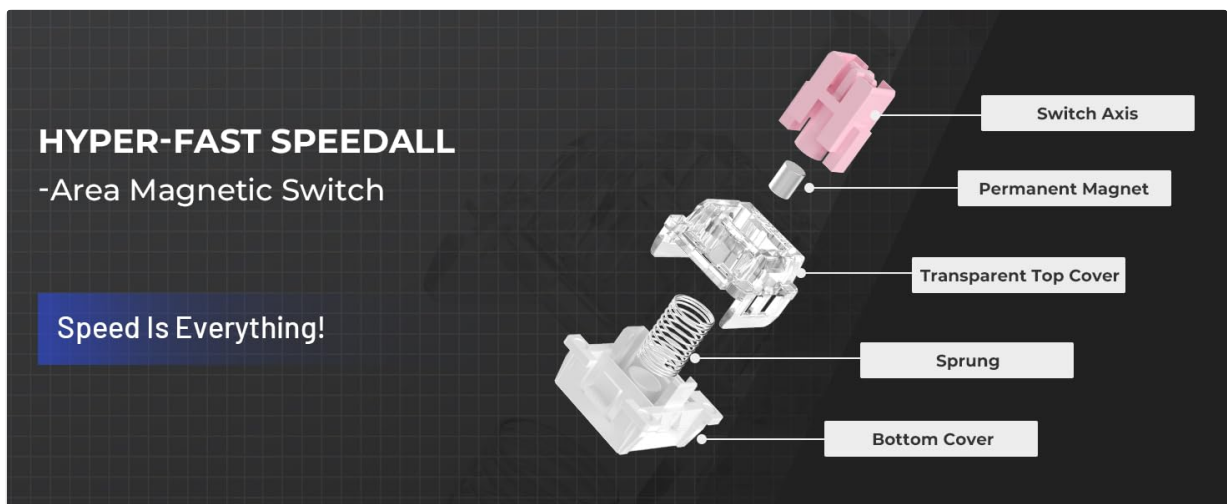

Figure 4.5: Explanation of Toggle Key (TGL), showing how a single keypress can toggle a continuous action.

4.3 Gasket Mount & Hot-Swap Design

The keyboard features a gasket-mounted structure for a quiet, stable, and smooth typing experience. It includes a full-key hot-swappable PCB base, compatible exclusively with Outemu magnetic switches. High-precision, pre-lubed satellite stabilizers are used for larger keys to reduce wobbliness.



Figure 4.6: Internal construction showing sound dampening materials like Poron foam, IXPE, and silicone bottom cotton for a quieter typing experience.



Figure 4.7: The hot-swappable PCB allows for easy replacement of Outemu magnetic switches.



Figure 4.8: Detailed specifications and force curve for the Outemu Magnetic Switches.

4.4 RGB Backlighting & PBT Keycaps

The keyboard features a built-in RGB LED lamp with 16.8 million colors, offering 18 backlit modes and 9 light colors. It comes with OEM triple-color theme non-shine-through PBT keycaps, known for their durability and clear legends.



Figure 4.9: The keyboard features vibrant RGB backlighting with 18 modes and 16.8 million colors.

4.5 8K Hz Polling Rate

Experience unparalleled response with an 8K Hz polling rate, providing a 0.125ms response time. This ensures minimal latency and immediate input registration, giving you a competitive edge.



Figure 4.10: The keyboard boasts an 8K Hz polling rate for ultra-low latency and quick response.

Video 4.2: A demonstration highlighting the rapid trigger capabilities of the keyboard, emphasizing its speed and precision.

5. OPERATING INSTRUCTIONS

5.1 Basic Usage

Once connected, the keyboard functions as a standard USB keyboard. You can begin typing immediately.

5.2 Software Customization

To unlock the full potential of your XVX G75 keyboard, download and install the dedicated software from the official OHY website. The software allows you to:

- Remap keys
- Set macros
- Adjust lighting modes and create custom effects
- Configure DKS, MT, and TGL functions
- Customize actuation points for magnetic switches

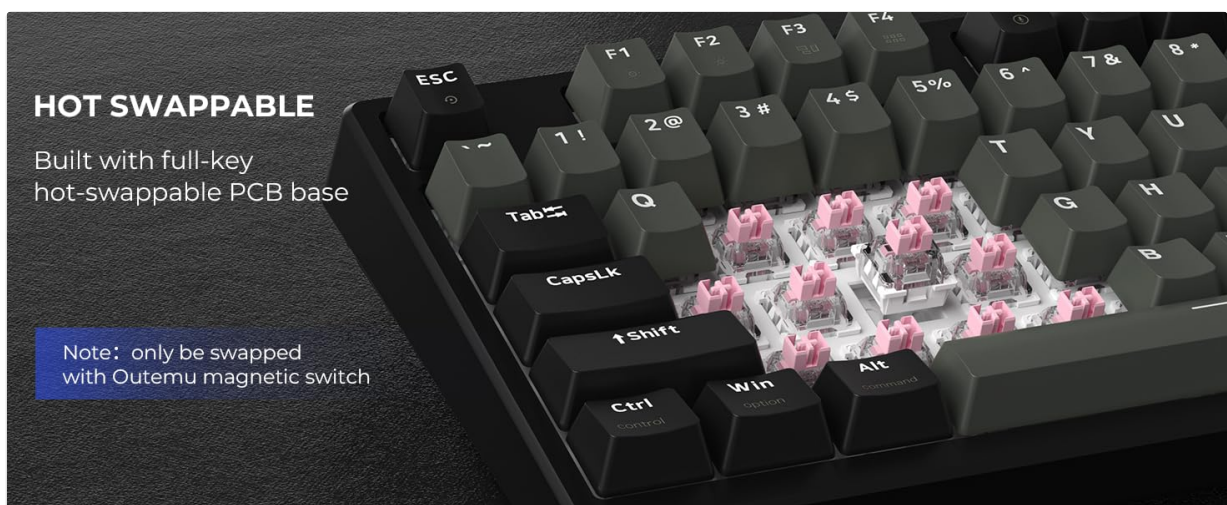

Figure 5.1: Overview of the professional software interface for comprehensive keyboard customization.

5.3 Switching Between Windows and Mac Modes

To switch between Windows and Mac operating system compatibility modes, press the following key combinations:

- **FN + Q:** Switch to Windows mode
- **FN + W:** Switch to Mac mode

5.4 Adjusting Backlighting

Use the following key combinations to control the keyboard's backlighting:

- **FN + INS:** Switch between different backlit modes.
- **FN + DEL:** Switch between different light colors.

6. MAINTENANCE

6.1 Cleaning

To clean your keyboard, disconnect it from your computer. Use a soft, dry cloth to wipe down the keycaps and chassis. For deeper cleaning, you may use a can of compressed air to remove debris from between the keys. Avoid using harsh chemicals or abrasive materials.

6.2 Switch Replacement

The keyboard's hot-swappable design allows for easy replacement of Outemu magnetic switches. When replacing switches, ensure the new switches are also Outemu magnetic switches. After changing switches, **recalibration in the software is necessary** to ensure proper functionality and accurate actuation point detection.

7. TROUBLESHOOTING

- **Keyboard not responding:**
 - Ensure the USB cable is securely connected to both the keyboard and the computer.
 - Try connecting the keyboard to a different USB port on your computer.
 - Restart your computer.
- **Backlighting not working or incorrect:**
 - Check the lighting settings in the keyboard software.
 - Use FN + INS and FN + DEL to cycle through lighting modes and colors.
- **Keys not registering or double-typing:**
 - Ensure the keyboard software is up to date.
 - If you have recently swapped switches, perform a recalibration in the software.
 - Check for any debris under the affected keycap.
- **Software not detecting keyboard:**
 - Ensure the keyboard is properly connected via USB.
 - Try reinstalling the keyboard software.
 - Temporarily disable any antivirus or firewall software that might be interfering.

8. SPECIFICATIONS

Feature	Detail
Brand	OHY
Model	XVX G75
Layout	75% (85 Keys)
Switch Type	Magnetic Switch (Hall Effect)
Actuation Point	Adjustable 0.3-4.0 mm
Polling Rate	8K Hz
Connectivity	Wired (USB-C)
Keycaps	PBT (Non-shine-through)
Backlighting	RGB (16.8 million colors, 18 modes)
Mounting Style	Gasket Mount
Hot-Swappable	Yes (Outemu magnetic switches only)
Compatibility	PC, Mac (switchable)
Material	Plastic
Item Weight	2.27 pounds
Package Dimensions	15.39 x 6.73 x 2.44 inches

9. WARRANTY AND SUPPORT

For warranty information and technical support, please refer to the official OHY website or contact their customer service. Keep your purchase receipt for warranty claims.

10. SAFETY INFORMATION

- Do not expose the keyboard to liquids or excessive moisture.
- Avoid extreme temperatures.
- Do not attempt to disassemble or modify the keyboard, as this may void the warranty and cause damage.
- Keep out of reach of children.