



[Manuals.plus](#) /

› [RIOWOIS](#) /

› RIOWOIS Soundbar DS6301G User Manual

## RIOWOIS RIOWOIS Soundbar DS6301G

# RIOWOIS Soundbar DS6301G User Manual

Model: RIOWOIS Soundbar DS6301G

---

## INTRODUCTION

---

Thank you for purchasing the RIOWOIS Soundbar DS6301G. This compact and powerful soundbar is designed to enhance your audio experience for smart TVs, PCs, and projectors, delivering clear sound with customized bass. Please read this manual carefully before using the product to ensure proper operation and to maximize its performance.



Image: The RIOWOIS Soundbar DS6301G positioned neatly below a television, showcasing its compact design and how it integrates into a home entertainment setup.

## SAFETY INFORMATION

---

To ensure safe operation and prevent damage, please observe the following safety precautions:

- Do not expose the soundbar to rain, moisture, or extreme temperatures.
- Do not block any ventilation openings.
- Use only the power adapter supplied with the unit.
- Do not attempt to disassemble or modify the soundbar. Refer all servicing to qualified personnel.
- Keep the soundbar away from strong magnetic fields.
- Clean only with a dry cloth.

## WHAT'S IN THE BOX

---

Verify that all components are present in the package:

- RIOWOIS Soundbar DS6301G
- Remote Control
- Power Adapter
- 3.5mm AUX Cable
- Optical Cable

- Wall Mount Kits
- User Manual (this document)



Image: An overhead view displaying all items included in the RIOWOIS Soundbar package: the soundbar itself, remote control, power adapter, 3.5mm AUX cable, optical cable, wall mount kits, and the user manual.

## PRODUCT OVERVIEW

### Soundbar Features

- Compact design, suitable for various setups.
- DSP (Digital Signal Processing) with three sound effects: Movie, Music, News.
- Compatible with Fire TV Remote control.
- Multiple connectivity options: Bluetooth, Optical, AUX.
- Wall-mountable design.
- Equipped with Dual Square Horn Drivers for 40 Watts of audio output.



Image: An illustrative diagram showing the internal components of the soundbar, highlighting the dual square horn drivers responsible for its 40 Watts of audio output.

## Controls and Ports

Familiarize yourself with the soundbar's controls and connection ports:

- **Power Button:** Turns the soundbar on or off.
- **Volume Buttons (+/-):** Adjusts the volume level.
- **Mode Button (M):** Switches between input modes (Bluetooth, AUX, Optical).
- **AUX IN Port:** For connecting devices via 3.5mm audio cable.
- **OPT IN Port:** For connecting devices via optical cable.
- **DC IN Port:** For connecting the power adapter.



Image: A detailed view of the soundbar's rear panel, clearly showing the AUX IN, OPT IN, and DC IN ports, along with the power, volume, and mode buttons.

## SETUP

---

### Placement Options

The soundbar can be placed on a flat surface or mounted on a wall.

#### Desktop Placement

Place the soundbar on a stable, flat surface directly in front of your TV, PC monitor, or projector. Ensure it does not block the screen or any IR remote sensors.

#### Wall Mounting

Use the included wall mount kits to securely attach the soundbar to a wall. Follow the instructions provided with the wall mount kit for safe installation.



Image: The RIOWOIS Soundbar elegantly mounted on a wall, positioned beneath a television, demonstrating its wall-mountable capability and space-saving design.



Image: A wider view of the soundbar installed on a wall in a modern living room, highlighting its seamless integration with home decor.

## Connecting Your Soundbar

### Optical Connection (Recommended for TV)

1. Connect one end of the optical cable to the OPT OUT port on your TV.
2. Connect the other end of the optical cable to the OPT IN port on the soundbar.
3. Plug the power adapter into the soundbar's DC IN port and then into a power outlet.
4. Turn on the soundbar and select "OPT" mode using the Mode button on the soundbar or remote.

### AUX Connection (for various devices)

1. Connect one end of the 3.5mm AUX cable to the headphone jack or audio output on your device (e.g., PC, smartphone).
2. Connect the other end of the AUX cable to the AUX IN port on the soundbar.
3. Plug the power adapter into the soundbar's DC IN port and then into a power outlet.
4. Turn on the soundbar and select "AUX" mode using the Mode button on the soundbar or remote.

### Bluetooth Connection (for wireless streaming)

1. Plug the power adapter into the soundbar's DC IN port and then into a power outlet.
2. Turn on the soundbar and select "BT" (Bluetooth) mode using the Mode button on the soundbar or remote. The indicator light will flash.
3. On your device (smartphone, tablet, PC), enable Bluetooth and search for "RIOWOIS Soundbar DS6301G".
4. Select the soundbar from the list to pair. Once paired, the indicator light will stop flashing and remain solid.



Image: The soundbar positioned on a desk with a computer setup, demonstrating its Bluetooth streaming capability with a smartphone displaying music playback.

### Adjusting TV Settings with Optical Cable

For optimal sound quality and to avoid issues like silent or noisy output when using the optical connection, you may need to adjust your TV's audio settings. Ensure your TV's digital audio output is set to PCM 2.0 Stereo and disable Dolby/DTS.

## How to adjust TV settings with optical cable?

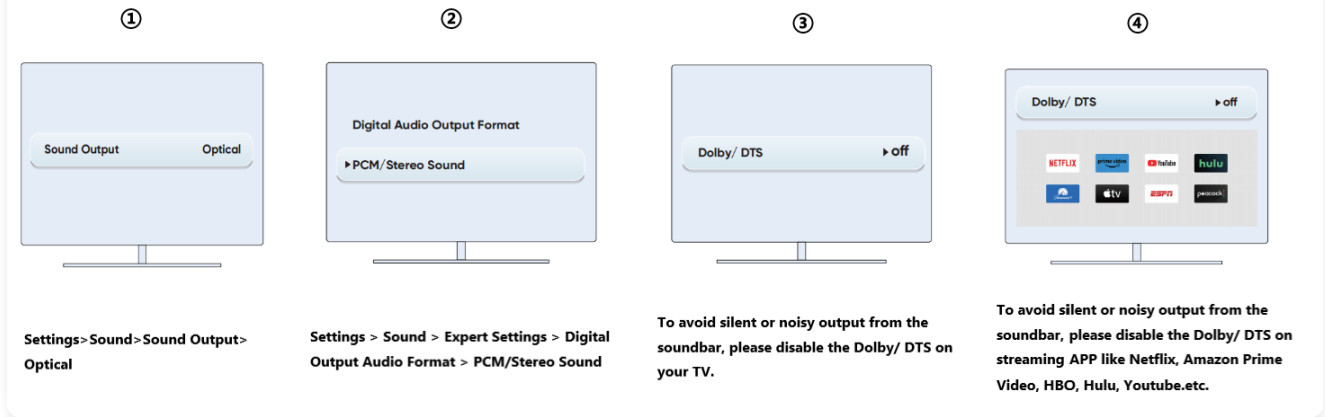

Image: A visual guide illustrating the four steps to configure TV audio settings for optical cable connection, including setting sound output to Optical, digital audio format to PCM/Stereo Sound, and disabling Dolby/DTS.

1. Go to TV Settings > Sound > Sound Output > Select **Optical**.
2. Go to TV Settings > Sound > Expert Settings > Digital Output Audio Format > Select **PCM / Stereo Sound**.
3. To avoid silent or noisy output from the soundbar, please disable the Dolby/DTS on your TV.
4. For streaming apps (Netflix, Amazon Prime Video, Hulu, YouTube, etc.), also ensure Dolby/DTS is disabled within the app's audio settings if available.

## OPERATING INSTRUCTIONS

### Power On/Off

Press the Power button on the soundbar or the remote control to turn the unit on or off.

### Mode Selection

Press the "M" (Mode) button on the soundbar or the "Mode" button on the remote control to cycle through input sources: Bluetooth (BT), AUX, Optical (OPT).

### Volume Control

Use the Volume + and - buttons on the soundbar or the remote control to adjust the volume. The soundbar can reach up to 98 dB maximum volume.



Image: A family enjoying music in their living room, with the RIOWOIS Soundbar in the foreground, illustrating its capability to produce up to 98 dB maximum volume for an immersive audio experience.

### Sound Effects (DSP Modes)

The soundbar features three DSP sound modes to optimize your listening experience:

- **Movie Mode:** Enhances dialogue clarity and surround sound effects for films.
- **Music Mode:** Provides a balanced audio profile for music playback.
- **News Mode:** Optimizes vocal frequencies for clear speech in news broadcasts or podcasts.

Press the corresponding button (Movie, Music, News) on the remote control to switch between these modes.



Image: A triptych showing three different scenarios: a music concert, a news broadcast, and a movie scene, each paired with the soundbar to demonstrate its specialized sound modes for Music, News, and Movies.

## Remote Control Usage

The included remote control provides full functionality for the soundbar. It is also compatible with Fire TV remote controls for convenience.



Image: The RIOWOIS Soundbar positioned below a television, with an overlay text indicating its compatibility with Fire TV remotes, simplifying control for users.



Image: A close-up shot of the soundbar's remote control, showing its various buttons for power, volume, mode selection, and sound effects.

## MAINTENANCE

To maintain the performance and appearance of your soundbar:

- Wipe the surface with a soft, dry cloth. Do not use liquid cleaners or aerosol sprays.
- Keep the soundbar free from dust and debris.
- Ensure proper ventilation by not covering the soundbar's vents.
- Avoid placing heavy objects on top of the soundbar.

## TROUBLESHOOTING

Problem	Possible Cause	Solution
No sound	Soundbar not powered on. Incorrect input mode selected. Cables not connected properly. TV audio settings incorrect (for Optical).	Ensure soundbar is powered on. Select the correct input mode (BT, AUX, OPT). Check all cable connections. Adjust TV audio output to PCM 2.0 Stereo and disable Dolby/DTS.
Distorted sound	Volume too high. Source audio quality is poor. TV audio settings incorrect (for Optical).	Lower the volume. Try a different audio source. Adjust TV audio output to PCM 2.0 Stereo and disable Dolby/DTS.
Bluetooth not pairing	Soundbar not in BT mode. Device too far from soundbar. Bluetooth interference.	Ensure soundbar is in BT mode (flashing indicator). Move device closer to soundbar (within 10 meters). Turn off other Bluetooth devices nearby.
Remote control not working	Batteries are dead or inserted incorrectly. Obstruction between remote and soundbar.	Replace batteries and check polarity. Ensure clear line of sight to the soundbar's IR receiver.

## SPECIFICATIONS

Feature	Detail
Model Name	RIOWOIS Soundbar DS6301G
Dimensions (D x W x H)	3.5"D x 17"W x 2.5"H
Weight	2.42 pounds
Speaker Type	Soundbar
Speaker Maximum Output Power	40 Watts
Surround Sound Channel Configuration	2.0
Connectivity Technology	Bluetooth, Auxiliary, Optical
Bluetooth Range	10 Meters

Feature	Detail
Audio Encoding	PCM 2.0 Stereo
Signal-to-Noise Ratio	80 dB
Material	Acrylonitrile Butadiene Styrene (ABS)
Mounting Type	Wall Mount
Power Source	Corded Electric

## WARRANTY AND SUPPORT

---

RIOWOIS proudly offers an extensive worry-free after-sale service for our soundbar, ensuring your peace of mind for FIVE whole years. We also provide free lifetime replacements for accessories including optical cable, AUX cable, wall mount kits, remote, etc.

Our dedicated after-sales team is available 24/7 round the clock to assist you with any product-related concerns. For support, please contact us via:

- **Email:** [Insert Customer Support Email Here, if available]
- **Phone:** [Insert Customer Support Phone Number Here, if available]
- **Online:** Visit the [RIOWOIS Store on Amazon](#) for more information and contact options.

Please have your model number (RIOWOIS Soundbar DS6301G) and purchase details ready when contacting support.

---