

[Manuals.plus](#) /

› [Junsun](#) /

› Junsun Android 13 Car Radio Stereo User Manual for Subaru Forester WRX Impreza (2013-2015)

Junsun JS Forester 315

Junsun Android 13 Car Radio Stereo User Manual

MODEL: JS FORESTER 315

For Subaru Forester, WRX, Impreza (2013-2015)

Introduction

This manual provides detailed instructions for the installation, operation, and maintenance of your Junsun Android 13 Car Radio Stereo. Please read this manual thoroughly before installation and use to ensure proper functionality and safety. This head unit is designed for Subaru Forester, WRX, and Impreza models from 2013 to 2015, and is compatible with factory sound systems.

Included Components

Verify that all items listed below are present in your package:

- Head unit
- Microphone
- Cables (Power Cable, RCA Cable, Reversing Line, USB Cables)
- GPS Module
- Canbus Box
- Crowbar (Pry Tool)
- Screwdriver
- Gift Camera (Backup Camera)

DSP Sound System

Equip with 36EQ, enjoy pure timbre bring happiness, including Normal, Jazz, Pop, Classical, Rock, ect. Feel the high sound quality make you immersive.

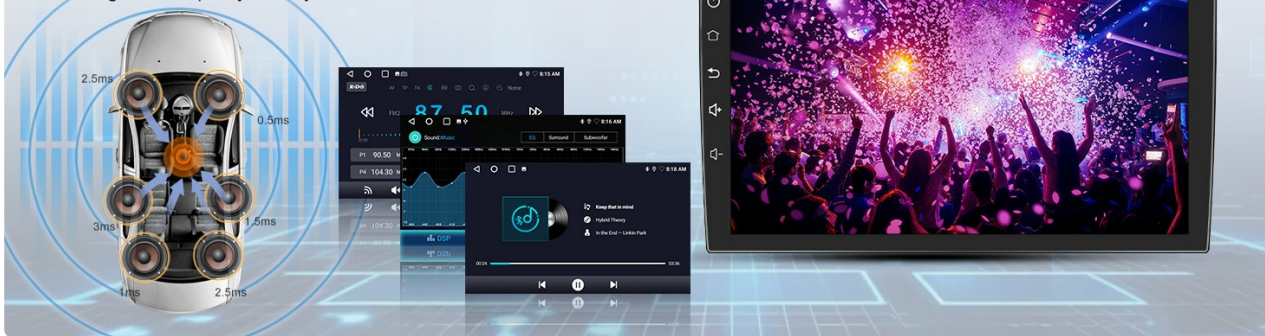

Image: Overview of all included components: Head unit, various cables, GPS module, Canbus box, tools, and backup camera.

Specifications

Brand	Junsun
Model Name	JS Forester 315
Operating System	Android 13
Screen Size	9 Inches
Resolution	1280x720 (IPS)
Memory Storage Capacity	32 GB ROM, 2 GB RAM
Connectivity Technology	Bluetooth, Wi-Fi, USB
Special Features	CarPlay, Android Auto, SWC, GPS, WiFi, BT, FM, RDS, AM, DSP, Rear Camera Support
Audio Output Mode	Stereo
Mounting Type	Dashboard Mount

Premium 1280*720 IPS Screen Grade A Quality

9 "
Screen

1280*720
Resolution

1080P
VideoPlayback



Image: The 9-inch HD touch screen with 1280x720 resolution, supporting 1080P video playback.

Setup and Installation

Proper installation is crucial for the optimal performance of your car stereo. It is recommended to have this unit installed by a professional if you are not familiar with car electronics. Ensure the vehicle's battery is disconnected before beginning installation.

General Installation Steps:

1. **Remove Decorative Panel:** Carefully use the provided pry tool (crowbar) to remove the decorative panel surrounding your factory radio.
2. **Remove Factory Radio:** Unscrew and remove the fixing screws holding the factory radio in place. Gently pull out the old player.
3. **Disconnect Wires:** Disconnect all plugs and cables from the back of the factory radio.
4. **Transfer Air Vents:** Remove the air vents from the old decorative panel and install them into the new product decoration frame.
5. **Connect Cables:** Introduce the USB cables, reversing image video cable, and GPS antenna into the

center console. Connect the power harness plug to the corresponding socket on the back of the new head unit. Connect the reversing image video plug and detection line. Connect the ground wire of the power harness to the car's body iron frame.

6. **Install Head Unit:** Carefully install the new head unit into the center console, ensuring all wires are properly routed and not pinched. Secure it with screws.
7. **Reattach Panel:** Reattach the decorative panel, ensuring it snaps securely into place.



**For Subaru Forester 2013-2015
For Subaru WRX 2013-2015 /
Subaru WRX STI 2013-2015
For Subaru Impreza 2013-2015**



The frame for this unit is black and will not fit models where the AC vents are silver. If you have accidentally purchased the wrong one then we can also supply you with the right frame. (The clips on the back of the frame are in a different location)

Image: The Junsun Android 13 Car Radio Stereo unit and its compatible Subaru Forester/WRX/Impreza dashboard frame.

Installation Videos:

Video: Detailed installation guide for the Subaru Forester 2013-2018 Android Head Unit. This video demonstrates the process of removing the old unit, connecting wires, and installing the new head unit.

Video: Step-by-step instructions on how to install an aftermarket radio for Subaru Forester models.

Operating Instructions

CarPlay / Android Auto

The head unit supports wireless CarPlay and Android Auto. Connect your smartphone via Bluetooth to project your phone's interface onto the large screen. This allows for easy access to navigation, music, calls, and other apps using voice commands (Siri/Google Assistant).



Image: The CarPlay and Android Auto interfaces displayed on the car stereo, showing various app icons.

Video: Demonstrates how to connect your smartphone to the car stereo for wireless CarPlay functionality.

Bluetooth Connectivity

The built-in Bluetooth 4.0 allows for fast pairing with your smartphone. Enjoy hands-free calling and high-quality audio streaming. The external microphone ensures clear communication during calls.

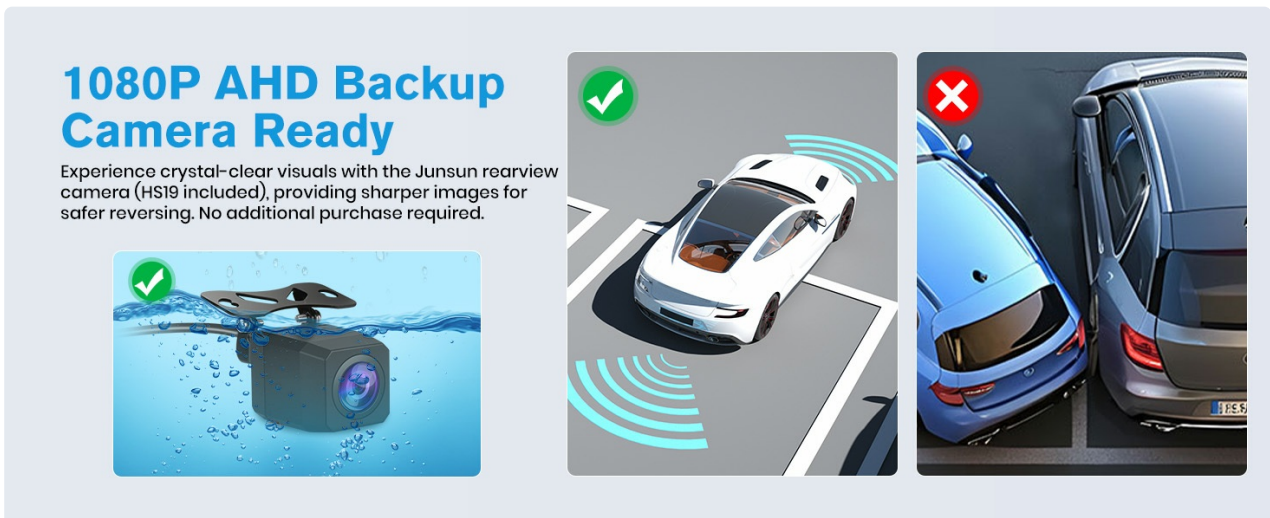

Image: Illustration of Bluetooth 4.0 features, including hands-free calling and music playback.

Video: Guide on how to correctly connect your device via Bluetooth to the car stereo.

GPS Navigation

The head unit features a built-in GPS module supporting both online and offline navigation applications. Download your preferred navigation apps from the Google Play Store to ensure you never get lost.

GPS Navigation

Real-time online/offline map navigation



Image: The GPS navigation interface showing real-time online/offline map navigation with various map applications.

FM/AM Radio with RDS

Enjoy your favorite radio stations with the built-in FM/AM tuner. RDS (Radio Data System) provides additional information such as station name and song title where available.

DSP Sound System

Experience enhanced audio quality with the integrated Digital Sound Processor (DSP). The 32-band EQ allows for precise sound adjustments, offering various preset sound effects (Normal, Jazz, Pop, Classical, Rock, etc.) and customizable settings for a realistic and immersive music experience.

Support Harman Kardon sound system

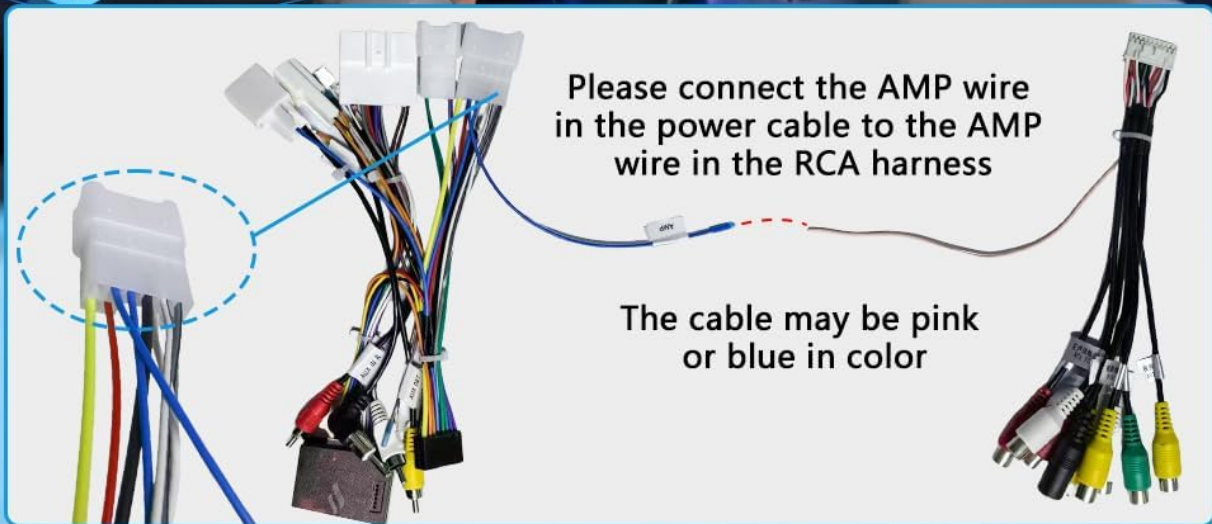

Image: The 32-band EQ DSP interface, allowing precise sound adjustments for a realistic and immersive music experience.

Steering Wheel Control (SWC)

The head unit supports your vehicle's original steering wheel controls. This allows you to operate the stereo without diverting your attention from the road, enhancing safety and convenience. The wiring harness is designed to integrate with factory SWC functionality.

Steering Wheel Control

No need to divert your eyes, the center screen can be operated via the controls on the steering wheel



Image: The Steering Wheel Control interface, showing how to map physical steering wheel buttons to various stereo functions.

Video: Instructions on how to switch the steering wheel control type for proper functionality.

Rear Camera Support

The unit supports a backup camera, providing clear visuals for safer reversing. A free backup camera is included with the product.

5GHz WiFi

Once connected to wifi or your phone's hotspot, you can download offline maps or use online maps at any time



Image: Display of the 1080P AHD backup camera view with parking assist lines, showing clear visuals for reversing.

Maintenance

To ensure the longevity and optimal performance of your Junsun car stereo, follow these maintenance guidelines:

- **Screen Cleaning:** Use a soft, lint-free cloth to gently wipe the screen. Avoid abrasive cleaners or harsh chemicals that could damage the display.
- **Software Updates:** Periodically check for software updates from the manufacturer to ensure you have the latest features and bug fixes.
- **Temperature Control:** Avoid exposing the unit to extreme temperatures for extended periods.
- **Cable Connections:** Periodically check all cable connections to ensure they are secure and free from damage.

Troubleshooting

If you encounter issues with your car stereo, refer to the following common problems and solutions:

- **No Power:** Check all power connections. Ensure the car battery is properly connected and charged. Verify the fuse is intact.
- **No Sound or Poor Sound Quality:** Check speaker connections. Ensure the volume is not muted or too low. Adjust the DSP equalizer settings (refer to the DSP Sound System section). Some users report initial muddy sound that improves with EQ adjustment.
- **Steering Wheel Controls Not Working:** Ensure the SWC wires are correctly connected to the harness. Access the SWC settings in the unit's menu and perform the learning process (refer to the Steering Wheel Control section). Adjust SWC button values (SWC1, SWC2, SWC3) if needed.
- **Backup Camera Not Displaying:** Verify the reversing line and video input cables are securely connected. Ensure the camera is receiving power.
- **Wi-Fi/Bluetooth Connectivity Issues:** Ensure your phone's Wi-Fi and Bluetooth are enabled. Try restarting both the head unit and your phone.
- **HVAC Vent Misalignment:** Some users have reported issues with HVAC vent tabs not aligning during installation. Double-check the fitment and ensure the correct frame is used for your specific vehicle model and year.

Warranty and Support

This Junsun car stereo comes with a **1-Year Warranty**. For technical support, installation assistance, or warranty claims, please contact Junsun Car Electronics directly through their Amazon store page. They typically respond within 24 hours due to time differences.

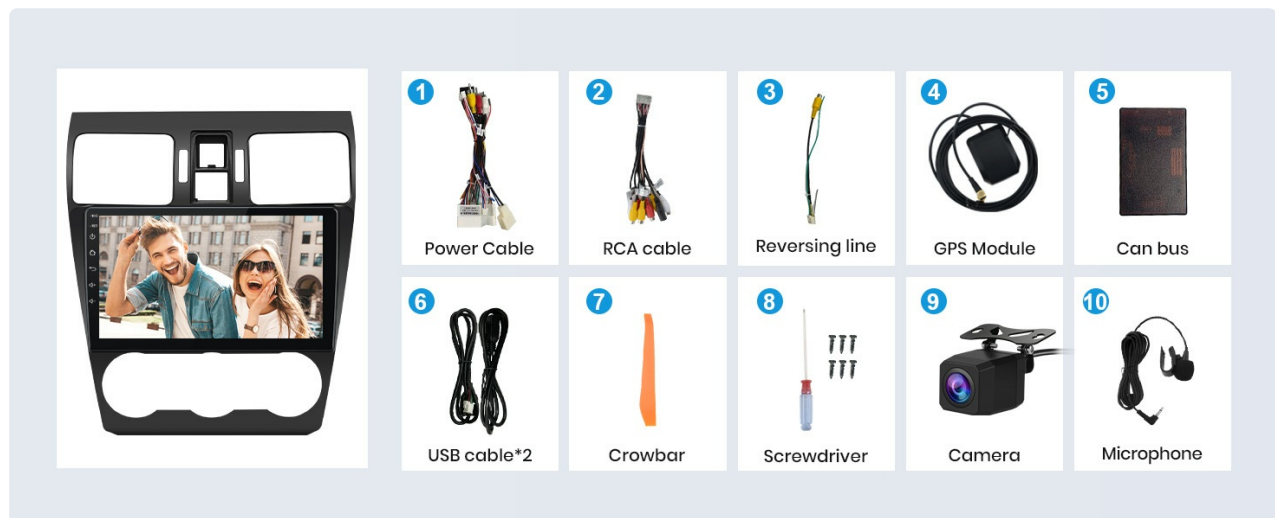

Image: Instructions on how to contact Junsun Car Electronics for support via their Amazon store page.