

Andoer SY-DB0102-1

Andoer Digital Camera Compact SY-DB0102-1 User Manual

Model: SY-DB0102-1

1. INTRODUCTION

Thank you for purchasing the Andoer Digital Camera Compact. This user-friendly camera is designed for beginners and children, offering a range of features to capture your precious moments. Please read this manual carefully to ensure proper use and optimal performance of your device.



Figure 1: Andoer Digital Camera Compact (Red)

2. PACKAGE CONTENTS

Verify that all items listed below are included in your package:

- Digital Camera
- 2 x 550mAh Lithium-Ion Batteries
- Type-C Charging Cable
- Wrist Strap
- Carrying Bag
- 32GB TF Card
- User Manual



Figure 2: Included Accessories

3. CAMERA OVERVIEW

Familiarize yourself with the main components of your camera:

- **Front:** Digital Lens, Built-in Flash, 2.8-inch TFT Display (for selfies/preview), Shutter Button.
- **Rear:** 2.8-inch LCD Display, Navigation Buttons (Up/Down/Left/Right/OK), Menu Button, Display Button, Zoom In/Out Buttons.
- **Side:** SD Card Slot, Type-C Port.
- **Bottom:** Battery Compartment, Tripod Mount.

Snap with Ease:

A Stylish, Compact Camera for Kids & Beginners in a Durable Aluminum Shell.

Perfect for teens, kids, and beginners. More compact than iPhone 15 for easy use and storage.



Only 78g

Figure 3: Camera Dimensions and Design

4. SETUP

4.1. Battery Installation and Charging

1. Open the battery compartment cover located on the bottom of the camera.
2. Insert a fully charged 550mAh Lithium-Ion battery, ensuring correct polarity. The battery has similar icons on both the front and back; ensure the guide pattern is facing up. Gently twist the battery lock towards the screen and hold it, then insert the battery into the battery slot.

3. Close the battery compartment cover securely.
4. To charge, connect the camera to a computer or a suitable power adapter using the provided Type-C charging cable. The red LED light will illuminate to indicate charging. Once charging is complete (approximately 2.5 hours), the LED light will automatically turn off.

Note:

- The camera comes with two batteries for extended use.
- Remove the battery when not using the camera for a long time.

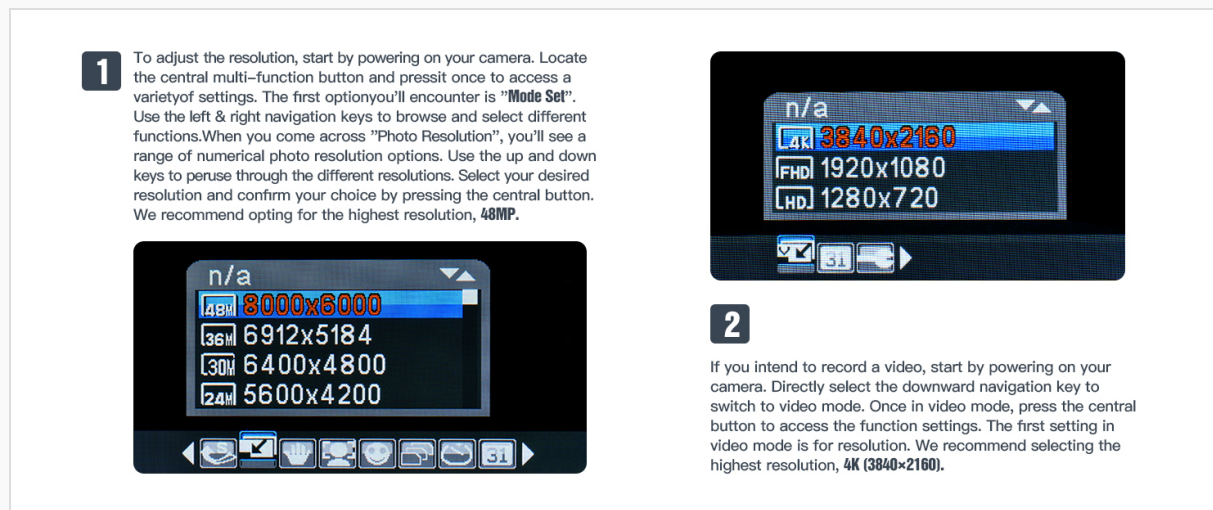

Figure 4: Battery Installation Guide



Figure 5: Camera Charging via USB-C

4.2. SD Card Insertion and Removal

This camera supports up to 32GB TF (Micro SD) storage cards. It has limited built-in memory, so inserting a TF card is essential for saving photos and videos.

1. Locate the TF card slot on the side of the camera.
2. Insert the TF card into the slot until you hear a "click" sound. The camera will display the TF card information on the LCD screen if inserted correctly.
3. To remove, gently press the TF card inward until it clicks, then release. The card will eject slightly, allowing you to pull it out.

Important Notes:

- Once the TF card is inserted, all photos and videos will be saved to the card.

- Formatting the card will clear all data, including protected data.
- Do not remove the TF card during formatting to avoid damage.

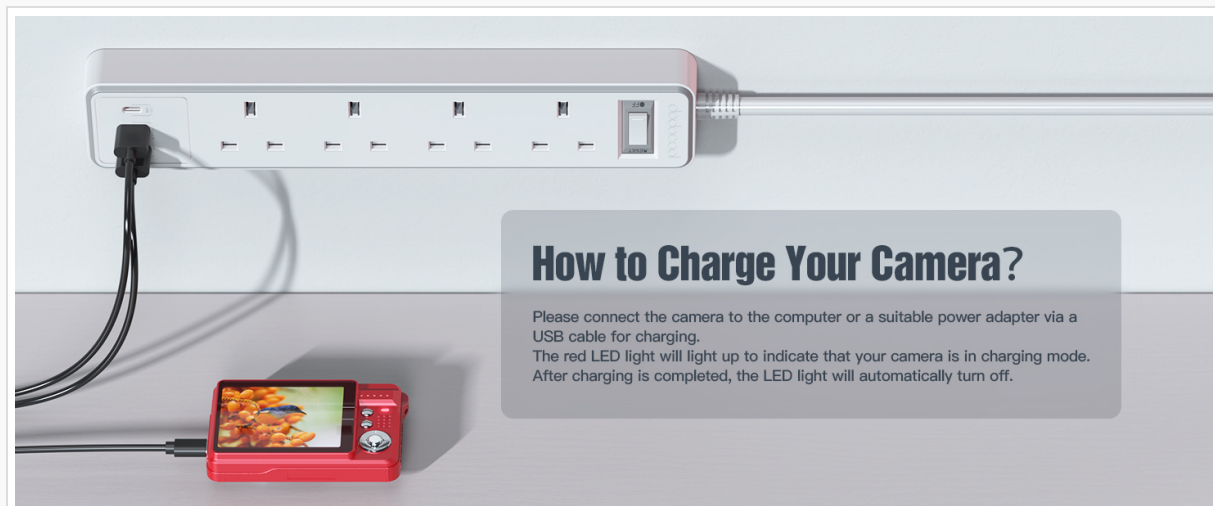

Figure 6: SD Card Insertion

5. OPERATING THE CAMERA

5.1. Power On/Off

Press and hold the Power button (usually located on the top or side) to turn the camera on or off.

5.2. Basic Photography

In Photo mode, aim the camera at your subject and press the Shutter button to capture an image. The camera features:

- **Auto Focus:** The camera automatically adjusts focus for crisp, clear images.
- **16X Digital Zoom:** Use the zoom buttons (W/T) to magnify or reduce your subject.
- **Built-in Flash:** Automatically activates in low-light conditions or can be manually controlled via settings.

How to Insert Remove SD Card?

This camera can support up to 32GB of storage cards. However, it has limited built-in memory which can only store a small number of test photos. If the camera runs low on memory or the battery is removed, it will automatically shut down and the photos will not be saved. To avoid losing any photos, it is important to insert a TF card before using the camera.

To insert the TF card, locate the TF card slot on the side of the camera. Follow the correct installation method as shown in the provided figure. When you hear a "click" sound, it indicates that the TF storage card is correctly inserted. The camera will then display the TF card information on the LCD screen. Additionally, please note that the camera will automatically shut down within a few seconds after the TF card is inserted.

Attention:

- 1、Once the TF card is inserted, all photos taken will be saved in the TF card.
- 2、Formatting will clear all data, including data in the TF card and protected data.
- 3、Please do not move the TF card during formatting to avoid damaging it and rendering it unusable.

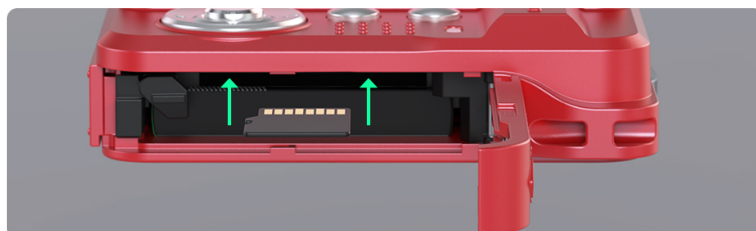

Figure 7: Autofocus Functionality



Figure 8: 16X Digital Zoom

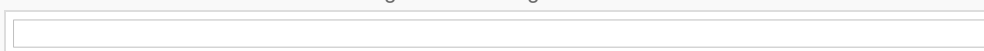

Figure 9: Built-in Flash (Fill Light)

5.3. Video Recording

To record a video, power on your camera. Directly select the downward navigation key to switch to video mode. Once in video mode, press the central button to access the function settings. The first setting in video mode is for resolution. We recommend selecting the highest resolution, 4K (3840x2160).



Figure 10: Video Resolution Settings

5.4. Special Features

- **Anti-Shake:** Reduces blur caused by camera movement for sharper photos.
- **Face Detection:** Automatically detects faces for optimal focus and exposure in portraits.
- **Smile Capture:** Automatically takes a photo when a smile is detected.
- **Self-Timer:** Set a delay (e.g., 2, 5, 10 seconds) before a photo is taken, ideal for group shots.
- **Continuous Shooting:** Captures multiple photos in quick succession for fast-paced action.

Autofocus Function

Experience effortless photography with our camera's fast and precise autofocus. Never miss a moment, capture everything in sharp detail.



Figure 11: Anti-Shake Feature

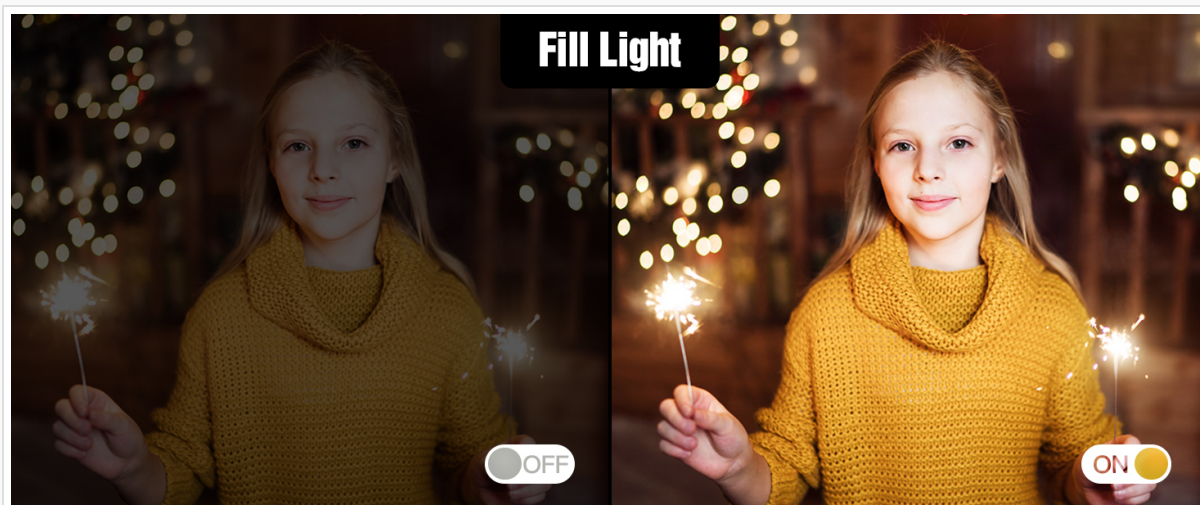

Figure 12: Face Detection and Smile Capture

5.5. Viewing Photos and Videos

Use the navigation buttons to browse through your captured photos and videos on the camera's LCD screen. Press the 'OK' button to view a selected item.

5.6. Connecting to a Computer

To download images or videos, connect the camera to your PC using the USB cable. This allows you to view your work on a larger screen and transfer files for editing or sharing.

Note:

- The camera's screen is designed to provide a preview, not the full high-resolution image. To truly appreciate the 48MP photos and 4K videos, we recommend viewing them on a computer.



Figure 13: Connecting to PC for File Transfer

6. MAINTENANCE

- Keep the camera clean by wiping it with a soft, dry cloth.
- Avoid exposing the camera to extreme temperatures, dust, or moisture.
- Store the camera in its carrying bag when not in use to protect it from scratches and impacts.
- Remove the battery if the camera will not be used for an extended period.

7. TROUBLESHOOTING

Problem	Possible Solution
Camera does not power on	Ensure the battery is fully charged and correctly inserted.
Cannot take photos/videos	Check if a TF card is inserted and has sufficient storage space. Format the TF card if necessary (after backing up data).
Images are blurry	Ensure the lens is clean. Check lighting conditions. Activate the Anti-Shake feature.
Cannot transfer files to computer	Ensure the USB cable is securely connected to both the camera and the computer. Try a different USB port or cable.

8. SPECIFICATIONS

Feature	Detail
Effective Still Resolution	48 MP
Video Resolution	3840x2160 (4K), 1920x1080
Digital Zoom	16 x

Feature	Detail
Screen Size	2.8 Inches (LCD)
Image Stabilization	Digital
Auto Focus Technology	Contrast Detection
Supported File Format	JPEG, AVI
Memory Storage Capacity	32 GB (TF Card included)
Battery Type	Lithium Ion (2 x 550mAh included)
Connectivity Technology	USB Type-C
Item Weight	95 Grams
Water Resistance Level	Not Water Resistant

9. WARRANTY AND SUPPORT

The Andoer Digital Camera Compact comes with a 1-year warranty from the date of purchase. For any problems encountered during use, please contact our professional customer support team.

You can reach customer support through the seller's contact information on the platform where you purchased the product. Typically, this involves navigating to your order history and selecting the option to contact the seller.

Packing List



1 * Digital Camera



2 * Batteries



1 * 32GB TF Card



1 * Type-C Charging Cable



1 * Users' Manual(English)



1 * Carrying Bag



1 * Wrist Strap

Figure 14: How to Contact Seller for Support