

DEATTI DET-T4

DEATTI Trail Camera DET-T4 User Manual

Model: DET-T4

1. INTRODUCTION

The DEATTI Trail Camera DET-T4 is a high-performance game camera designed for wildlife monitoring, home security, and outdoor surveillance. Featuring 48MP photo resolution and 4K video capabilities, it captures clear and detailed images and videos. With built-in WiFi and Bluetooth, users can easily connect to the camera via a mobile app for remote control and footage viewing. Its robust IP66 waterproof design ensures reliable operation in various weather conditions.

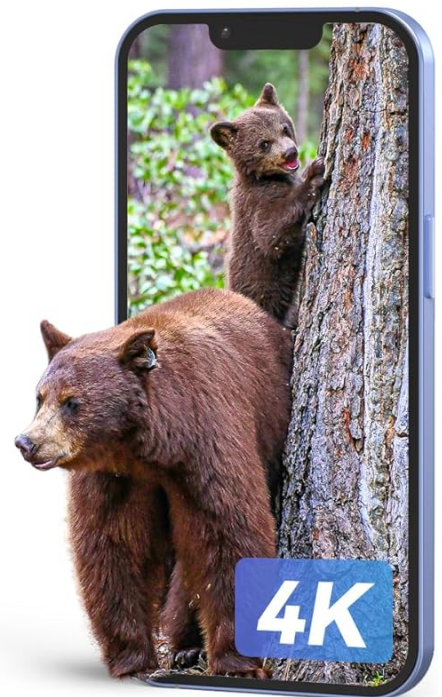

Image: The DEATTI Trail Camera DET-T4, showcasing its design and key features like 48MP, 4K, WiFi, Bluetooth, and included batteries and SD card.

Use in Multiple Scenarios



Image: Multiple scenarios where the DEATTI Trail Camera can be effectively used, such as home security, wildlife monitoring, hunting, and deterring farm burglars.

Video: An official introduction to the DEATTI Trail Camera T4, highlighting its features and capabilities for outdoor use.

2. WHAT'S IN THE BOX

Upon unboxing your DEATTI Trail Camera DET-T4, you will find the following components:

- 1 x Trail Camera (DET-T4)
- 8 x AA Batteries
- 1 x Metal Bracket
- 1 x Screwdriver
- 1 x 32GB SD Card
- 1 x User Manual



Image: All items included in the DEATTI Trail Camera package, ready for initial setup.

3. SETUP GUIDE

3.1 Initial Camera Setup

1. **Install Batteries:** Open the camera's battery compartment and insert 8 AA batteries, ensuring correct polarity.
2. **Insert SD Card:** Locate the SD card slot and insert the provided 32GB SD card until it clicks into place.
3. **Switch to SETUP Mode:** Slide the mode switch from OFF to SET. The camera's screen will power on, allowing you to configure settings.

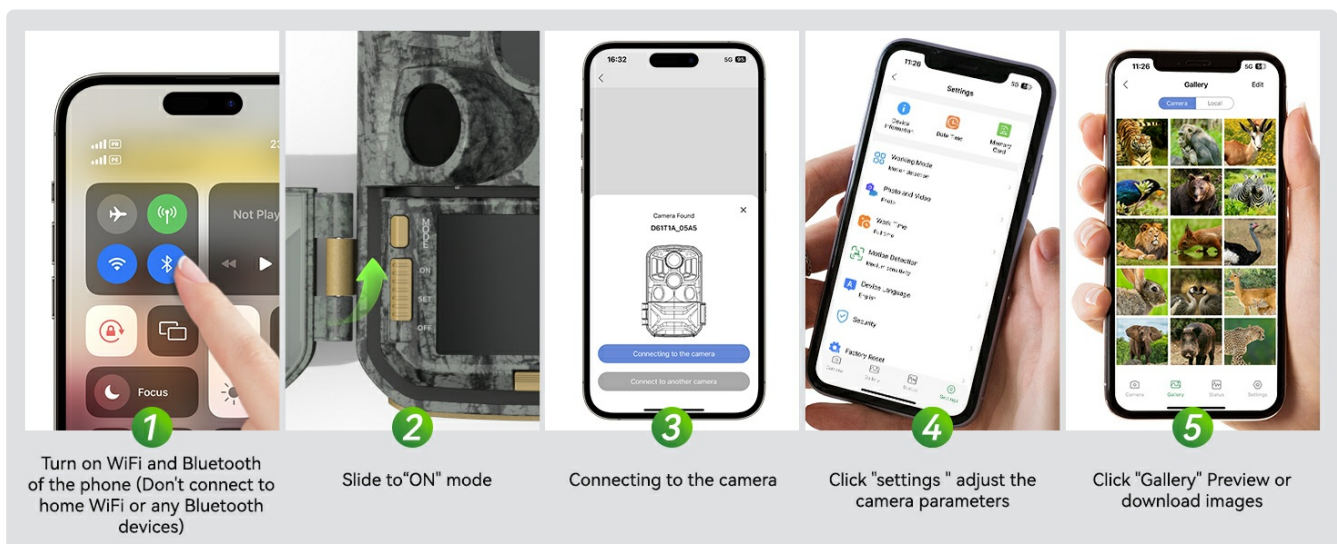

Image: Visual instructions for battery installation, SD card insertion, and setting the camera to SETUP mode.

3.2 App Connection (TrailCam Go)

The DEATTI Trail Camera connects to your smartphone via the TrailCam Go app for remote control and viewing. This connection uses the camera's built-in WiFi and Bluetooth, not your home WiFi network.

1. **Download App:** Search for "TrailCam Go" in your smartphone's app store (App Store for iOS or Google Play for

Android) and install it.

2. **Enable Bluetooth & WiFi:** On your phone, turn on both Bluetooth and WiFi. Do not connect to any home WiFi or other Bluetooth devices.
3. **Connect to Camera:** Open the TrailCam Go app. Follow the on-screen prompts to connect to your camera. Ensure the camera is in ON mode and within range (up to 20 meters).
4. **Adjust Settings:** Once connected, you can use the app to adjust camera parameters, such as photo/video resolution, trigger interval, and more.
5. **View/Download Images:** Access the gallery within the app to preview or download captured photos and videos directly to your phone.



Image: Steps for connecting the camera to the TrailCam Go app, including enabling phone settings, connecting, adjusting parameters, and viewing media.

4. OPERATING THE CAMERA

4.1 Basic Operation

After initial setup and configuration, switch the camera to ON mode. The camera will then enter infrared monitoring mode and begin capturing based on your settings.

- **Capture Modes:** The camera supports three capture modes: Photo, Video, and Photo + Video.
- **Trigger Time:** Features an impressive 0.1-second trigger time to capture fast-moving subjects.
- **Detection Range:** The camera's trigger distance reaches up to 30 meters (98 feet) during both day and night.

0.1S Trigger Time

Never miss a fast-moving moment

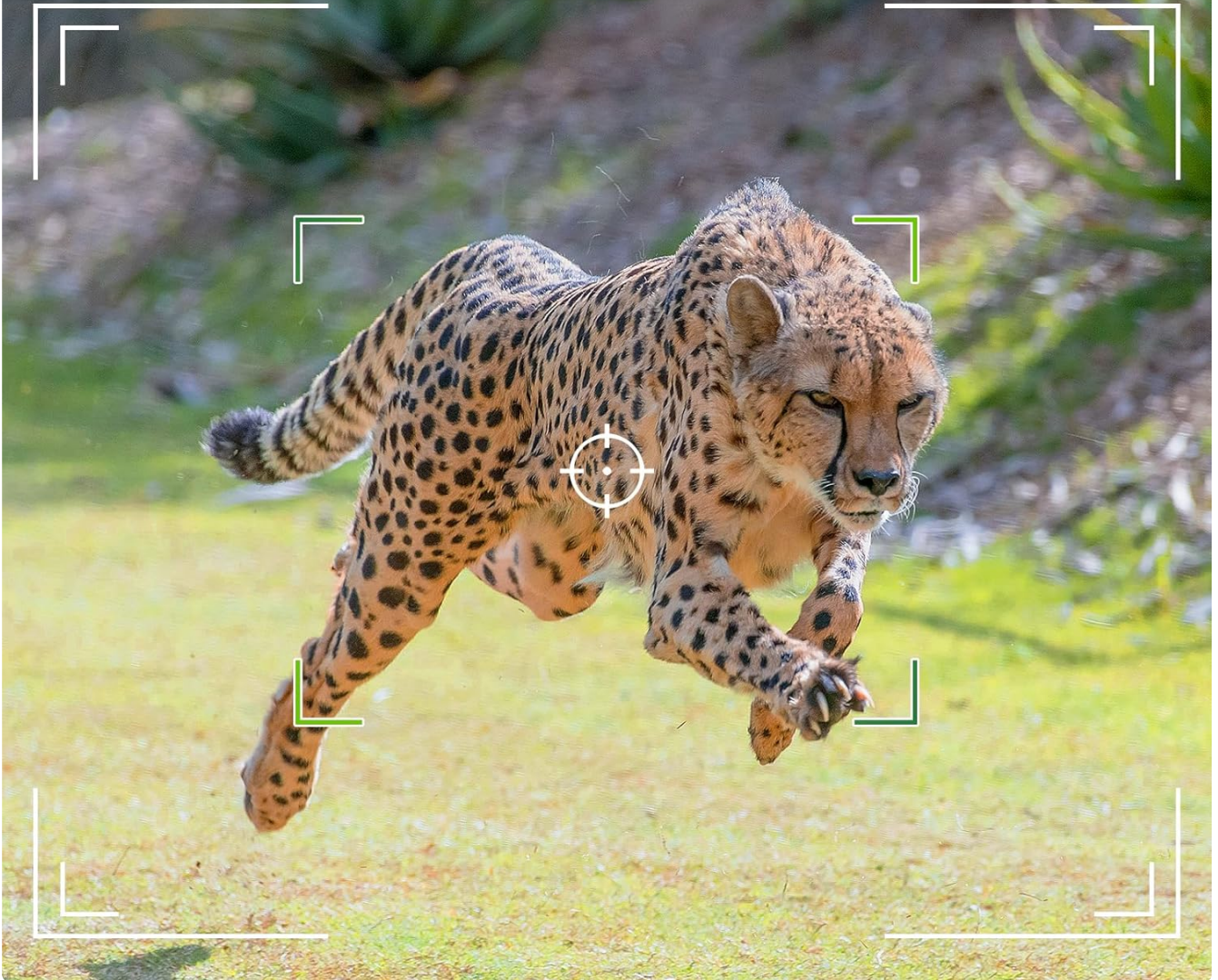

Image: The camera's rapid 0.1-second trigger time ensures that fast-moving subjects are captured effectively.

4.2 Image and Video Quality

- **Resolution:** Captures high-resolution 48MP photos and 4K (2160P) videos.
- **Night Vision:** Equipped with infrared LEDs for clear night vision up to 30 meters, invisible to animals.
- **Wide-Angle Lens:** A 120° wide-angle lens and three PIR sensors provide a broad detection field of view, capturing more animal behavior.

WiFi and Bluetooth Connection & APP Control

Built-in WiFi effective distance 8m



Image: Demonstrates the superior clarity of 48MP images and 4K videos captured by the camera.

30m Night Vision

See clearly in the dark with infrared LEDs



Up to 30m
night vision range



Excellent Night Vision



Image: Shows the camera's effective 30-meter night vision range, providing clear images in complete darkness.

120° Ultra-wide Detection Angle

Capture the full range of animal dynamics



Image: The 120-degree ultra-wide detection angle allows for capturing a broader view of animal dynamics.

5. MAINTENANCE

- **Cleaning:** Regularly clean the camera lens and PIR sensors with a soft, dry cloth to ensure optimal performance. Avoid abrasive materials.
- **Battery Replacement:** Replace all 8 AA batteries when the battery indicator shows low power. Ensure to use fresh, high-quality alkaline batteries for best results.
- **SD Card Management:** Periodically format the SD card to maintain optimal recording performance and free up space. Back up important footage before formatting.
- **Weather Protection:** While the camera is IP66 waterproof, ensure the battery compartment and ports are securely closed to prevent water ingress, especially during heavy rain or snow.

IP66 Weatherproof

All Weather Protection, Rugged housing, Easy to mount.



Image: The camera's IP66 weatherproof design provides all-weather protection and features a rugged housing for durability.

6. TROUBLESHOOTING

6.1 Common Issues & Solutions

- **Camera Not Powering On:**

- Ensure all 8 AA batteries are inserted correctly with the proper polarity.
- Check if batteries are fully charged. Replace with new batteries if necessary.
- Verify the mode switch is set to ON or SET.

- **App Connection Issues:**

- Ensure your phone's Bluetooth and WiFi are enabled, but not connected to other networks.
- Make sure the camera is in ON mode and within the 20-meter effective range of your phone.
- Try restarting both the camera (by switching OFF and then ON) and your smartphone.
- If issues persist, try reinstalling the TrailCam Go app.

• **Poor Image/Video Quality:**

- Clean the camera lens and PIR sensors.
- Check camera settings via the app or on-screen menu to ensure desired resolution (48MP/4K) is selected.
- Ensure sufficient lighting for daytime captures or proper darkness for night vision to activate.

• **No Motion Detection:**

- Verify PIR sensor sensitivity settings in the camera menu (Low, Middle, High). Adjust as needed for your environment.
- Ensure there are no obstructions directly in front of the PIR sensors.
- Check the trigger interval setting; a longer interval might miss events.

7. SPECIFICATIONS

Feature	Specification
Model Name	DET-T4
Indoor/Outdoor Usage	Outdoor
Power Source	Battery Powered (8 AA batteries included)
Connectivity Protocol	Bluetooth, Wireless
Video Capture Resolution	4K
Effective Still Resolution	48 MP
Trigger Time	0.1 seconds
Night Vision Range	30 Meters
Viewing Angle	120 Degrees
Water Resistance Level	IP66 (Water Resistant)
Flash Memory Installed Size	32 GB (SDXC)
Max Flash Memory Supported	128 GB
Control Method	App
Product Dimensions	8 x 4.6 x 3.9 inches
Item Weight	1.67 pounds

Trail Camera T4-Product Size

2.0" Color Screen to Review Photo and Videos on Camera



Image: Detailed product dimensions of the Trail Camera T4, including length, width, and height.

8. WARRANTY AND SUPPORT

For warranty information and technical support regarding your DEATTI Trail Camera DET-T4, please contact DEATTI customer service directly.

Official Email: support@deatti.com

Please have your model number (DET-T4) and purchase details ready when contacting support.