

## WAVLINK WN570HA2

# WAVLINK AC1200 Outdoor Wi-Fi Extender User Manual

Model: WN570HA2

## 1. INTRODUCTION

The WAVLINK AC1200 Outdoor Long Range Wi-Fi Extender is a high-performance networking device designed to provide robust and extended Wi-Fi coverage in outdoor environments. Utilizing Wi-Fi 5 (802.11ac) technology, it offers dual-band speeds up to 1200Mbps (300Mbps on 2.4GHz and 867Mbps on 5GHz), making it ideal for smooth HD streaming, online gaming, and other bandwidth-intensive activities. Its IP67-rated weatherproof enclosure ensures reliable operation in harsh conditions, while Power over Ethernet (PoE) simplifies installation.

# AC1200 Outdoor Wireless AP/Repeater

Eliminate Wi-Fi dead zones, speed up to 1200Mbps on dual band



Overview of the WAVLINK AC1200 Outdoor Wireless AP/Repeater capabilities.

# Powerful Connectivity & Expansive Reach

*\*Coverage may vary based on the actual environment.*

Coverage Up to

**200** Meters\*

Connect Up to

**32** Devices



The device offers extensive coverage and supports multiple connected devices.

# Access Stable Signal Wherever You Are



Yard



Park



Outdoor Cafe

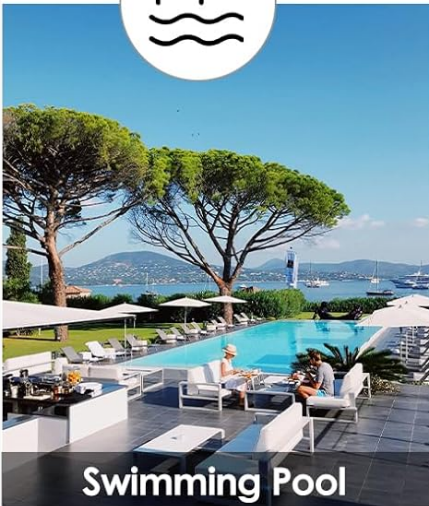

Swimming Pool

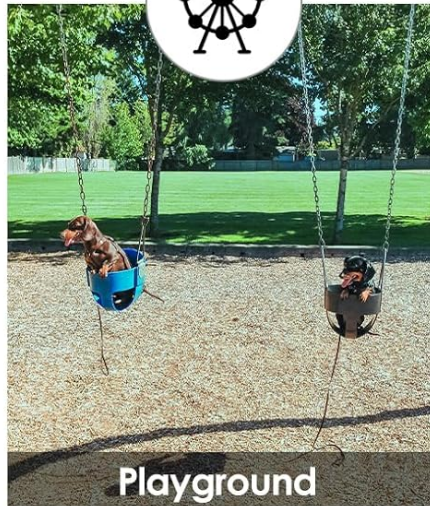

Playground

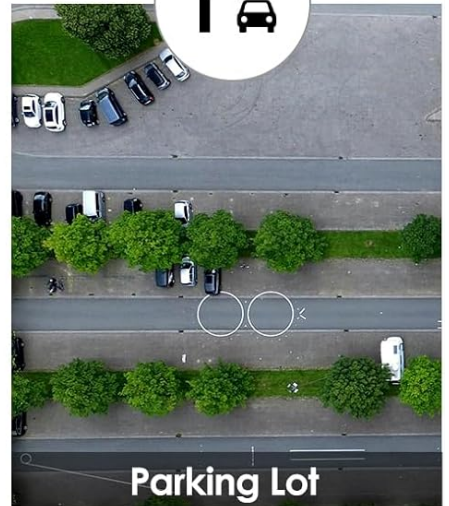

Parking Lot

The extender is suitable for a variety of outdoor environments.

## 2. PACKAGE CONTENTS

Please verify that all items listed below are present in your package:



All components included in the product package.

- 1x AC1200 Dual Band Access Point
- 2x 7dBi High-gain Antennas
- 1x RJ-45 Ethernet Cable
- 1x Power Adapter
- 1x PoE Converter

### 3. PRODUCT OVERVIEW

#### 3.1 Device Layout

Familiarize yourself with the ports and indicators on your WAVLINK AC1200 device:

## Default Parameters

5G SSID: WAVLINK-AC XXXX

2.4G SSID: WAVLINK-N XXXX

Default IP: 192.168.10.1

Password: admin

Reset(8s)

WAN/LAN 100Mbps

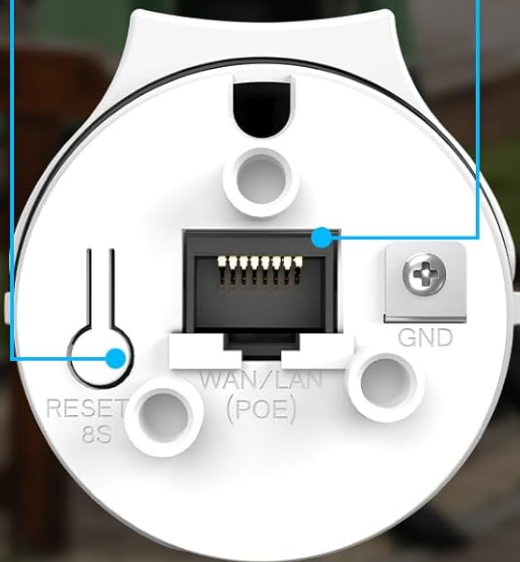

Key features and dimensions of the WAVLINK AC1200.

- **WAN/LAN (PoE) Port:** Connects to your network via Ethernet cable. Supports Power over Ethernet. Note: This port supports up to 100Mbps.
- **Reset Button:** Press and hold for 8 seconds to restore factory default settings.
- **LED Indicators:** Provide status information for Wi-Fi, WAN/LAN activity, and Power.

### 3.2 Default Parameters

For initial setup, use the following default parameters:

- **5G SSID:** WAVLINK-AC XXXX
- **2.4G SSID:** WAVLINK-N XXXX
- **Default IP:** 192.168.10.1
- **Password:** admin

## 4. SETUP AND INSTALLATION

### 4.1 Cable Connection

Properly connect the Ethernet cable to ensure waterproof integrity:



\*Actual distance may vary depending on actual surrounding environment.

Instructions for securing the Ethernet cable connection for outdoor use.

1. Pass the RJ45 cable through the spiral cover.
2. Pass the RJ45 cable through the rubber seal.
3. Pass the RJ45 cable through the holder.
4. Connect the RJ45 cable to the RJ45 port on the device.
5. Spin the 2.4G/5G antennas onto the 2.4G/5G external RP-SMA connectors.
6. Screw up the holder.
7. Plug the rubber seal into the holder.
8. Secure the spiral cover by screwing it on.

### 4.2 Mounting the Device

The device can be mounted on a pole or wall using the provided accessories:

## WPA2 Encryption Method

WPA2 strengthens WiFi encryption for increased security, keeping your accounts and systems safe even in public areas.



Steps for attaching the mounting bracket and device.

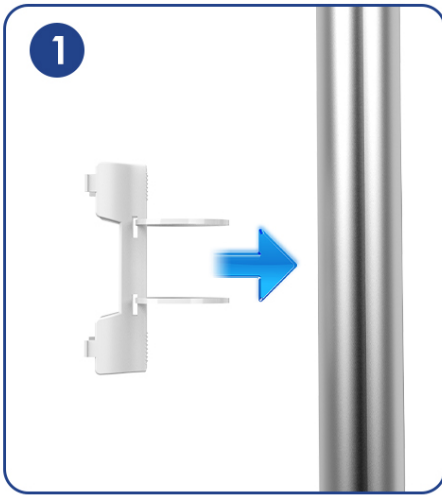

1. Fasten the main body holder.

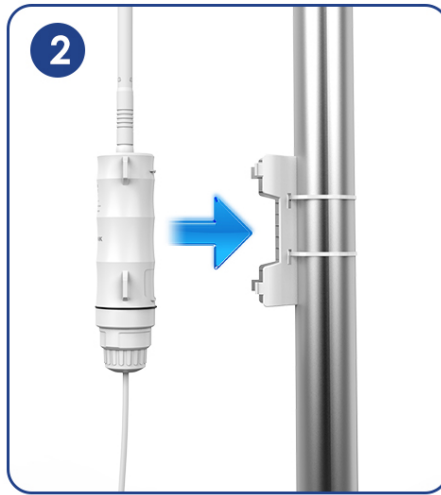

2. Plug the device into the holder.



3. After connecting to PoE, you can turn on the power and use it.

Final step of installation: powering on the device.

1. Fasten the main body holder to your desired mounting surface (e.g., pole or wall).
2. Plug the device securely into the installed holder.
3. After connecting to PoE, you can turn on the power and begin using the device.

### 4.3 Power Over Ethernet (PoE)

The WAVLINK AC1200 supports both active and passive PoE, allowing for flexible power and data transmission over a single Ethernet cable. This is particularly useful for outdoor installations where power outlets may not be readily available.

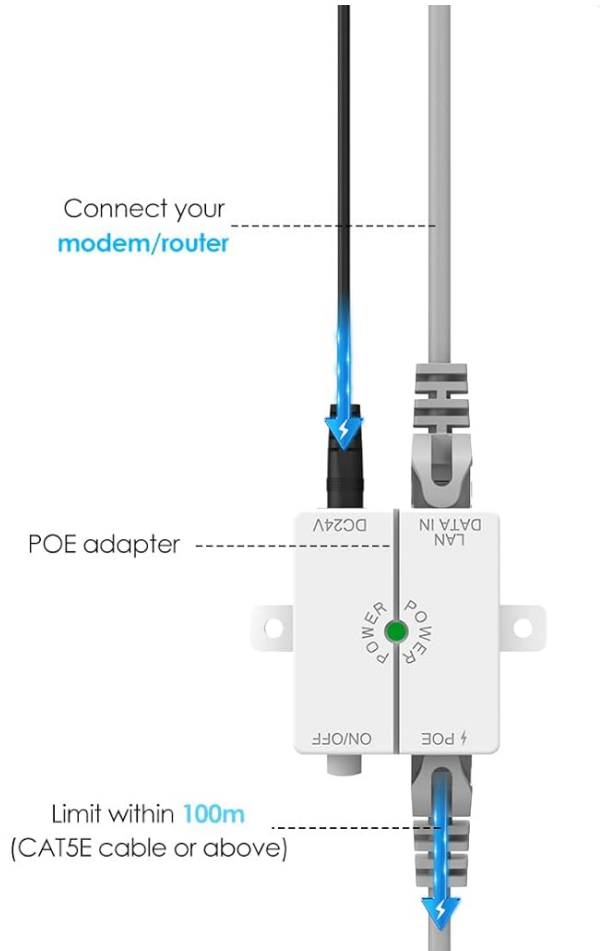

## Flexibly Supports Active & Passive PoE



DC 54V PoE  
(Passive)



DC 48V PoE  
(Active)



Limit within  
100m



Smart LED light

The device supports both active and passive PoE for versatile power options.

## PoE Switch

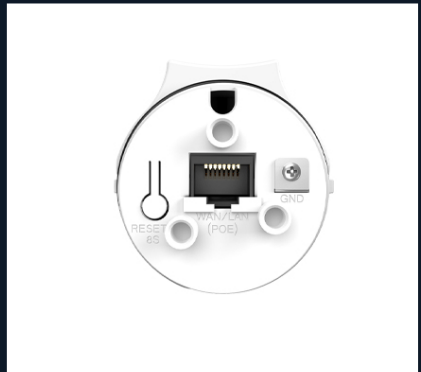
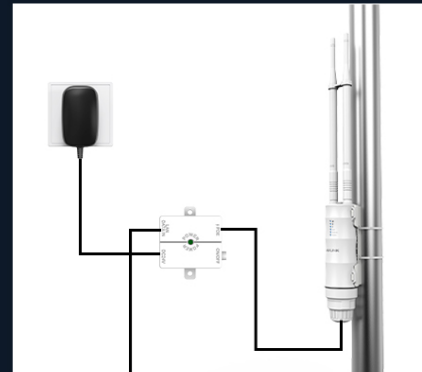
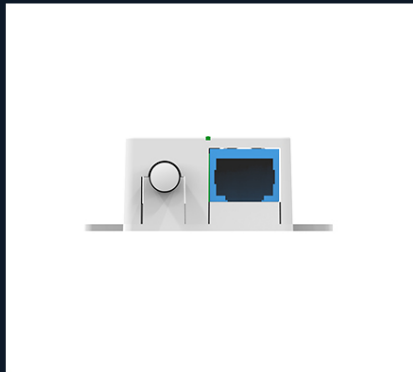

\*Support active and passive PoE, you can choose according to your device needs.

Illustrates different PoE connection methods.

You can use the included passive PoE converter or connect to an active PoE switch (e.g., 48V PoE) depending on your network infrastructure. Ensure the Ethernet cable length does not exceed 100 meters (CAT5E cable or above) for optimal performance.

## 5. OPERATING MODES

The WAVLINK AC1200 supports multiple operating modes to suit various networking needs:

# Multiple & Optional Working Modes

1

## AP/Router Mode

Modem/Router

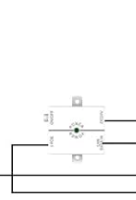

AP/Router



## Repeater Mode



Router

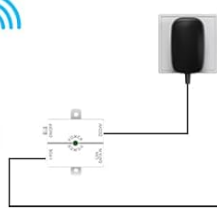

Repeater



2

3

## AP+Repeater Mode

Modem/Router

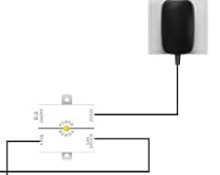

AP

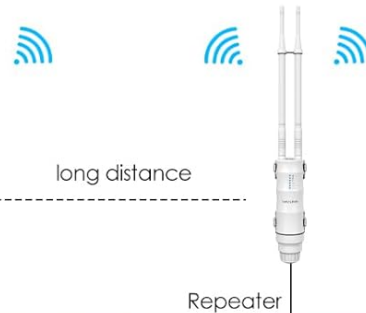

Repeater



Visual representation of the different operating modes.

# Multiple-Modes Supported

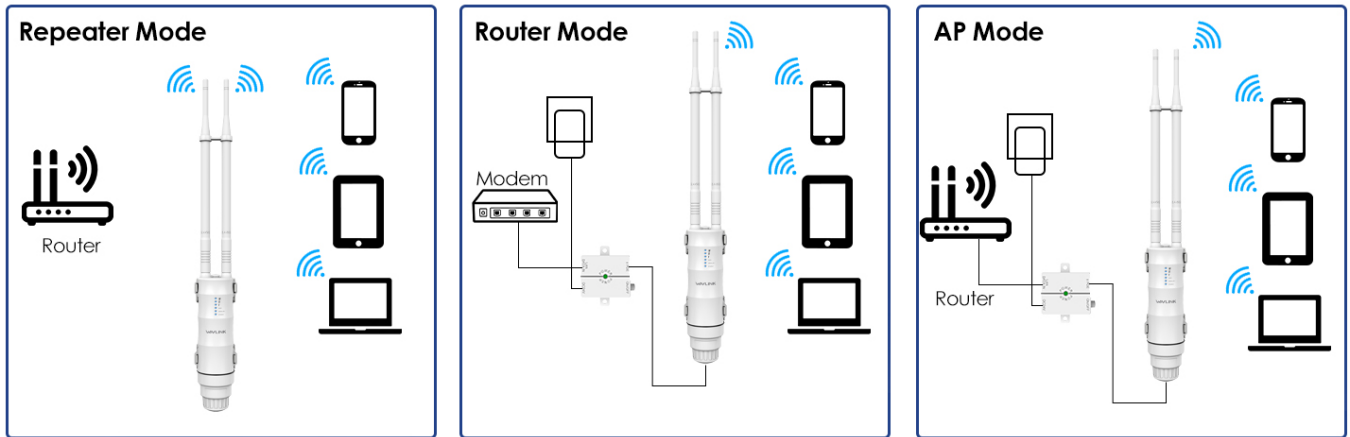

Detailed diagrams for Repeater, Router, and AP modes.

- **Repeater Mode:** Extends the Wi-Fi coverage of an existing wireless network by amplifying and relaying the signal.
- **Router Mode:** Creates an instant private wireless network, allowing multiple devices to share an internet connection.
- **AP Mode (Access Point):** Converts a wired network connection into a wireless one, providing Wi-Fi access to connected devices.
- **AP+Repeater Mode:** Extends the range of a wireless network by using a repeater to amplify and relay the signal from an access point, ideal for covering long distances.



## AP+Repeater Mode

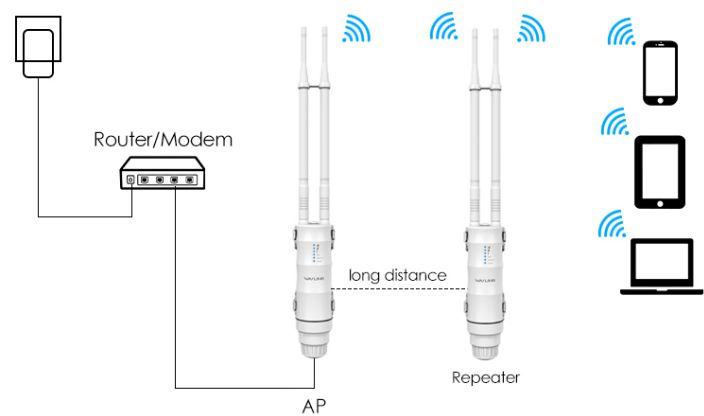

Specific setup for AP+Repeater mode.

## 6. MAINTENANCE

The WAVLINK AC1200 is built for durability in outdoor conditions. To ensure its longevity and optimal performance, consider the following:

# Fit with Any Outdoor Scenarios

Note: The PoE part of the router is not waterproof



IP67 Waterproof Enclosure



-10°C~50°C(-14°F~122°F)



15KV ESD & 6KV Lightning Protection



The device features robust weather and electrical protection.

- **IP67 Rated Weatherproof Case:** The enclosure is designed to withstand harsh outdoor environments, including extreme cold, heat, or humid climates. It can operate within a temperature range of -10°C to 50°C (-14°F to 122°F).
- **ESD and Lightning Protection:** Equipped with 15KV ESD and 6KV lightning protection to safeguard the device from electrical surges.
- **Regular Inspection:** Periodically check the physical condition of the device, cables, and connections for any signs of wear or damage. Ensure all seals are intact.
- **Cleaning:** If necessary, gently clean the exterior of the device with a soft, damp cloth. Do not use harsh chemicals or abrasive cleaners.
- **PoE Part:** Note that the PoE part of the router is not waterproof and should be installed indoors or in a protected enclosure.

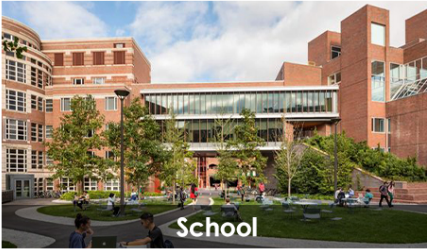

The device is built to withstand diverse weather conditions, but the PoE component requires indoor installation.

## 7. TROUBLESHOOTING

- **No Power:**

Ensure the power adapter and PoE converter are correctly connected and receiving power. Check the power LED indicator on the device.

- **No Internet Access:**

Verify that the Ethernet cable from your main router/modem is securely connected to the WAN/LAN port of the WAVLINK extender. Check the WAN/LAN LED indicator. Ensure your main internet connection is active. If in Repeater mode, ensure the extender is successfully connected to your main Wi-Fi network.

- **Poor Signal/Speed:**

The WAN/LAN port supports a maximum of 100Mbps. If your internet speed exceeds this, the extender will cap it at 100Mbps. Ensure the device is positioned optimally, avoiding obstructions. While the device supports dual-band, some users have reported inconsistent performance on the 2.4GHz band; try connecting devices to the 5GHz band if possible.

- **Cannot Access Web Management Page (192.168.10.1):**

Ensure your device (computer/phone) is connected to the extender's Wi-Fi network or directly via Ethernet. Verify that your device's IP settings are set to obtain an IP address automatically (DHCP). Try clearing your browser's cache or using a different browser. If issues persist, perform a factory reset by holding the reset button for 8 seconds.

- **Security Concerns (HTTP vs HTTPS):**

Some users have noted the web interface uses HTTP instead of HTTPS. While this is common for local network device management, be aware that configuration traffic is not encrypted. Ensure your local network is secure.

## 8. SPECIFICATIONS

<b>Brand</b>	WAVLINK
<b>Model Number</b>	WN570HA2
<b>Wireless Communication Standard</b>	802.11a/b/g/n/ac
<b>Data Transfer Rate</b>	Up to 1200 Mbps (300Mbps 2.4G, 867Mbps 5G)

<b>Frequency Band Class</b>	Dual-Band
<b>Antennas</b>	2x 7dBi High-Gain Omni-Directional Antennas
<b>Coverage Range</b>	Up to 200 meters (656 feet)
<b>Max Connected Devices</b>	Up to 32 devices
<b>Ports</b>	1x WAN/LAN RJ45 Port (100Mbps)
<b>PoE Support</b>	Active/Passive PoE
<b>Waterproof Rating</b>	IP67
<b>Environmental Protection</b>	15KV ESD, 6KV Lightning Protection
<b>Operating Temperature</b>	-10°C to 50°C (-14°F to 122°F)
<b>Dimensions</b>	Approx. 11.34 x 4.92 x 2.32 inches (43cm height, 5cm width)
<b>Item Weight</b>	1.06 pounds



Illustration of the extended coverage provided by the device.



## 2 x 7 dBi Omni Directional Antennas

Whether used to provide Wifi coverage in yards, parks, or other outdoor public spaces, the performance of the 7dBi high-gain antenna dramatically increases the range and stability of your wireless connection.

The high-gain antennas enhance wireless range and stability.

## 9. WARRANTY AND SUPPORT

WAVLINK products are designed for reliability and performance. For any technical assistance, warranty inquiries, or support needs, please contact WAVLINK customer service:

A graphic with a dark blue background featuring a glowing world map and a network of blue lines and dots. The WAVLINK logo is in the top left, followed by the slogan 'Bring Technology To Your Life' and the tagline 'see the world'. Below this is a paragraph of text about the company's history and mission, followed by contact information including a phone number, a phone icon, an email icon, and an email address.

**WAVLINK** *Bring Technology To Your Life*  
see the world

Found in 2003, WAVLINK owns the expertise in comprehensive IT peripherals. With a relentless focus on technology, creativity, and sustainability, we aim to make life more convenient, work more efficient, and travel more worry-free.

- Perfect after-sales service allows you to buy with confidence.

 **+1 8889730883**  
(UTC -5) Mon - Fri 9AM - 6PM

 **Contact@wavlink.com**

WAVLINK customer support contact details.

- **Phone:** +1 8889730883 (UTC-5) Mon - Fri 9AM - 6PM
- **Email:** Contact@wavlink.com

Please refer to the official WAVLINK website or your product packaging for the most up-to-date warranty information.