

## EazelID M950

# EazelID M950 Label Maker Instruction Manual

Model: M950

## 1. INTRODUCTION

The EazelID M950 is a versatile label maker designed for home, office, and school use. It offers two primary printing modes: direct input via its integrated QWERTY keyboard and wireless control through the 'Print Master' mobile application via Bluetooth. Featuring a rechargeable battery and a backlit LCD screen, the M950 provides convenience and clarity for all your labeling needs. This manual provides detailed instructions for setting up, operating, and maintaining your device.

## 2. PACKAGE CONTENTS

Please verify that all items listed below are included in your package:

- 1 x EazelID M950 Label Maker
- 1 x 3M21 Black on White Label tape (12mm\*4M)
- 1 x Type-C Data Cable
- 1 x Packaging box
- 1 x User Manual (this document)

# PACKAGE INCLUDES

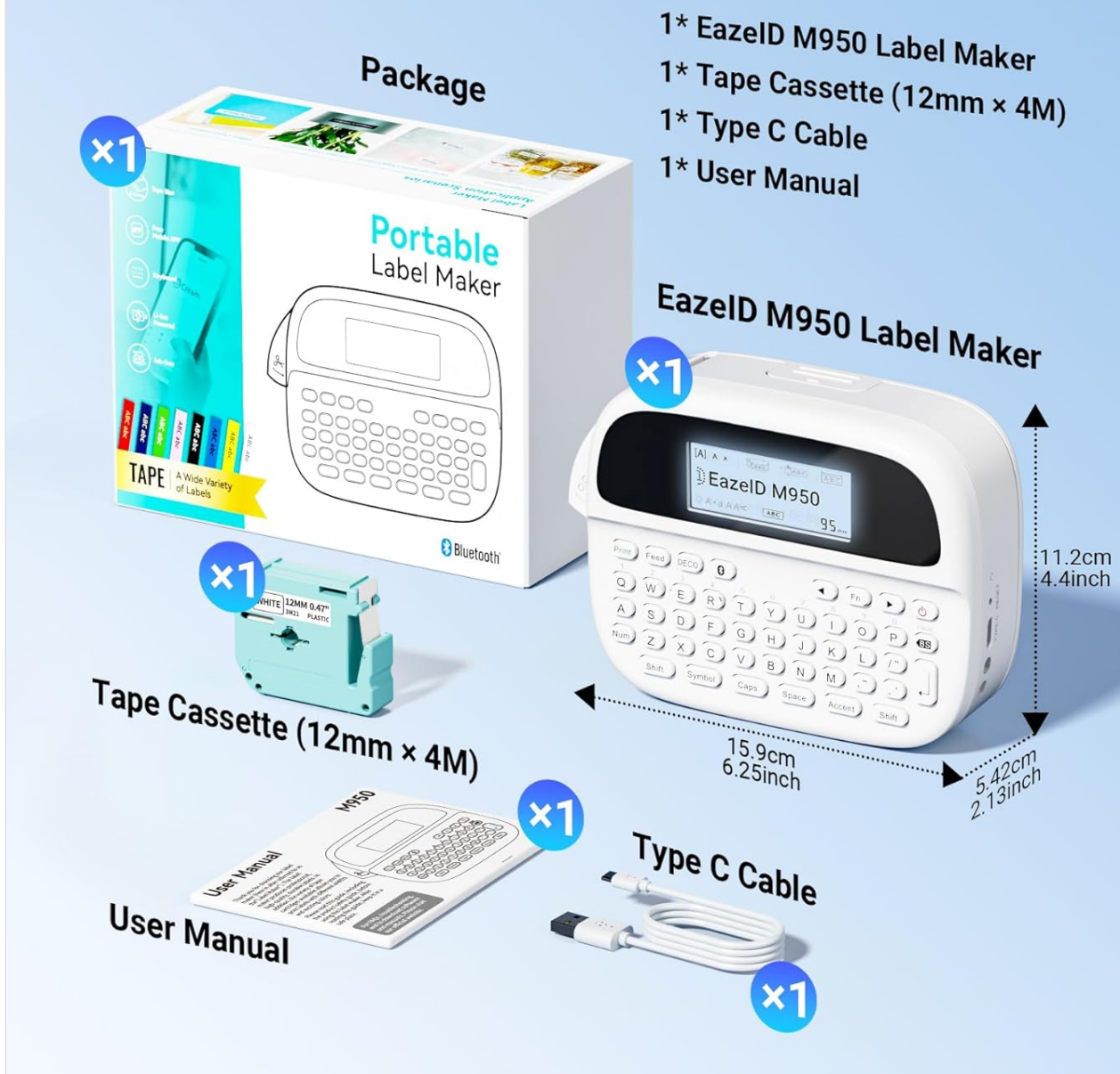

Figure 2.1: EazelID M950 Label Maker package contents.

### 3. PRODUCT OVERVIEW

The EazelID M950 Label Maker features a compact design with an integrated QWERTY keyboard and a backlit LCD screen for ease of use. It utilizes thermal printing technology, eliminating the need for ink or toner.



Figure 3.1: Front view of the EazelD M950 Label Maker and accessories.



Figure 3.2: Key features and components of the EazelD M950 Label Maker.

## 4. SETUP

### 4.1 Charging the Device

The M950 Label Maker is equipped with a built-in 1200mAh rechargeable lithium battery. Before first use, or



when the battery is low, charge the device using the provided Type-C USB cable.

1. Connect the Type-C end of the cable to the charging port on the side of the label maker.
2. Connect the USB-A end of the cable to a 5V-2A charging adapter (not included) or a compatible USB port.
3. The device will indicate charging status on the LCD screen. A full charge typically takes 1-2 hours.



Figure 4.1: Charging the EazeID M950 Label Maker.

## 4.2 Installing Label Tape

To install or replace the label tape cassette:

1. Ensure the label maker is powered off.
2. Locate the tape compartment cover on the top of the device. Gently open the cover.
3. Insert the label tape cassette into the compartment, ensuring it clicks into place. The tape should feed smoothly out of the slot.
4. Close the tape compartment cover securely.

# M950 SMART KEYBOARD LABELER

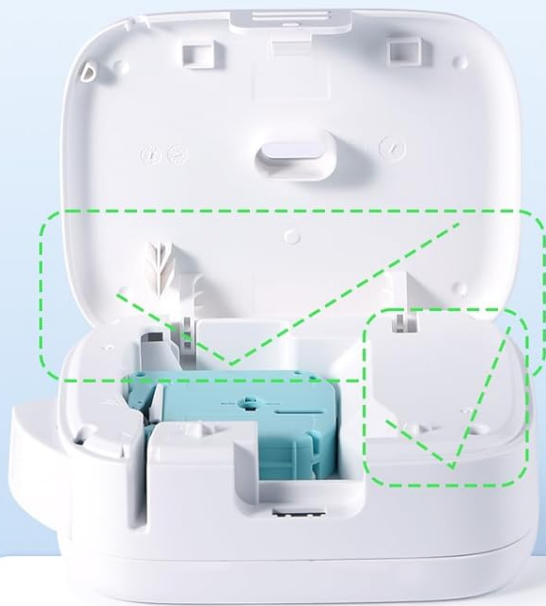

— **Rechargeable  
Li-ion Battery**



**\*\* (Type C Cable Included)**

— **Printer and cover  
in one piece**



**M950**

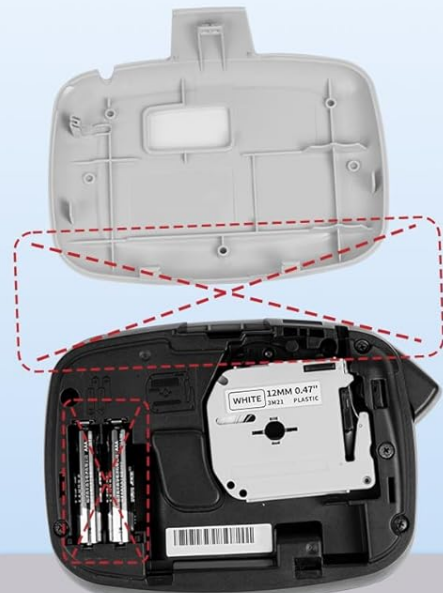

— **AAA Batteries**

**\*\* (Not Included)**



— **Printer and  
covers separate**

**\*\* (Easy to lose)**



**Other**

Figure 4.2: Internal view of the M950 label maker showing tape cassette placement.

## 5. OPERATING INSTRUCTIONS

### 5.1 Powering On/Off

- To power on: Press and hold the **Power** button (usually marked with a power symbol) until the LCD screen illuminates.
- To power off: Press and hold the **Power** button again until the screen turns off.

### 5.2 Direct Printing via QWERTY Keyboard

The M950 features an ergonomic QWERTY keyboard for direct label creation.

1. **Power On:** Turn on the label maker.
2. **Input Text:** Use the QWERTY keyboard to type your desired label text. The text will appear on the backlit

LCD screen.

3. **Formatting Options:** Use the function keys (e.g., **Fn**, **Symbol**, **Caps**, **Accent**) to access various fonts, sizes, symbols, and other formatting options.
4. **Print:** Press the **Print** button to generate the label.
5. **Cut:** Use the built-in cutter to cleanly separate the printed label from the tape roll.

## Keyboard Smarter and Portable



No ink needed



Built in Cutter



Type-C Charging



Portable and Lightweight



High Definition  
203DPI



Bluetooth  
Connection





**EazeID M950 Label Maker**  
(489g)



**Ipad**  
(500g)



Figure 5.1: Using the QWERTY keyboard for direct label printing.

### 5.3 Bluetooth App Printing (Print Master App)

For advanced features and customization, connect your M950 to the 'Print Master' app via Bluetooth.

1. **Download App:** Download the 'Print Master' app from your device's app store (available on Android and iOS).
2. **Power On & Bluetooth:** Turn on the label maker and ensure Bluetooth is enabled on both the label maker and your smartphone.



3. **Connect:** Open the 'Print Master' app. The app will search for nearby EazeID label makers. Select 'EazeID M950' from the list to connect.
4. **Design Label:** Use the app's interface to create your label. The app offers a vast library of customizable templates, over 1000 patterns, 100+ frames, 100+ fonts, barcodes, and QR codes.
5. **Print:** Once your label is designed, tap the 'Print' icon in the app.
6. **Cut:** Use the built-in cutter on the label maker to separate the printed label.

## 2 PRINTING MODES

Connect Bluetooth  
to use



With Keyboard  
to use

Figure 5.2: The EazeID M950 supports both keyboard and Bluetooth app printing modes.



Figure 5.3: Connecting to the 'Print Master' app via Bluetooth.

## 6. MAINTENANCE

### 6.1 Cleaning the Device

To ensure optimal performance and longevity of your label maker:

- Power off the device before cleaning.
- Use a soft, dry cloth to wipe the exterior of the label maker.
- For the print head, gently wipe with a cotton swab lightly dampened with isopropyl alcohol. Allow it to dry completely before use.
- Do not use abrasive cleaners or solvents.

### 6.2 Battery Care

To maximize battery life:

- Avoid fully discharging the battery frequently.
- Charge the device regularly, even if not in constant use.
- Store the device in a cool, dry place when not in use for extended periods.

## 7. TROUBLESHOOTING

If you encounter issues with your EazeID M950 Label Maker, refer to the following common problems and solutions:

Problem	Possible Cause	Solution
Device does not power on	Low battery; Device malfunction	Charge the device for at least 30 minutes. If still unresponsive, contact support.
No print or faint print	Tape installed incorrectly; Print head dirty; Low battery	Reinstall tape cassette. Clean the print head. Charge the device.



Problem	Possible Cause	Solution
Bluetooth connection fails	Bluetooth off; App not updated; Device too far	Ensure Bluetooth is enabled on both devices. Update 'Print Master' app. Move label maker closer to smartphone. Restart both devices.
Labels are difficult to peel	Specific label tape characteristic	Ensure you are using genuine EazeID label tape. Try bending the label backing slightly to separate.

## 8. SPECIFICATIONS

Technical specifications for the EazeID M950 Label Maker:

- **Model Name:** EazeID M950 Label Maker
- **Printing Technology:** Thermal
- **Print Resolution:** 203 DPI
- **Connectivity:** Bluetooth, USB Type C
- **Maximum Media Size:** 12mm (0.47 inch)
- **Battery:** 1200mAh Lithium Ion (rechargeable, included)
- **Control Method:** App (Print Master), QWERTY Keyboard
- **Special Features:** Backlit LCD Screen, Built-in Cutter, Portable
- **Product Dimensions:** Approximately 1 x 1 x 1 inches
- **Item Weight:** 1.06 pounds
- **Included Components:** Label maker, tape, USB-C cable, user manual

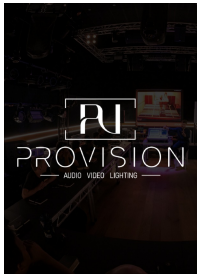

Figure 8.1: EazeID M950 Label Maker dimensions and key features.

## 9. WARRANTY AND SUPPORT

The EazeID M950 Label Maker comes with a limited warranty. For specific warranty terms and conditions, please refer to the warranty card included in your product packaging or visit the official EazeID website.

For technical support, troubleshooting assistance, or inquiries about replacement parts and accessories, please contact EazeID customer service through the contact information provided on the official website or your purchase platform.



## Provision AVL Product Catalogue: Audio, Video, and Lighting Solutions

Explore the comprehensive product catalogue from Provision AVL, featuring a wide range of professional audio, video, lighting, and rigging equipment from leading brands like d&b audiotechnik, FBT, PMC, Solid State Logic, GLP, ETC, Vega Pro Lighting, Prolyte, Clitec, Milos, and EXE Technology.

## Documents - EazelID – M950

### EazelID

Innovative Labeling Solutions

#### M950 Label Maker User Manual

Thank you for choosing our label maker (here in after referred to as the "Label Maker"). The label maker produces professional, high-quality, durable labels. In addition, the variety of tape cartridges available allows you to print labels with different widths and exciting colors.

Please read this guide, including the product safety guide, before using this label maker. After reading this guide, keep it in a safe place.

For FAQs, troubleshooting, and to download software and manuals, Please visit our official website.



#### Contents

##### A: Before Use

1. Contents Checklist
2. Parts Description

##### B: Use the Label Maker

1. Print from the Label Maker
2. Print from Your Mobile Device

##### C: Basic Operations

1. Entering Text
2. Designing Labels
3. Basic Settings
4. Printing Labels
5. Saving Label Files
6. Symbol Examples
7. Frame Examples
8. Accented Character Examples

##### D: Support

1. Specification
2. Charging the Label Maker
3. Replacing the Tape Cassette
4. Reset
5. Clean the Print Head
6. Print the self-test page
7. Error Messages
8. Important Note
9. Troubleshooting
10. Product Warranty Description
11. Maintenance Card

#### A: Before Use

##### 1. Contents Checklist

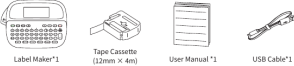

\*1: The Tape Cassette listed here does not include the cassette.  
\*2: The quantity of included Tape Cassette is subject to the actual delivery.

##### 2. Parts Description

###### 2-1 KEYBOARD



###### 2-2 LCD



\* To move the cursor to the beginning of your text, press **←** and the **↶** key simultaneously.  
To move the cursor to the end of your text, press **→** and the **↷** key simultaneously.

#### B: Use the Label Maker

##### 1. Print from the Label Maker

1. Remove sticker.
2. Press **ON** until the display lights up.
3. Set the language.  
The default setting is [English].
4. Type text and create labels from keyboard.
5. Press **Print**.
6. Press the cutter button to cut the label.
7. Tear off ribbon.
8. Tear off the backing paper from the back of the label along the easy-tear line.
9. Attach labels to dry, flat objects.

##### 2. Print from Your Mobile Device

Download App





## C: Basic Operations

### 1. Entering Text

Upper-Case Lower-Case	<b>Caps</b>	Switch between upper-case and lower-case characters.
Numbers and Symbols	<b>Symbol</b> Or <b>Num</b>	Insert numbers: Press Num to turn the num lock on or off. Insert symbols: Select a category → Select a symbol →
Line Feed	<b>LF</b>	Press LF to start a line feed. Maximum number of lines for 0.47" (12mm) tape width: three lines.
Delete Text and Format	<b>DEL</b>	1) Delete one character at a time: <b>DEL</b> 2) Delete all characters: <b>DEL</b> → <b>Text Only</b> → 3) Delete all text and formatting: <b>DEL</b> → <b>Text &amp; Format</b> →
Accented Characters	<b>Accent</b>	1) Entering accented characters. Select an accent → 2) To cancel operations, press <b>DEL</b> . 3) See 5.8 for examples of accent characters. The order of accent characters differs by the selected LCD language.
Label Length	<b>FL</b>	Set the label length. Auto: Automatically adjusts the label length to the length of the text. <b>FL</b> → <b>Label Length</b> → Select a value →
A/F	<b>FL</b>	This function allows you to choose a fixed label template length. <b>FL</b> → <b>A/F</b> → Select a value →

### 2. Designing Labels

Press **FN**, use **Left** / **Right** to select a function to design labels.

1) **Size**: Adjusting font size.  
**FN** → **Size** → Select a value →

2) **Width**: Adjusting font width.  
**FN** → **Width** → Select a value →

3) **Style**: Adjusting font style.  
**FN** → **Style** → Select a style →

4) **Undr/Frame**: Select a decorative underline/frame to add to your label.  
**FN** → **Undr/Frame** → Select a category →  
Select a underline/frame →

5) **DECO**: This function allows you to create unique labels using built-in templates.  
**FN** → **DECO** → Select a deco mode →

6) **Alignment**: Adjust text format.  
**FN** → **Alignment** → Select a value →

### 3. Basic Settings

Label Width	<b>FW</b>	The default setting is 12mm. <b>FW</b> → <b>Label Width</b> → Select a value →
Cutting Line	<b>FL</b>	The Cutting Line ( ) indicate the end of the label. Cut along the Cutting Line ( ) with scissors. 8mm 8mm 8mm 8mm When printing multiple labels at a time, the default is with a Cutting Line, if you need to turn it off, you can do this. <b>FL</b> → <b>Cutting Line</b> → <b>OFF</b> →
Print Density	<b>FW</b>	Set the print density. <b>FW</b> → <b>Print Density</b> → Select a value →
Language	<b>FW</b>	Set the language. The default setting is [English]. <b>FW</b> → <b>Language</b> → Select a language →

### 4. Printing Labels

Vertical	<b>FW</b>	Set up vertical printing. <b>FW</b> → <b>Vertical</b> → Select a value →
Feed	<b>Feed</b>	This function will feed approximately 0.31" (8mm) of blank tape. <b>Feed</b>
Print	<b>Print</b>	start printing. 1. If you need only 1 copy of the label, press Print. 2. When printing multiple labels (printing multiple same labels): <b>Print</b> → <b>Print</b> → Select a print quantity (up to 9 copies)

### 5. Saving Label Files

You can save your original labels on to your label maker. Up to 9 labels can be saved and recalled for printing at a later time. You can also edit and overwrite the stored label.

1) **Save**:  
Create a label → **FW** → **File** → **Save** →  
Select a save destination →

2) **Open**:  
**FW** → **File** → **Open** →  
Select a saved file →

### 6. Symbol Examples



### 7. Frame Examples

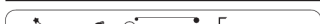

[\[pdf\]](#) User Manual Frequently Asked Questions Troubleshooting Guide Guide Label M950 EazeID Label Maker Rechargeable Machine with Labels Waterproof Bluetooth Labeler Portable QWERTY Keyboard Backlit LCD Screen for Home Office School White MakerM950 User Guide B0FSSGRSCQ B0D3DTYQPR B0DB824KG3B1S6xRIs2aLm media amazon images | B1S6xRIs2aL ||| Innovative Labeling Solutions M Label Maker User Manual Thank you for choosing our label maker here in after referred to as the Label Maker . The label maker produces professional, high-quality, durable labels. In addition, the variety of tape

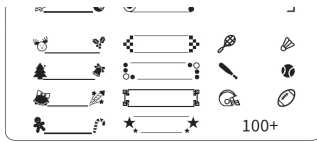

## 8. Accented Character Examples

áàãäåæçàää ÅÅÅÅÆÄÄÄ çĉċĈĊ ĊĊċċ ēēēēēēēēēē  
ÉÉÉÉÉÉÉÉ ġġĠĠ ĨĨĨĨ ĨĨĨĨ ĨĨĨĨ ...

### D: Support

## 1. Specification

Page Width	Available widths: 0.35 inch(9mm), 0.47 inch(12mm)
Max Print Width	0.35 inch (9mm)
Print Technology	Thermal & Thermal transfer
Print Resolution	203 dpi
Cutting Method	Manual Cutting
Power Supply	Lithium battery Or USB powered
Item Size	151.9Wx112.1Ldx54.2Hmm/6.0x4.4x2.1 inch
Supported Operating Methods	Keyboard/Mobile device
Label Length	The label length for each label depends on the label width, with a maximum of 100 characters per label.
Maximum Number of Print Lines	Items: 2 Lines, 12mm; 3 Lines.

## 2. Charging the Label Maker

Charge until the power indicator light goes off.



- To save power, the label maker will automatically turn off after five minutes of inactivity. The last label created is remembered and displayed when the power is turned back on.

### 3. Replacing the Tape Cassette

- ① Make sure the end of tape passed through both tape guides. Extend the end of the tape by about 1.18 inch (3cm) from the tape guide.

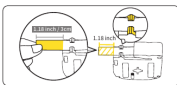

- 2 Install the label tape correctly as indicated, and make sure the extended tape comes out through the tape exit slot of the label maker.



- \* If sample tape comes with ribbon, you can manually align the ribbon and tape at the first time use.

#### 4. Reset

Reset the internal memory. For example, to reset the label maker or delete any saved label data. You can use a needle shaped object to poke the reset hole on the right side of the charging interface.



## 5. Clean the Print Head

Use a cotton swab dipped in a small amount of alcohol, and wipe the print head gently.

- The print head needs to be cleaned when printing is not clear.
- Make sure the power is turned off and the power cord is unplugged before cleaning the print head.
- Wait until the alcohol evaporates and the print head is dry, then turn on the label maker to print.



## 6. Print the self-test page

Double click the power button to print the self-test page.



## 7. Error Messages

Message	Cause/Remedy
Cutter Error !	The Tape Cutter Lever was pressed while trying to print or feed the tape. If the tape is jammed in the Cutter unit, remove the tape. Turn the Label Maker off and then on again before continuing.
Text Full !	Please reduce the word count to within 100 characters.
Battery Low !	Please charge immediately.
Line Limit !	Reduce the number of text lines.
No Cassette !	Please install the label ribbon into the machine's consumables compartment.
No Data !	Please enter the text first before printing.

## 8. Important Note

## SAFETY PRECAUTIONS

Be sure to read this section before using the product. It contains important safety instructions. We recommend that you keep this document nearby for future reference.

- For servicing, adjustments, or repairs, contact our Service.
- If the product operates abnormally or any error occurs, or if any cable is damaged, turn off the power and disconnect the cable and the product from the power source.
- We assume no responsibility for damages arising from earthquakes, fire, other disasters, actions of third parties, or use of intentional or negligent operation, misuse, or operation under other special conditions.
- We assume no responsibility for damage (such as losses, loss of business profit, lost profits, or consequential damages) caused by a power outage or a power failure, or by a power outage or a inability to use the product.
- We assume no responsibility for damages that may result from incorrect operation of the product by connecting it to a power source not recommended or using incompatible software.
- We assume no responsibility for any damages or lost profits arising from the use of labels created by third parties.
- We assume no responsibility for the loss of data due to failure, repair, or consumables and we do not accept any claim from a third party.
- We reserve the right to make changes without notice in the specifications and materials contained herein without notice. We reserve the right to change the specifications and materials, consequently caused by reliance on the materials presented, including but not limited to the website and other electronic or printed materials.
- For more information about the available products, see the User's Guide on the official website.
- The latest version of your product documentation is available on the official website.
- The availability of the product is subject to the availability of the product in the country or region.
- This product is approved for use in the country or region of purchase only.

**⚠ WARNING**

Failure to observe instructions and warnings could result in death or serious injuries.

- [illegible]

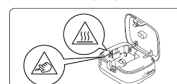

cartridges available allows you to print lab...

lang:en score:22 filesize: 3.13 M page\_count: 1 document date: 2024-08-13

Failure to observe instructions and warnings could result in minor or moderate injuries.

Label Maker, USB Cable, Lithium battery  
\* DO NOT disassemble the lithium battery

- DO NOT touch the Label Maker when removing it from the box or relocating it, otherwise you may get injured.
- DO NOT touch the Label Maker when the power supply is on.
- Be careful when closing the Tape Cassette Compartment Cover. There is a risk of injury if your fingers are pinched between the upper and lower parts of the cover.
- When you are not using the Label Maker, store it out of the reach of children. In addition, do not allow children to put the Label Maker parts or labels in their mouths. If any object has been swallowed, seek medical attention immediately.
- DO NOT leave the Label Maker in the reach of babies and children.
- Store the Label Maker on a flat, level, and stable surface.
- Turn off the power supply if you do not intend to use the printer for an extended period of time.
- Do not press on the Liquid Crystal Display (LCD) screen or the Tape Cassette Compartment Cover when operating the Cutter unit.
- DO NOT open the Tape Cassette Compartment Cover when the Cutter unit is operating.
- DO NOT apply excessive pressure to the Cutter unit.

### FCF Warning statement

No intentional or part 15 of the FCC Rules. Operation is subject to the following two conditions: (1) This device may not cause harmful interference, and (2) this device must accept any interference received, including interference that may cause operational degradation.

The user is responsible for ensuring compliance by the party responsible for compliance could avoid this user's authority to operate the operation.

The user is responsible for ensuring compliance with the limits for a Class B digital device, pursuant to part 15 of the FCC Rules. These limits are designed to provide reasonable protection against harmful interference in a residential installation. This equipment generates and can radiate radio frequency energy and, if not installed and used in accordance with the instructions, may cause interference to radio communications. However, this does not guarantee that interference will not occur in a particular installation. If this equipment does cause harmful interference, the user is encouraged to try to correct the interference by one or more of the following measures:

- Reorient or relocate the receiving antenna.
- Increase the separation between the equipment and receiver.
- Connect the equipment into an outlet on a circuit different from that to which the receiver is connected.
- Consult the dealer or an experienced radio/television technician for additional suggestions.

FCC RF exposure statement:

The user is responsible for ensuring compliance with the maximum **RF** exposure requirement. The device can be used in portable operation without restriction.

This device contains license-sensitive information (hereinafter "license") that comply with Innovation, Science and Economic Development Canada's "license exempt R550". Operation is subject to the following two conditions:

1. This device must not cause interference with any other radio transmitter.
2. This device must accept any interference, including interference that may cause undesired operation of the device.

L'entrepreneur/le propriétaire de licence est informé que le présent appareil est conforme aux CNR d'Innovation, des Sciences et du Développement économique Canada ("licence exempte R550"). L'utilisation est soumise aux deux conditions suivantes:

1. L'appareil ne doit pas produire d'interférence avec tout autre émetteur radio.
2. L'appareil doit accepter toute interférence radio, y compris une interférence qui pourrait causer le fonctionnement indésirable de l'appareil.

The device has been evaluated to meet general IC RF exposure requirements. The device can be used in portable (hand-held) mode without restrictions.

L'appareil a été évalué pour répondre aux exigences générales d'exposition aux RF d'IC. L'appareil peut être utilisé dans le mode portable (à la main) sans restrictions.

If you need additional help, visit [official website](http://officialwebsite.com).

Fn → ◀ / ▶ → [File] → [ ] → ◀ / ▶  
→ [About] → [ ] → [Firmware Ver] → [ ]

Product after-sales service is strictly based on the consumer protection law of the People's Republic of China and the Product Quality law of the People's Republic of China.

Product after-sales service is strictly based on the consumer protection law of the People's Republic of China and the Product Quality law of the People's Republic of China.

1. The free warranty period is 1 year from the date of purchase (according to the date of the official purchase invoice).

1. The free warranty period is 1 year from the date of purchase (according to the date of the official purchase invoice).
2. Within days from the date of the purchase receipt, the user can choose to return, replace or get free repair service.  
Within days from the date of receipt, the user can choose to replace or repair the product.  
Service is free of charge.
3. Free repair service does not include insurance, postage, shipping and other fees, nor does it include door-to-door service.

The warranty is void under the following conditions:

2. Not presenting the purchase invoice and the original warranty/maintenance card together, or the warranty card does not match the invoice information.
3. Presenting a damaged warranty/maintenance card (e.g. torn or tampered with).
4. Altering product information.
5. Damage caused by unauthorized repair, disassembling, etc.
6. Damage caused by human error.
7. Damage caused by natural disasters such as earthquakes, floods, windstorm, lightning strikes, or external disasters such as fires and house collapse.
8. Failure or damage caused by harsh conditions (oil, dust, moisture, direct sunlight, etc.) or failure to use or care for the product as written in the instruction manual.

Please safe keep the warranty/maintenance card properly. The warranty/maintenance card will not be replaced if lost.  
Product warranty description takes effect with warranty/maintenance card properly filled in.

<input type="checkbox"/> Replace <input type="checkbox"/> Return			
User information	Name:	Gender:	Phone:
	Address:		
Product information	Date of purchase:		
	Product order number:		
	Product serial number:		
Reason for Return (Replace/Repair/Request Maintenance)	Problem description:		