

[Manuals.plus](#) /

› [Pawtong](#) /

› Pawtong Foldable Baby 5-in-1 Activity Walker Instruction Manual

Pawtong Foldable Baby 5-in-1 Activity Walker

Pawtong Foldable Baby 5-in-1 Activity Walker Instruction Manual

Model: Foldable Baby 5-in-1 Activity Walker

1. INTRODUCTION

This manual provides essential instructions for the safe assembly, operation, maintenance, and storage of your Pawtong Foldable Baby 5-in-1 Activity Walker. This product is designed to support infants aged 6 to 18 months through various developmental stages, offering multiple modes of use including a walker, bouncer, rocker, eating table, and push walker. Please read this manual thoroughly before use and retain it for future reference.



Image 1.1: The Pawtong 5-in-1 Activity Walker, illustrating its primary function and versatility across different modes.

2. SAFETY INFORMATION

WARNING: Failure to follow these warnings and instructions could result in serious injury or death.

- Always keep the child in view while in the walker. Never leave the child unattended.
- Prevent access to stairs, steps, and uneven surfaces.
- Prevent access to all hot surfaces, electrical cords, and appliances.
- Prevent access to liquids, such as hot beverages, and other potential hazards.
- This walker is intended for children who can sit up unassisted (approximately 6 months) and who weigh no more than 26 lbs (12 kg) and are less than 32 inches (81 cm) tall. Discontinue use when the child can walk unassisted.
- Ensure all locking mechanisms are engaged before placing the child in the walker.
- Regularly inspect the product for loose parts, damaged components, or sharp edges. Do not use if any part is damaged.

Safety Design Prevent Sliding Down Stairs

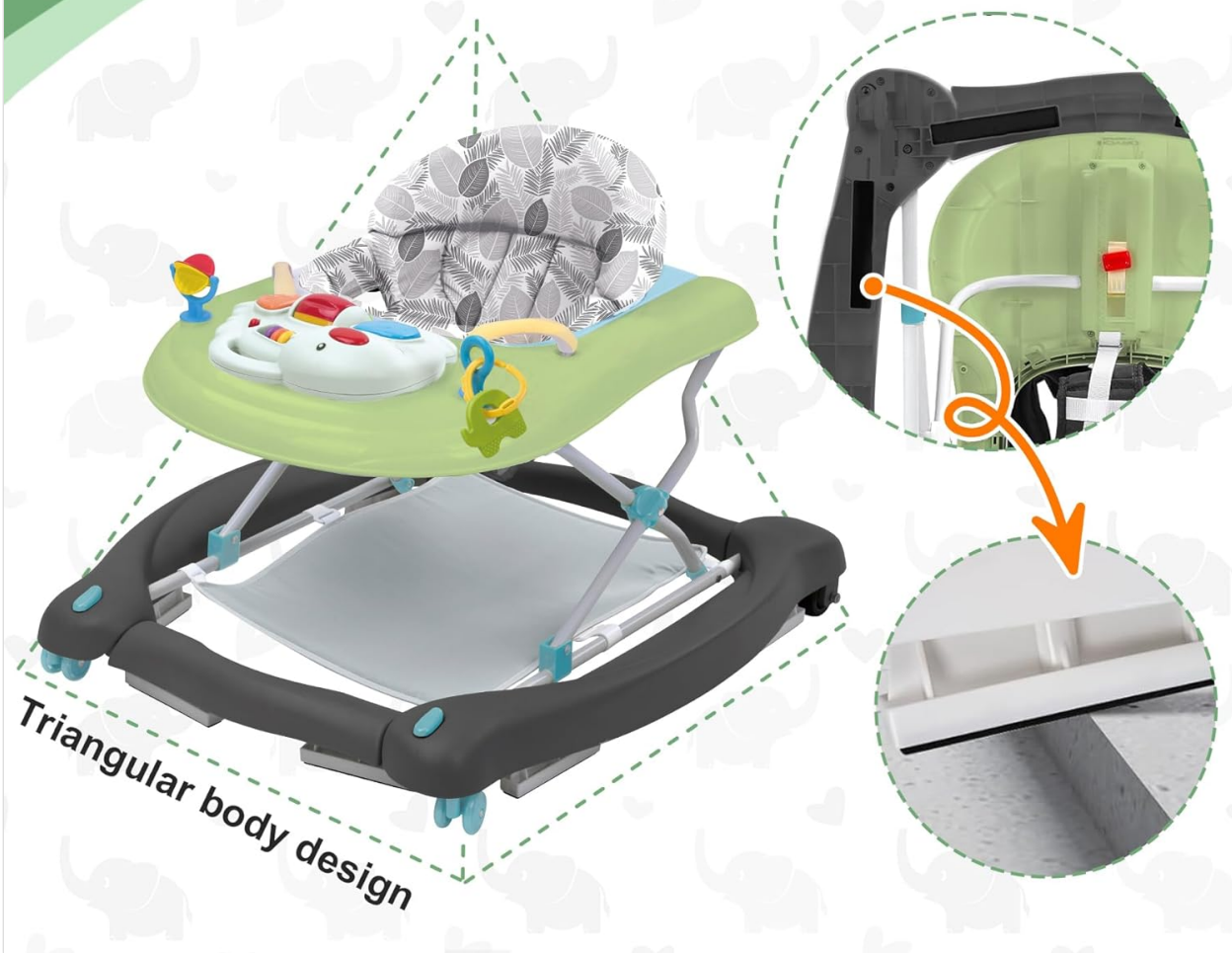

Image 2.1: Illustration of the walker's safety features, including the triangular body design and anti-slip pads, designed to prevent accidental movement on stairs.

6 Rubber Pads

Prevernt baby from falling down stairs



Image 2.2: Detail of the six rubber pads located on the underside of the walker, which provide friction and prevent the walker from moving over edges like stairs.

3. PRODUCT COMPONENTS

Before assembly, ensure all components are present and undamaged. Refer to the packaging for a complete list of parts. Key components include:

- Main Frame (Base and Support Legs)
- Seat Unit (with breathable cushion)
- Activity Tray (with music fun gear and detachable toys)
- Rear Speed-Adjustable Wheels
- Silent Universal Wheels (front)
- Foot Mat (for bouncer/rocker modes)
- Push Handrail (for push walker mode)

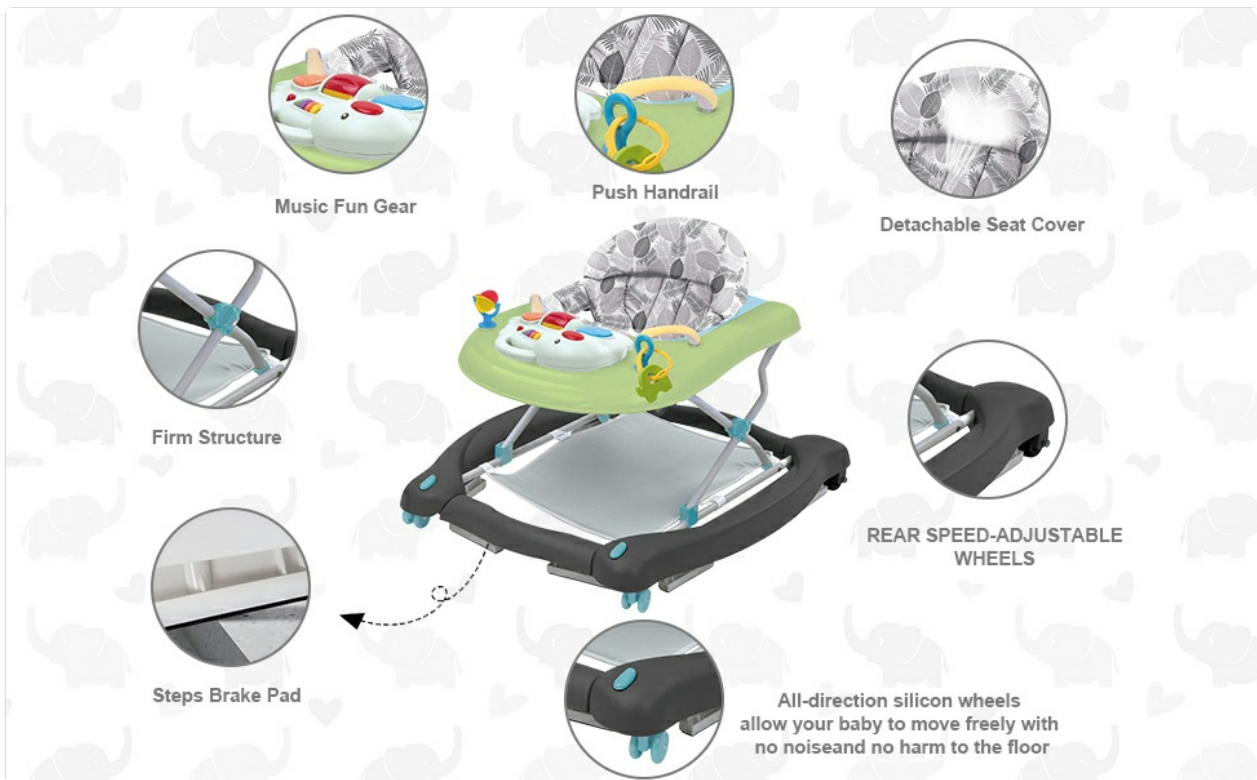

Image 3.1: An exploded view illustrating the main components and features of the walker, including the activity tray, seat, wheels, and structural elements.

4. SETUP AND ASSEMBLY

Assembly typically requires no tools. Follow these general steps:

1. **Unfold the Frame:** Carefully unfold the main frame until it locks into an upright position. Ensure all locking mechanisms click into place.
2. **Attach the Seat Unit:** Align the seat unit with the designated slots on the frame and press down firmly until it is securely attached.
3. **Install the Activity Tray:** Place the activity tray onto the top frame, ensuring it snaps into position.
4. **Attach Wheels:** Ensure all wheels are securely attached and rotate freely. The rear wheels may have a speed adjustment feature.
5. **Insert Foot Mat (Optional):** For bouncer or rocker modes, insert the foot mat into the base of the walker.

One Click Conversion to Rocking Chair Mode Seat Detachable



Image 4.1: Visual guide for converting the walker into rocking chair mode, demonstrating how to detach the seat and activate the rocking function.

5. OPERATING MODES

The Pawtong 5-in-1 Activity Walker offers versatility to adapt to your child's growth and developmental needs.



Image 5.1: Overview of the five distinct modes of the activity walker and their corresponding age recommendations.

5.1. Baby Jumper Mode (5M+ up to 10M)

In this mode, the walker functions as a stationary jumper. Ensure the foot mat is installed at the base, allowing the child to bounce safely within the activity center. The seat provides support while the child engages with the toys.

5.2. Baby Rocker Mode (6M+ up to 12M)

Convert the walker into a rocker by engaging the rocking mechanism at the base. The foot mat should be in place. This mode provides gentle rocking motion for entertainment and soothing.

5.3. Baby Eating Mode (7M+ up to 18M)

The activity tray can be removed to reveal a flat surface, converting the walker into an eating table. This allows the child to sit comfortably and eat meals or snacks. Ensure the child is securely seated.



Image 5.2: Demonstrates the eating mode with the removable toy plate, the bouncer function, and details on the silent wheels and breathable seat cushion.

5.4. Baby Walker Mode (7M+ up to 18M)

With the foot mat removed, the child can use the walker to move around. The silent universal wheels allow for smooth movement. Ensure the child's feet can comfortably reach the floor.

Detachable Seats for Safer Walking

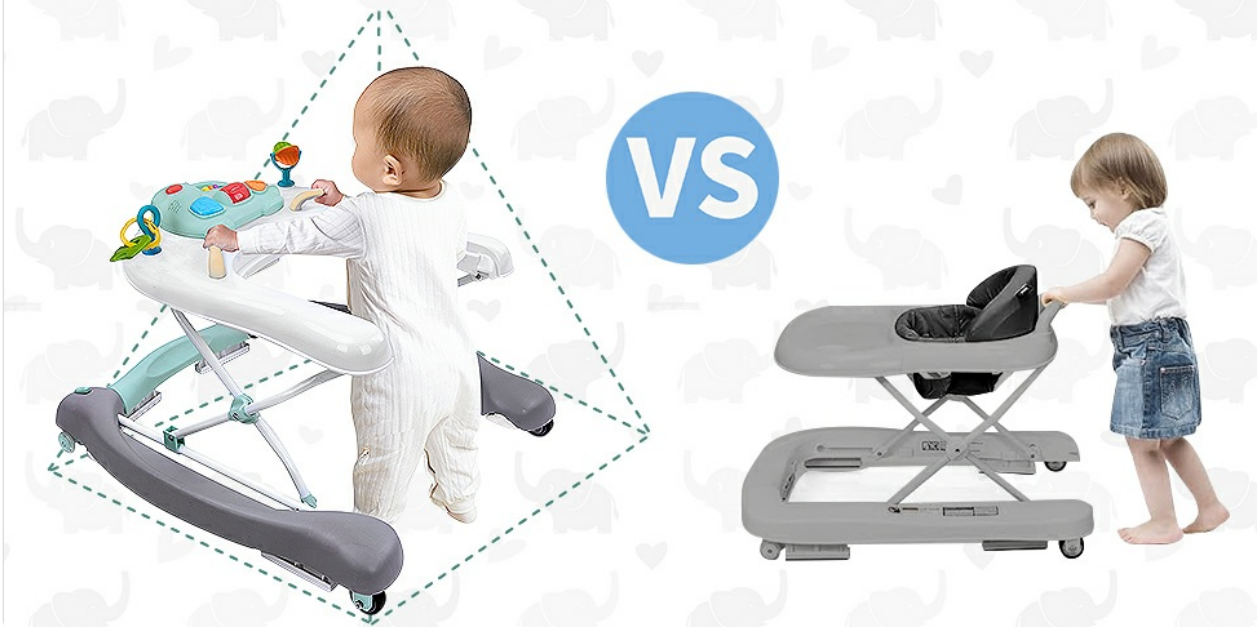

Image 5.3: Illustrates the benefit of the detachable seat design for promoting safer walking development.

5.5. Hand Push Mode (15M+)

Once the child is more confident in walking, the walker can be used as a push walker. The child stands behind the walker and pushes it forward using the integrated handrail, aiding in balance and coordination.

6. ADJUSTMENTS

6.1. Height Adjustment

The walker features 3 adjustable height positions. To adjust, locate the height adjustment mechanisms on the support legs. Press the buttons or levers and slide the frame to the desired height. Ensure both sides are adjusted equally and lock securely into place. Proper height ensures the child's feet are flat on the floor in walker mode, promoting healthy leg development.

Scientific ergonomic design Prevent Bow Legs



Image 6.1: Demonstrates the ergonomic design and the importance of correct height adjustment to prevent O-legs during use.

6.2. Rear Wheel Speed Adjustment

The rear wheels are equipped with an adjustable speed mechanism. This allows you to control the pace of the walker, providing more stability for beginners or a faster pace for more experienced users. Consult the wheel mechanism for specific adjustment instructions.

7. MAINTENANCE AND CLEANING

- **Seat Cushion:** The breathable seat cover is detachable for easy cleaning. Hand wash with mild soap and water, or machine wash on a delicate cycle. Air dry.
- **Frame and Activity Tray:** Wipe down with a damp cloth and mild soap. Rinse thoroughly and dry completely. Avoid abrasive cleaners.
- **Wheels:** Periodically clean the wheels to remove dust and debris, ensuring smooth operation.
- **General Inspection:** Regularly check all screws, bolts, and fasteners to ensure they are tight. Inspect for any signs of wear, tear, or damage.

8. STORAGE

The Pawtong Activity Walker is designed for compact folding, making storage convenient.

1. Remove the child from the walker.
2. Detach any removable accessories, such as the activity tray or foot mat, if desired.
3. Locate the folding mechanisms (usually buttons or levers on the frame).
4. Press the mechanisms and carefully fold the walker until it is compact.
5. Store in a dry, safe place away from direct sunlight and extreme temperatures.



Image 8.1: Visual guide demonstrating the compact folding process and the slim profile of the walker when stored, such as under a sofa.

9. TROUBLESHOOTING

Problem	Possible Cause	Solution
Walker does not move smoothly.	Wheels are dirty or obstructed.	Clean wheels to remove debris. Ensure no hair or lint is caught.
Walker feels unstable.	Height adjustment not locked, or frame not fully extended.	Ensure all height adjustment locks are engaged. Verify the frame is fully extended and locked.
Activity tray toys not functioning.	Batteries are low or incorrectly installed.	Replace batteries (if applicable) or ensure they are installed with correct polarity.
Difficulty folding the walker.	Folding mechanisms not fully disengaged.	Ensure all folding release buttons/levers are pressed simultaneously and correctly.

10. SPECIFICATIONS

- **Product Dimensions:** 27"L x 25"W x 16"H (unfolded)
- **Material Type:** Alloy Steel, Plastic
- **Material Composition:** Peach skin polyester (seat)
- **Style:** Folding
- **Batteries Required:** No (for main walker function; check activity tray for specific toy battery requirements)
- **Item Weight:** Approximately 13.29 pounds
- **Age Range:** 6-18 Months
- **Color:** Green (for this specific model variant)

11. WARRANTY AND SUPPORT

For warranty information or customer support, please refer to the contact details provided with your purchase or visit the official Pawtong website. Keep your purchase receipt as proof of purchase.