

Manuals+

[Q & A](#) | [Deep Search](#) | [Upload](#)

manuals.plus /

› [RONGJI](#) /

› [RONGJI Car Radio Stereo User Manual](#)

RONGJI Type A 8Core 8+128GB

RONGJI Car Radio Stereo User Manual

MODEL: TYPE A 8CORE 8+128GB

For Kia Sorento 2009-2013

1. Introduction

This manual provides detailed instructions for the installation, operation, and maintenance of your RONGJI 8+128GB 8Core Car Radio Stereo. This advanced head unit is designed specifically for Kia Sorento models from 2009 to 2013, offering a 10-inch IPS touch screen with integrated Car-Play, Android Auto, GPS navigation, and various multimedia features. Please read this manual thoroughly before installation and use to ensure proper functionality and safety.

2. Product Overview and Features

The RONGJI Car Radio Stereo is an advanced in-dash system designed to enhance your driving experience with modern connectivity and entertainment options.



Main Unit Display: The 10-inch IPS touch screen provides a clear and responsive interface for all functions.

Why Choose Us

Upgraded



Matel
Material

Plastic
Material



8 Core
CPU

VS

4 Core
CPU



1280x720
Resolution

1024x600
Resolution



Built-in
Cooling Fan

Without
Cooling Fan

Hardware Specifications: Features an 8-Core CPU, 8GB RAM, 128GB ROM, 1280x720 resolution, and a built-in cooling fan for optimal performance and durability.

Key Features:

- **Android 13.0 OS:** Provides a fast, smooth, and intuitive user experience.
- **10-inch IPS Touch Screen:** High-resolution (1280x720) capacitive display for clear visuals and responsive interaction.
- **Built-in Car-Play & Android Auto:** Supports both wireless and wired connections for seamless smartphone integration.
- **Bluetooth Connectivity:** Enables hands-free calling, phone book access, and audio streaming.
- **FM/AM/RDS Radio:** Stable radio frequency reception with automatic and manual tuning options.
- **Built-in DSP (EQ):** Digital Sound Processor for enhanced audio quality and customizable sound profiles.
- **Integrated WiFi Receiver:** Supports Wi-Fi and hotspot connections for online access and app downloads.
- **GPS Navigation:** Built-in GPS module with external antenna for online and offline map navigation.
- **Steering Wheel Control (SWC):** Allows control of music and calls directly from your vehicle's steering wheel.

- **Split Screen Function:** Display two applications simultaneously for multitasking.
- **Rear View Camera Support:** Compatible with aftermarket rear view cameras (camera not included).

3. Specifications

Feature	Specification
Operating System	Android 13.0
CPU	Octa Core (8Core)
RAM	8GB
ROM	128GB
Screen Size	10 Inches
Display Resolution	1280 x 720 (IPS Capacitive Touch Screen)
Connectivity	Bluetooth, Wi-Fi
Special Features	Car-Play, Android Auto, GPS Navigation, DSP, Steering Wheel Control, Split Screen
Vehicle Service Type	Car (Kia Sorento 2009-2013 specific)
Mounting Type	Dashboard Mount
Included Components	1 x Car Dash Cam
Manufacturer	Shenzhen Rongji Electronics Co., Ltd
Country of Origin	China

Note: The "Included Components" listing of "1 x Car Dash Cam" may be an error in the provided product data. Typically, this refers to the main head unit and its accessories.

4. Setup and Installation

Proper installation is crucial for the optimal performance of your new car stereo. It is highly recommended to have the unit installed by a professional if you are not familiar with car audio system installations.

4.1 Vehicle Compatibility Check

This unit is designed for Kia Sorento models from 2009-2013. Before purchasing or installing, carefully compare your vehicle's dashboard and factory radio socket with the provided images to ensure compatibility. Differences in dashboard layout, especially around the climate control area, may prevent installation.



Installation Comparison: Observe the transformation of the dashboard from the original factory radio to the new RONGJI head unit.

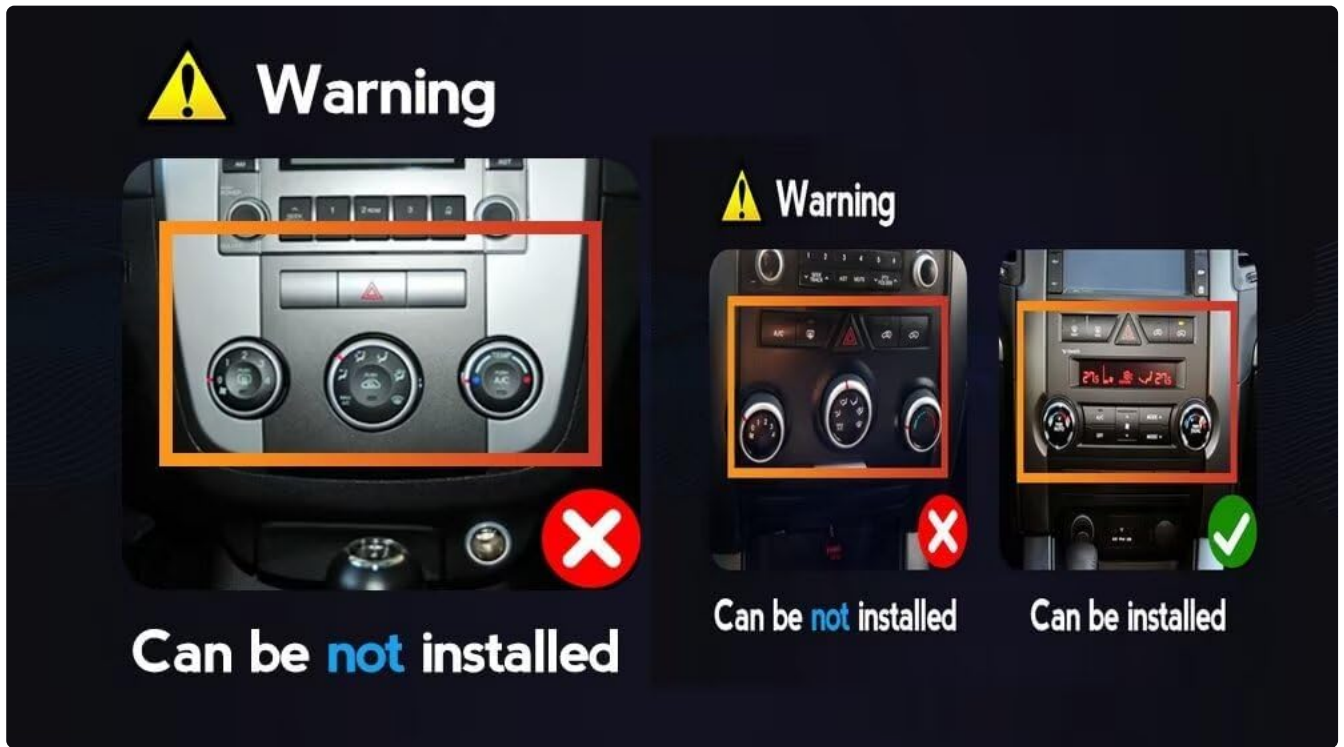

Compatibility Warning: This image illustrates specific dashboard configurations that are not compatible with this unit, alongside a compatible one. Ensure your vehicle's dashboard matches the 'Can be installed' example.

4.2 Pre-Installation Checklist

- Ensure the vehicle's battery is disconnected before starting any electrical work.
- Verify all components listed in the packaging are present.
- Have necessary tools ready (e.g., trim removal tools, screwdrivers, wire strippers).

4.3 Installation Steps (General Guide)

1. Carefully remove the existing factory radio and dashboard trim. Refer to your vehicle's specific service manual for detailed instructions.
2. Connect the wiring harness from the new head unit to the vehicle's factory wiring. Ensure all connections are secure.
3. Connect the GPS antenna, Wi-Fi antenna, and any other external accessories (e.g., rear view camera, USB cables).
4. Mount the new head unit securely into the dashboard opening.
5. Reconnect the vehicle's battery and perform a preliminary test of the unit's functions (power on, audio, touch screen responsiveness).
6. Reinstall the dashboard trim pieces.

5. Operating Instructions

This section details the primary functions and how to operate your RONGJI Car Radio Stereo.

5.1 Basic Operation

- **Power On/Off:** The unit typically powers on with the vehicle's ignition. Press and hold the power button (if available) for manual control.
- **Volume Control:** Adjust volume using the on-screen controls or steering wheel controls.
- **Touch Screen Navigation:** Tap icons to open applications, swipe to navigate menus, and use pinch-to-zoom for

maps.

5.2 Car-Play and Android Auto

Connect your smartphone to access navigation, music, calls, and messages safely while driving.



Car-Play and Android Auto: Supports both wired and wireless connections for seamless integration of your smartphone's features.

- **Wireless Connection:** Enable Bluetooth and Wi-Fi on your phone. On the head unit, go to the Car-Play/Android Auto app and follow the on-screen prompts to pair your device.
- **Wired Connection:** Connect your phone to the unit's USB port using a high-quality USB cable. The system should automatically detect and launch Car-Play or Android Auto.

5.3 Bluetooth Functions

Pair your phone via Bluetooth for hands-free calls and audio streaming.

1. Go to the Bluetooth application on the head unit.
2. Enable Bluetooth on your smartphone and search for available devices.

3. Select the head unit's Bluetooth name (e.g., "RONGJI_CAR_BT") from your phone's list and enter the pairing code if prompted (usually "0000" or "1234").
4. Once paired, you can make/receive calls and play music through the car speakers.

5.4 GPS Navigation and Wi-Fi

Utilize the built-in GPS for navigation and Wi-Fi for online features.

HD Capacitive Split Touch Screen

Support for two applications to be displayed on the screen at the same time which makes the operation more convenient and faster

Music+WEB

WEB+FM / MAP+FM etc...



Steering Wheel Control

Take control of the music or use hands-free calling function for safety to and concentrate on the road ahead. This head unit's steering wheel control (SWC) works with a digital SWC.





GPS and Wi-Fi: The unit supports accurate GPS positioning for navigation and Wi-Fi for internet access and app downloads.

- **GPS:** Open the Navigation app. You can download offline maps for areas without mobile signal. The unit supports GPS, GLONASS, and BDS for precise positioning.
- **Wi-Fi:** Go to Settings > Network & Internet > Wi-Fi. Select your home Wi-Fi network or phone hotspot and enter the password to connect. This enables online map updates, app downloads, and web browsing.

5.5 FM/AM Radio and DSP

Enjoy your favorite radio stations and customize your audio experience.

GPS accurate positioning

Built-in global positioning system , omni-directional map display , synchronous display real-time traffic conditions ,rapid and accurate positioning

GPS | GLONASS | BDS



Support WIFI

Built-in Wifi module allows you to watch online videos, listen to music, play games, and navigate online when connected to wifi.

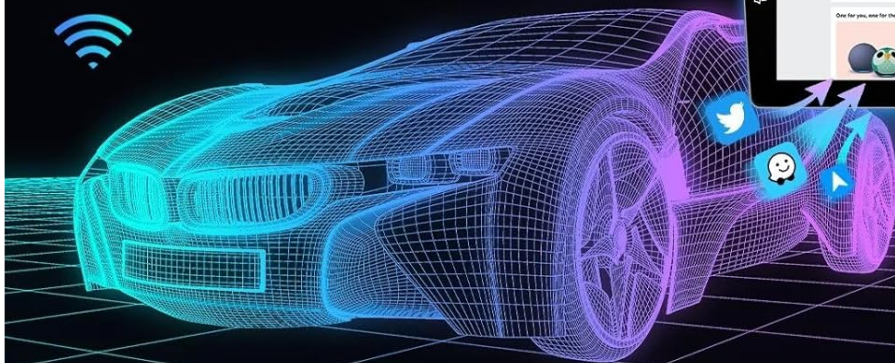

Radio and DSP: Access FM/AM radio with RDS and fine-tune your audio with the built-in Digital Sound Processor (DSP) equalizer.

- **Radio:** Open the Radio app. Use automatic search to find stations or manually tune to a specific frequency. RDS (Radio Data System) provides station information where available.
- **DSP (EQ):** Access the DSP or Equalizer settings from the main menu. Adjust frequency bands, bass enhancement, and sound field settings to optimize audio output.

5.6 Split Screen and Steering Wheel Control

Enhance multitasking and control convenience.

FM / AM RDS Radio

supports automatic search and manual search , You can drag the icon of target station and replace it into channel list

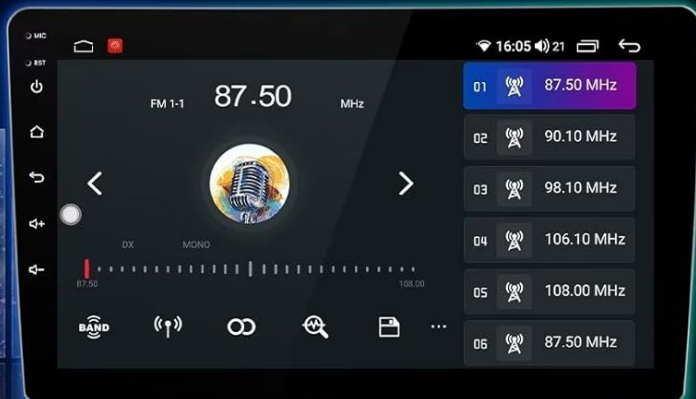

DSP Processor

Because we have a powerful DSP chip , we support equalizer adjustments which means you have more power to control the sound of various frequencies

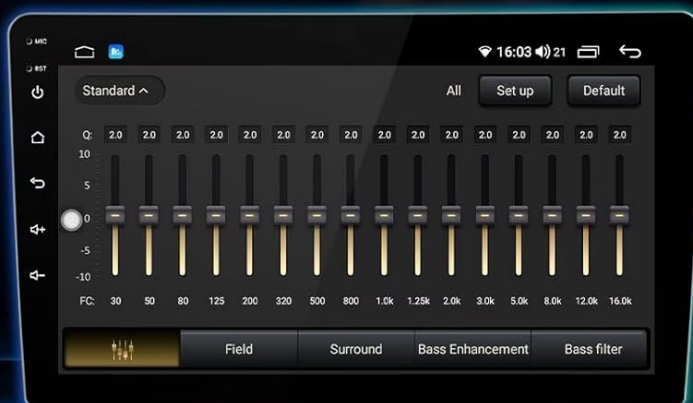

Split Screen and SWC: Use two applications simultaneously with split screen, and control media and calls safely via your steering wheel.

- **Split Screen:** While an app is open, long-press the recent apps button or drag an app to one side of the screen to activate split-screen mode. Select another app to run simultaneously.
- **Steering Wheel Control (SWC):** The unit supports your vehicle's original steering wheel controls. Navigate to Settings > SWC to configure or calibrate the buttons if needed. This allows control over volume, track skipping, and call management without taking your hands off the wheel.

6. Maintenance

Regular maintenance ensures the longevity and optimal performance of your car stereo.

- **Screen Cleaning:** Use a soft, lint-free cloth slightly dampened with water or a screen cleaner specifically designed for electronics. Avoid abrasive materials or harsh chemicals.
- **Dust Removal:** Periodically use compressed air to clear dust from vents and ports to prevent overheating.
- **Software Updates:** Check for available software updates through the unit's settings (if applicable) to ensure you have

the latest features and bug fixes.

- **Avoid Extreme Temperatures:** Do not expose the unit to prolonged direct sunlight or extreme cold, as this can affect performance and lifespan.

7. Troubleshooting

This section addresses common issues you might encounter and provides solutions.

Problem	Possible Cause	Solution
Unit does not power on.	Loose power connection, blown fuse, vehicle battery issue.	Check power wiring and fuse. Ensure vehicle battery is charged. Consult a professional if issues persist.
No sound from speakers.	Volume too low, mute activated, speaker wiring issue, incorrect audio output settings.	Increase volume. Check if unit is muted. Verify speaker connections. Check audio settings in DSP/EQ.
Bluetooth not connecting.	Bluetooth not enabled, incorrect pairing process, interference.	Ensure Bluetooth is enabled on both devices. Delete previous pairings and re-pair. Move closer to the unit.
GPS signal weak or inaccurate.	GPS antenna not properly installed or obstructed, old map data.	Ensure GPS antenna has a clear view of the sky. Check antenna connection. Update map data if available.
Touch screen unresponsive.	Temporary software glitch, screen protector interference, physical damage.	Restart the unit. Remove any thick screen protectors. If damage is visible, contact support.

If you encounter issues not listed here or if the suggested solutions do not resolve the problem, please contact customer support for further assistance.

8. Warranty and Support

For warranty information, please refer to the documentation provided with your purchase or contact the seller directly. RONGJI is committed to providing quality products and customer satisfaction.

For technical support or inquiries, please visit the official RONGJI store on Amazon or contact their customer service department.

RONGJI Store Link: <https://www.amazon.com/stores/RONGJI/page/485EB8D5-E5C5-4D83-AAEF-F3D387E12594>

