



[Manuals.plus](#) /

› [WARRIORLAND](#) /

› WARRIORLAND WLS-105G Green Laser Sight User Manual

WARRIORLAND WLS-105G

WARRIORLAND WLS-105G Green Laser Sight User Manual

Model: WLS-105G | Brand: WARRIORLAND

INTRODUCTION

This user manual provides comprehensive instructions for the WARRIORLAND WLS-105G Green Laser Sight. Designed for specific Glock models (42, 43, 43X, 48), this ultra-compact and lightweight trigger laser enhances aiming precision. Please read this manual thoroughly before installation and operation to ensure safe and correct usage.



Image: The WARRIORLAND WLS-105G Green Laser Sight, shown attached to a pistol, highlighting its compact design and green laser beam.

SAFETY INFORMATION

WARNING: Laser radiation. Avoid direct eye exposure. Class IIIa laser product, output less than 5mW. Always follow firearm safety rules. Ensure the firearm is unloaded and safe before handling or installing the laser sight. Do not point the laser at aircraft or individuals. Store the device out of reach of children.

PACKAGE CONTENTS

Verify that all items are present in the package:

- 1x Custom-made Green Laser Sight (WLS-105G)
- 2x CR1/3N batteries
- 1x Wrench for Laser Adjustment

- 2x Cotton swabs for cleaning
- 1x User Manual (this document)
- 1x Waterproof ring

SETUP AND INSTALLATION

The WLS-105G laser sight is designed for easy installation onto compatible Glock models. Ensure your firearm is unloaded and safe before proceeding.

1. **Preparation:** Ensure the laser sight is in its original status.

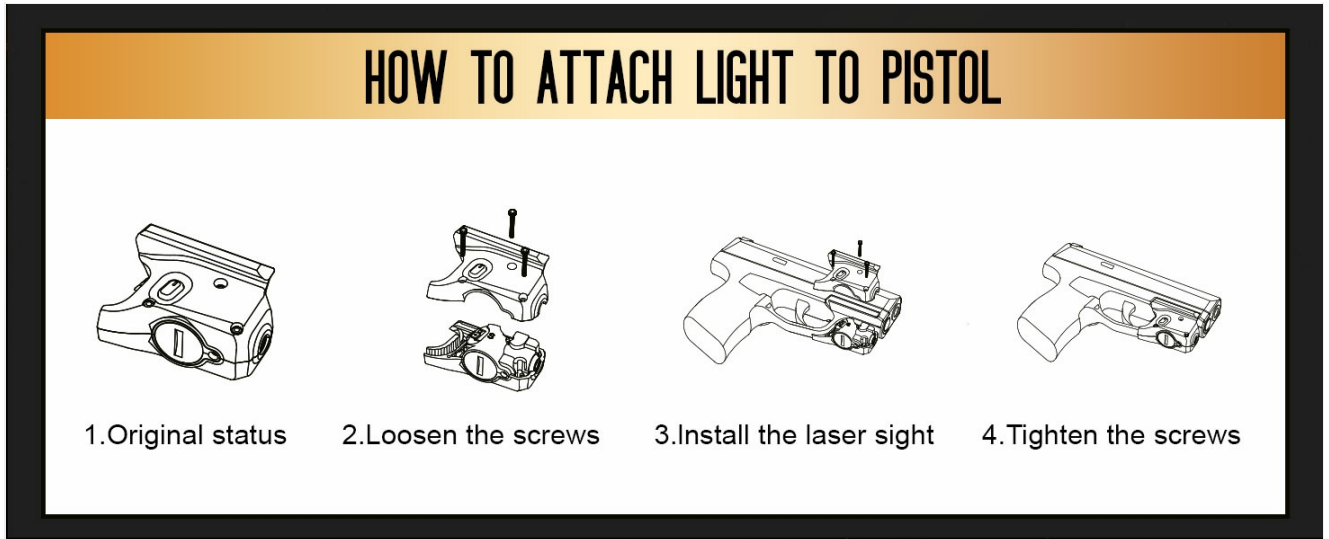

Image: Step-by-step diagram illustrating the attachment process of the laser sight to a pistol. From left to right: original status, loosening screws, installing the sight, and tightening screws.

2. **Loosen Screws:** Carefully loosen the screws on the laser sight using the provided wrench.
3. **Install Laser Sight:** Align the laser sight with the trigger guard and pistol rail of your compatible Glock model (42, 43, 43X, 48). The sight is custom-made to fit the contour perfectly.

DESIGN TO FIT PERFECTLY



Image: The WLS-105G laser sight shown installed on a Glock pistol, demonstrating its precise fit and compact integration with the trigger guard. Also shows compatibility with Glock 42, 43/43X, and 48.

- 4. Tighten Screws:** Once properly seated, tighten the screws securely to ensure the laser sight is stable and does not move during use. The design ensures a stable construction by attaching to both the trigger guard and the pistol rail.

STABLE & ACCURATE



Image: A close-up view of the green laser sight integrated seamlessly with the pistol's trigger guard, emphasizing its stable and accurate attachment without significant protrusion.

OPERATING INSTRUCTIONS

Power On/Off

The WLS-105G features an ambidextrous on/off switch for easy operation by both right and left-handed shooters. Simply tap the switch to activate or deactivate the laser.

Battery Indicator

The laser sight includes a power indicator to display the current battery level. This helps ensure you are always ready for use.

Green: Battery level is at 70%-100%.

Blue: Battery level is at 20%-70%.

Red: Battery level is at 0-20%.

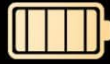

POWER INDICATOR

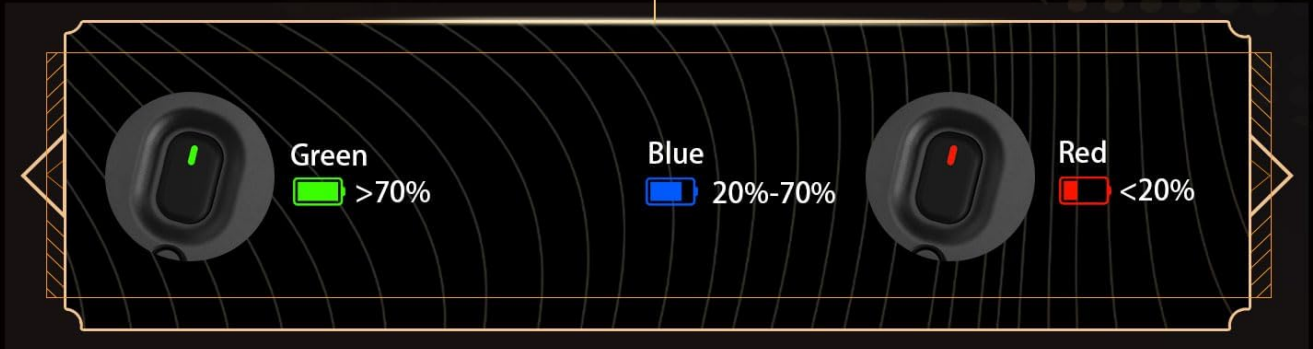

Image: Illustration of the WLS-105G laser sight with its power indicator, showing the different colors (Green, Blue, Red) that correspond to various battery charge levels.

Windage and Elevation Adjustment

The laser beam can be adjusted for windage (horizontal) and elevation (vertical) to enhance accuracy and suit specific tactical needs. Use the provided wrench to make precise adjustments.

WINDAGE AND ELEVATION ADJUSTMENT



WINDAGE ADJUSTMENT



ELEVATION ADJUSTMENT



Image: A detailed diagram showing the adjustment screws for windage and elevation on the WLS-105G laser sight, along with visual representations of how each adjustment affects the laser's point of aim.

WINDAGE AND ELEVATION ADJUSTMENT

WINDAGE ADJUSTMENT



ELEVATION ADJUSTMENT



Image: Another view detailing the windage and elevation adjustment mechanisms, showing the direction of turn for each adjustment and its effect on the laser dot's position relative to the target.

MAINTENANCE

Cleaning

Use the provided cotton swabs or a soft, dry cloth to clean the laser sight. Avoid using harsh chemicals or abrasive materials that could damage the lens or housing.

Battery Replacement

The WLS-105G uses 2 x CR1/3N batteries, providing approximately 160 minutes of runtime. When the power indicator shows red, it is time to replace the batteries. To replace, locate the battery compartment, open it, remove old batteries, insert new ones with correct polarity, and close the compartment securely.

TROUBLESHOOTING

Problem	Possible Cause	Solution
Laser does not turn on.	Dead batteries, incorrect battery installation, switch malfunction.	Check battery indicator. Replace batteries if low. Ensure batteries are inserted with correct polarity. Tap switch firmly.
Laser beam is dim or flickers.	Low battery power.	Replace batteries.
Laser sight is loose after installation.	Screws not tightened sufficiently.	Re-tighten mounting screws using the provided wrench. Ensure proper alignment.
Laser does not hold zero.	Improper installation, loose mounting, extreme recoil.	Ensure sight is securely mounted. Re-zero the laser. Check for any damage to the sight or firearm.

SPECIFICATIONS

Feature	Detail
Model Name	WLS-105G
Laser Type	Green Laser
Wavelength	510-530nm
Output Power	<5mW peak
FDA Class	Class IIIa
Laser Spot Size	<15mm@10m
Runtime	160 minutes (approx. 2.6 hours)
Battery Type	2 x CR1/3N batteries
Operating Temperature	-10°C ~ +55°C

Feature	Detail
Material	Durable, impact-resistant polymer
Weight	105 Grams
Compatible Devices	Glock 42 / 43 / 43X / 48 (Not Glock 43X Mos)

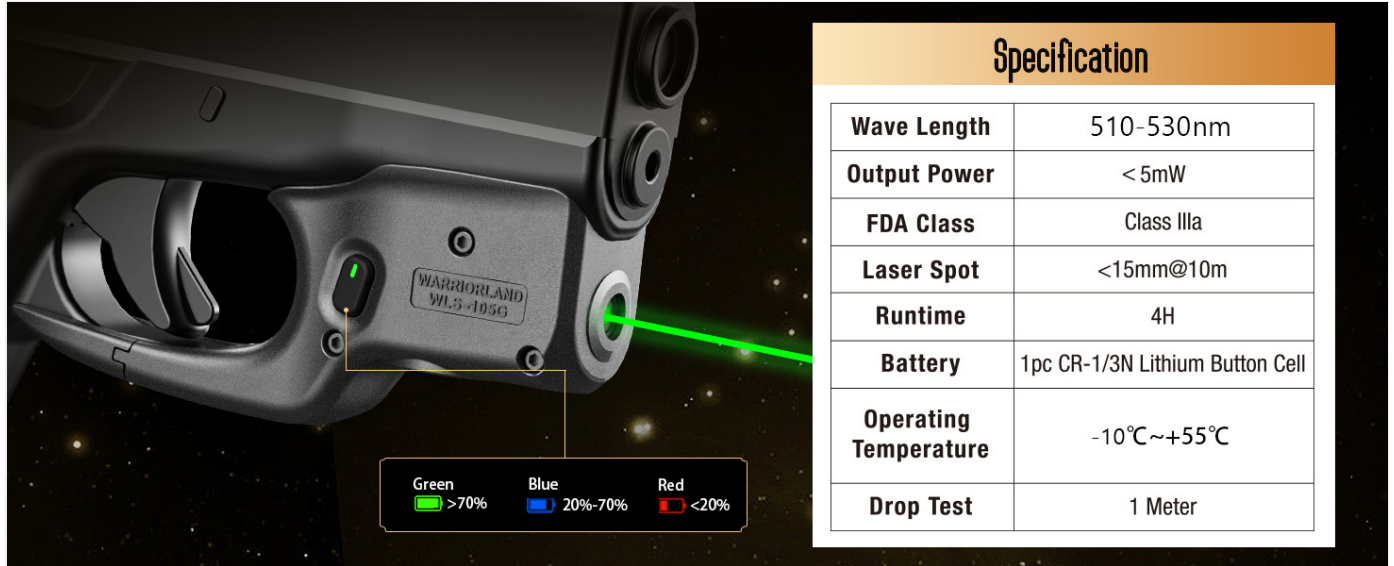

Specification	
Wave Length	510-530nm
Output Power	< 5mW
FDA Class	Class IIIa
Laser Spot	<15mm@10m
Runtime	4H
Battery	1pc CR-1/3N Lithium Button Cell
Operating Temperature	-10°C~+55°C
Drop Test	1 Meter

Green >70% Blue 20%-70% Red <20%

Image: A visual representation of the product specifications, including wavelength, output power, FDA class, laser spot size, runtime, battery type, operating temperature, and drop test rating.

WARRANTY INFORMATION

The WARRIORLAND WLS-105G Green Laser Sight comes with a **Limited Lifetime Warranty**. This warranty covers defects in materials and workmanship under normal use. For detailed terms and conditions, please refer to the warranty card included in your package or contact WARRIORLAND customer support.

CUSTOMER SUPPORT

For any questions, technical assistance, or warranty claims, please contact WARRIORLAND customer support. Visit the official WARRIORLAND website for the most up-to-date contact information and additional resources.

Visit the [WARRIORLAND Store on Amazon](#)