

Manuals+

[Q & A](#) | [Deep Search](#) | [Upload](#)

manuals.plus /

- › [GIMI COCKPIT](#) /
- › [GIMI COCKPIT Imperator GM-520 Zero Gravity Reclining Gaming Workstation Instruction Manual](#)

GIMI COCKPIT 520B

GIMI COCKPIT Imperator GM-520 Zero Gravity Reclining Gaming Workstation Instruction Manual

Model: 520B

1. IMPORTANT SAFETY INFORMATION

Please read all instructions carefully before assembly and operation. Retain this manual for future reference.

- **Maximum Weight Capacity:** Do not exceed the maximum weight capacity of 410 lbs (186 kg). Exceeding this limit may cause instability and damage to the workstation, potentially leading to injury.
- **Stable Environment:** Ensure the workstation is assembled and used on a stable, level surface.
- **Proper Assembly:** Follow all assembly instructions precisely. Incorrect assembly can compromise the structural integrity of the workstation.
- **Children and Pets:** Keep children and pets away from the workstation during assembly and operation to prevent accidents.
- **Electrical Components:** If your model includes electrical components (e.g., RGB lights, reading light), ensure all connections are secure and follow electrical safety guidelines. Disconnect power before cleaning or maintenance.
- **Moving Parts:** Be aware of pinch points when adjusting reclining mechanisms, monitor arms, and keyboard trays.

2. PRODUCT OVERVIEW

The GIMI COCKPIT Imperator GM-520 is a zero-gravity reclining workstation designed for immersive gaming and comfortable office use. It features extensive adjustability for the chair, monitor mounts, and accessories.

Key Features:

- Executive Leather Massage Seat (23.8" Width)
- Backrest Recline up to 165 Degrees

- Seat Cushion Recline up to 35 Degrees
- Adjustable Monitor Arm for distance, angle, and position
- Support for multiple monitors (up to 3x 32" or 1x 55" Odyssey Ark with optional bracket)
- Adjustable Keyboard Tray (left or right side installation)
- Stepless Dimmable Reading Light
- RGB Lighting
- Adjustable Foot Pedal



Figure 1: The Emperor GM-520 Zero Gravity Reclining Gaming Workstation in its standard configuration.

3. SETUP AND ASSEMBLY

The Imperator GM-520 requires assembly. Due to the complexity and weight of the components, it is recommended that two adults perform the assembly. Ensure all parts are present before beginning.

3.1 Unpacking and Component Check

- Carefully unpack all components from the packaging.
- Verify that all parts listed in the packing list are present and undamaged. If any parts are missing or damaged, contact customer support immediately.

3.2 Space Requirements

Before assembly, ensure you have adequate space. Refer to the dimensions diagram below for planning.

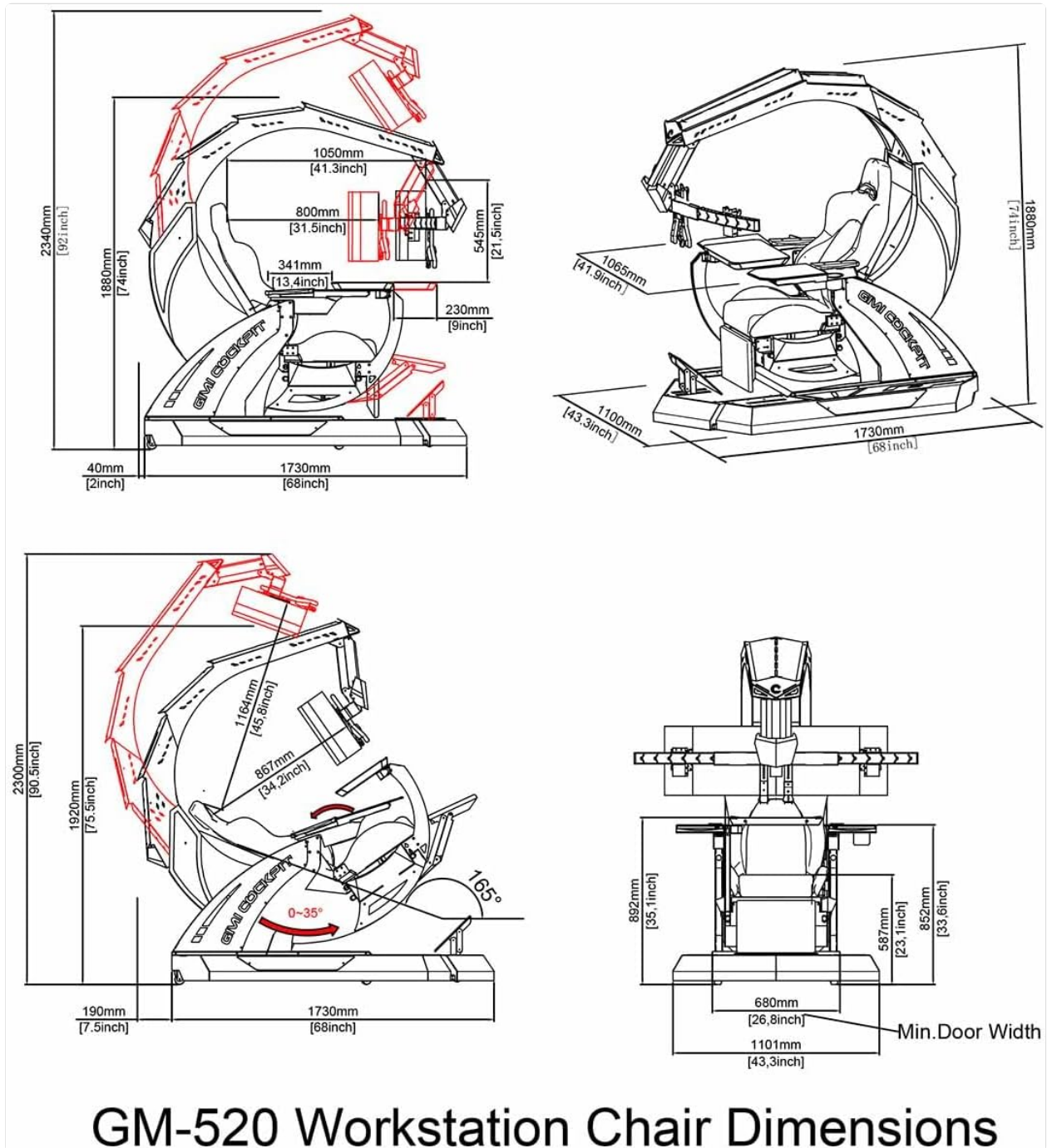

Figure 2: GM-520 Workstation Chair Dimensions. This diagram illustrates the overall dimensions of the workstation in various positions, including height, width, and depth, crucial for space planning.

3.3 Core Assembly (General Steps)

While detailed step-by-step instructions are typically provided with the product packaging, the general assembly involves:

1. Assemble the base frame and attach the main support structure.
2. Mount the chair seat and backrest onto the main support.
3. Attach the monitor arm assembly to the main frame.
4. Install the keyboard tray and armrests. The keyboard tray can be installed on either the right or left side.
5. Connect any electrical components, such as the RGB lighting and reading light, to the power supply.
6. Install the foot pedal.

3.4 Monitor Installation

The workstation supports various monitor configurations:

- **Single Monitor:** Attach your monitor to the central VESA mount.
- **Multiple Monitors:** The system supports up to three 32-inch monitors. Additional custom brackets may be required for five 32-inch monitors.
- **Large Monitors:** For a single 55-inch Odyssey Ark monitor, an optional custom bracket is required.

Ensure monitors are securely fastened and cables are managed to prevent interference with movement.



Figure 3: The workstation configured with a monitor and keyboard tray, demonstrating the adjustable components.

4. OPERATING INSTRUCTIONS

The Emperor GM-520 offers extensive adjustability to optimize your comfort and viewing experience.

4.1 Reclining Functions

- **Backrest Recline:** The backrest can recline up to 165 degrees. Use the lever located on the side of the seat to adjust the angle.

- **Seat Cushion Recline:** The seat cushion can recline up to 35 degrees, allowing for a 'knees above heart' zero-gravity position. Adjust this independently or in conjunction with the backrest.



Figure 4: Illustration of the 165-degree backrest recline and 35-degree seat cushion recline capabilities of the GM-520 workstation.

4.2 Monitor Arm Adjustments

The monitor arm provides flexibility for optimal screen positioning:

- **Up/Down Adjustment:** Adjust the height of the monitor arm to align screens with your eye level.
- **Monitor Distance:** Slide the monitor mount along the arm to adjust the distance from your eyes (range from approximately 20" to 32").
- **Monitor Tilt Angle:** Tilt the monitors up or down for ergonomic viewing.
- **Monitor Mount Position Adapter:** Fine-tune the position of individual monitors on multi-monitor setups.
- **Easy Entry:** The monitor arm can be fully opened or swung away to facilitate easy entry and exit from the workstation.

4.3 Keyboard Tray and Armrest Adjustments

- **Keyboard Tray Position and Angles:** Adjust the height, depth, and angle of the keyboard tray for comfortable typing and mouse use.
- **Keyboard Tray Recline:** The keyboard tray is designed to recline with the chair, while the armrests recline less, maintaining a stable surface for peripherals.
- **Armrest Position:** Armrests can be fully opened for easy access and to accommodate mouse movement.

4.4 Lighting Controls

- **Stepless Dimmable Reading Light:** Use the dedicated control to adjust the brightness of the integrated reading light.
- **RGB Lights:** Control the color and pattern of the RGB lighting to customize your environment. Refer to the specific RGB controller instructions for detailed operation.



Figure 5: The Emperor GM-520 workstation integrated into a room setting, showcasing its ambient lighting features.

5. MAINTENANCE

Regular maintenance ensures the longevity and optimal performance of your Emperor GM-520 workstation.

- **Cleaning:**
 - For leather surfaces, wipe with a soft, damp cloth. Use a mild leather cleaner if necessary, following the product instructions. Avoid harsh chemicals.
 - For powder-coated metal surfaces, wipe with a soft, dry or slightly damp cloth.

- Ensure all electrical components are unplugged before cleaning.
- **Inspections:** Periodically check all bolts, screws, and connections to ensure they are tight. Re-tighten if necessary.
- **Moving Parts:** Keep moving parts free of obstructions. Avoid forcing adjustments if resistance is met.

6. TROUBLESHOOTING

This section addresses common issues you might encounter with your workstation.

6.1 Adjustment Mechanisms Not Moving Smoothly

- **Check for Obstructions:** Ensure no cables, clothing, or other objects are impeding the movement of the chair, monitor arm, or keyboard tray.
- **Lubrication:** If mechanisms feel stiff, a small amount of silicone-based lubricant can be applied to pivot points, avoiding electrical components.
- **Loose Fasteners:** Verify that all bolts and screws related to the affected mechanism are securely tightened.

6.2 Electrical Components (Lights) Not Functioning

- **Power Connection:** Ensure the workstation is properly plugged into a functional power outlet.
- **Cable Integrity:** Check all power cables and internal connections for any signs of damage or loose connections.
- **Controller Check:** If applicable, ensure the RGB or reading light controller is functioning correctly and not in a 'off' state.

6.3 Workstation Instability

- **Level Surface:** Confirm the workstation is on a flat, level floor.
- **Tighten Fasteners:** Re-check and tighten all assembly bolts and screws, especially those connecting the base and main frame.
- **Weight Distribution:** Ensure weight is distributed evenly and not exceeding the maximum capacity.

If you encounter issues not covered here or require further assistance, please contact GIMI COCKPIT customer support.

7. SPECIFICATIONS

Brand	GIMI COCKPIT
Model Name	520B
Color	Black
Product Dimensions (D x W x H)	68"D x 44"W x 92"H
Back Style	Solid Back
Special Feature	Arm Rest, Cushion Availability

Recommended Uses	Gaming, Reading
Maximum Weight Recommendation	410 Pounds (186 kg)
Finish Type	Powder Coated
Included Components	CHAIR (Workstation components)
Arm Style	With arms
Indoor/Outdoor Usage	Indoor
Furniture Finish	Leather
Seat Depth	22 inches
Fill Material	Foam
Reclining Position Count	2 (Backrest, Seat Cushion)
Tilting	Yes
Is Customizable	Yes
Chair Backrest Width	23.8 Inches
Item Weight	620 pounds (Shipping Weight)
Date First Available	April 24, 2024

8. WARRANTY AND SUPPORT

For specific warranty information regarding your GIMI COCKPIT Emperor GM-520 workstation, please refer to the documentation included with your purchase or contact the seller directly. Warranty terms may vary based on region and retailer.

If you require technical support, have questions about assembly, or need to report a missing/damaged part, please contact the GIMI COCKPIT customer service department or your authorized retailer. Contact information is typically provided with your purchase documentation.

9. OFFICIAL PRODUCT VIDEOS

No official product videos from the seller were available for embedding in this manual.