

## Manuals+

[Q & A](#) | [Deep Search](#) | [Upload](#)

manuals.plus /

› [Combier](#) /

› [Combier CMA210S-B Bidet Toilet Seat User Manual](#)

## Combier CMA210S-B

# Combier CMA210S-B Bidet Toilet Seat User Manual

Model: CMA210S-B

## 1. INTRODUCTION

This manual provides detailed instructions for the installation, operation, and maintenance of your Combier CMA210S-B Bidet Toilet Seat. Please read this manual thoroughly before installation and use to ensure proper function and safety. Keep this manual for future reference.



The Combiert CMA210S-B Bidet Toilet Seat, shown with its wireless remote control.

## 2. PRODUCT FEATURES

The Combiert CMA210S-B Bidet Toilet Seat is designed to enhance personal hygiene and comfort with a range of advanced features:

- **Adjustable Heated Seat:** Provides warmth for comfort, especially in colder environments.
- **Warm Water Wash:** Offers continuous warm water for cleansing with adjustable temperature and

pressure settings.

- **Warm Air Dryer:** Reduces the need for toilet paper with adjustable warm air.
- **Multiple Spray Modes:** Includes Rear Wash, Front Wash, Oscillating Wash, and Turbo Wash for comprehensive cleaning.
- **Self-Cleaning Nozzle:** Stainless steel nozzle performs self-cleaning before and after each use.
- **Wireless Remote Control:** Full-function remote for easy adjustment of settings.
- **Side Control Knob:** Provides an alternative control method for essential functions.
- **LED Nightlight:** Illuminates the toilet bowl for convenience during nighttime use.
- **Slow Closing Seat & Lid:** Prevents slamming for quiet operation and increased durability.
- **Smart Seat Sensor:** Activates functions only when the seat is occupied.
- **Eco Mode:** Energy-saving function to reduce power consumption.



Visual representation of the adjustable warm air, heated seat, warm water, and night light features.

## LED Display

You can understand the current setting at a glance



## Control Knob

Easier operation, offering functions such as rear wash, Female wash and drying.



## Wireless Remote

Full-function wireless remote right by your side.



The LED display shows current settings, alongside the side control knob and the full-function wireless remote.

### 3. PACKAGE CONTENTS

Verify that all components are present in the package before beginning installation:

- 1x Smart Bidet Seat
- 1x Wireless Remote
- 1x Instruction Manual
- 2x Screw
- 2x Gasket
- 2x Steel Disc
- 1x Mounting Plate
- 2x Anchoring Rubber
- 1x Three-way Valve
- 1x PE Pipe

# BIDET TOILET SEAT FIT CHECK

Our products are suitable for the following sizes, please check carefully before purchase

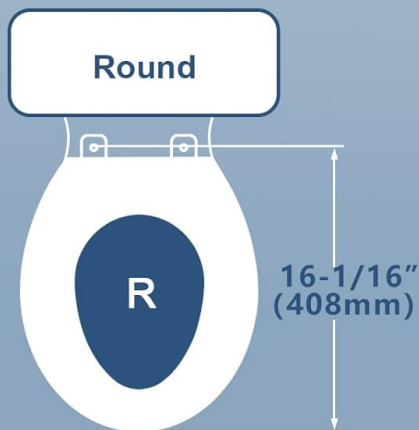

Illustration of all items included in the product packaging.

## 4. INSTALLATION GUIDE

Follow these steps for proper installation. It is recommended to review the full installation manual (PDF) for detailed diagrams and safety information. No plumber is typically required for this installation.

### 4.1 Pre-Installation Check

- Ensure your toilet is an elongated type.
- Confirm there is a power outlet (120V AC) within reach of the bidet seat's power cord.
- Turn off the water supply to the toilet.
- Flush the toilet to empty the tank.

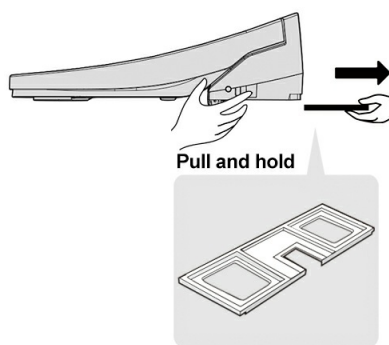

Diagram illustrating fit requirements for elongated and round toilets, and the necessity of a power outlet.

#### 4.2 Mounting the Bidet Seat

1. **Remove Existing Toilet Seat:** Detach your current toilet seat and lid from the toilet bowl.
2. **Install Mounting Plate:** Place the mounting plate over the toilet bowl holes. Insert the screws, gaskets, and steel discs, then secure them with anchoring rubber from underneath. Adjust the plate position as needed.
3. **Attach Bidet Seat:** Slide the bidet toilet seat onto the installed mounting plate until it clicks into place.

1



Step 1: Detach the mounting plate from the bidet seat by pulling and holding the release button.

2

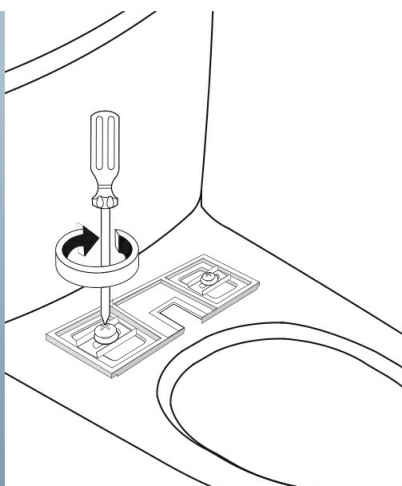

Step 2: Use a screwdriver to secure the mounting plate to the toilet bowl.

3

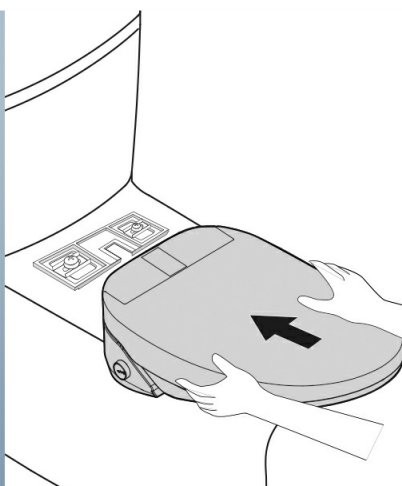

Step 3: Slide the bidet toilet seat firmly onto the installed mounting plate until it locks.

#### 4.3 Water Connection

4. **Install T-Valve:** Disconnect the existing water supply hose from the toilet tank. Install the provided T-valve between the toilet tank fill valve and the water supply hose.
5. **Connect PE Pipe:** Connect one end of the PE pipe to the T-valve and the other end to the water inlet on the bidet seat. Ensure all connections are hand-tightened to prevent leaks.
6. **Restore Water Supply:** Slowly turn on the water supply to the toilet and check for any leaks.

4

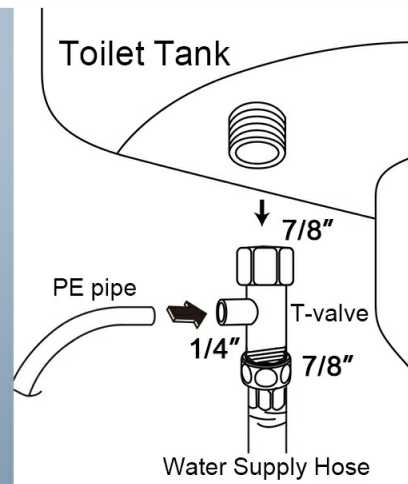

Step 4: Connect the PE pipe to the T-valve, which is installed between the toilet tank and the water supply hose.

5

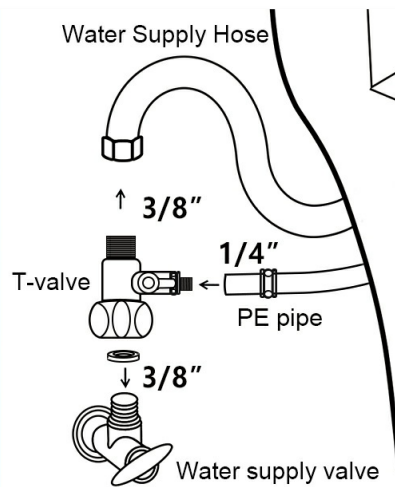

Step 5: Illustrates the complete water connection setup, showing the T-valve connecting to the toilet tank and the main water supply valve.

#### 4.4 Power Connection

Plug the bidet toilet seat's power cord into a grounded 120V AC electrical outlet. Ensure the outlet is protected by a Ground Fault Circuit Interrupter (GFCI) for safety.

### 5. OPERATING INSTRUCTIONS

The Combiar CMA210S-B can be operated using the wireless remote control or the side control knob.

#### 5.1 Wireless Remote Control Functions

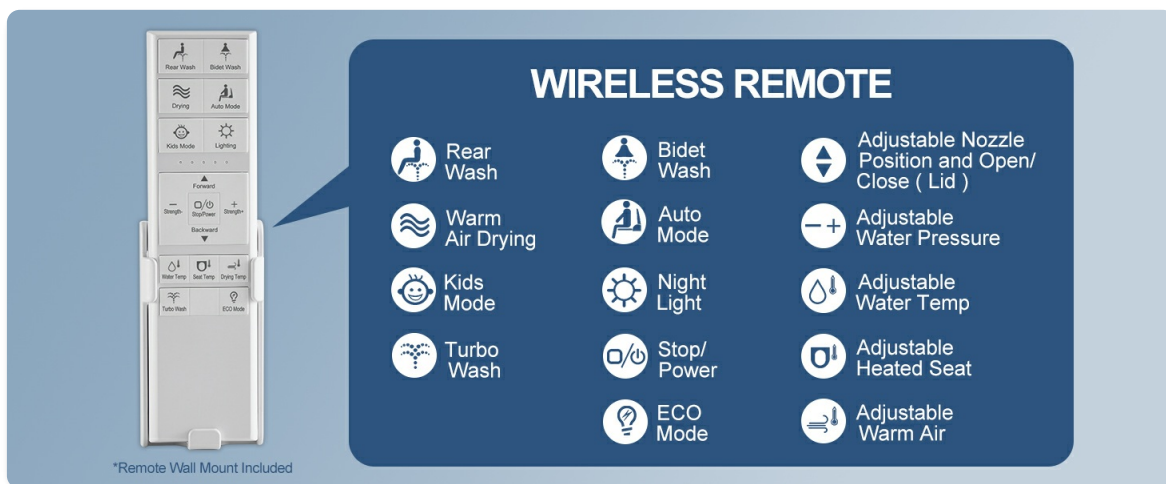

Detailed overview of the wireless remote control buttons and their corresponding functions.

- **Rear Wash:** Activates the rear cleansing spray.
- **Bidet Wash (Front Wash):** Activates the feminine cleansing spray.
- **Warm Air Drying:** Initiates the warm air drying cycle.
- **Auto Mode:** Performs a preset sequence of wash and dry cycles.
- **Kids Mode:** Provides a gentler wash and dry cycle suitable for children.
- **Night Light:** Toggles the LED night light on/off.
- **Adjustable Nozzle Position:** Controls the forward/backward position of the nozzle.
- **Adjustable Water Pressure:** Increases or decreases water spray intensity.
- **Adjustable Water Temperature:** Adjusts the temperature of the wash water.
- **Adjustable Heated Seat:** Controls the seat temperature.
- **Adjustable Warm Air:** Controls the temperature of the air dryer.
- **Turbo Wash:** Provides a stronger, more focused wash.
- **Stop/Power:** Stops current operation or turns the unit on/off.
- **ECO Mode:** Activates energy-saving mode.

## 5.2 Side Control Panel

The side control knob offers quick access to essential functions such as rear wash, front wash, and drying.

## 5.3 Basic Operation

1. **Sit on the Seat:** The smart seat sensor will detect your presence, enabling the bidet functions.
2. **Select Wash Mode:** Press the desired wash button (Rear Wash, Bidet Wash, Turbo Wash) on the remote or use the side knob.
3. **Adjust Settings:** Use the remote to adjust water pressure, water temperature, and nozzle position to your preference.
4. **Dry:** After washing, press the Warm Air Drying button. Adjust air temperature as desired.
5. **Stop:** Press the Stop button to end any operation.



## Turbo Wash

Stainless steel nozzles spray water rinsing, Multiple modes can be selected, Take you to enjoy the cleaning function of the luxury toilet!



Rear Wash



Front Wash



Oscillating Wash



Self-cleaning Nozzle

Illustration of the Turbo Wash feature and different spray patterns including Rear Wash, Front Wash, Oscillating Wash, and the self-cleaning nozzle.

## 6. MAINTENANCE

Regular cleaning and maintenance will ensure the longevity and optimal performance of your bidet toilet seat.

### 6.1 Cleaning the Bidet Seat

- Unplug the power cord and turn off the water supply before cleaning.
- Wipe the exterior surfaces with a soft, damp cloth and a mild, non-abrasive cleaner.
- Do not use harsh chemicals, abrasive cleaners, or brushes, as these can damage the surface.
- For the nozzle, the self-cleaning function is typically sufficient. If manual cleaning is needed, gently wipe the nozzle with a soft cloth.

### 6.2 Filter Maintenance

Periodically check the water filter (if applicable) for sediment buildup. Clean or replace as necessary to maintain water flow and prevent nozzle clogging.

## 6.3 Long-Term Storage

If the bidet seat will not be used for an extended period, or during freezing temperatures, drain all water from the unit to prevent damage. Refer to the full manual for detailed draining instructions.

## 7. TROUBLESHOOTING

If you encounter issues, refer to the following common troubleshooting steps. For problems not listed here, consult the full instruction manual or contact customer support.

Problem	Possible Cause	Solution
No water spray	Water supply off, filter clogged, seat sensor not activated.	Ensure water supply valve is open. Clean or replace water filter. Ensure you are seated properly to activate the sensor.
No heated water	Heater setting too low, power issue.	Increase water temperature setting. Check power connection and GFCI.
No heated seat	Heated seat setting too low, power issue.	Increase seat temperature setting. Check power connection and GFCI.
Remote control not working	Dead batteries, remote out of range, obstruction.	Replace remote batteries. Ensure remote is within operating range and no obstructions block the signal.
Leaks from connections	Loose connections.	Turn off water supply. Gently tighten all water connections. Do not overtighten.
Unit beeps constantly or displays error code (e.g., F3)	Internal malfunction or specific error condition.	Unplug the unit for 30 seconds, then plug it back in. If the issue persists, consult the detailed manual for error code explanations or contact customer support.

## 8. SPECIFICATIONS

<b>Model Number</b>	CMA210S-B
<b>Brand</b>	Combier
<b>Shape</b>	Elongated
<b>Product Dimensions</b>	20.47"L x 15.71"W
<b>Item Weight</b>	10 Pounds
<b>Material</b>	Acrylonitrile Butadiene Styrene (ABS)

<b>Color</b>	White, Black
<b>Power Supply</b>	120V AC (Requires GFCI protected outlet)
<b>Included Components</b>	Bidet Toilet Seat, Wireless Remote, Installation Hardware

## 9. WARRANTY AND SUPPORT

For warranty information or technical assistance, please refer to the official Combier website or contact their customer support directly. Keep your purchase receipt as proof of purchase.

### Online Resources:

- For the complete installation manual, please refer to the [Installation Manual \(PDF\)](#).