

mollie TSC-09HA1/I3TI22

mollie 9000 BTU Mini Split Air Conditioner (Model TSC-09HA1/I3TI22) Instruction Manual

Your comprehensive guide to installation, operation, and maintenance.

1. INTRODUCTION

This manual provides detailed instructions for the safe and efficient operation of your mollie 9000 BTU Mini Split Air Conditioner, Model TSC-09HA1/I3TI22. This unit offers both heating and cooling functionalities, smart app control, and advanced air filtration for optimal indoor comfort.

2. SAFETY INFORMATION

- **Professional Installation Required:** This mini-split AC unit requires professional installation. Attempting to install the unit without proper training and tools may result in injury, property damage, or voiding the warranty.
- **Electrical Safety:** Ensure the unit is connected to a properly grounded electrical outlet with the correct voltage (115V). Do not use extension cords.
- **Refrigerant:** The unit is pre-charged with R410A refrigerant. Handling of refrigerant should only be performed by certified technicians.
- **Clearance:** Maintain adequate clearance around both indoor and outdoor units for proper airflow and operation. Refer to the installation section for specific distances.

3. PACKAGE CONTENTS

The mollie 9000 BTU Mini Split Air Conditioner package includes the following components:

- Indoor Air Handler Unit
- Outdoor Condenser Unit
- Remote Control
- 4-in-1 Filter
- Installation Kit (Copper Line Set, Drain Hose, Sealing Gum, Drain Joint, Tape, Screws)

Note: Connecting cable and signal wire are NOT included and must be purchased separately based on length needed.



Figure 3.1: Included components for the mollie mini split air conditioner. Note that the signal wire is not included.

4. SETUP AND INSTALLATION

Installation of this mini-split air conditioner requires specialized knowledge and tools. It is mandatory to have the unit installed by a qualified HVAC professional to ensure proper function, safety, and warranty validity.

4.1 Important Considerations

- **Location:** Choose a location for both indoor and outdoor units that allows for adequate airflow and maintenance access.
- **Clearance:** Ensure sufficient clearance from walls and other obstructions. For the indoor unit, maintain at least 5 inches (13cm) from side walls and 8 inches (20cm) from the ceiling. For the outdoor unit, ensure at least 20 inches (50cm) from side walls and 79 inches (200cm) from the front.
- **Electrical Connection:** The unit operates on 115V AC. A dedicated circuit may be required.
- **Signal Wire:** The signal wire, which connects the indoor and outdoor units, is not included. The installer will need to determine the appropriate length and type of signal wire.



Figure 4.1: Recommended clearances for indoor and outdoor unit installation.

5. OPERATING INSTRUCTIONS

Your mollie mini-split AC unit can be controlled via the included remote control or through the smart app on your smartphone.

5.1 Control Options

- **Remote Control:** The handy remote control allows you to adjust settings from a distance. The display screen on the remote turns off automatically after 10 seconds of inactivity to avoid disturbing sleep.
- **Smart App Control:** The unit is equipped with smart Wi-Fi connectivity. Download the dedicated smartphone app to control your AC remotely. This allows for pre-cooling your home before arrival and managing settings from anywhere.

BUILT-IN WIFI

OPERATING FROM ANYWHERE VIA WIFI



PRE-COOLING WHEN YOU'RE ALMOST HOME

NO LONGER WORRY ABOUT FORGETTING
TURN OFF AIR CONDITIONER

Figure 5.1: Control your unit with the remote or smart app.

MERV GRADE AIR FILTER SCREEN

CAPTURES 80-89.9% OF 1.0 TO 3.0 MICRON PARTICLES,
AND GREATER THAN 90% OF 3.0-10.0 MICRON PARTICLES

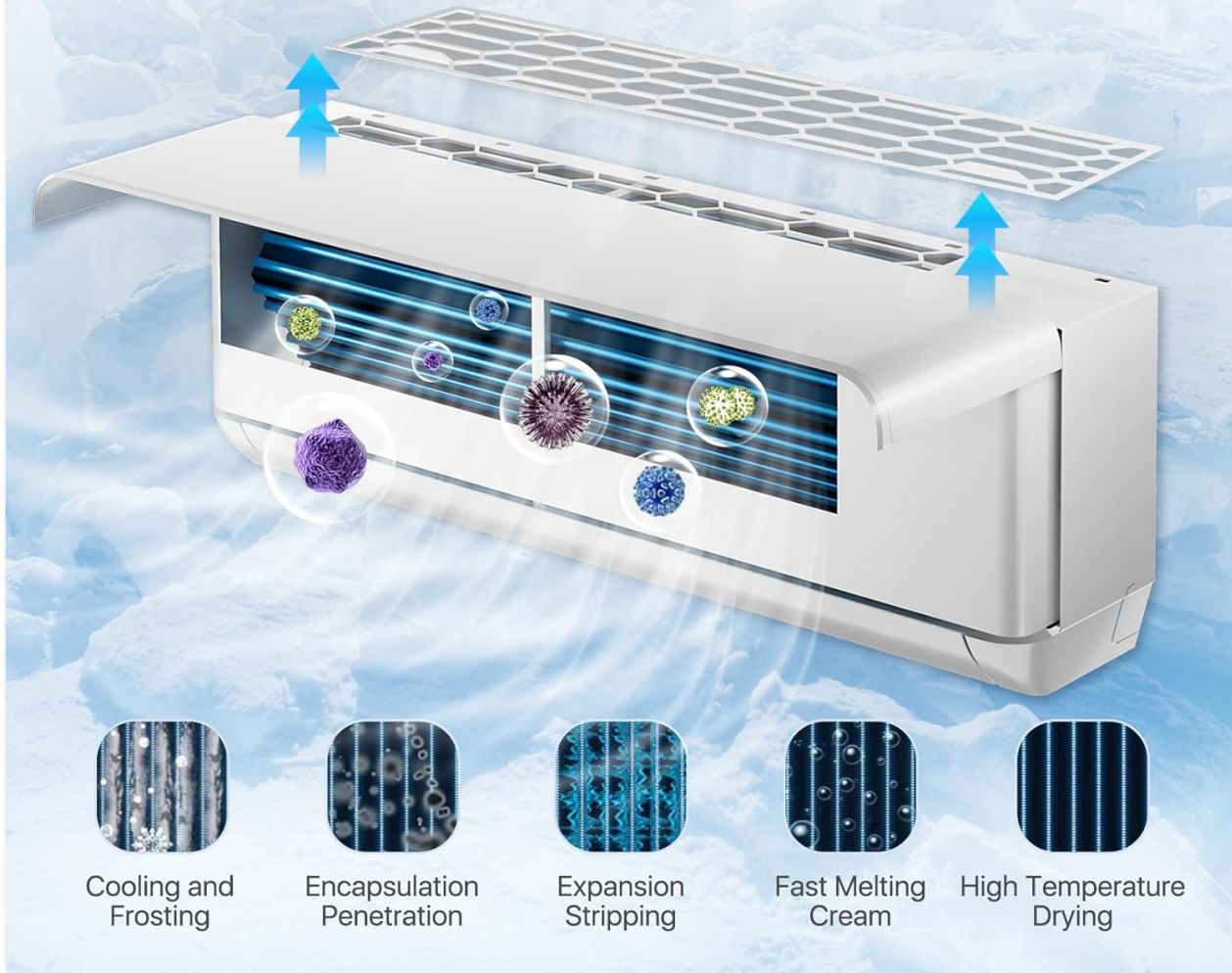

Figure 5.2: Detailed view of the smart app control options.

5.2 Operating Modes

The unit offers 8 working modes:

- **Cool:** Provides cooling to lower room temperature.
- **Heat:** Provides heating to raise room temperature.
- **Dry:** Dehumidifies the air.
- **Auto:** Automatically selects the appropriate mode based on the set temperature and current room conditions.
- **Fan:** Circulates air without heating or cooling.
- **Eco:** Optimizes energy consumption for efficient operation.
- **Sleep:** Adjusts temperature and fan speed for quiet and comfortable sleep.
- **TURBO:** Provides maximum cooling or heating power for rapid temperature change.

Operation temperature range: 61°F - 88°F.

5.3 Fan Speed Settings

The unit features 7 available fan speeds to meet various needs, allowing you to customize airflow intensity.

5.4 Timer Function

Set a smart 0.5-24 hour timer for automatic on/off operation, enhancing convenience and energy saving.

5.5 Sleep Mode

In Sleep Mode, all display lights turn off, and the unit automatically adjusts temperature and fan speed during the night to ensure peaceful sleep with low noise operation (27 Decibels).



Figure 5.3: Sleep mode ensures quiet operation for undisturbed rest.

5.6 Air Flow Control

The unit features 360° precision air flow control, allowing you to adjust the air flow direction precisely for uniformly distributed cool or heated air throughout the room.

SMART APP CONTROL

CONTROL YOUR AC ANYWHERE AND ANYTIME

Mode



Cool



Heat



Dry



Fan



Auto

Fan



High



Mid



Low



Auto

More



Buzzer



Reservation



Electricity
Monitoring



Self-diagnosis



Figure 5.4: 360° precision air flow for even temperature distribution.

6. MAINTENANCE

Regular maintenance ensures optimal performance and longevity of your air conditioner.

6.1 Filter Cleaning

The 4-in-1 filter combines activated charcoal and photocatalysts for air purification. Clean the filter regularly to maintain superior air quality and unit efficiency. The unit will remind you to clean the filter after every 250 hours of use.

BREATHE BETTER, LIVE HEALTHIER WITH 4-IN-1 FILTER.

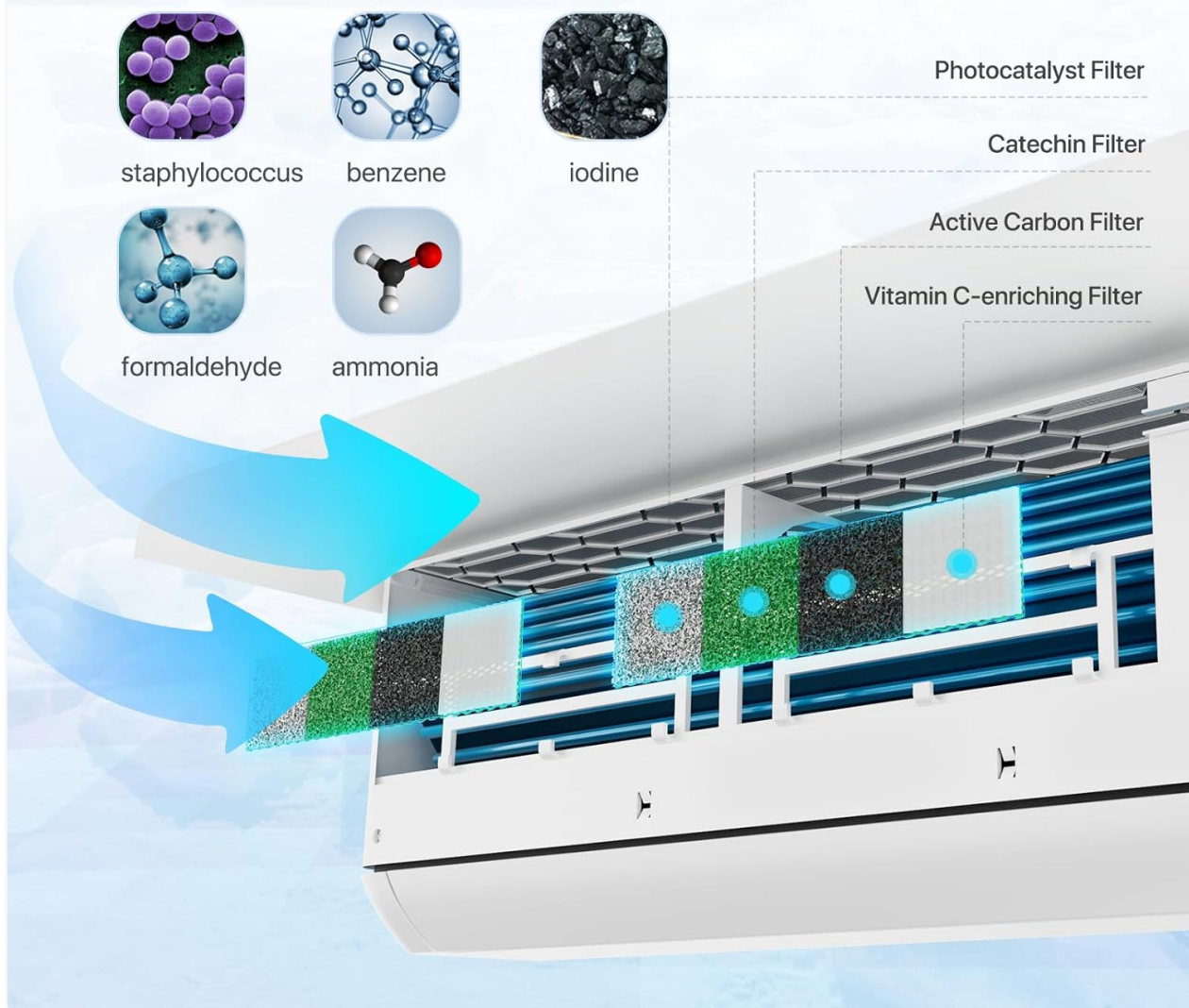
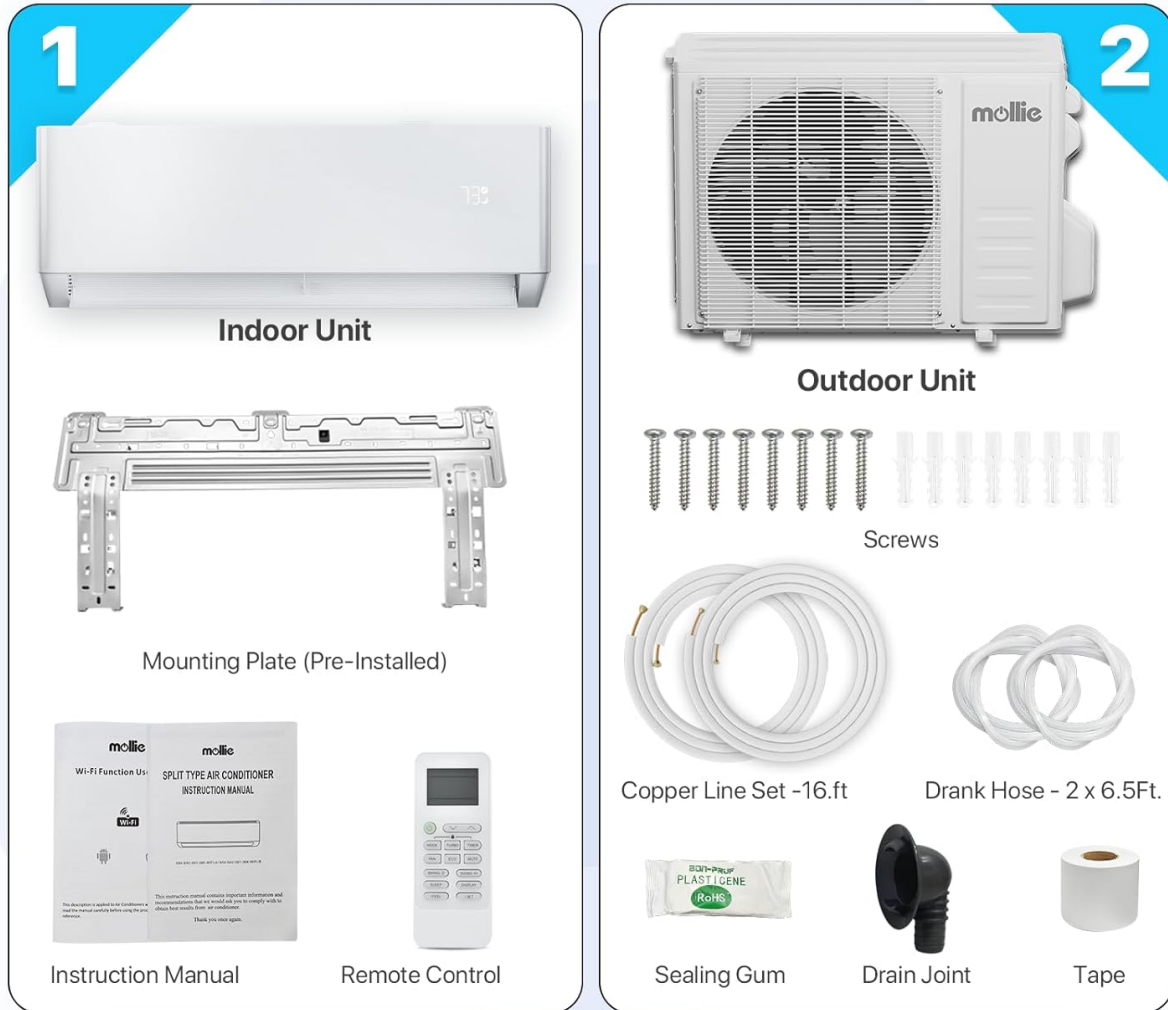

Figure 6.1: The 4-in-1 filter system for enhanced air quality.

PACKAGE LIST

COMES IN 2 BOXES & DELIVERY TIME MAYBE DIFFERENT PER BOX



Tips: Signal wire is NOT included, please purchase separately based on length needed.

Figure 6.2: MERV grade air filter screen captures fine particles.

6.2 General Cleaning

Wipe the exterior of the unit with a soft, damp cloth. Do not use harsh chemicals or abrasive cleaners.

7. TROUBLESHOOTING

If you experience issues with your mollie mini-split air conditioner, refer to the following basic troubleshooting steps:

- **Unit Not Turning On:** Check if the unit is properly plugged into a working electrical outlet. Ensure the circuit breaker has not tripped.
- **Insufficient Cooling/Heating:** Verify that the desired temperature setting is appropriate. Check if the air filters are clean and not obstructed. Ensure no objects are blocking the airflow of either the indoor or outdoor unit.
- **Unusual Noises:** Minor noises during operation are normal. If you hear loud or unusual noises, contact a qualified technician.
- **Smart App Connectivity Issues:** Ensure your Wi-Fi network is active and the unit is within range. Follow the app's instructions for re-establishing connection.

For complex issues or repairs, always contact a professional HVAC technician.

8. SPECIFICATIONS

Feature	Specification
Product Dimensions	12 x 32 x 7.5 inches (Indoor Unit)
Item Weight	61.5 pounds
Model Number	TSC-09HA1/I3TI22
Form Factor	Mini-Split
Capacity	0.75 Tons (9000 British Thermal Units)
Floor Area Coverage	Up to 400 Square Feet
Voltage	115 Volts (AC)
Noise Level	27 Decibels
Seasonal Energy Efficiency Ratio (SEER)	22.00
Color	White
Refrigerant	R-410A (Pre-charged)
Special Features	Dehumidifier, Washable Filter, WiFi Enabled
Included Components	4-in-1 Filter, Installation Kit
Batteries Required	Yes (for remote control)

PRODUCT DIMENSIONS

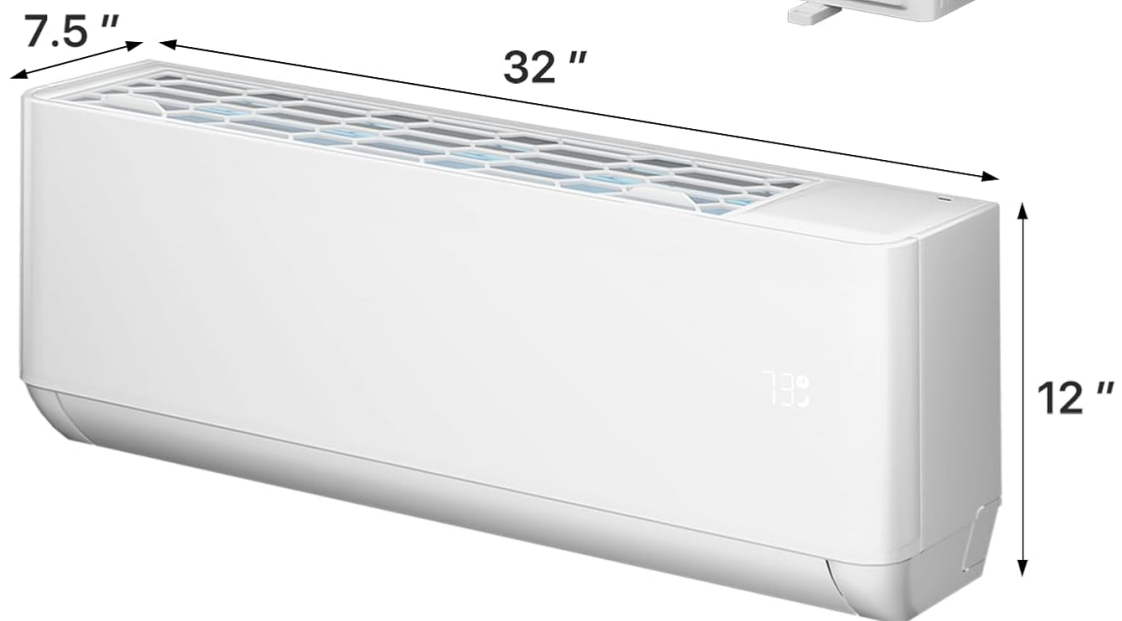
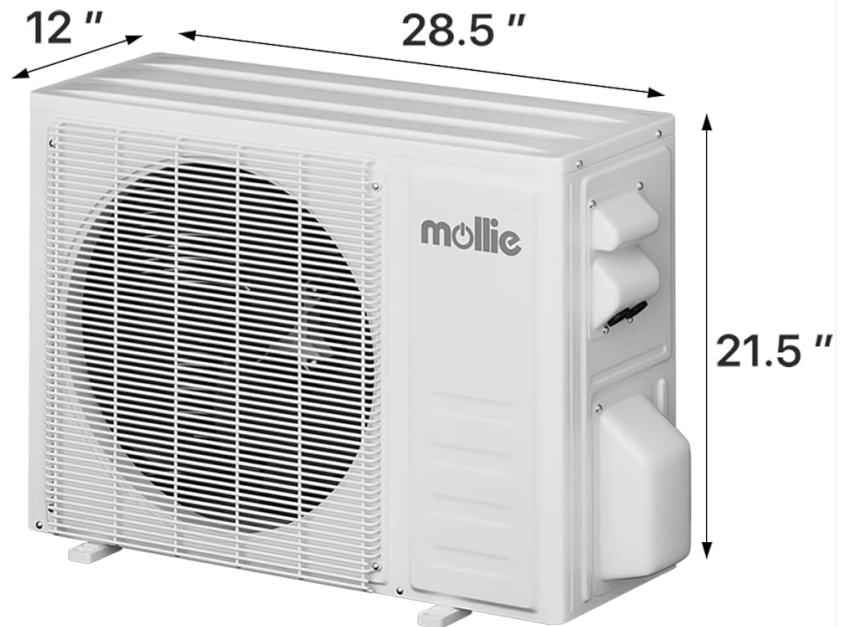

Figure 8.1: Product dimensions for the mollie mini split AC unit.

9000BTU AIR-CONDITIONER

EMBRACE COMFORT,
EVEN IN VASTNESS!



How to Choose Area

(square feet)

Capacity

Up to 400 sq.ft.

9000BTU

Up to 550 sq.ft.

12000BTU

Up to 1000 sq.ft.

18000BTU

Up to 1500 sq.ft.

24000BTU

Up to 2500 sq.ft.

36000BTU



Figure 8.2: Guide for choosing appropriate BTU capacity based on room size.



360° PRECISION AIR FLOW CONTROL

ADJUST THE AIR FLOW DIRECTION PRECISELY FOR UNIFORMLY
DISTRIBUTED THE COOL/HEAT AIR IN THE ROOM

Figure 8.3: Energy efficiency ratings for the mollie mini split AC unit.

9. WARRANTY AND SUPPORT

For warranty information regarding your mollie 9000 BTU Mini Split Air Conditioner, please contact the seller directly. Keep your purchase receipt as proof of purchase.

For any questions, comments, or support needs, please refer to the contact information provided by the seller at the time of purchase.