

CHUNMU G6

Instant Language Translator Device User Manual

Brand: CHUNMU | Model: G6

1. INTRODUCTION

The CHUNMU G6 Instant Language Translator Device is designed to facilitate real-time communication across language barriers. Utilizing advanced speech recognition and neural network translation technology, this compact device supports two-way translation in 137 languages and accents. It also features photo translation capabilities for 74 languages, making it an ideal tool for travel, business, and learning.





Figure 1: Front view of the CHUNMU G6 Instant Language Translator Device.

2. SETUP

2.1 Charging the Device

Before first use, fully charge the translator device.

- Connect the included USB Type-C charging cable to the device's charging port (refer to Figure 2 for port location).
- Connect the other end of the cable to a standard USB power adapter (not included) or a computer's USB port.
- A full charge typically takes approximately **2 hours**.
- The device is equipped with a 600mAh battery, providing about **6 hours of continuous use** and up

to 30 days of standby time.



Super Endurance

Goodbye to Insufficient battery life, greater capacity, less worry

2 hours

Charging Time

About 6 hours

Continuous Using Time

30 days

Standby Time



Figure 2: Battery endurance and charging information.

2.2 App Installation and Connection

The translator device requires connection to a mobile application for full functionality.

1. **Download the "One Click" App:** Scan the QR code provided in the device's packaging or search for "One Click" in your mobile phone's app store (compatible with iOS and Android devices).
2. **Enable Bluetooth:** Ensure Bluetooth is enabled on your mobile phone.
3. **Pair the Device:**
 - Turn on the CHUNMU G6 translator device by pressing and holding the Power button.
 - Open the "One Click" app on your phone.
 - Follow the in-app instructions to connect the translator device via Bluetooth. A successful connection will be indicated by a chime and a specific light on the device.

APP settings correspond to the language of A&B

Bidirectional translation

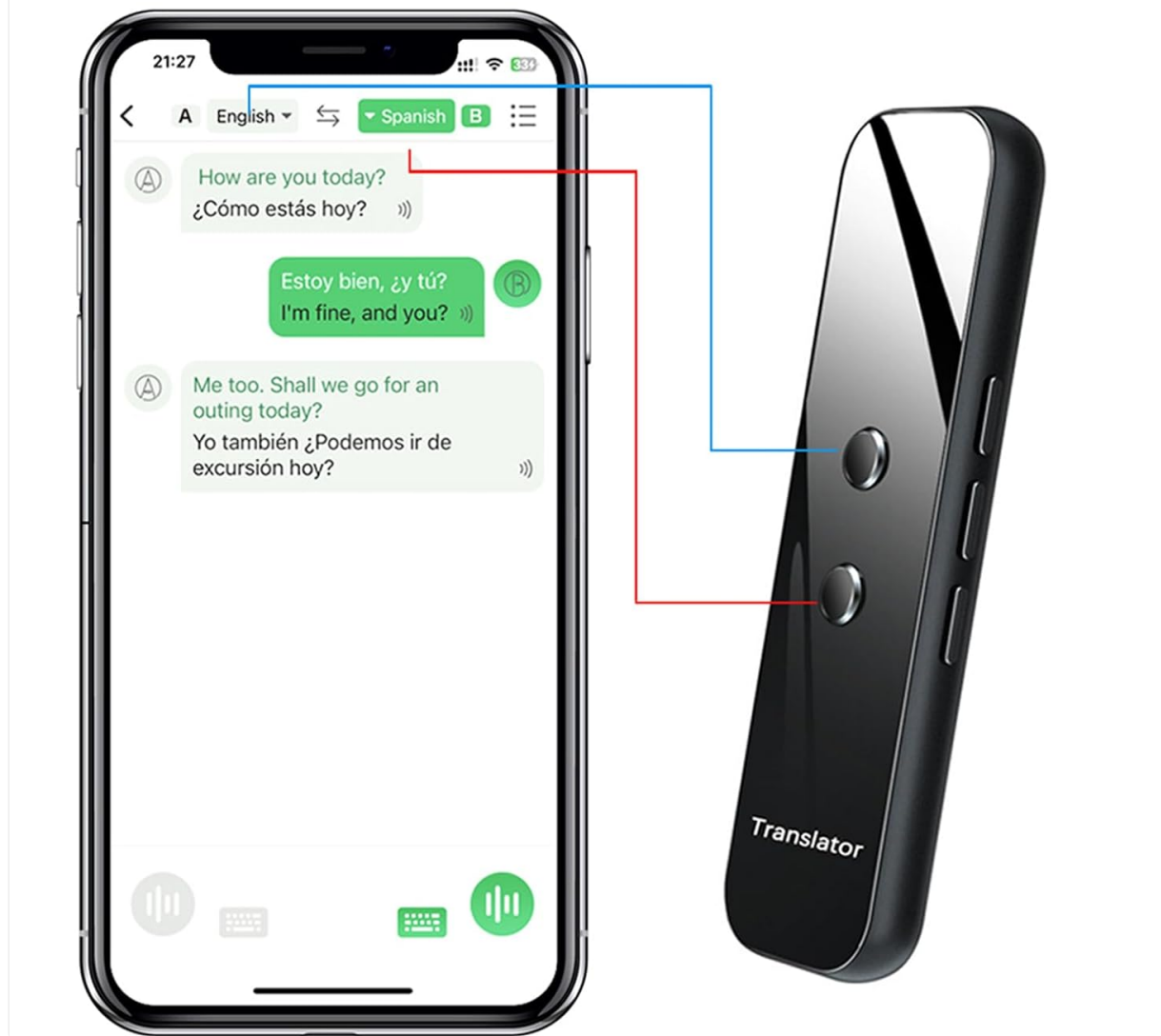

Figure 3: App interface demonstrating bidirectional translation setup.

3. OPERATING INSTRUCTIONS

3.1 Device Overview and Buttons

Familiarize yourself with the device's buttons and indicators for optimal use.

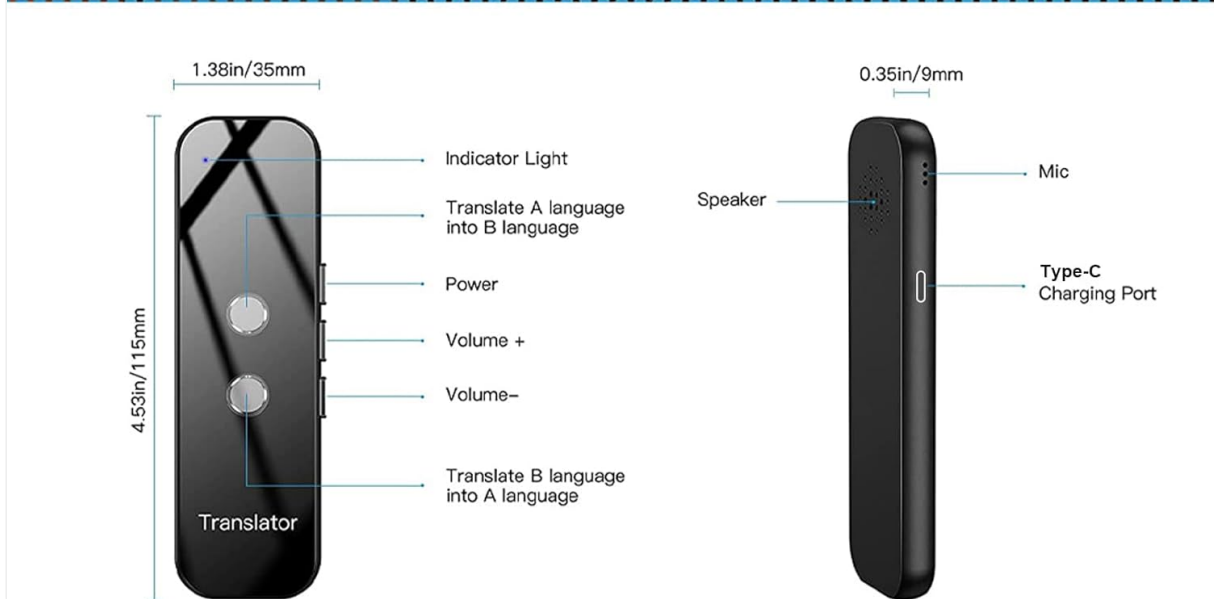

Figure 4: Device layout and button functions.

- **Indicator Light:** Shows device status (e.g., charging, connected).
- **Power Button:** Press and hold to turn on/off.
- **Volume + / Volume -:** Adjust the speaker volume.
- **Translate A language into B language button:** Press and hold this button to speak in Language A (set in app) for translation into Language B.
- **Translate B language into A language button:** Press and hold this button to speak in Language B (set in app) for translation into Language A.
- **Type-C Charging Port:** For charging the device.
- **Speaker:** Outputs translated audio.
- **Mic:** Captures your voice for translation.

3.2 Real-time Two-Way Voice Translation

The device supports 137 languages and accents for instant two-way voice translation.

1. **Select Languages:** In the "One Click" app, select the two languages you wish to translate between (e.g., Language A: English, Language B: Spanish).
2. **Initiate Translation:**
 - To translate from Language A to Language B, press and hold the "Translate A language into B

language" button on the device. Speak clearly into the microphone. Release the button when you finish speaking. The translated audio will play from the device's speaker, and text will appear in the app.

- To translate from Language B to Language A, press and hold the "Translate B language into A language" button. Speak clearly into the microphone. Release the button when you finish speaking. The translated audio will play from the device's speaker, and text will appear in the app.

3. **Optimal Usage:** Speak clearly and at a moderate pace. Keep phrases concise for best accuracy.

137 LANGUAGES & ACCENTS

Mandarin	Italian
Cantonese	Hebrew
English (UK)	Portuguese
English (United States)	Spanish
Japanese	Mongolian language
French	Malay language
Korean	Burmese language
German	Lao language
Thai	Khmer language (Cambodia)
Vietnamese language	Nepali language
Filipino language	Malayalam (India)
English (Philippines)	Marathi language (India)
Indonesian	Telugu language (india)
Tamil language (Singapore)	Bengali language (india)
	Tamil language (india)
	Bengali language
	Javanese language (indonesia)
	Sundanese language (indonesia)
	English (Australia)

.....
Partial language presentation



Figure 5: Partial list of supported languages and accents.

3.3 Photo Translation

The "One Click" app supports photo translation for 74 online languages.

1. **Access Photo Translation:** Open the "One Click" app and navigate to the photo translation feature.
2. **Capture Image:** Use your phone's camera through the app to take a photo of the text you wish to translate (e.g., menus, signs, documents).
3. **Translate:** The app will process the image using image recognition technology and provide the translation. You can often copy and edit the translated text within the app.

The APP supports photo translation

Instant shooting and translation

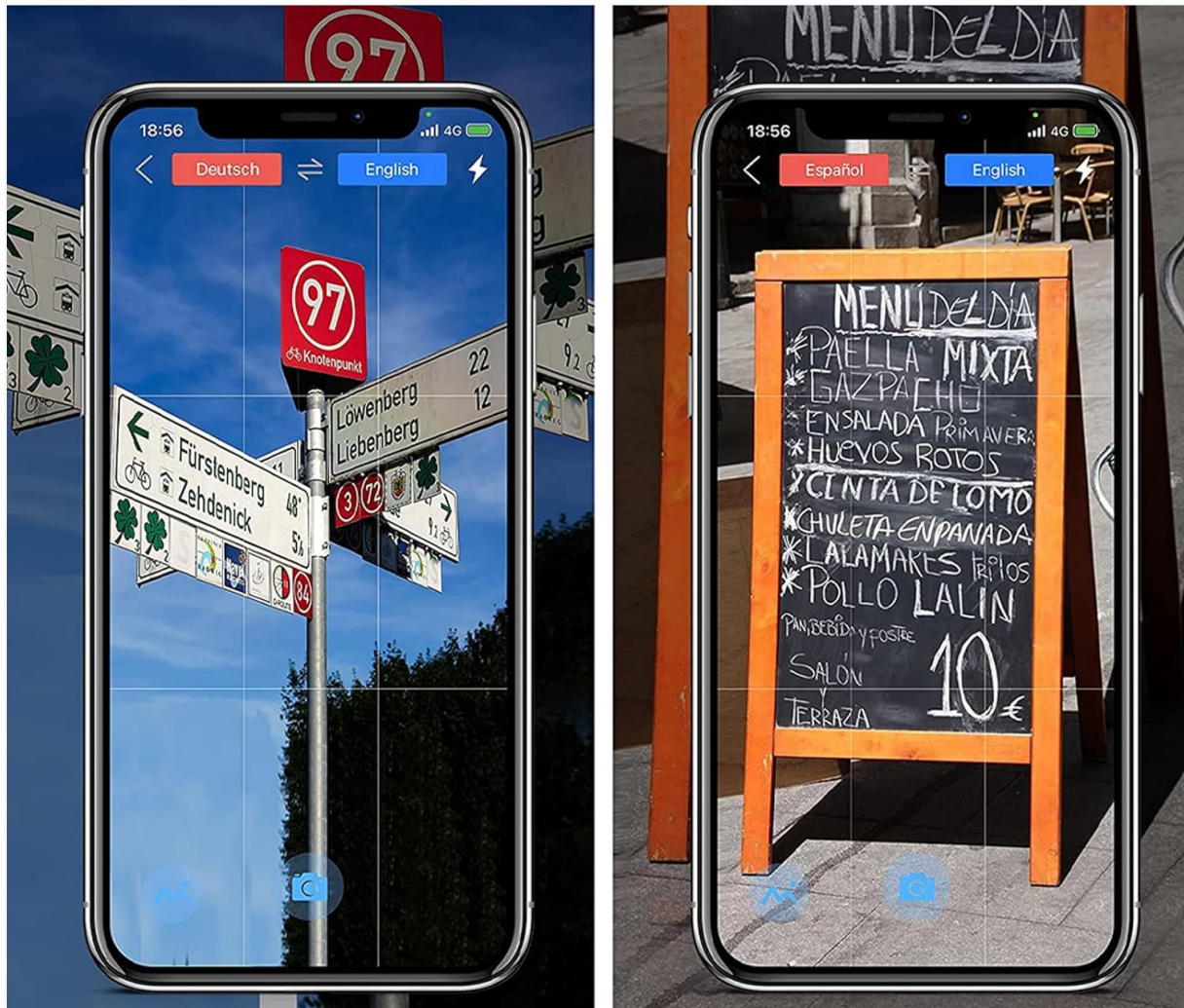

Figure 6: Photo translation feature in the "One Click" app.

4. MAINTENANCE

Proper care ensures the longevity and performance of your CHUNMU G6 translator.

- **Cleaning:** Wipe the device with a soft, dry cloth. Do not use abrasive cleaners or solvents.
- **Storage:** Store the device in a cool, dry place away from direct sunlight and extreme temperatures.
- **Water Exposure:** The device is not waterproof. Avoid exposure to water or high humidity.
- **Handling:** The device features a sturdy aluminum alloy shell, but avoid dropping or subjecting it to strong impacts.
- **Battery Care:** For optimal battery life, avoid fully discharging the battery frequently. If storing for extended periods, charge the device to about 50% every few months.

5. TROUBLESHOOTING

If you encounter issues with your translator device, refer to the following common solutions.

Common Issues and Solutions

Problem	Possible Cause / Solution
Device does not turn on.	Battery may be depleted. Charge the device for at least 30 minutes. Ensure the charging cable and adapter are working correctly.
Cannot connect to the "One Click" app via Bluetooth.	<ul style="list-style-type: none">• Ensure Bluetooth is enabled on your phone.• Restart both the translator device and your phone.• Make sure the "One Click" app is updated to the latest version.• Forget the device in your phone's Bluetooth settings and try pairing again.• Ensure the device is within Bluetooth range of your phone.
Translation is inaccurate or not working.	<ul style="list-style-type: none">• Ensure a stable internet connection (Wi-Fi or mobile data) on your phone, as the device relies on online translation services.• Speak clearly and directly into the microphone.• Keep phrases concise and avoid complex sentences.• Verify that the correct source and target languages are selected in the "One Click" app.• Check the microphone for any obstructions.
Low or no audio output from the speaker.	<ul style="list-style-type: none">• Adjust the volume using the Volume + button on the device.• Ensure the speaker is not obstructed.• Check the volume settings within the "One Click" app.
Buttons are unresponsive or require multiple presses.	<ul style="list-style-type: none">• Restart the device.• Ensure the device is fully charged.• If the issue persists, it may indicate a hardware defect. Contact customer support.

6. SPECIFICATIONS

Feature	Detail
Model	G6
Dimensions (L x W x H)	5.12 x 2.4 x 1.14 inches (approximately 130 x 61 x 29 mm)
Item Weight	4.6 ounces (approximately 130 grams)
Battery Type	1 Lithium Polymer battery (included)
Battery Capacity	600mAh

Feature	Detail
Charging Time	Approx. 2 hours
Continuous Using Time	Approx. 6 hours
Standby Time	Approx. 30 days
Supported Voice Languages	137 languages/accents (online)
Supported Photo Languages	74 languages (online, via app)
Connectivity	Bluetooth (requires smartphone app)
Manufacturer	CHUNMU Direct
First Available Date	April 19, 2024

7. WARRANTY AND SUPPORT

CHUNMU is committed to providing high-quality products. Each translator device undergoes rigorous testing to ensure reliability.

7.1 Warranty Information

Specific warranty terms and conditions may vary. Please refer to the warranty card included with your product or visit the official CHUNMU website for detailed warranty information. Keep your proof of purchase for warranty claims.

7.2 Customer Support

If you encounter any problems or have questions regarding your CHUNMU G6 Instant Language Translator Device, please do not hesitate to contact our customer support team.

- **Online Support:** Visit the official CHUNMU website for FAQs, troubleshooting guides, and contact forms.
- **Email Support:** Refer to your product packaging or the official website for the customer support email address.
- **Purchase Platform Support:** For issues related to your purchase, you may also contact the customer service of the platform where you bought the device.