

Mexhom bl-a80

Mexhom Water Vapor Fireplace Instruction Manual

Model: bl-a80 | Brand: Mexhom

1. IMPORTANT SAFETY INFORMATION

Please read this entire instruction manual before installation and use of your Mexhom Water Vapor Fireplace. Failure to follow these instructions may result in electric shock, fire, property damage, or personal injury.

- Use only purified or filtered water to prevent mineral buildup and ensure optimal performance.
- Do not block the air vents or water mist outlet.
- Ensure the fireplace is installed on a stable, level surface.
- Keep the power cord away from heated surfaces.
- This appliance is for indoor use only.
- The flame effect is created by water vapor and LED lights; it does not produce actual heat. The flames are touchable and safe for people and pets.
- Always disconnect the power before performing any maintenance or cleaning.

2. PRODUCT OVERVIEW

The Mexhom Water Vapor Fireplace creates a realistic 3D atomized flame effect using LED technology and water mist. It features both manual and automatic water control, remote control operation, and a smart chip for safety.

Package Contents:

- Water Vapor Fireplace Unit
- Remote Control
- Water Hose
- Instruction Manual (this document)

Key Components:

- **3D Atomized Flame System:** Creates realistic, touchable flame effects.
- **Dual Water Inlets:** Supports both manual and automatic water addition.

- **Control Panel:** Integrated touch controls for various settings.
- **Remote Control:** For convenient operation from a distance.
- **LED Lighting:** Energy-saving thermostatic lamps for flame effects.
- **Smart Chip:** Automatic power-off due to water shortage to prevent dry burning.

3. SPECIFICATIONS

Feature	Detail
Brand	Mexhom
Model Name	bl-a80
Product Dimensions	31.5"D x 8.27"W x 7.87"H
Item Weight	32 pounds
Power Source	AC (110V - 120V - 60Hz)
Material	Metal
Installation Type	Embedded
Special Feature	Decorative, Flame Effect, Manual Water
Ventilation Type	Vent Free
Included Components	Instruction Manual, Remote Control, Water Hose

4. SETUP & INSTALLATION

4.1 Recessed Installation

The fireplace is designed for embedded installation. Ensure your cabinet slotting dimensions are appropriate for the unit's size (L31.5 x W7.87x H8.27 in).

For optimal atomization effect, maintain a 45cm (17.72 inches) gap between the fireplace's top and the overhead cabinet. This spacing allows mist to flow naturally, preventing compression or scattering, and enhancing the realistic ambiance.

31.50 IN Water Vapor Fireplace Size



Cabinet Slotting Dimensions

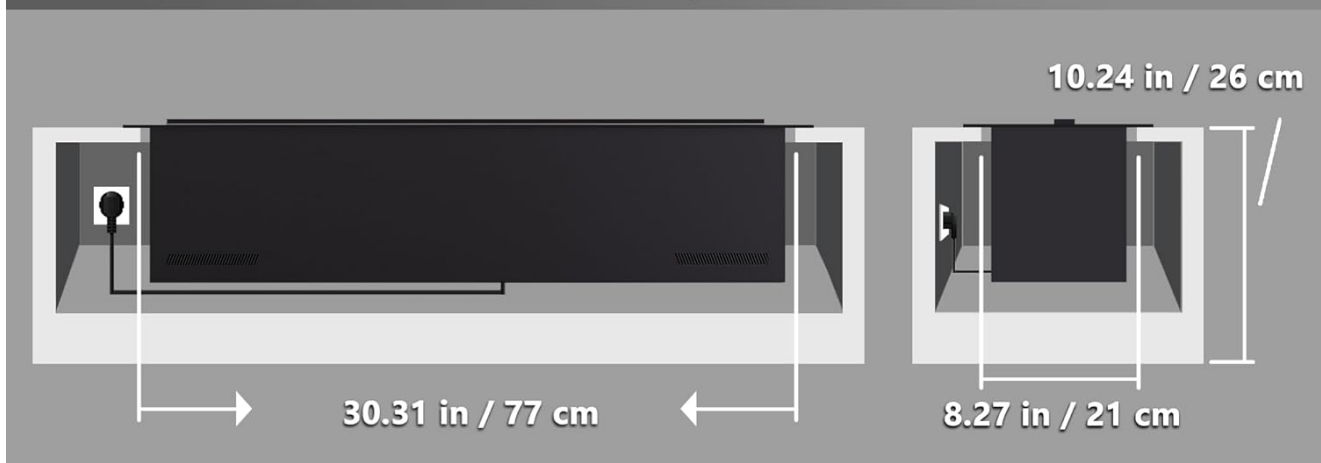

Image: Fireplace dimensions and cabinet slotting guide.

4.2 Water Connection

The fireplace supports both manual and automatic water addition. Always use purified or filtered water.

Manual Water Addition Steps:

1. Prepare a container of purified or filtered water.
2. Insert the provided water hose into the water inlet at the top of the fireplace unit.
3. Press and hold the water filling button on the screen for 3 seconds.
4. Wait for the water addition to be completed. The intelligent water control system ensures consistent misting.

Automatic Water Supply Steps:

1. Insert one end of the provided pipe into the water supply opening at the bottom of the fireplace.
2. Connect the other end of the pipe to a faucet or external water supply.
3. Open the water pipe valve.
4. Turn on the tap. The system will automatically fill the reservoir.

DUAL WATER INLETS

Entire Unit 304 Stainless Steel

Manual/Electric Mode with One-Touch Switching



One-click switch button

- Behind the machine -

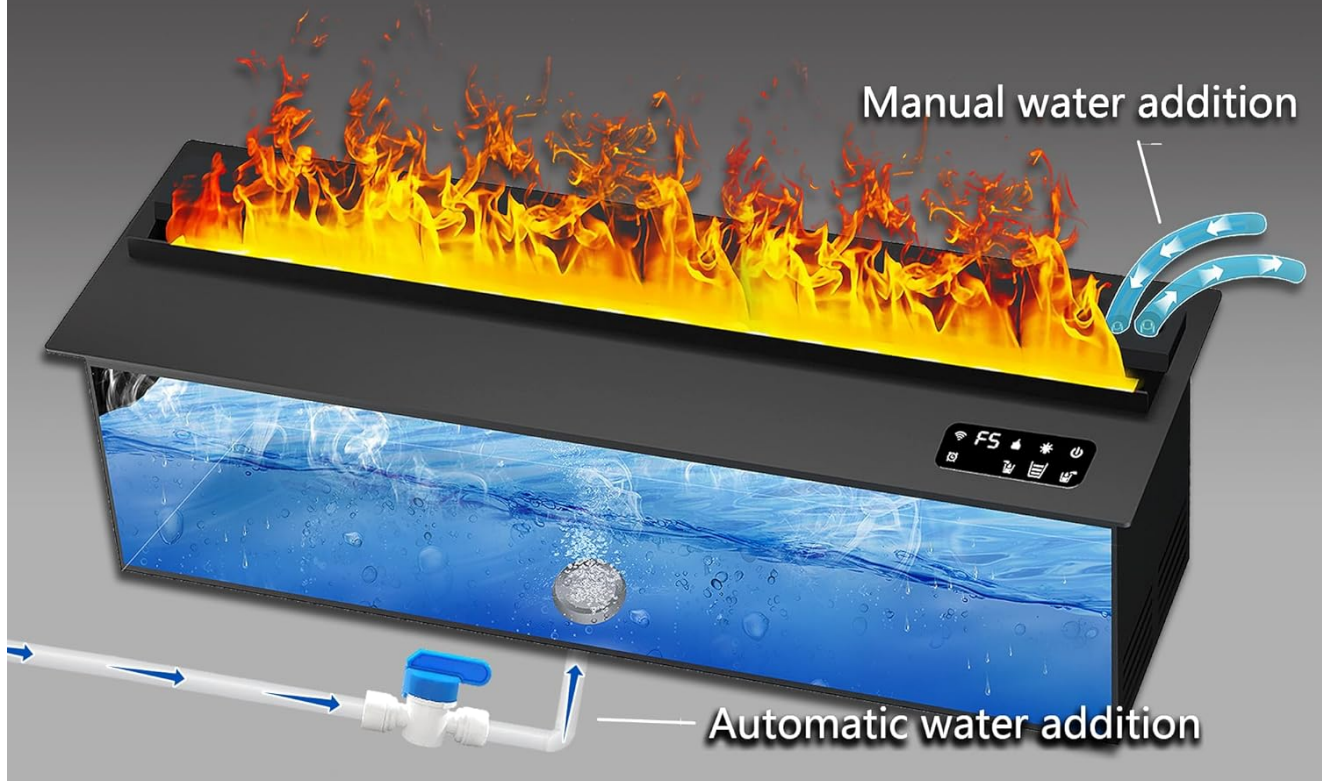
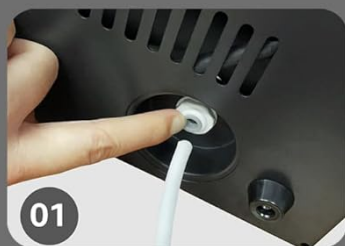

Image: Dual water inlets for flexible water supply options.

Automatic Water Supply Steps



01



02

01: Insert the pipe into the water supply opening at the bottom of the fireplace.

02: The other end is connected to the faucet.



03



04

03: Open the water pipe valve.

04: Turn on the tap.

Manual Water Addition Steps

01: Prepare the water.

02: Insert the pipe into the water inlet at the top of the machine

03: Press and hold the water filling button on the screen for 3 seconds.

04: Wait for the water addition to be completed.



01



02

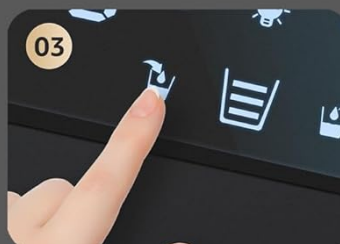

03

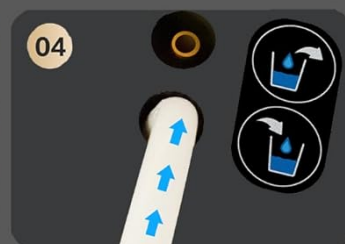

04

Image: Detailed steps for connecting water supply.

Your browser does not support the video tag.

Video: Demonstrates dual water supply and RGB flame effects.

Your browser does not support the video tag.

Video: Shows the dual water supply and flame effects of the Mexhom Water Vapor Fireplace.

5. OPERATION

5.1 Power On/Off

Connect the 5ft power cord to a standard US 110V-120V, 60Hz outlet. Use the power button on the control panel or remote control to turn the unit on or off.

5.2 Flame Effects & Brightness

The fireplace features 3D atomized flame effects with adjustable brightness and speed. You can select from 5 levels of flame brightness and 9 different flame colors to create your desired ambiance.



Image: Remote control functions for flame settings.

Safe and environmentally friendly Touchable flame



- No Heating Function -

↑ *Top Reserved Height Suggested: 45cm/17.72 in
"To maintain mist -flame dynamics and space aesthetics"*

Image: Demonstrates the touchable, non-heating flame effect.

Your browser does not support the video tag.

Video: Showcases the multicolor atomized flame effects.

Your browser does not support the video tag.

Video: Demonstrates flame color changes and remote control operation.

Your browser does not support the video tag.

Video: Illustrates various flame color options for the water vapor fireplace.

Your browser does not support the video tag.

Video: Provides a general overview of the 3D water vapor fireplace in operation.

5.3 Control Panel & Remote Control

The fireplace can be operated using the integrated screen control panel or the included remote control. The screen displays settings for Wi-Fi, Atomization Gear, Fire Level, Dimmable, Power, Timer, Water Input, Volume State, and Water Output.



Screen Control

Using new LED

Energy saving thermostatic lamp

LED beads

Smart Chip

Automatic power-off due to water shortage to prevent dry burning and damage to the machine

Image: Screen control panel details and LED technology.

5.4 Timer Function

Set a timer for automatic shut-off, ranging from 1 to 9 hours, using the remote control or control panel. This feature is convenient for ensuring the fireplace turns off after a desired period.

6. MAINTENANCE

6.1 Water Quality

To maintain the longevity and performance of your fireplace, always use purified or filtered water. This prevents mineral buildup in the misting system, which can affect the flame effect and potentially damage the unit.

6.2 Cleaning

Regularly inspect the water reservoir and misting components for any residue. Clean as needed with a soft cloth and mild detergent. Ensure the unit is completely dry before refilling with water and operating.

6.3 Draining Water

If you need to drain the water from the unit, connect the hose to the 'OUT' port and activate the drain function via the control panel or remote control. This will automatically remove water from the reservoir.

7. TROUBLESHOOTING

- **No Flame Effect:** Check if the water reservoir is full. The smart chip will prevent operation if water levels are too low. Ensure the power is connected and the unit is turned on.
- **Remote Control Not Responding:** Check the remote control batteries. Ensure there are no obstructions between the remote and the fireplace sensor.
- **Inconsistent Misting:** Ensure only purified or filtered water is used. Mineral buildup can affect mist production. Clean the misting components if necessary.
- **Water Sensor Issues:** If the water sensor is not functioning correctly, ensure the water pipe is properly inserted and there are no blockages.

8. WARRANTY & SUPPORT

8.1 Warranty Information

This Mexhom Water Vapor Fireplace comes with a Limited Warranty. Please refer to the warranty card included in your package for specific terms and conditions, including coverage duration and claim procedures.

8.2 Customer Support

For any questions, technical assistance, or warranty claims, please contact Mexhom customer support. Contact details can typically be found on the product packaging or the official Mexhom website.