



[Manuals.plus](#) /

› [NBBUFF](#) /

› NBBUFF 50ft RGB LED Strip Lights Instruction Manual

NBBUFF NB-rgb001-1

NBBUFF 50ft RGB LED Strip Lights Instruction Manual

Model: NB-rgb001-1

PRODUCT OVERVIEW

The NBBUFF 50ft RGB LED Strip Lights offer versatile lighting solutions with color-changing capabilities, music synchronization, and multiple control options. This manual provides essential information for setup, operation, and maintenance to ensure optimal performance and user satisfaction.



Image: Overview of the NBBUFF 50ft RGB LED Strip Lights, showing the LED strip, remote control, power adapter, and controller, alongside a smartphone illustrating app control.

WHAT'S IN THE BOX

- 1x LED Strip Lights (50ft)
- 1x Controller
- 1x Remote Control
- 1x Power Adapter
- 1x Instruction Manual

SETUP INSTRUCTIONS

1. **Prepare the Surface:** Ensure the installation surface is clean, dry, and smooth. Dust or uneven textures can affect adhesive performance.
2. **Plan the Layout:** Before peeling the adhesive, unroll the LED strip and plan its placement. Avoid sharp bends or

excessive pulling on the strip.

3. **Attach the LED Strip:** Carefully peel the adhesive backing from the LED strip and press it firmly onto the desired surface. For enhanced adhesion, especially around corners or obstacles, use additional double-sided tape (as shown in the diagram below).

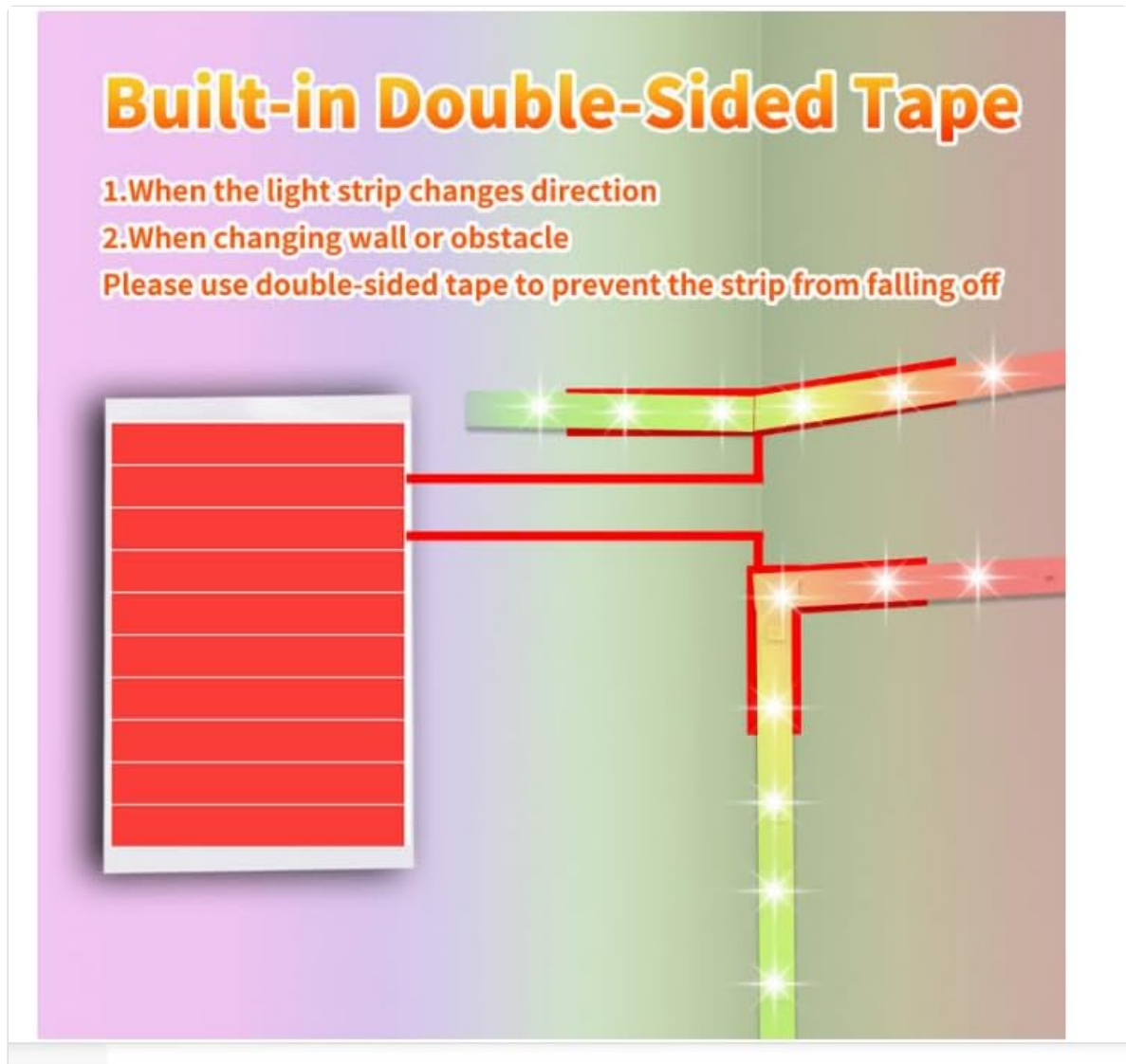

Image: Illustration demonstrating the application of double-sided tape for secure installation of LED strips around corners and obstacles.

4. **Connect the Controller:** Plug the LED strip into the controller. Ensure the arrows on both connectors align.
5. **Connect the Power Adapter:** Plug the power adapter into the controller, then plug the power adapter into a standard AC outlet.
6. **Initial Test:** Before final placement, test the lights to ensure they function correctly.

Easy to Use

How to connect



Image: Visual guide for connecting the LED strip to its controller and power adapter. Also shows the remote control, highlighting the protective plastic chip that needs removal before first use.

OPERATING INSTRUCTIONS

Your NBBUFF LED Strip Lights can be controlled via the included remote control or a smartphone application.

Using the Remote Control

Ensure the plastic protective chip is removed from the remote control before use. Point the remote directly at the controller for optimal response.

- **Power On/Off:** Press the **ON/OFF** button.
- **Color Selection:** Choose from a variety of preset colors using the color buttons.
- **Brightness Adjustment:** Use the **Brightness Up/Down** buttons to adjust light intensity (20%, 40%, 60%, 80%, 100%).
- **Mode Selection:** Select dynamic modes like Flash, Jump, or Fade using the dedicated buttons.
- **Music Sync:** Activate music synchronization mode to have the lights react to sound.

Using the Smartphone App

Download the compatible app (refer to the QR code on the controller or packaging for the correct app). Follow the in-app instructions to pair your device with the LED strip lights.

- **Color Customization:** Access a wider range of colors and create custom color schemes.
- **Brightness Control:** Adjust brightness from 1% to 100% for precise lighting.

- **Dynamic Modes:** Explore additional dynamic lighting effects and customize their speed.
- **Music Sync:** Utilize the app's music sync feature for lights to respond to music played through your phone.
- **Timing Function:** Set schedules for the lights to automatically turn on or off at specific times.

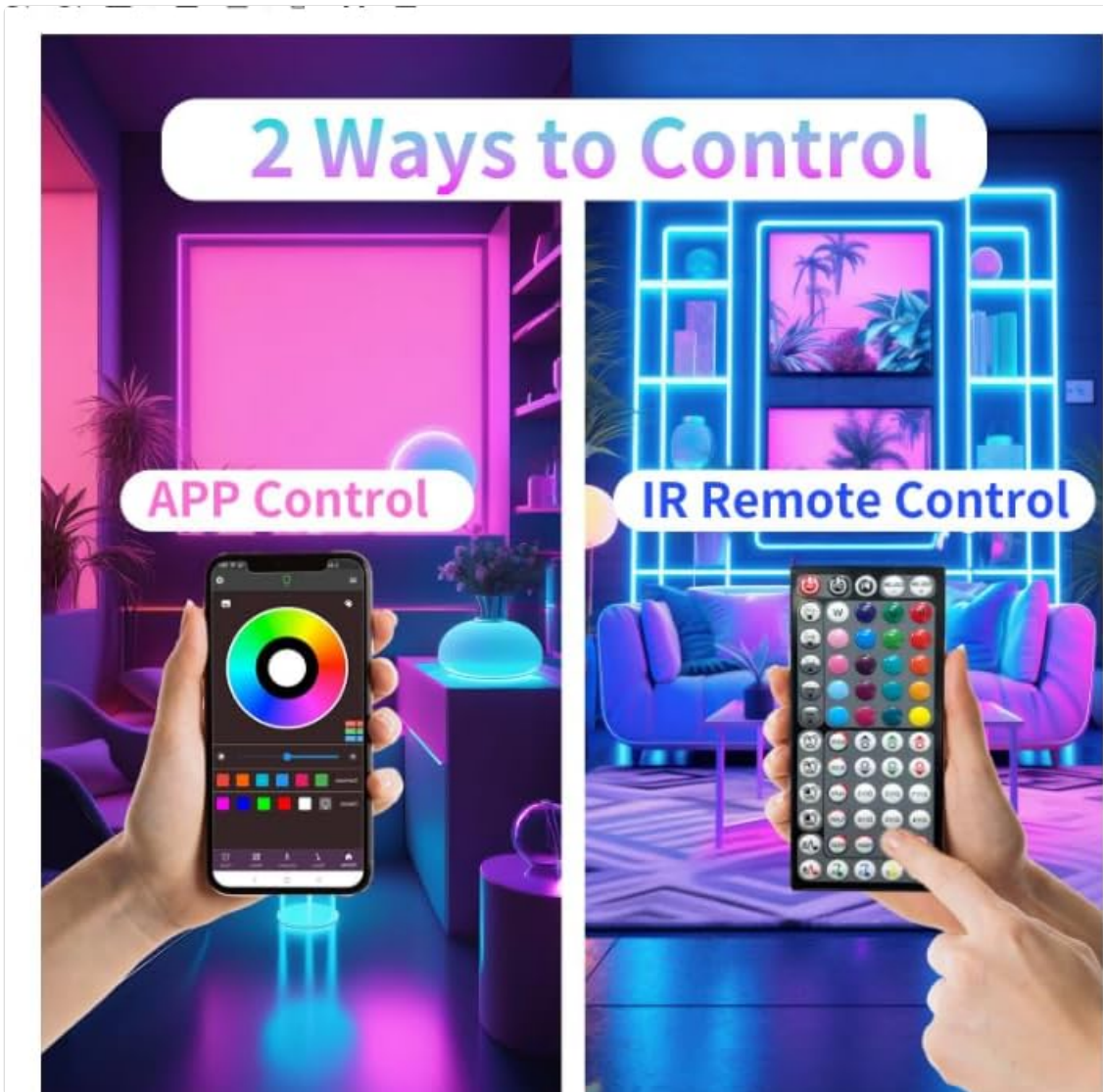

Image: Comparison of control methods, showing both smartphone app control and infrared remote control for the LED strip lights.

Music mode

The lights dance with the music



Image: Example of the music mode in action, where the LED lights synchronize with music, creating a dynamic atmosphere.

MAINTENANCE

- **Cleaning:** Gently wipe the LED strip with a dry, soft cloth to remove dust. Do not use liquid cleaners or abrasive materials.
- **Storage:** If storing the lights, ensure they are clean and dry. Roll them loosely to prevent damage to the strip or adhesive.
- **Adhesive Longevity:** The adhesive is designed for long-term use on clean, smooth surfaces. If re-installation is required, new double-sided tape may be necessary.

TROUBLESHOOTING

Problem	Possible Cause	Solution
---------	----------------	----------

Problem	Possible Cause	Solution
Lights do not turn on.	Power adapter not connected. Remote control battery low or plastic chip not removed. Controller or strip connection loose.	Ensure all connections are secure and the power adapter is plugged into a working outlet. Remove the plastic chip from the remote's battery compartment. Replace battery if needed. Check the connection between the LED strip and the controller, ensuring arrows align.
Remote control not responding.	Obstruction between remote and controller. Remote battery low.	Ensure a clear line of sight between the remote and the IR receiver on the controller. Replace the remote control battery.
App control not working.	Bluetooth/Wi-Fi not enabled on device. App not paired with lights.	Enable Bluetooth and/or Wi-Fi on your smartphone. Follow the app's instructions to re-pair with the LED strip lights.
Lights are not sticking to the surface.	Surface is not clean or smooth. Adhesive has lost its stickiness.	Clean the surface thoroughly before application. Use additional strong double-sided tape for better adhesion.

SPECIFICATIONS

- **Brand:** NBBUFF
- **Model:** NB-rgb001-1
- **Indoor/Outdoor Usage:** Indoor
- **Light Source Type:** LED
- **Power Source:** AC
- **Light Color:** RGB (Color Changing)
- **Theme:** Music Sync
- **Material:** Copper
- **Controller Type:** App Control, Remote Control
- **Number of Light Sources:** 240
- **Voltage:** 24 Volts
- **Item Length:** 50 Feet
- **Item Weight:** 5.9 ounces (0.17 Kilograms)

WARRANTY AND SUPPORT

For any questions or issues regarding your NBBUFF LED Strip Lights, please contact customer support. Information on warranty coverage is typically provided with your purchase documentation or can be found on the manufacturer's official website.

If you have any questions after receiving the product, please contact our customer email service. We will reply to you within 24 hours.

