



Manuals.plus /

› OMMO /

› OMMO Blender 1800W Professional High-Speed Countertop Blender User Manual

OMMO OMMO Blender 1800W

OMMO Blender 1800W Professional High-Speed Countertop Blender

USER MANUAL

Model: OMMO Blender 1800W | Brand: OMMO

1. Introduction

Thank you for choosing the OMMO 1800W Professional High-Speed Countertop Blender. This appliance is designed for efficient blending, crushing, and processing of various ingredients, from smoothies and shakes to ice and fruits. Please read this manual thoroughly before first use to ensure safe operation and optimal performance.

This blender features a powerful 1800W motor, hardened stainless steel blades, a 60oz BPA-free jar, and variable speed control with a pulse function. Its user-friendly design includes an ergonomic lid and dishwasher-safe components for easy cleaning.

2. Important Safety Instructions

When using electrical appliances, basic safety precautions should always be followed to reduce the risk of fire, electric shock, and/or injury to persons, including the following:

- Read all instructions before operating the blender.
- Do not immerse the motor base in water or other liquids.
- Always ensure the lid is securely in place before operating the blender.
- Avoid contact with moving parts. Blades are sharp. Handle with care.
- Unplug from outlet when not in use, before assembling or disassembling parts, and before cleaning.
- Do not operate any appliance with a damaged cord or plug, or after the appliance malfunctions or has been dropped or damaged in any manner.
- Close supervision is necessary when any appliance is used by or near children.

- Do not use outdoors.

3. Product Components

The OMMO Blender consists of the following main components:

- **Motor Base:** Houses the powerful 1800W motor and control panel.
- **60oz BPA-Free Jar:** Durable, drop-resistant, and scratch-resistant container for blending.
- **Lid with Removable Cap:** Designed for easy opening and secure sealing during operation.
- **Stainless Steel Blades:** Six hardened, aircraft-grade stainless steel blades for efficient crushing and blending.
- **Tamper:** Used to push ingredients towards the blades for smoother blending (not shown in all images, but typically included).



Image: Overview of the OMMO Blender highlighting its hardened stainless-steel blades, high-speed vortex blending capability, and durable metal drive system.

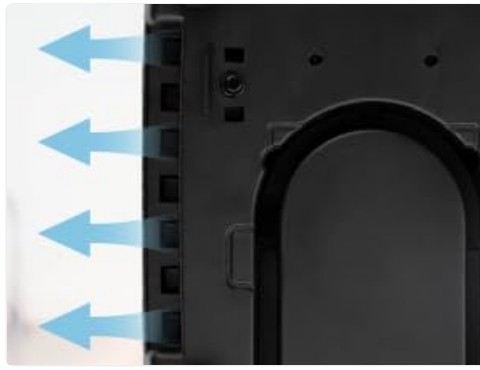

Image: The robust metal drive system ensures durability and consistent performance.



Image: The 60oz BPA-free jar is designed for durability and safety, featuring thickened, drop-resistant, and scratch-resistant construction.



Image: The ergonomic lid design allows for easy opening and secure closure.

4. Setup

Before first use, wash all parts that will come into contact with food (jar, lid, blades) in warm, soapy water. Rinse thoroughly and dry.

1. Place the motor base on a clean, dry, and level surface.
2. Ensure the speed control knob is in the 'OFF' position.
3. Place the blender jar onto the motor base, aligning the jar's base with the drive socket on the motor base. The jar should sit securely.
4. Add your ingredients to the jar. Do not exceed the maximum fill line.
5. Secure the lid onto the jar. Ensure the lid is properly seated and locked to activate the safety mechanism.



Image: The blender features a safety lock mechanism that prevents operation unless the jar is correctly seated.

5. Operating Instructions

The OMMO Blender offers precise control over your blending tasks.

Variable Speed Control

Use the speed control knob to adjust the blending speed from minimum to maximum. Start with a lower speed for tougher ingredients and gradually increase as needed. This allows you to achieve a variety of textures, from chunky salsas to silky smooth purees.

Pulse Function

The pulse function provides short bursts of high-speed blending. This is ideal for chopping ingredients, breaking down large pieces, or achieving a coarse texture. Use it for quick processing or when you need more control over the consistency.

BPA-Free

Delicious but Healthy



- 60 OZ 0.93pounds



- Thickened Cup
- Drop-Resistant Scratch-Resistant



Image: The control panel features a pulse button and a variable speed knob for precise blending.

Blending Tips

- Always add liquids first, followed by soft ingredients, then hard ingredients, and finally ice or frozen items.
- Do not overfill the jar. Ensure the lid is securely closed before starting.
- For thick mixtures, use the tamper through the lid opening to push ingredients towards the blades. Never use utensils.
- If the blender stalls, turn it off, remove some ingredients, and restart.

6 Stainless blades Easily crush ice into smoothies



Image: The blender is capable of various tasks including chopping, grinding, blending, emulsifying, and preparing batters.



Image: Use the tamper to assist with blending thicker mixtures.

Video: Watch the OMMO blender in action, demonstrating its ability to create delicious smoothies. This video is provided by OMMO-US.

6. Cleaning and Maintenance

Proper cleaning and maintenance will extend the life of your OMMO Blender.

Self-Cleaning Function

For quick and easy cleaning, add warm water and a drop of dish soap to the blender jar. Secure the lid and run the blender on a medium speed for 30-60 seconds. Rinse thoroughly.

Dishwasher Safe Parts

The blender jar and lid are dishwasher safe. Place them on the top rack of your dishwasher. The motor base should never be immersed in water.

Motor Base Cleaning

Wipe the motor base with a damp cloth. Do not use abrasive cleaners or scouring pads. Ensure the base is completely dry before storing or next use.



Image: The blender jar is dishwasher safe, and a self-cleaning function simplifies daily maintenance.



Image: Proper ventilation helps maintain motor performance and longevity.

7. Troubleshooting

If you encounter issues with your OMMO Blender, refer to the following common problems and solutions:

Problem	Possible Cause	Solution
Blender does not start.	Not plugged in; Jar not properly seated; Speed knob not in 'OFF' position.	Ensure power cord is plugged in; Securely place jar on base; Turn speed knob to 'OFF' before starting.
Ingredients not blending smoothly.	Too little liquid; Overfilled jar; Ingredients too large.	Add more liquid; Reduce ingredient quantity; Cut ingredients into smaller pieces; Use tamper.
Motor smells or overheats.	Overloading; Prolonged use.	Reduce load; Allow blender to cool down for 15-20 minutes before resuming use.

If the problem persists, please contact customer support.

8. Specifications

Detailed technical specifications for your OMMO Blender 1800W:

Feature	Specification
Brand	OMMO
Model	OMMO Blender 1800W
Power Source	Corded Electric
Wattage	1800 watts
Voltage	110 Volts
Capacity	60oz (3.8 Pounds)
Product Dimensions (D x W x H)	7.5"D x 6.7"W x 17.3"H
Item Weight	7 Pounds
Blade Material	Stainless Steel
Jar Material	BPA Free Plastic
Controls Type	Knob
Special Features	Dishwasher Safe, Safety Lock



Image: Key dimensions of the OMMO Blender for placement and storage.

9. Warranty and Support

Your OMMO Blender 1800W comes with a **Limited Warranty**. Please refer to the product packaging or contact OMMO customer service for specific warranty terms and conditions.

For technical support, troubleshooting assistance, or warranty claims, please contact OMMO customer support through the retailer where the product was purchased or visit the official OMMO website for contact information.