



Manuals.plus /

› AUTOUTLET /

› AUTOUTLET Wii to HDMI Converter 1080P Instruction Manual

AUTOUTLET EFU113USE

AUTOUTLET Wii to HDMI Converter 1080P Instruction Manual

Model: EFU113USE

1. INTRODUCTION

The AUTOUTLET Wii to HDMI Converter is designed to connect your Nintendo Wii console to modern televisions and monitors via an HDMI cable. This adapter converts the analog video and audio signals from the Wii into a digital HDMI format, allowing you to enjoy your Wii games with improved picture and sound quality on Full HD devices. It supports all Wii display modes, including NTSC 480i, 480p, and PAL 576i.

The converter features advanced signal processing for accurate image reproduction, vibrant colors, and clear audio, minimizing jagged lines and delays. It includes a 6ft high-speed HDMI cable and a 3.5mm audio jack for versatile audio output options. A blue indicator light confirms proper operation.

2. PACKAGE CONTENTS

Please verify that all items listed below are included in your package:

- 1 x AUTOUTLET Wii to HDMI Converter
- 1 x 6ft (1.8m) High-Speed HDMI Cable



Image 2.1: The package includes the Wii to HDMI converter and a 1.8m HDMI cable.

3. PRODUCT FEATURES AND OVERVIEW

The AUTOUTLET Wii to HDMI Converter integrates a new decoding chip for stable signal transmission and enhanced video processing. This ensures a clear and vibrant display on your HDMI-compatible screen.

NEW DECODING CHIP

Provides stable signal transmission

HD Conversion Chipset

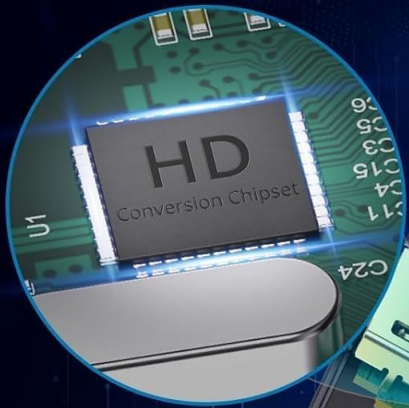

Voltage Regulator Chipset

Protection Circuit Chipset



Image 3.1: Internal components of the converter, highlighting the HD Conversion Chipset for stable signal transmission.

The converter is designed for convenient connection, featuring a short cable to plug into the Wii's AV Multi Out port, an HDMI output port, and a 3.5mm audio output jack.

CONVENIENT CONNECTION

Equipped with 1.8m HDMI cable, 20cm extension cord for wii interface and 3.5mm audio output port

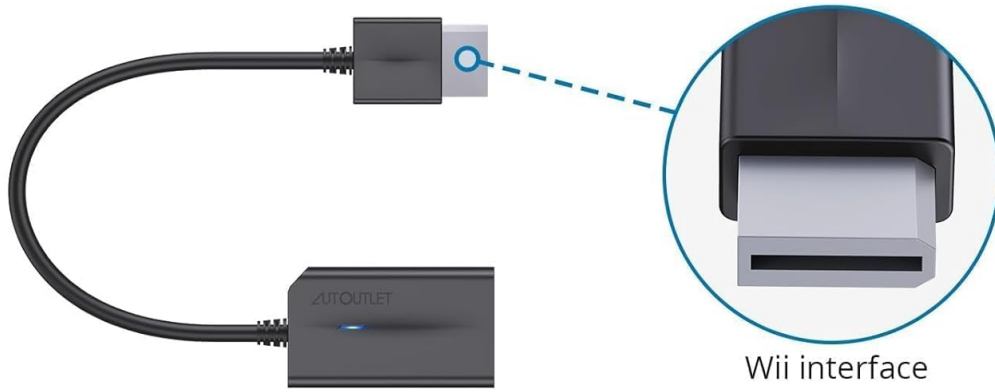

Image 3.2: Overview of the converter's ports and included HDMI cable for convenient connection.

The compact design ensures it does not obstruct other ports on your Wii console. Refer to the dimensions below:

WII TO HDMI CONVERTER



Image 3.3: Detailed dimensions of the Wii to HDMI converter.

4. SETUP INSTRUCTIONS

1. **Connect the Converter to Wii:** Insert the Wii connector end of the AUTOUTLET converter into the AV Multi Out port on the back of your Nintendo Wii console. Ensure it is firmly seated.
2. **Connect HDMI Cable:** Plug one end of the provided 6ft HDMI cable into the HDMI output port on the converter.
3. **Connect to Display:** Plug the other end of the HDMI cable into an available HDMI input port on your television, monitor, or projector.
4. **(Optional) Connect Audio:** If you wish to output audio to external speakers or headphones, connect a 3.5mm audio cable (not included) from the 3.5mm audio jack on the converter to your audio device.
5. **Power On:** Power on your Wii console and your display device. The blue indicator light on the converter will illuminate, indicating it is receiving power and functioning.



Image 4.1: Connection diagram illustrating how to set up the converter with your Wii, TV, and optional audio system.

Setup Demonstration Video

Your browser does not support the video tag.

Video 4.1: This video demonstrates the unboxing and step-by-step connection process of the AUTOUTLET Wii to HDMI Converter to a Wii console and a television. It shows plugging the converter into the Wii, connecting the HDMI cable to both the converter and the TV, and the optional 3.5mm audio connection. The video also highlights the indicator light and the 'plug and play' functionality.

5. OPERATING INSTRUCTIONS

- 1. Select Input:** On your television or monitor, use the remote control to select the correct HDMI input source to which the Wii console is connected.
- 2. Wii Settings:** Ensure your Wii's display settings are configured correctly. Navigate to the Wii System Settings, then Screen, and select 'Widescreen (16:9)' for optimal display on modern widescreen TVs. For resolution, select 'EDTV/HDTV (480p)' if available, or 'Standard TV (480i)' if 480p is not an option for your specific Wii model.
- 3. Enjoy Gaming:** Once the correct input is selected and Wii settings are adjusted, your Wii's video and audio will be displayed on your screen.

PLUG AND PLAY



Image 5.1: The converter enables a 'plug and play' experience, allowing users to enjoy Wii games on modern displays.

EXCELLENT AUDIO/VIDEO QUALITY

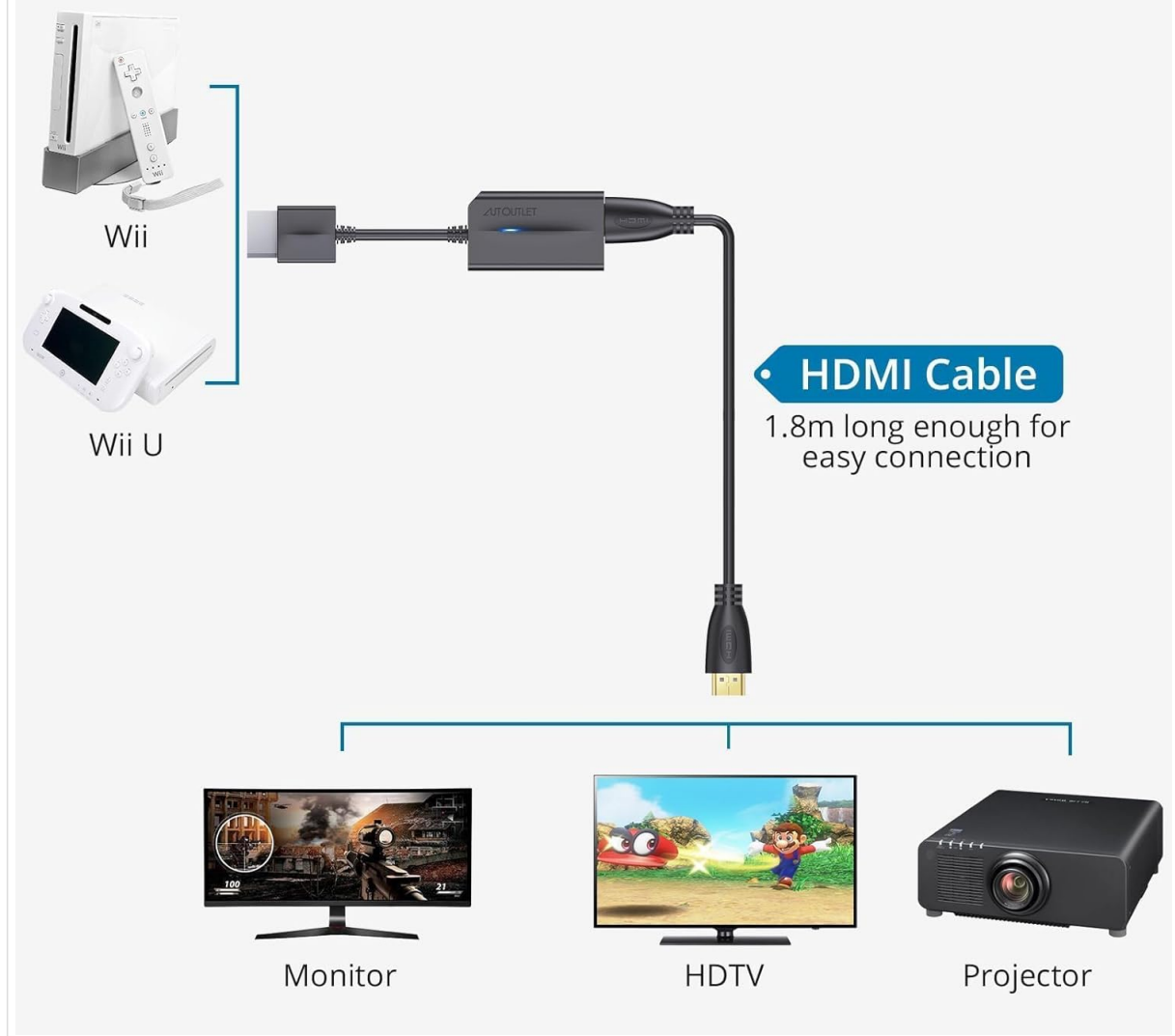

Image 5.2: The converter provides excellent audio and video quality for various display types.

6. IMPORTANT NOTES AND CAUTIONS

- **Wii Mini Incompatibility:** This converter is **not compatible** with the Nintendo Wii Mini console, as the Wii Mini lacks the necessary AV Multi Out port.
- **Signal Conversion Only:** The converter transforms analog Wii signals to digital HDMI 1080P/720P format. It does not upscale the original resolution of the Wii. The output resolution will be the highest resolution supported by the Wii (typically 480p) converted to an HDMI signal.
- **Audio Output:** While video is transmitted via HDMI, the 3.5mm audio jack provides an alternative audio output for headphones or external speaker systems, allowing for flexible audio setups.

7. TROUBLESHOOTING

If you encounter issues with your AUTOUTLET Wii to HDMI Converter, please refer to the following common troubleshooting steps:

- **No Picture/Signal:**
 - Ensure all cables (Wii to converter, HDMI to TV) are securely connected.

- Verify that your TV is set to the correct HDMI input source.
 - Check if the blue indicator light on the converter is illuminated. If not, ensure the Wii console is powered on.
 - Confirm your Wii is not a Wii Mini model.
- **No Audio:**
 - If using HDMI for audio, ensure your TV's volume is up and not muted.
 - If using the 3.5mm audio jack, ensure your external speakers/headphones are properly connected and powered on.
 - Check Wii audio settings in System Settings.
- **Distorted Picture/Colors:**
 - Ensure the converter is fully inserted into the Wii's AV Multi Out port.
 - Try a different HDMI cable if possible.
 - Verify Wii display settings (480i/480p, 16:9/4:3) are appropriate for your TV.

If these steps do not resolve the issue, please contact AUTOUTLET customer support for further assistance.

8. SPECIFICATIONS

Feature	Specification
Model Number	EFU113USE
Input	Wii AV Multi Out Port
Output	HDMI, 3.5mm Audio Jack
Supported Wii Display Modes	NTSC 480i, 480p; PAL 576i
HDMI Output Resolution	Up to 1080P/720P (conversion, not upscaling)
Included HDMI Cable Length	6 feet (1.8 meters)
Color	Black
Item Weight	4.6 ounces
Manufacturer	AUTOUTLET

9. WARRANTY AND SUPPORT

The AUTOUTLET Wii to HDMI Converter comes with an **18-month guarantee** from the date of purchase. This warranty covers manufacturing defects and ensures reliable performance of the product.

For technical support, troubleshooting assistance, or warranty claims, please contact AUTOUTLET customer service. Please have your purchase details and product model number (EFU113USE) ready when contacting support.

If the product does not display properly, such as no sound or no image, please let us know and we will reply to you within 24 hours.

