

Amico HS-STC7515WH

Amico 7-Inch 5CCT Ultra-Thin LED Recessed Ceiling Light Instruction Manual

Model: HS-STC7515WH

1. INTRODUCTION

Thank you for choosing the Amico 7-Inch 5CCT Ultra-Thin LED Recessed Ceiling Light. This product is designed for easy installation and offers versatile lighting options with its 5-color temperature selectable feature and smooth dimming capabilities. This manual provides essential information for safe installation, operation, and maintenance of your new lighting fixture. Please read it thoroughly before installation and retain it for future reference.

2. SAFETY INFORMATION

- Always turn off the power at the circuit breaker before beginning installation or performing any maintenance.
- Consult a qualified electrician if you are unsure about the installation process.
- Ensure all electrical connections comply with local codes and ordinances.
- Do not install this fixture with wet hands or while standing on a wet surface.
- This product is designed for indoor use only.
- The fixture is IC rated, meaning it is suitable for direct contact with insulation.
- Do not attempt to modify the fixture. Any modifications may void the warranty and create safety hazards.

3. PACKAGE CONTENTS

Verify that all components are present and undamaged before installation.

- LED Recessed Light Fixture (Quantity: 12)
- Junction Box (Quantity: 12)



Image: Amico 7-inch LED Recessed Light and Junction Box. Shows the main light unit connected to its junction box, with multiple units shown on the right.

4. SPECIFICATIONS

Feature	Specification
Model Number	HS-STC7515WH
Size	7 inch
Color Temperature (CCT)	2700K, 3000K, 3500K, 4000K, 5000K (Selectable)
Brightness	1300 Lumens
Wattage	15 Watts (equivalent to 100W halogen)
Dimmability	5% - 100% Smooth Dimmable
Voltage	120 Volts

Material	Aluminum
Product Dimensions	7.68"L x 7.68"W x 0.98"H
Advised Hole Cutout Size	6.9 inches
Certifications	ETL & FCC, IC Rated
Indoor/Outdoor Usage	Indoor



Image: Detailed dimensions of the Amico 7-inch LED Recessed Light and its junction box. The advised hole cutout size is 6.9 inches.

7 inch Recessed Light Cutout Size

Wider Illumination for Spacious Rooms



Image: Comparison of recessed light cutout sizes (5-inch, 6-inch, 7-inch), highlighting the 7-inch model's 6.9-inch cutout.

5. INSTALLATION INSTRUCTIONS

Follow these steps for a safe and proper installation. No recessed can housing is needed for this ultra-thin design.

1. **Turn Off Power:** Before starting, ensure the power supply to the installation area is turned off at the circuit breaker.
2. **Cut a Hole:** Use the provided template (if included) or measure and cut a 6.9-inch diameter hole in the ceiling at the desired location. Ensure there is at least 2 inches of clearance above the ceiling for the junction box.
3. **Connect Wiring:** Open the junction box cover. Connect the household electrical wires (live, neutral, ground) to the corresponding wires inside the junction box using appropriate wire connectors. Ensure connections are secure.
4. **Secure Junction Box:** Place the junction box through the cutout hole into the ceiling space.
5. **Connect Light Panel:** Connect the cable from the LED light fixture to the junction box cable. Ensure the connection is tight and secure.
6. **Mount Light:** Push the spring clips on the sides of the light fixture upwards and insert the fixture into the

ceiling hole. Release the clips to secure the light in place.

7. **Restore Power:** Once the light is securely mounted, restore power at the circuit breaker.



Image: Visual guide showing four steps for easy installation: 1. Cut a hole, 2. Connect wiring, 3. Connect light panel, 4. Mount light.

For a visual guide on installation, please watch the video below:

Your browser does not support the video tag.

Video: An animated guide demonstrating the installation process for the Amico 7-inch recessed LED light, including cutting the hole, wiring the junction box, connecting the light, and mounting it.

6. OPERATING INSTRUCTIONS

6.1. 5CCT Color Temperature Selection

Your Amico recessed light features 5 selectable color temperatures (2700K, 3000K, 3500K, 4000K, 5000K). To change the color temperature:

1. Locate the switch on the side of the junction box.
2. Before installation, or by carefully accessing the junction box after installation (ensure power is off), slide the

switch to your desired color temperature setting.

3. Once set, the light will illuminate at the chosen color temperature when power is supplied.

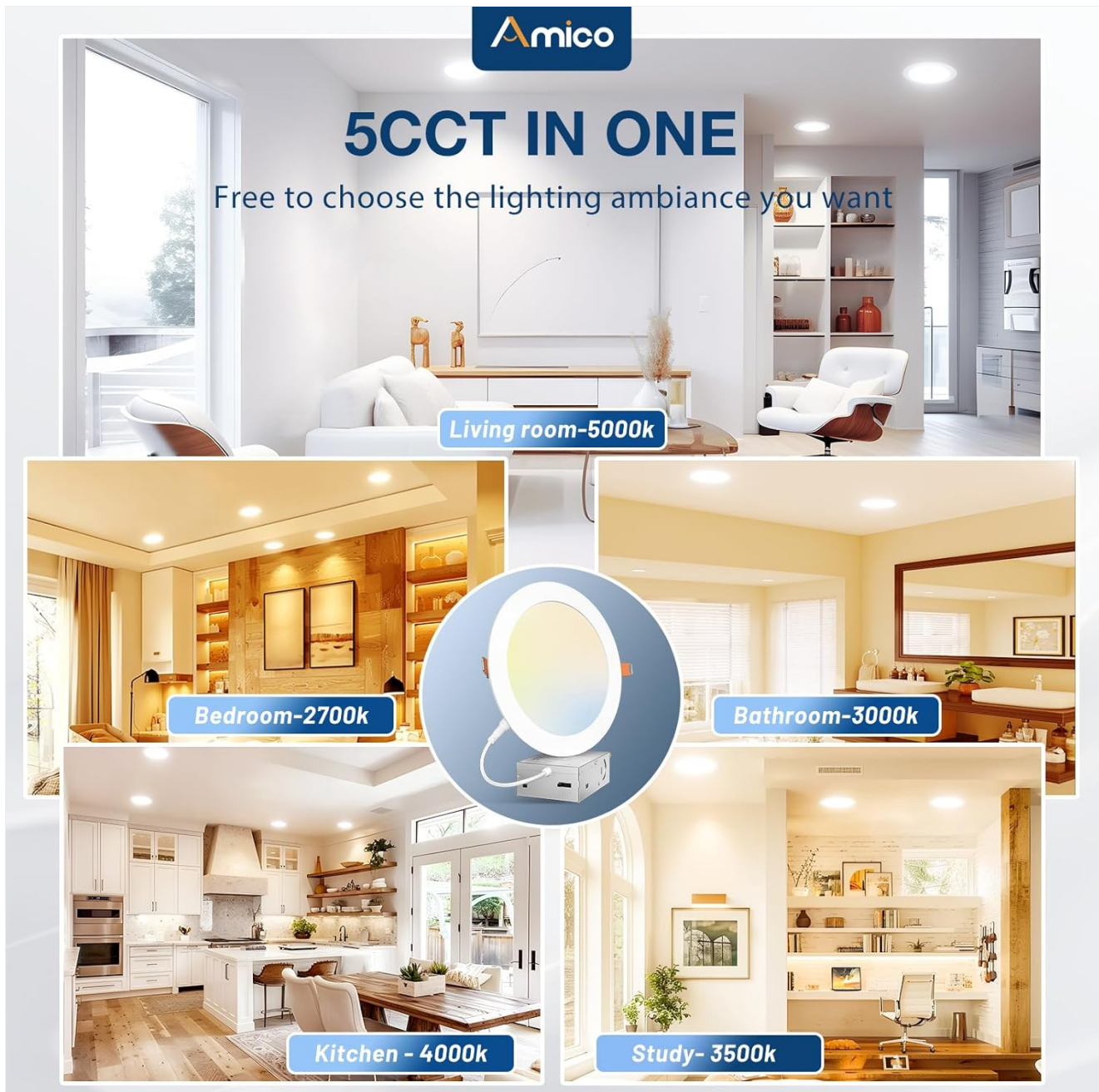

Image: Illustrates the 5 selectable color temperatures (2700K, 3000K, 3500K, 4000K, 5000K) and how they can be chosen via a switch on the junction box.

Examples of different room ambiances are shown for each temperature.

6.2. Dimming Functionality

The Amico recessed lights are designed for smooth dimming from 5% to 100% with most standard LED dimmers on the market.

- Ensure you are using an LED-compatible dimmer switch for optimal performance and to avoid flickering or buzzing.
- Adjust the dimmer switch to achieve your desired light intensity.

Smooth Dimming



Image: Depicts the smooth dimming capability of the lights, ranging from 5% to 100% brightness. Various dimmer switch types are shown as examples (dimmers not included).



Image: A chart showing compatible dimmer models from Lutron and Leviton, indicating their star ratings for compatibility.

7. MAINTENANCE

The Amico LED recessed lights require minimal maintenance.

- **Cleaning:** Ensure the power is off before cleaning. Wipe the fixture with a soft, dry, or slightly damp cloth. Do not use harsh chemicals or abrasive cleaners, as they may damage the finish.
- **Bulb Replacement:** The LED chips are integrated and not user-replaceable. The fixture is designed for a long lifespan.

8. TROUBLESHOOTING

Problem	Possible Cause	Solution
Light does not turn on.	No power, loose wiring, faulty switch, incorrect CCT setting.	Check circuit breaker. Verify all wire connections are secure. Test the switch. Ensure the CCT switch on the junction box is set correctly.
Light flickers or buzzes.	Incompatible dimmer switch, loose wiring.	Ensure you are using an LED-compatible dimmer. Check all wiring connections.
Light is too dim or too bright.	Dimmer setting, incorrect CCT setting.	Adjust the dimmer switch. Verify the CCT switch on the junction box is set to your preferred brightness/color.
Inconsistent light color among multiple fixtures.	CCT switch set differently on fixtures.	Ensure all CCT switches on the junction boxes are set to the same color temperature.

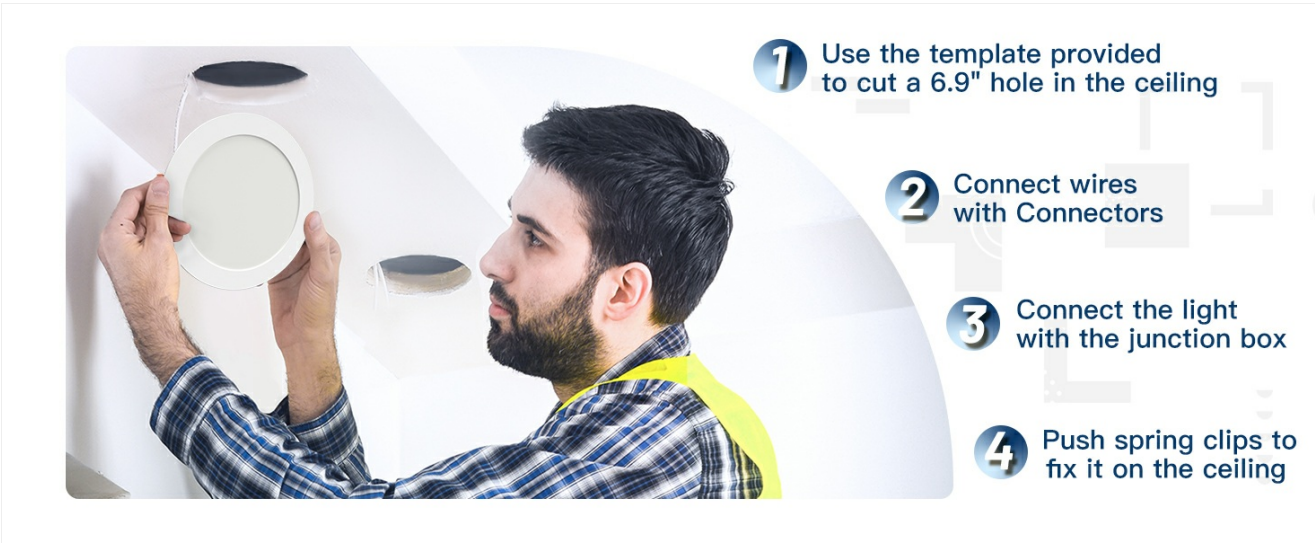
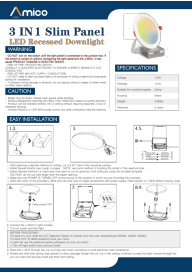

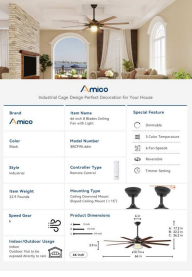

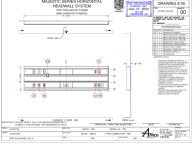

Image: Illustrates the "No Flicker & No Noise" feature of the lights, comparing a clear image with one showing flicker.

9. WARRANTY AND SUPPORT

Amico products are manufactured to high-quality standards. This product comes with a 2-year warranty. For warranty claims, technical support, or any questions regarding your product, please contact Amico customer service. Please have your model number (HS-STC7515WH) and purchase information ready. You can typically find support contact information on the Amico official website or through your purchase platform.

	<p>Amico 3-in-1 Slim Panel LED Recessed Downlight Installation Guide</p> <p>Installation instructions and specifications for the Amico 3-in-1 Slim Panel LED Recessed Downlight, featuring selectable CCT and easy installation methods for both new construction and remodel applications. Includes safety warnings, cautions, and detailed steps.</p>
	<p>Amico Leo Series MIL-Spec MG Downlight High-Performance LED Fixture</p> <p>Discover the Amico Leo Series MIL-Spec MG Downlight, a 6-inch recessed LED fixture designed for hospital environments, offering up to 4000 lumens, 3500K-5000K color temperature, and MIL-STD-461G compliance for optimal light output and emissions control.</p>
	<p>5-in-1 Slim Panel LED Recessed Downlight Installation Guide</p> <p>Easy installation guide for the 5-in-1 Slim Panel LED Recessed Downlight, including CCT selection and safety warnings.</p>
	<p>Amico 66-Inch 8-Blade Industrial Ceiling Fan with Light - Specifications and Features</p> <p>Comprehensive details on the Amico 66-inch 8-blade industrial cage ceiling fan, including its specifications, motor and light details, blade information, remote control functions, and support contact.</p>
	<p>Amico GoLift Patient Lift: Installation and Operation Manual</p> <p>Comprehensive installation and operation instructions for the Amico GoLift patient lift system, covering safety, specifications, usage, maintenance, and accessories for 400 lbs and 700 lbs models.</p>
	<p>Amico Majestic Series Horizontal Headwall System Technical Specification</p> <p>Technical drawing and system details for the Amico Majestic Series Horizontal Headwall System, two-tier, no chase model (HW00-02T-P-MXXX), including component specifications and installation notes.</p>