

[Manuals.plus](#) /

> [Erinice](#) /

> Erinice Filter Replacement Kit User Manual for Shark Pet Cordless Stick Vacuums WZ240, WZ250, WZ140, IX140, IZ140, UZ145, UZ155 Series

## Erinice WZ240, WZ250, WZ140, IX140, IX142, IZ140, IZ142, IZ242, UZ145, UZ155

# Erinice Filter Replacement Kit User Manual

For Shark Pet Cordless Stick Vacuums WZ240, WZ250, WZ140, IX140, IZ140, UZ145, UZ155 Series

## 1. INTRODUCTION

This manual provides instructions for the Erinice filter replacement kit, designed for use with various Shark Pet Cordless Stick Vacuum models. Regular filter replacement and maintenance are essential for optimal vacuum performance and maintaining a clean home environment.

This kit is compatible with the following Shark Pet Cordless Stick Vacuum models:

- WZ240, WZ240 26, WZ250, WZ140
- UZ145, UZ155
- IZ140, IZ140C, IZ141C, IZ142, IZ142HD, IZ142NP, IZ242
- IX140, IX140C, IX140H, IX141, IX141H, IX142, IX144AMZ
- QZ140QBK, QZ140QBL, WZ250RD

It replaces original parts #616FJ140 and #617FJ140.



*Image 1.1: Overview of the Erinice filter replacement kit, including post-motor filters and foam & felt pre-motor filters.*

## 2. PRODUCT COMPONENTS

---

Each Erinice filter replacement kit includes the following items:

- **2 x Post-Motor Filters:** These are the main HEPA-style filters.
- **4 x Pre-Motor Foam & Felt Filters:** These filters work together to capture finer particles before reaching the post-motor filter.
- **1 x Cleaning Brush:** For removing debris from filters and vacuum components.



Image 2.1: Visual representation of the kit contents: two post-motor filters, four sets of foam and felt filters, and one cleaning brush.

### 3. SETUP AND INSTALLATION

Replacing the filters in your Shark Pet Cordless Stick Vacuum is a straightforward process that does not require special tools. Always ensure the vacuum is turned off and unplugged before attempting any maintenance.

#### 3.1. Locating Filters

Refer to your specific Shark vacuum model's user manual to locate the pre-motor and post-motor filter compartments. Typically, pre-motor filters are located near the dust cup, while the post-motor filter is often found at the base or rear of the vacuum unit.

#### 3.2. Removing Old Filters

1. Open the filter compartment(s) according to your vacuum's instructions.
2. Carefully remove the old foam and felt filters, and the post-motor filter. Dispose of them properly.

#### 3.3. Installing New Filters

1. Insert the new foam filter first, followed by the felt filter, into the pre-motor filter compartment. Ensure they are seated correctly.
2. Insert the new post-motor filter into its designated compartment.
3. Close all filter compartments securely.

The new filters are designed for a precise fit, ensuring optimal performance and suction strength.



● Front ●



● Back ●



With plastic



Quality ABS material,  
durable to use



Premuim fabric,  
high filtration

Image 3.1: Detailed view of the post-motor filter, showing its construction and components for proper installation.

## 4. MAINTENANCE

To maintain peak performance of your vacuum cleaner and extend the life of your filters, regular cleaning and timely replacement are crucial.

### 4.1. Cleaning Filters

The foam and felt filters, as well as the post-motor filter, are washable and reusable. Follow these steps for cleaning:

1. Remove the filters from the vacuum.
2. Rinse the filters under clean, running water until the water runs clear.
3. Gently squeeze excess water from the foam and felt filters. Do not wring.
4. Allow all filters to air dry completely for at least 24 hours before reinstallation. Do not use a dryer or heat gun, as this can damage the filter material.
5. Use the included small cleaning brush to remove any stubborn dirt or hair from the filters before or after washing.

**Important: Ensure filters are completely dry before placing them back into the vacuum. Operating the vacuum with damp filters can damage the motor.**



The image features a blue banner at the top with the Erinice logo and the text "WASHABLE & REUSABLE" in white. To the right of the banner is a white checkmark icon. Below the banner, there are three blue circular icons: a hand washing icon labeled "Washable", a circular arrow icon labeled "Reusable", and a thumbs-up icon labeled "Easy to Install". Below these icons is a large illustration of two white cylindrical filters with black rims, one upright and one lying on its side, being rinsed with water. The water is depicted with ripples and bubbles, and the filters are reflected on the surface below.

*Image 4.1: Illustration of filters being rinsed with water, demonstrating their washable and reusable nature.*

## 4.2. Replacement Schedule

- **Foam & Felt Filters:** It is recommended to clean these filters once a month and replace them every 2-4 months, depending on usage frequency.
- **Post-Motor Filter:** It is recommended to clean this filter once a month and replace it every 3-6 months, depending on usage frequency.

Timely replacement helps maintain optimal suction and filtration efficiency.

## 5. HIGH FILTRATION TECHNOLOGY

The Erinice replacement filter set is engineered with high-efficiency filtration materials to capture a wide range of airborne particles, contributing to a cleaner and healthier indoor environment.

- **Particle Capture:** These filters are designed to absorb floating dust, hair, pet fur, and various other particles.

- **Micro-Particle Filtration:** The advanced filtration technology can effectively remove 99.97% of pollutants as small as 0.3 microns, including fine dust, allergens, and odors.
- **Material Quality:** Constructed from premium fabric and durable ABS material, ensuring longevity and consistent performance.



Image 5.1: Visual representation of the filter's ability to capture various particles like hair, dust, pet fur, and other debris.

## 6. COMPATIBILITY VERIFICATION

To ensure you have the correct replacement filters, please verify your vacuum model number and compare the dimensions of the filters if necessary.

### 6.1. Compatible Models

This filter kit is specifically designed for Shark Pet Cordless Stick Vacuum models that use parts #616FJ140 and #617FJ140. Compatible models include:

- WZ240, WZ240 26, WZ250, WZ140
- UZ145, UZ155

- IZ140, IZ140C, IZ141C, IZ142, IZ142HD, IZ142NP, IZ242
- IX140, IX140C, IX140H, IX141, IX141H, IX142, IX144AMZ
- QZ140QBK, QZ140QBL, WZ250RD

Erinice
PERFECTLY COMPATIBILITY
✓

PERFECT COMPATIBLE WITH SHARK ROCKET PRO CORDLESS STICK VACUUM:

✓ <b>WZ240</b>	✓ <b>WZ240 26</b>	✓ <b>WZ250</b>	✓ <b>WZ140</b>	✓ <b>IX140</b>
✓ <b>IX140C</b>	✓ <b>IX140H</b>	✓ <b>IX141</b>	✓ <b>IX141H</b>	✓ <b>IX142</b>
✓ <b>IZ140</b>	✓ <b>IZ140C</b>	✓ <b>IZ141C</b>	✓ <b>IZ142</b>	✓ <b>IZ142HD</b>
✓ <b>IZ142NP</b>	✓ <b>IZ242</b>	✓ <b>UZ145</b>	✓ <b>UZ155</b>	

Compare to Part # **616FJ140 & 617FJ140**



Image 6.1: A visual list of Shark Rocket Pro Cordless Stick Vacuum models compatible with this filter kit.

## 6.2. Dimensional Comparison

If you are unsure about compatibility, compare the dimensions of your existing filters with the specifications provided below. The post-motor filter (part 616FJ140) has a net surface diameter of approximately 3.1 inches (7.9 cm) and a height of 2.75 inches (7 cm). The base measures approximately 4.5 inches (11.4 cm) by 4.96 inches (12.6 cm).

# Erinice PRECISE DIMENSIONS



Image 6.2: Detailed measurements of the post-motor filter and the foam and felt filters to aid in compatibility verification.

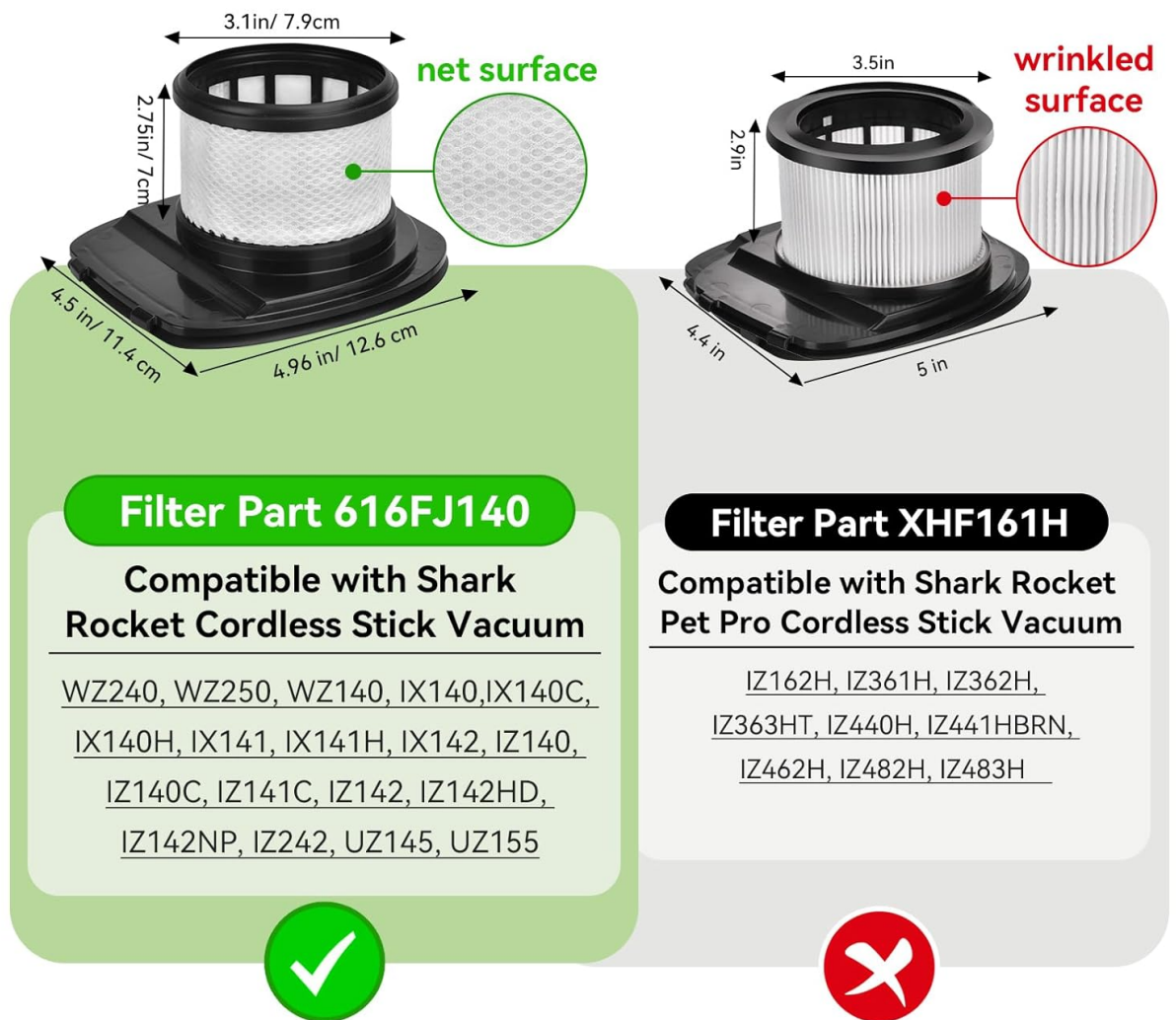

Image 6.3: A comparison chart showing the dimensions of the 616FJ140 filter versus other Shark filter models (e.g., XHF161H) to prevent incorrect purchases.

## 7. SPECIFICATIONS

Feature	Detail
Brand	Erinice
Compatible Devices	Shark Pet Cordless Stick Vacuum WZ240, WZ240 26, WZ250, WZ140, UZ145, UZ155, IZ140, IZ140C, IZ141C, IZ142, IZ142HD, IZ142NP, IZ242, IX140, IX140C, IX140H, IX141, IX141H, IX142, IX144AMZ, QZ140QBK, QZ140QBL, WZ250RD
Replaces Part Numbers	#616FJ140 & #617FJ140
Material Type	Felt, Foam, Plastic
Reusability	Reusable (Washable)

Feature	Detail
Included Components	2 Post-motor filters, 4 Foam & Felt filters, 1 Cleaning brush
Item Weight	6.7 ounces
Product Dimensions	4 x 2 x 4 inches (approximate package dimensions)

## 8. TROUBLESHOOTING

---

This section addresses common issues related to vacuum performance that can often be resolved by proper filter maintenance.

### 8.1. Reduced Suction Power

- **Cause:** Clogged or dirty filters are a primary cause of reduced suction.
- **Solution:** Remove and clean all filters (foam, felt, and post-motor) as described in the Maintenance section. Ensure they are completely dry before reinstallation. If suction does not improve, replace the filters with new ones from this kit.

### 8.2. Unpleasant Odors from Vacuum

- **Cause:** Accumulated dirt, pet dander, or moisture in the filters can lead to odors.
- **Solution:** Thoroughly clean all filters. If odors persist after cleaning and drying, it indicates that the filters have absorbed too much odor-causing material and should be replaced.

### 8.3. Filters Not Fitting Correctly

- **Cause:** Incorrect filter model purchased.
- **Solution:** Double-check your Shark vacuum's model number against the compatibility list in Section 6.1. Compare the dimensions of your old filters with those provided in Section 6.2 to confirm compatibility.

## 9. WARRANTY AND SUPPORT

---

For any questions regarding the Erinice filter replacement kit, including installation, maintenance, or compatibility, please contact Erinice customer service. Specific warranty details may vary; please refer to the product packaging or contact the seller for more information.

We are committed to ensuring customer satisfaction and will assist you with any issues you may encounter.