

OTTOCAST Play2Video Pro

OTTOCAST Play2Video Pro Wireless CarPlay Android Auto Adapter User Manual

Model: Play2Video Pro

1. PRODUCT OVERVIEW

The OTTOCAST Play2Video Pro is a versatile adapter designed to convert your car's factory-wired CarPlay system into a wireless CarPlay and Android Auto experience. It features a built-in Android system, allowing access to popular streaming applications directly on your car's display. This device aims to enhance your in-car entertainment and connectivity.



Image: The OTTOCAST Play2Video Pro device shown next to a car's infotainment screen, displaying its user interface with various applications.



Image: The compact OTTOCAST Play2Video Pro device surrounded by icons of various multimedia applications, symbolizing its entertainment capabilities.

2. SETUP INSTRUCTIONS

2.1 Package Contents

- OTTOCAST Play2Video Pro Device
- USB-C to USB-A Cable
- USB-C to USB-C Cable
- Sticky Pad
- User Manual (this document)



Image: The complete package contents of the OTTOCAST Play2Video Pro, including the device, two USB cables, a sticky pad, and the user manual.

2.2 Compatibility Requirements

- Your car must have factory-installed wired CarPlay.
- For iPhone users: iPhone 6 or later with iOS 10+.
- For Android users: Android 11 or later.
- The car's infotainment system must have a touchscreen.
- Not compatible with Huawei, Xiaomi, and Redmi devices.
- Compatible with most car brands including Ford, Chevrolet, Dodge, Toyota, Honda, Jeep, Audi, Mercedes-Benz, Porsche, Volvo, Volkswagen, Lexus, Hyundai, Peugeot, Mazda, Land Rover, and more.

2.3 Initial Connection

1. Connect the OTTOCAST Play2Video Pro to your car's USB data port using one of the provided USB cables (USB-C to USB-A or USB-C to USB-C, depending on your car's port).
2. The device will power on and display its interface on your car's screen.
3. On your car's screen, navigate to the Bluetooth settings within the Play2Video Pro interface.
4. On your smartphone, open Bluetooth settings and search for the device named 'play2video pro-xxx'.
5. Pair your phone with the device. Allow all necessary permissions for contacts and media sync.
6. Once paired, the device will automatically connect to your phone for wireless CarPlay or Android Auto.



Image: A visual representation of eliminating tangled cables by switching to the wireless connectivity provided by the Play2Video Pro.

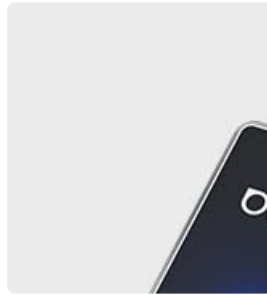

Image: A man entering his car, illustrating the automatic connection feature of the OTTOCAST Play2Video Pro upon vehicle startup.

2.4 Wireless CarPlay and Android Auto

The Play2Video Pro enables seamless wireless integration of both Apple CarPlay and Android Auto. After initial pairing, your phone will automatically connect when you start your vehicle, providing access to navigation, music, calls, and messages through your car's display.

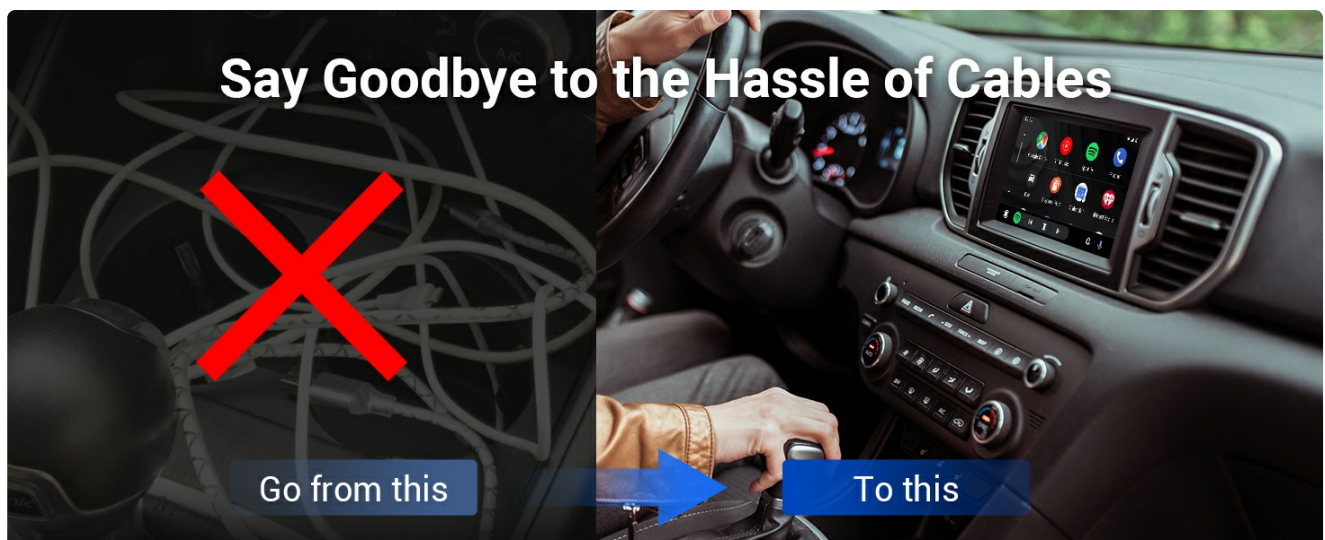

Image: A car's infotainment screen simultaneously displaying both Apple CarPlay and Android Auto interfaces, connected wirelessly to respective smartphones.

2.5 Bluetooth Connection Video Guide

Your browser does not support the video tag.

Video: A step-by-step guide demonstrating how to connect your smartphone to the OTTOCAST Play2Video Pro via Bluetooth for wireless functionality.

3. OPERATING INSTRUCTIONS

3.1 Accessing Built-in Applications

The Play2Video Pro features a built-in Android system with pre-installed applications such as YouTube, Netflix, Spotify, and IPTV. To use these applications, ensure the device is connected to your car's Wi-Fi or your mobile hotspot.



Image: The car's infotainment screen displaying the main interface of the Play2Video Pro, featuring icons for Netflix, YouTube, Spotify, and IPTV.

3.2 Using CarPlay and Android Auto Features

Once connected, you can utilize all standard CarPlay and Android Auto functions, including:

- **Navigation:** Use your preferred mapping applications.
- **Music:** Stream music from Spotify, Apple Music, YouTube Music, or other compatible apps.
- **Phone Calls:** Make and receive calls hands-free.
- **Messages:** Send and receive messages via voice commands.
- **Calendar:** View your schedule and appointments.

Auto-Connect

OTTOCAST Play2Video Pro automatically connects when you turn on your vehicle.

Save time plugging in your phone for any length of drive.

A promotional image for the 'Auto-Connect' feature. On the left, a dark blue box contains the text 'Auto-Connect' in white, followed by 'OTTOCAST Play2Video Pro automatically connects when you turn on your vehicle.' and 'Save time plugging in your phone for any length of drive.' On the right, a photograph shows a man in a light blue shirt and dark pants standing next to a silver car, talking on a mobile phone. The background is a bright, sunny outdoor setting with green trees.

Image: A car's infotainment screen showcasing various native CarPlay applications such as Navigation, Music, Phone Call, Calendar, and Messages.

3.3 Control Methods

The Play2Video Pro supports multiple control methods, integrating with your car's existing systems:

- **Steering Wheel Controls:** Use your car's steering wheel buttons for audio, calls, and navigation.

- **Touchscreen Control:** Directly interact with the car's touchscreen display.
- **OEM Knob Control:** Utilize your car's original equipment manufacturer (OEM) control knobs.
- **Voice Control:** Use Siri (for CarPlay) or Google Assistant (for Android Auto) for hands-free operation.



Image: A car interior view illustrating the different control methods supported by the Play2Video Pro, including steering wheel, touchscreen, and OEM knob controls, along with voice commands.

3.4 USB Disk Playback

The device supports a 128GB TF card (not included) and USB disk playback, allowing you to play downloaded movies and music directly on your car's screen.

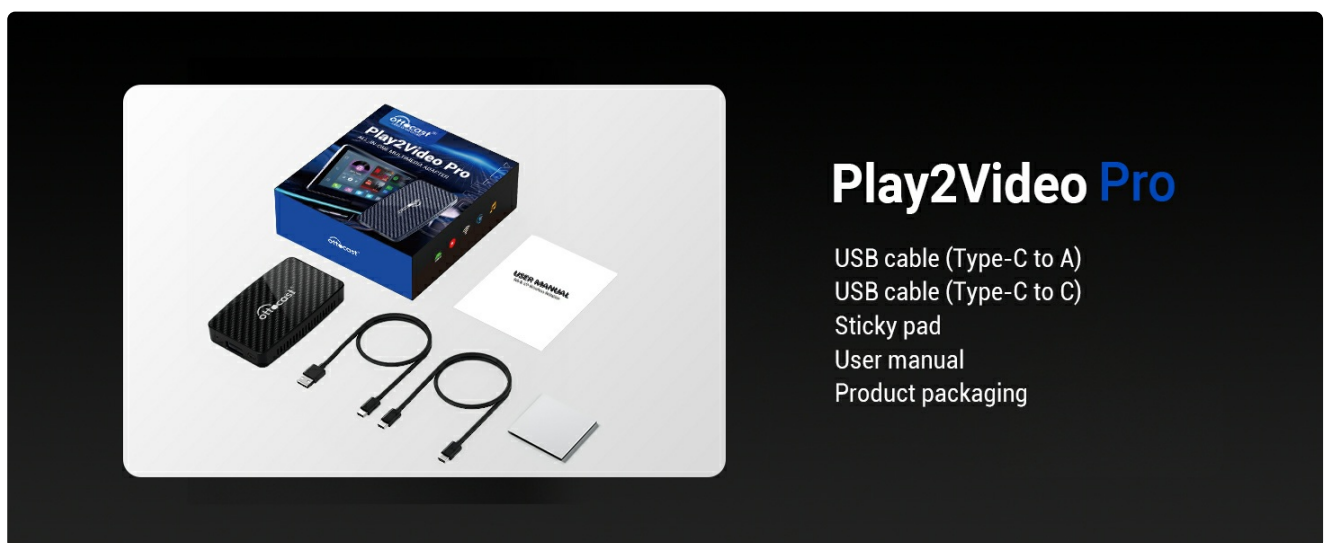

Image: The Play2Video Pro device with a USB flash drive inserted, demonstrating its capability to play media files on the car's display.

3.5 User Interface and App Customization Video Guide

Your browser does not support the video tag.

Video: A demonstration of the OTTOCAST Play2Video Pro's user interface, including how to add widgets and customize preferred applications.

4. MAINTENANCE

4.1 Software Updates (FOTA)

The Play2Video Pro supports Firmware Over-The-Air (FOTA) updates to ensure optimal performance and access to the latest features. To update:

1. Ensure the device is connected to Wi-Fi (via car's Wi-Fi or mobile hotspot).
2. On the Play2Video Pro interface, navigate to 'App Update' or 'OTA' icon.
3. Check for available updates and follow the on-screen prompts to install.
4. The device will restart after a successful update.

Your browser does not support the video tag.

Video: Instructions on how to connect the Play2Video Pro to Wi-Fi and perform a Firmware Over-The-Air (FOTA) update.

4.2 Cleaning

To clean the device, use a soft, dry cloth. Avoid using liquid cleaners or abrasive materials that could damage the surface.

5. TROUBLESHOOTING

- **Device not connecting wirelessly:** Ensure your car has factory-wired CarPlay. Verify your phone's Bluetooth and Wi-Fi are enabled and correctly paired with the Play2Video Pro. Check compatibility requirements for your phone's OS version.
- **Sluggish performance or app crashes:** Ensure the device has a stable Wi-Fi connection for streaming apps. Check for and install any available software updates. Restart the device by unplugging and re-plugging it.
- **No sound or distorted audio:** Verify your car's audio input is set to the correct source (e.g., USB or Bluetooth). Check volume levels on both the car and the Play2Video Pro.
- **Video playback issues (choppy/lagging):** This may be due to a weak Wi-Fi signal or mobile hotspot connection. Ensure a strong internet connection for optimal streaming.
- **Device does not power on:** Ensure the USB cable is securely connected to a functional USB data port in your car. Try a different USB port if available.

6. SPECIFICATIONS

Feature	Detail
Model Number	Play2Video Pro
RAM	2GB DDR3
ROM	16GB eMMC
Operating System	Built-in Android System
Supported Phone OS	iOS 10+ (iPhone 6 and later), Android 11+
Max TF Card Support	128GB
Connectivity	Wireless CarPlay, Wireless Android Auto, Wi-Fi, Bluetooth
Pre-installed Apps	YouTube, Netflix, Spotify, IPTV
Control Methods	Steering Wheel, Touchscreen, OEM Knob, Voice (Siri, Google)
Dimensions	4.37 x 3.94 x 1.46 inches

Weight	5.3 ounces (0.15 kg)
Connector Type	USB-C (for connection to car)



Image: A detailed diagram of the H618 silicon chip, representing the core processing unit of the Play2Video Pro.



Image: The compact design of the Play2Video Pro, shown next to an Apple Magic Mouse for scale, highlighting its small footprint.

7. WARRANTY AND SUPPORT

For warranty information and technical support, please refer to the official OTTOCAST website or contact their customer service directly. Keep your purchase receipt for warranty claims.

You can visit the OTTOCAST store for more information:[OTTOCAST Store](#)