

## Rode WIMEDUAL

# RØDE Wireless ME Dual Set Ultra-Compact Wireless Microphone System Instruction Manual

Model: WIMEDUAL

## 1. INTRODUCTION

---

The RØDE Wireless ME Dual Set is an ultra-compact wireless microphone system designed for effortless professional audio recording. It features built-in, broadcast-grade microphones in both transmitters and the receiver, making it suitable for various applications including filmmaking, interviews, and content creation. Intelligent GainAssist technology ensures clear audio without clipping, and its intuitive controls simplify operation. The system offers stable wireless connectivity with a range of over 100 meters.

## 2. WHAT'S IN THE BOX

---

The RØDE Wireless ME Dual Set includes the following components:

- 2x Wireless ME Transmitters (TX)
- 1x Wireless ME Receiver (RX)
- 1x SC21 USB-C to Lightning Cable
- 2x SC22 USB-C to USB-C Cables
- 1x SC2 3.5mm TRS to TRS Cable
- 1x SC7 3.5mm TRS to TRRS Cable
- 3x Furry Windshields
- 2x MagClip GO Magnetic Clips
- 1x Carry Pouch



Image: The RØDE Wireless ME Dual Set showing two transmitters and one receiver, along with various cables and accessories.

### 3. SETUP

#### 3.1. Charging the Devices

Before first use, ensure all transmitters and the receiver are fully charged. Use the provided USB-C cables (SC21 or SC22) to connect the devices to a USB power source. The battery indicator lights will show charging status.

#### 3.2. Powering On/Off

To power on or off any unit (transmitter or receiver), press and hold the power button until the indicator lights illuminate or turn off.

#### 3.3. Pairing

The Wireless ME Dual Set comes pre-paired from the factory. If re-pairing is necessary, refer to the detailed instructions in the full user manual available on the RØDE website.

#### 3.4. Connecting to Your Device

Connect the receiver to your recording device using the appropriate cable:

- **Cameras:** Use the SC2 3.5mm TRS to TRS cable.
- **Smartphones (iOS with Lightning):** Use the SC21 USB-C to Lightning cable.
- **Smartphones (Android with USB-C) / Computers (USB-C):** Use the SC22 USB-C to USB-C cable.

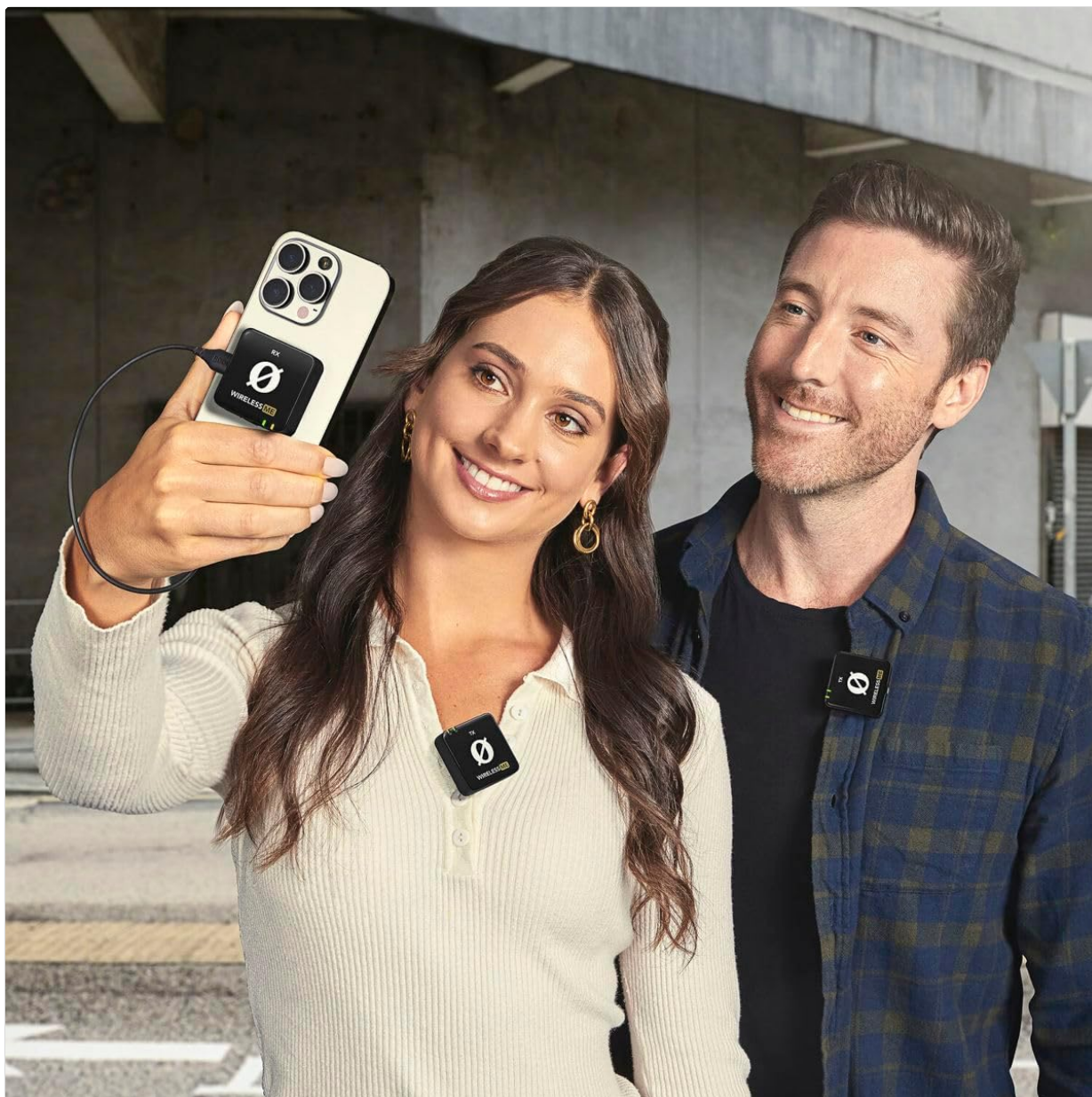

Image: A RØDE Wireless ME receiver connected to a smartphone, with two transmitters clipped onto individuals for recording.

## 4. OPERATING INSTRUCTIONS

### 4.1. Attaching Transmitters

Clip the transmitters onto the clothing of the person speaking. For optimal audio, position the microphone close to the speaker's mouth. Use the included furry windshields to reduce wind noise when recording outdoors.



Image: A close-up view of a RØDE Wireless ME transmitter with a furry windshield attached, highlighting the microphone input.

## 4.2. GainAssist Technology

The Wireless ME features intelligent GainAssist technology, which automatically controls your audio levels to prevent clipping and distortion. This ensures a clean audio signal without manual gain adjustments in most scenarios.

## 4.3. Monitoring Audio

If your recording device allows, monitor the audio output using headphones to ensure optimal sound quality and detect any potential issues during recording.

## 5. KEY FEATURES

---

- **Ultra-Compact Design:** Small and lightweight for discreet and portable use.
- **Built-in Microphones:** Both transmitters and the receiver feature high-quality omnidirectional microphones.
- **GainAssist Technology:** Automatically adjusts audio levels for clear, distortion-free sound.
- **Wide Compatibility:** Seamlessly connects with cameras, Windows/macOS computers, and iOS/Android phones.
- **Dual Channel Recording:** The Dual set captures two subjects simultaneously, recording to separate channels for flexible post-production.
- **Extended Range:** Stable wireless connectivity up to 100 meters (line of sight).

## 6. MAINTENANCE

---

- **Cleaning:** Use a soft, dry cloth to clean the devices. Avoid using liquids or abrasive cleaners.
- **Storage:** Store the Wireless ME Dual Set in its carry pouch in a cool, dry place when not in use.
- **Battery Care:** For optimal battery life, avoid fully discharging the devices frequently. Recharge regularly.

## 7. TROUBLESHOOTING

---

- **No Audio:**
  - Ensure all units are powered on and properly paired.
  - Check cable connections between the receiver and your recording device.
  - Verify audio input settings on your recording device.
- **Poor Audio Quality/Interference:**
  - Ensure transmitters are within range of the receiver.
  - Minimize obstructions between transmitters and receiver.
  - Use furry windshields in windy conditions.
  - Check for strong Wi-Fi or other 2.4GHz interference sources.
- **Charging Issues:**
  - Ensure USB cables are securely connected.
  - Try a different USB power source or cable.

## 8. SPECIFICATIONS

---

Feature	Detail
Item Weight	274 Grams (9.7 ounces)
Impedance	200 Ohms
Microphone Form Factor	Lavalier
Dimensions (L x W x H)	8.15 x 4.61 x 1.65 inches
Power Source	Battery Powered (3 A batteries included)
Material	Plastic
Signal-to-Noise Ratio	60 dB
Hardware Platform	Camera
Number of Channels	2
Frequency Response	2400 MHz
Connectivity Technology	Wi-Fi
Connector Type	USB Type-C
Special Feature	Bluetooth, Wireless
Polar Pattern	Omnidirectional

## 9. WARRANTY AND SUPPORT

For warranty information and technical support, please refer to the official RØDE website or contact their customer service directly. Keep your proof of purchase for warranty claims.

## 10. PRODUCT MEDIA

### Product Images



Image: A RØDE Wireless ME receiver mounted on a camera's hot shoe, with a red coiled cable connecting it to the camera's microphone input. This setup is ready for recording with the wireless transmitters.



Image: A side view of a RØDE Wireless ME transmitter, showing the power button, 3.5mm input jack, and USB-C port for charging and connectivity.



Image: A side view of a RØDE Wireless ME receiver, displaying the 3.5mm output jack, USB-C port, and power button.

## Related Documents - WIMEDUAL



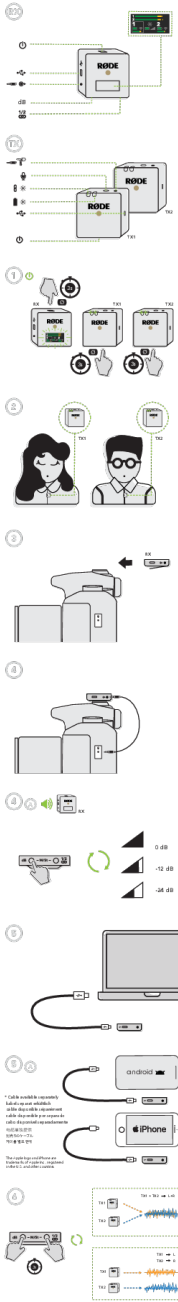

[Rode Wireless GO II Quickstart Guide](#)

A quickstart guide for the Rode Wireless GO II, covering setup, operation, and safety information.

