



Manuals.plus /

› HoneyGuaridan /

› HoneyGuaridan 3.5L Automatic Pet Feeder with Dual Stainless Steel Bowls and Smart App Control User Manual

## HoneyGuaridan 3.5L Stainless Steel Bowls

# HoneyGuaridan 3.5L Automatic Pet Feeder with Dual Stainless Steel Bowls and Smart App Control User Manual

Model: 3.5L Stainless Steel Bowls

---

## INTRODUCTION

---

Thank you for choosing the HoneyGuaridan 3.5L Automatic Pet Feeder. This device is designed to provide a convenient and reliable feeding solution for your pets, especially in multi-pet households. Featuring dual stainless steel bowls, smart app control, and advanced freshness preservation, this feeder ensures your pets receive their meals on time and in appropriate portions. Please read this manual thoroughly before use to ensure proper operation and maintenance.

## PACKAGE CONTENTS

---

- HoneyGuaridan 3.5L Automatic Pet Feeder Unit
- 2 x Stainless Steel Food Bowls
- Type-C Power Adapter
- Desiccant Bag (pre-installed or separate)
- User Manual

## SETUP

---

1. **Unpack the Feeder:** Carefully remove all components from the packaging.
2. **Assemble Bowls:** Place the two stainless steel bowls into their designated slots on the feeder base.
3. **Power Supply:**
  - Connect the Type-C power adapter to the feeder and a wall outlet.
  - For backup power, install 3 D-cell batteries (not included) into the battery compartment at the bottom of the feeder. This ensures continuous operation during power outages. Note: WiFi

functionality is not available when operating solely on battery power to conserve energy.

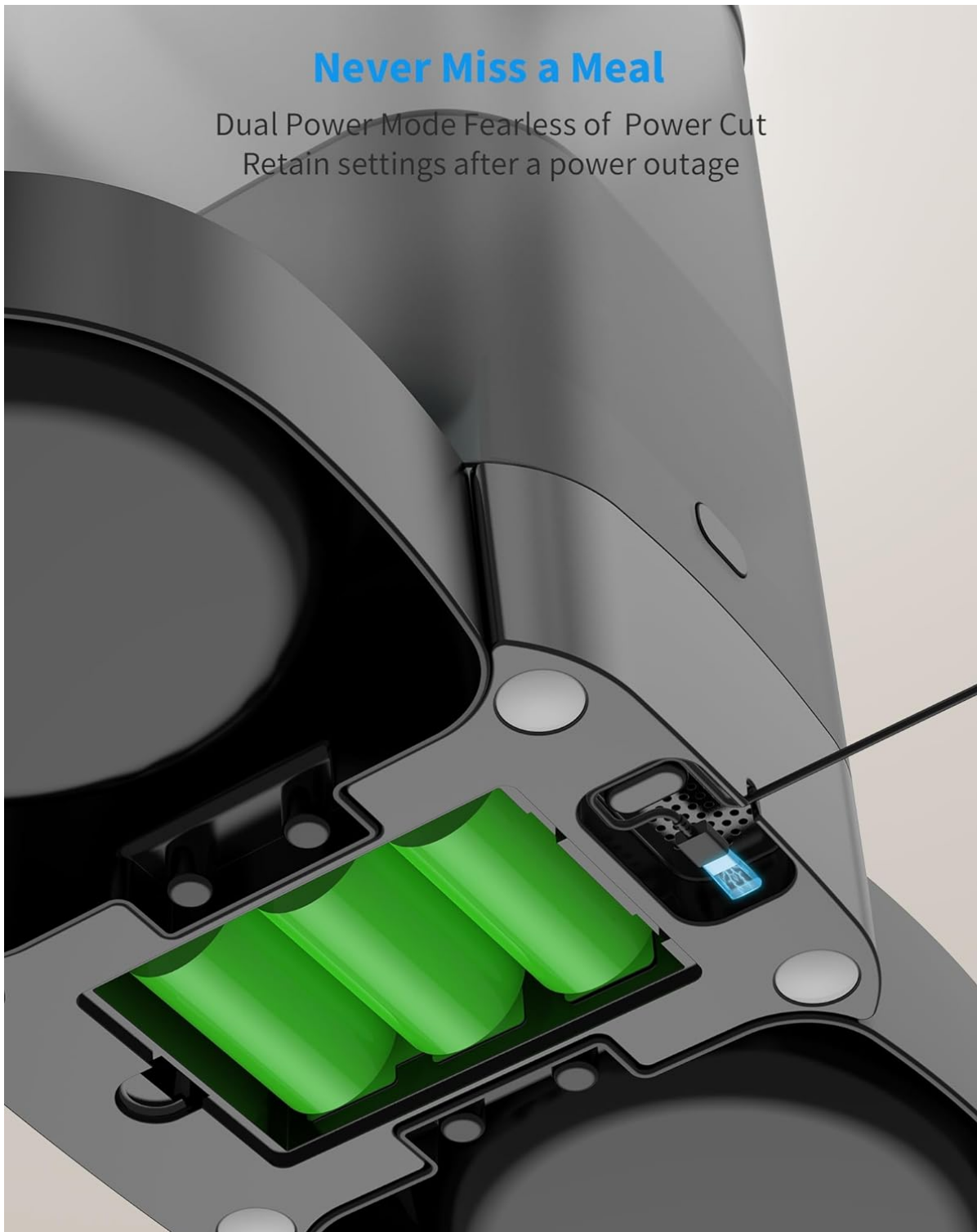

Image: Dual power mode with battery compartment and Type-C adapter connection. This ensures the feeder continues to operate even during power interruptions.

- 4. Fill Food Container:** Open the top lid and pour dry pet food into the container. Ensure the desiccant bag is properly placed in its compartment to maintain food freshness.

## Freshness in Every Bite

Secure storage and keeps food fresh and crispy

Silicone seal

Desiccant bag



Sealed rotor



Image: Components ensuring food freshness, including a silicone seal, desiccant bag, and sealed rotor.

### 5. App Connection (2.4GHz WiFi):

- Download the HG Smart app from your device's app store (iOS/Android).
- Follow the in-app instructions to connect your feeder to a 2.4GHz WiFi network. This enables remote control and monitoring.

## OPERATING INSTRUCTIONS

### 1. Smart App Control

The HG Smart app provides comprehensive control over your pet feeder:

- **Meal Scheduling:** Set up to 6 meals per day with customizable portion sizes for each bowl. The app

allows precise control over feeding times and amounts.

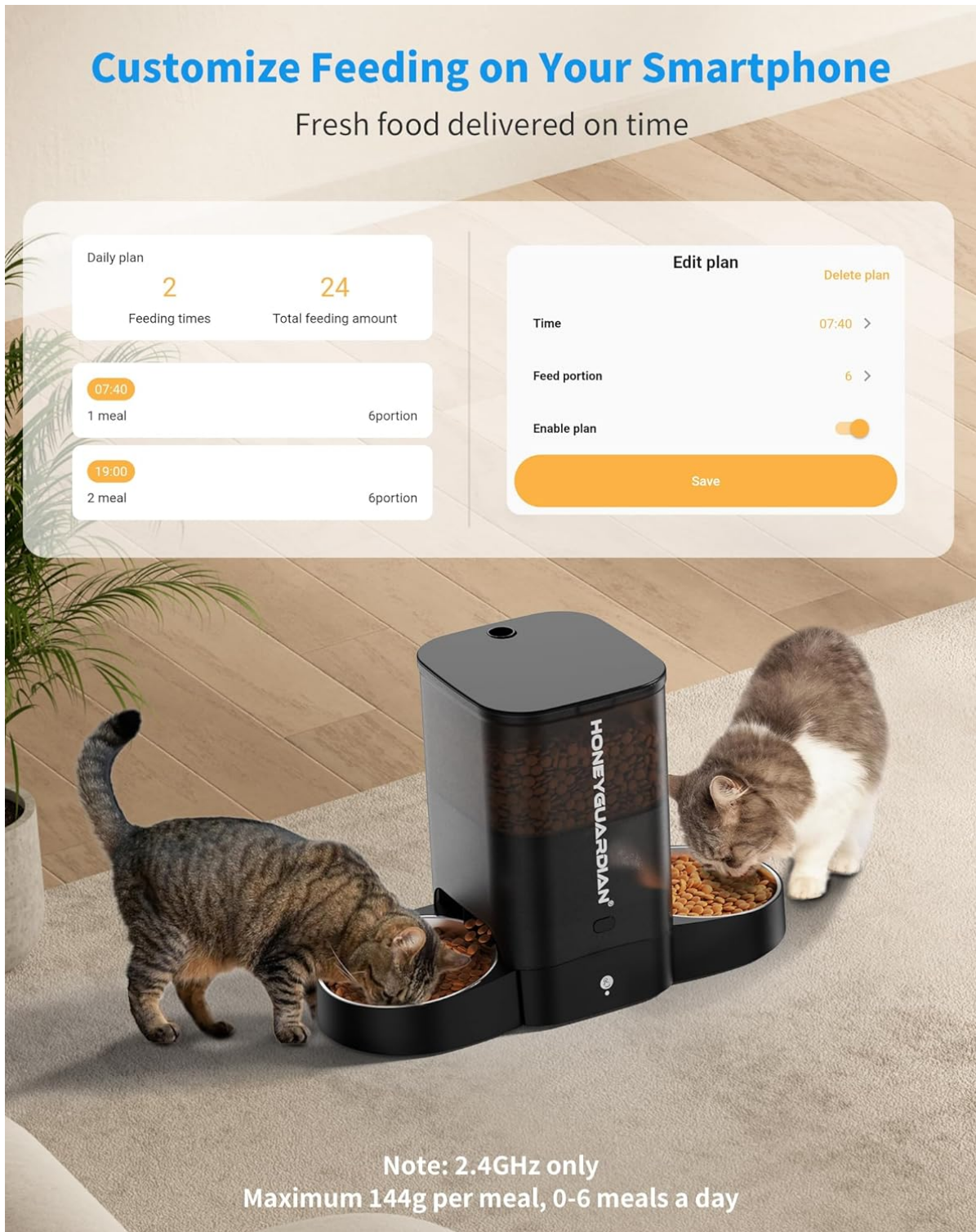

Image: App interface for customizing daily feeding plans, showing options for time and portion size.

- **Feeding Dynamics Monitoring:** Intelligent sensors at each food outlet detect when pets approach and stay, logging feeding activity. The app provides reports on meal duration and frequency for both left and right bowls, offering insights into your pets' eating habits.

## Available to View Two Pets' Eating Dynamics

Sense pets' approach and stay, syncing each feeding activity to App  
You're able to see the eating status of right and left bowls respectively

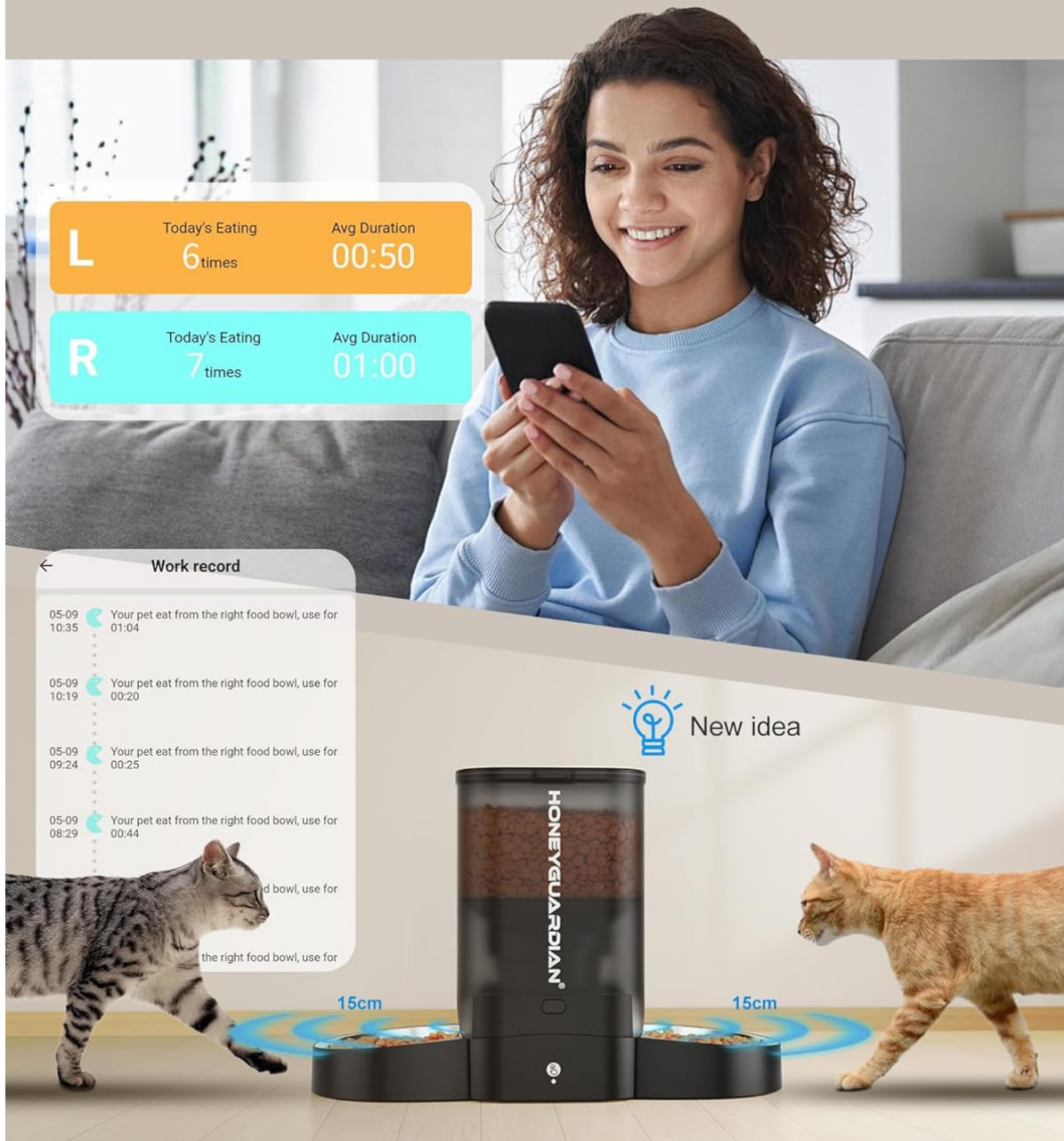

Image: App displaying eating dynamics for two pets, showing daily eating times and average duration for each bowl.

- **Food Remaining Reminder:** The app can notify you about the remaining food level in the container, ensuring you refill it before it runs out.

## APP Food Remaining Reminder

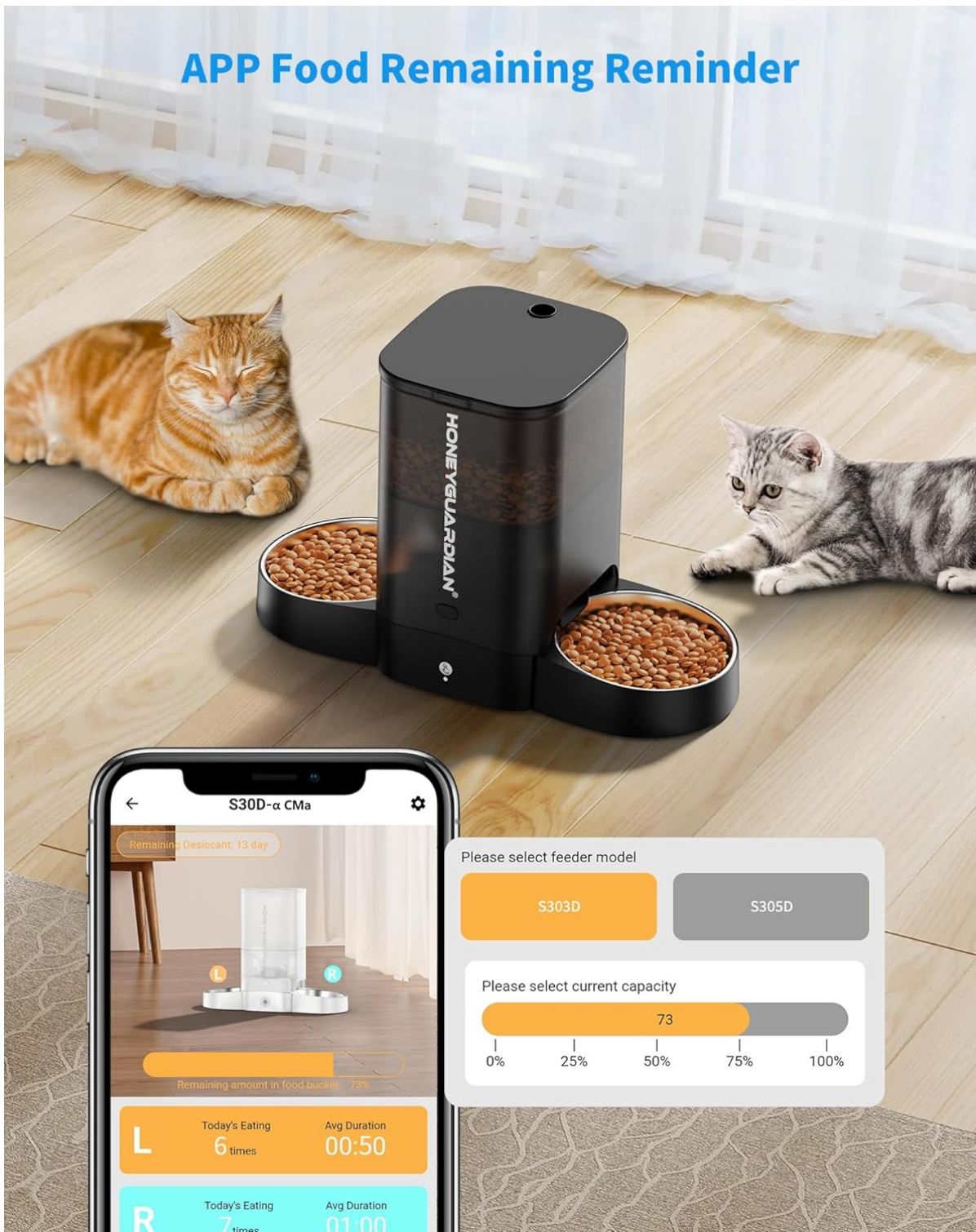

Image: App interface showing food remaining reminder and options for selecting feeder models.

- **Personalized Meal Call:** Record a 10-second voice message via the app. This message will play at feeding times to call your pets to their meal.

## Personalised Meal Call

Record a 10s messages with one click on HG Smart APP

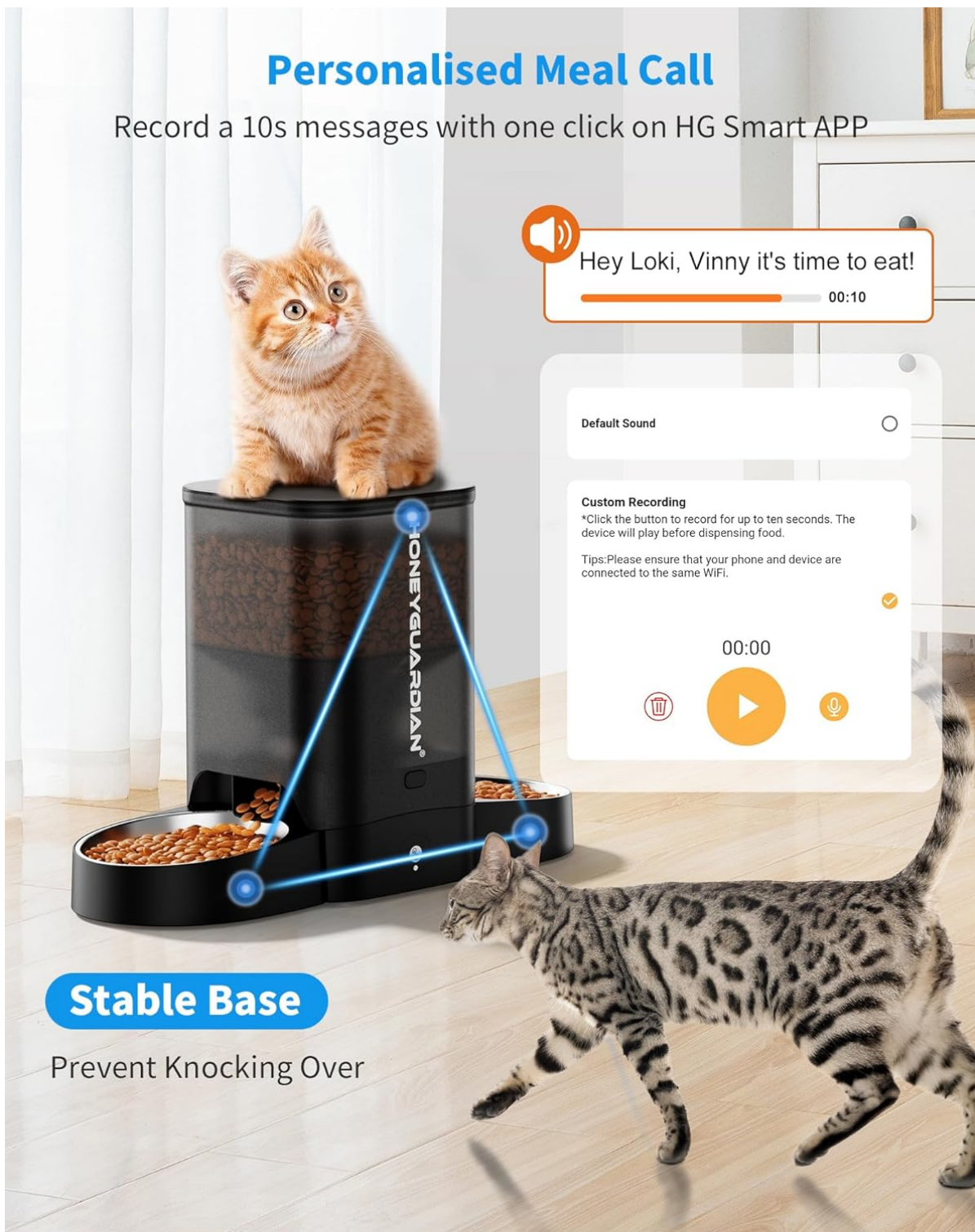

Image: Voice recording feature for personalized meal calls and the stable base design to prevent tipping.

## 2. Manual Feeding

You can manually dispense food at any time using the buttons on the feeder's control panel. Refer to the on-screen display for current settings and options.

## 2 Separate Food Distribution Chutes

Evenly dispenses the same portions of food into each bowl



# OPPOSITE BOWLS

**No more fight over uneven food**

Image: The feeder features two separate food distribution chutes and opposite bowls, ensuring equal portions for each pet.

Your browser does not support the video tag.

Video: This video illustrates the internal food storage and dispensing mechanism of the HoneyGuardian Automatic Pet Feeder, showing how kibble is securely stored and released into the bowls.

Your browser does not support the video tag.

Video: This video demonstrates the HoneyGuardian Automatic Pet Feeder's features, including dual feeding, easy setup, food dispensing, dual power options, and simple cleaning. It highlights how the feeder helps manage feeding for multiple pets.

## MAINTENANCE

---

## 1. Cleaning

Regular cleaning is essential to maintain hygiene and proper functioning. The feeder is designed for easy disassembly and cleaning:

- Remove the stainless steel bowls and wash them with soap and water.
- The food container and base can be detached for thorough cleaning. Wash with mild detergent and rinse thoroughly.
- Ensure all parts are completely dry before reassembling.

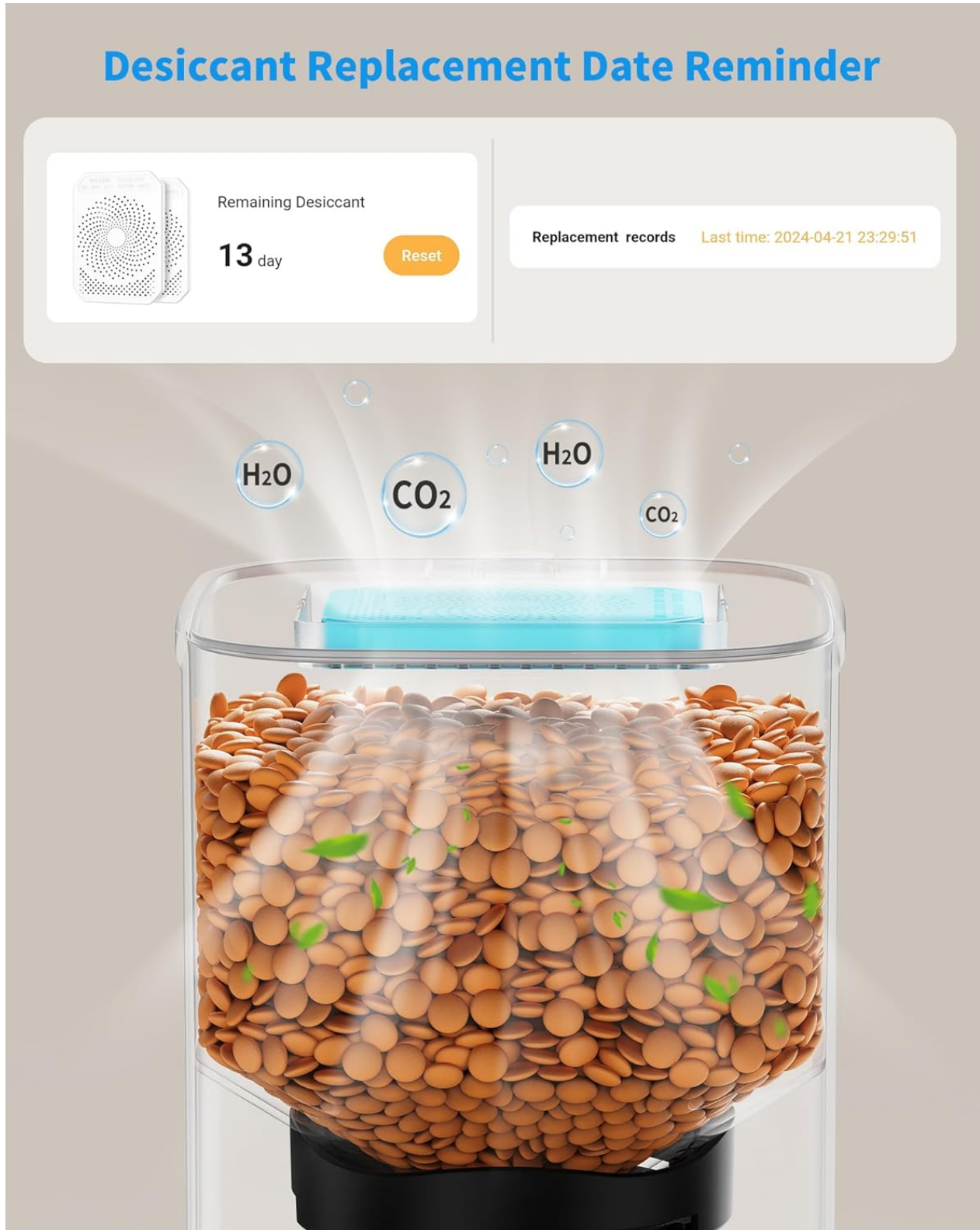

Image: App reminder for desiccant replacement date, ensuring optimal food freshness.

## 2. Desiccant Bag Replacement

The desiccant bag helps keep the food dry and fresh. Replace it periodically (e.g., every 1-2 months) to ensure optimal performance. The app may provide a reminder for replacement.

## TROUBLESHOOTING

---

- **Feeder not dispensing food:** Check if the food container is empty, if there's a blockage in the chute, or if the power supply is stable. Ensure the rotor is not jammed.
- **App connectivity issues:** Ensure your feeder is connected to a 2.4GHz WiFi network. Check your router settings and ensure the feeder is within range. Restart both the feeder and your router if necessary.
- **Inaccurate feeding records:** Ensure the motion sensors are clean and unobstructed.
- **Food not fresh:** Check if the desiccant bag needs replacement and if the lid is securely sealed.

## SPECIFICATIONS

---

- **Material:** ABS
- **Target Species:** Cat (suitable for small dogs as well)
- **Brand:** HoneyGuardan
- **Recommended Uses:** Dry food, Indoor, Multiple pets
- **Special Features:** 2.4G Smart App, Food-grade material, Programmable, Voice recording, Timer
- **Capacity:** 3.5L
- **Power:** Type-C Adapter, 3 x D-cell batteries (not included)

## SAFETY INFORMATION

---

- Use only dry pet food. Do not use wet food, canned food, or treats.
- Keep the feeder away from direct sunlight and heat sources.
- Ensure the feeder is placed on a stable, level surface to prevent tipping.
- Do not immerse the main unit in water.
- Keep out of reach of children.

## WARRANTY AND SUPPORT

---

HoneyGuardan products come with a standard manufacturer's warranty. For detailed warranty information, technical support, or service inquiries, please refer to the contact information provided on the product packaging or visit the official HoneyGuardan website. Please retain your proof of purchase for warranty claims.