

WAVLINK WL-WN573HX3

WAVLINK WL-WN573HX3 Outdoor WiFi 6 Access Point - AX3000 Dual-Band Instruction Manual

Model: WL-WN573HX3

1. INTRODUCTION

This manual provides comprehensive instructions for the installation, configuration, and operation of your WAVLINK WL-WN573HX3 Outdoor WiFi 6 Access Point. This device is designed to extend wireless network coverage in outdoor environments, offering high-speed, stable connectivity with advanced features like WiFi 6 technology, Power over Ethernet (PoE), and robust weather protection. Please read this manual thoroughly before beginning installation.

2. PRODUCT OVERVIEW

2.1 Key Features

- **WiFi 6 (802.11ax) Technology:** Supports dual-band speeds up to 2402 Mbps on 5 GHz and 573 Mbps on 2.4 GHz.
- **Outdoor Durability:** Features an IP67 waterproof enclosure, 15 kV ESD protection, and 6 kV lightning protection for reliable operation in harsh weather conditions.
- **Power over Ethernet (PoE):** Compatible with 802.3AF/AT active PoE and passive PoE, allowing power and data transmission over a single Ethernet cable.
- **High-Gain Antennas:** Equipped with four 8 dBi omnidirectional fiberglass antennas and integrated high-power amplifiers for extended coverage and penetration.
- **Mesh Technology:** Supports seamless WiFi roaming and expanded coverage with a single network name.
- **Multiple Operating Modes:** Functions as a Mesh device, Access Point (AP), Router, Repeater, or AP+Repeater.

2.2 Package Contents

Verify that all items are present in your package:

- 1 x WAVLINK AX3000 WiFi 6 Outdoor Access Point (WL-WN573HX3)
- 4 x Omni Antennas
- 4 x Cable Ties
- 1 x Ethernet Cable Connector
- 1 x Quick Installation Guide
- 1 x Screwdriver
- 2 x Silicone Pads
- Several Screws
- Optional Passive PoE Components (if included): 1 x 54V Power Adapter, 1 x PoE Converter, 1 x Ethernet Cable



Image: Front and rear view of the WAVLINK WL-WN573HX3 Outdoor WiFi 6 Access Point, showcasing its design and antenna ports.

AX 3000M Dual-Band WiFi 6

2.4Ghz
573Mbps

5Ghz
2402Mbps

Icons representing various activities: envelope, speech bubble, music note, game controller, HD monitor, and play button.

Image: Illustration demonstrating the AX3000 dual-band WiFi 6 capabilities, with 2.4GHz at 573Mbps and 5GHz at 2402Mbps, suitable for various outdoor activities.

Born for Outdoor Use

IP67 waterproof enclosure, build-in lightning arrester and fiberglass antenna tubes withstand harsh outdoor conditions



Image: The access point mounted outdoors, with icons representing its resilience to sun, rain, snow, thunder, wind, and hail, highlighting its IP67 weather protection.

3. INSTALLATION

3.1 Physical Mounting

The device is designed for pole mounting. Ensure the mounting location is clear of obstructions and provides optimal signal coverage.

1. Attach the two silicone pads to the bracket and the pole where the device will be mounted.
2. Thread the cable ties through the fixing points on the bracket.
3. Securely fix the product to the pole using the cable ties.

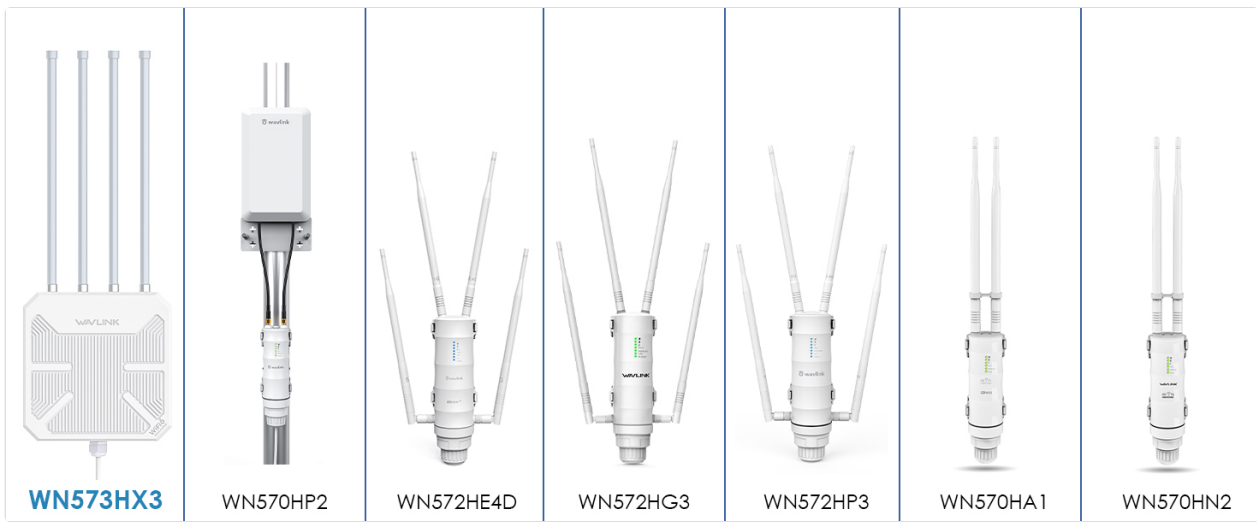

Image: Step-by-step diagram illustrating how to mount the access point to a pole using silicone pads and cable ties.

3.2 Antenna Connection

Carefully screw the four omnidirectional antennas onto the designated ports on the top of the access point. Ensure they are finger-tight to establish a secure connection.

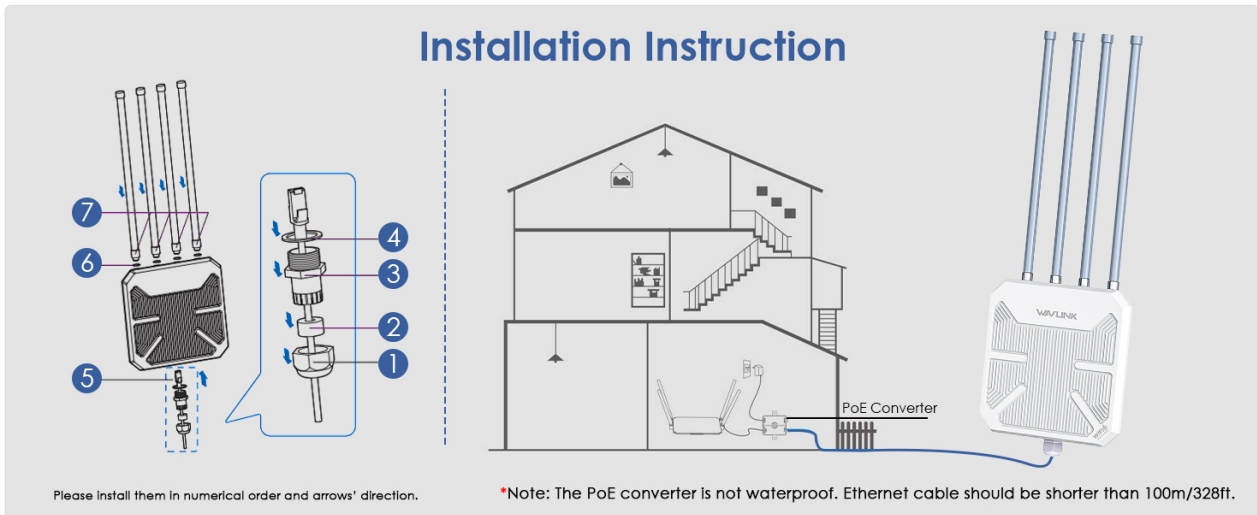

Image: Diagram showing the numerical order for installing the antennas and other components to the access point.

3.3 Power over Ethernet (PoE) Connection

The WL-WN573HX3 supports both active (802.3AF/AT) and passive PoE. This allows power and data to be transmitted through a single Ethernet cable, simplifying outdoor installation.

1. Connect one end of an Ethernet cable (CAT5E or higher, not exceeding 100m) to the Gigabit LAN port on the access point. Use the waterproof connector to seal the connection.
2. Connect the other end of the Ethernet cable to the 'PoE' port on the PoE converter/adaptor.
3. Connect another Ethernet cable from the 'LAN/DATA IN' port of the PoE converter to your router or network switch.
4. If using passive PoE, connect the 54V power adapter to the PoE converter.

Note: The PoE converter is not waterproof and must be installed indoors or in a protected enclosure.

Power over Ethernet

Supports active & passive PoE, can be flexibly deployed according to your needs

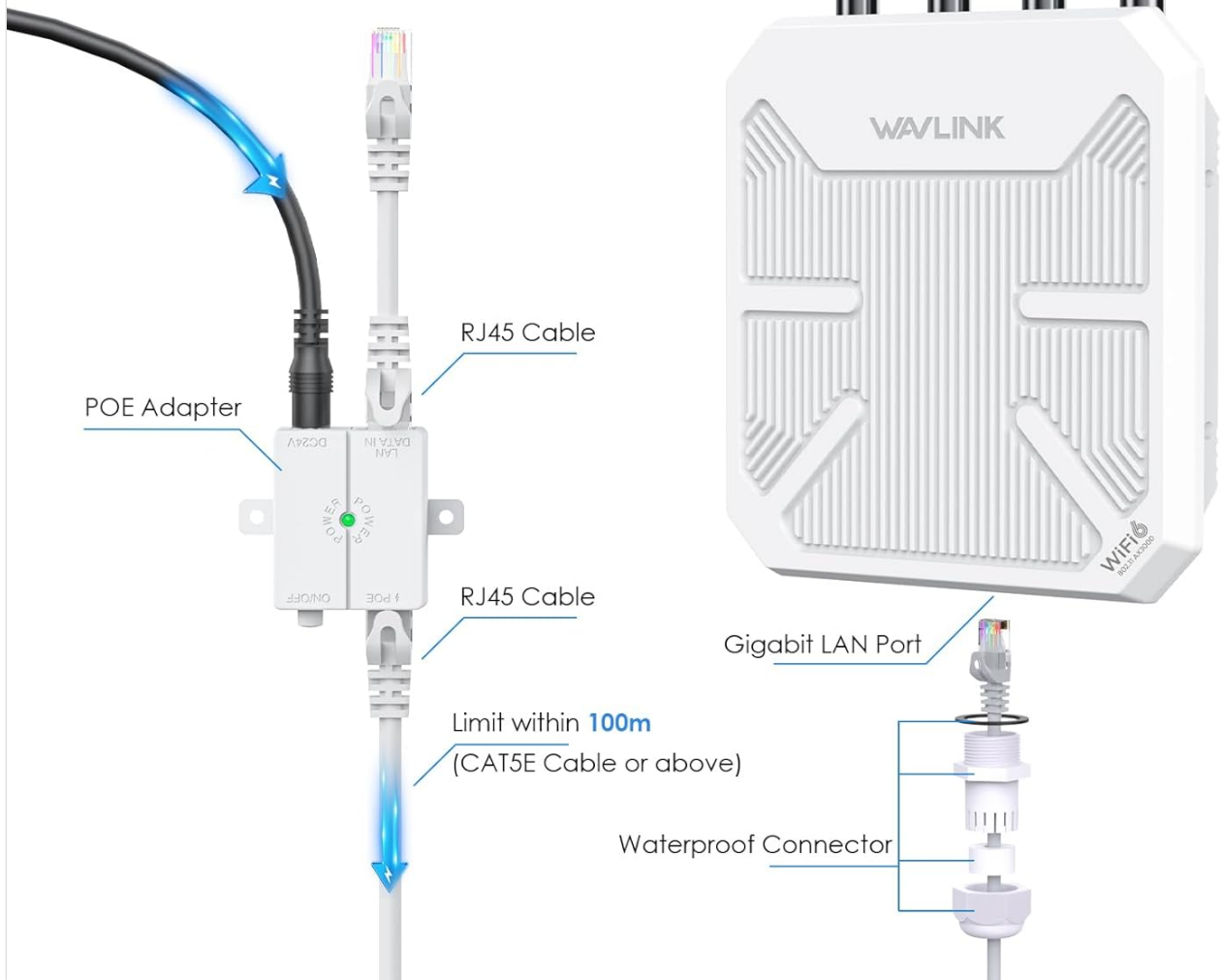

Image: Diagram illustrating the Power over Ethernet (PoE) connection, showing the Ethernet cable connecting the access point to a PoE adapter and then to a router, with a maximum cable length of 100m.

4. OPERATING MODES

The WAVLINK WL-WN573HX3 supports various operating modes to suit different network requirements:

- **Mesh Mode:** Creates a seamless WiFi network with multiple Mesh-compatible devices, providing extended coverage and a single network name.
- **AP (Access Point) Mode:** Converts a wired network connection into a wireless one, allowing wireless devices to connect.
- **Router Mode:** Functions as a primary router, managing network traffic and providing internet access.
- **Repeater Mode:** Extends the range of an existing wireless network by repeating its signal.
- **AP+Repeater Mode:** Combines the functionalities of an Access Point and a Repeater.

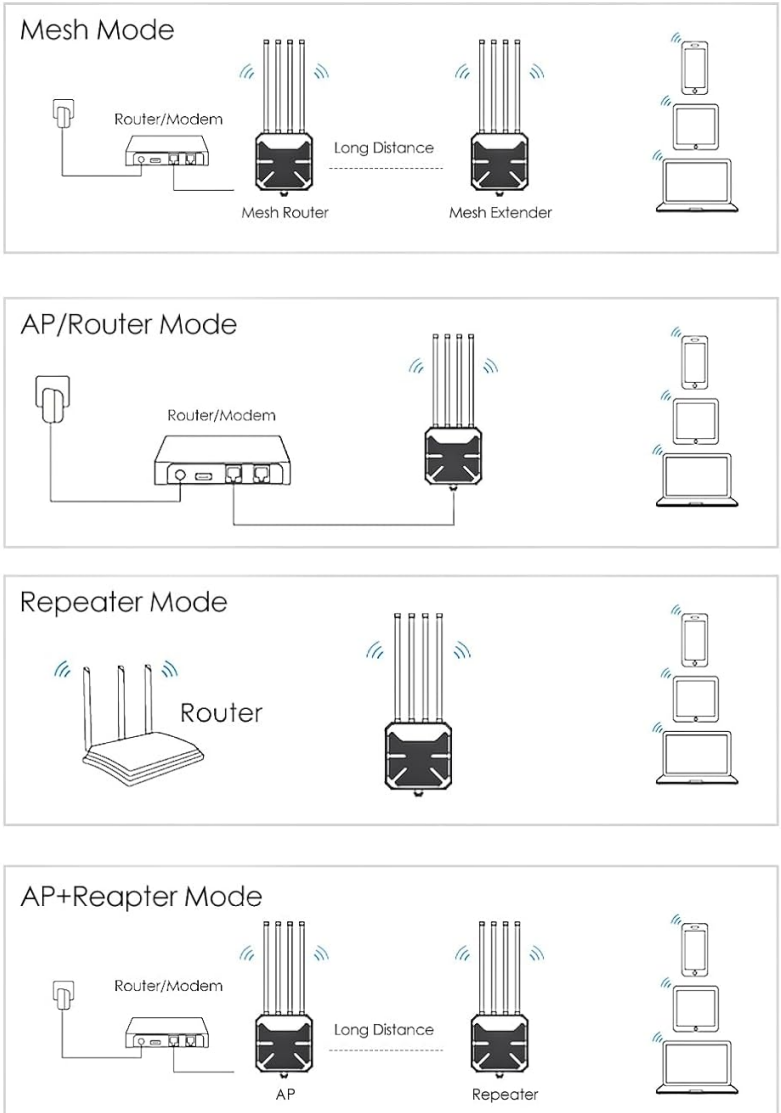

Image: Visual representation of the different operating modes: Mesh, AP/Router, Repeater, and AP+Repeater, showing how the device integrates into various network setups.

Mesh Technology Supported

Enjoy seamless and stable roaming everywhere

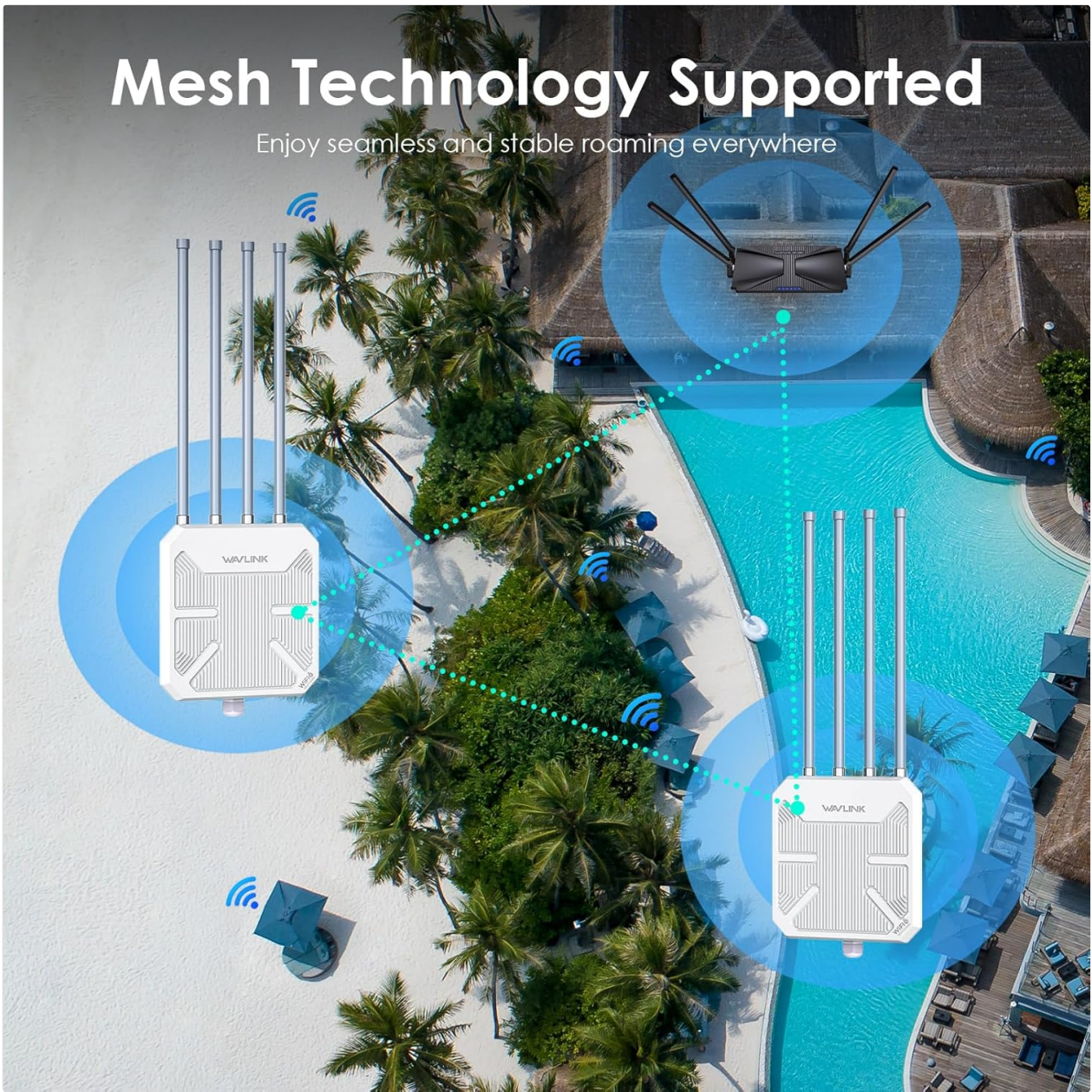

Image: An aerial view illustrating the seamless and stable roaming provided by Mesh Technology, with multiple access points covering a large outdoor area like a resort or pool.

5. INITIAL CONFIGURATION

After physical installation and power connection, configure the device via its web management interface.

1. Connect your computer to the same network as the access point (either directly via Ethernet to the PoE converter's LAN port or wirelessly if the default SSID is broadcasting).
2. Open a web browser and enter the default IP address (refer to the Quick Installation Guide for the specific IP address, typically 192.168.10.1 or similar).
3. Enter the default username and password (also found in the Quick Installation Guide).
4. Follow the on-screen setup wizard to select your desired operating mode and configure network settings such as SSID (network name) and password.
5. Save your settings and restart the device if prompted.

6. MAINTENANCE

6.1 Firmware Updates

Regularly check the WAVLINK official website for firmware updates. Firmware updates can improve performance, add new features, and enhance security. Follow the instructions provided with the firmware update package carefully.

6.2 Cleaning

Periodically inspect the device for dirt or debris, especially around the antenna connections and cable entry points. Use a soft, dry cloth to clean the exterior. Do not use liquid cleaners or solvents.

7. TROUBLESHOOTING

- **No Power:** Ensure the PoE adapter is correctly connected and receiving power. Check all Ethernet cable connections.
- **No Internet Access:** Verify that the access point is correctly connected to your main router/modem. Check your router's internet connection. Ensure the access point's operating mode is correctly configured.
- **Weak WiFi Signal:** Adjust the position of the access point and its antennas. Ensure there are no major physical obstructions. Consider adding another Mesh device if coverage is insufficient.
- **Cannot Access Web Interface:** Confirm your computer's IP address is in the same subnet as the access point. Try resetting the device to factory defaults (refer to the Quick Installation Guide for reset procedure).

8. TECHNICAL SPECIFICATIONS

Feature	Specification
Brand	WAVLINK
Model Number	WL-WN573HX3
Wireless Communication Standard	802.11ax (WiFi 6)
Data Transfer Rate	1.8 Gigabits per second (AX3000)
Frequency Band Class	Dual Band (2.4 GHz, 5 GHz)
2.4 GHz Speed	Up to 573 Mbps
5 GHz Speed	Up to 2402 Mbps
Special Features	Mesh Wi-Fi, Weather Resistant (IP67), Power over Ethernet (PoE)
Antennas	4 x 8 dBi Omni Antennas
ESD Protection	15 kV
Lightning Protection	6 kV
Compatible Devices	All Wi-Fi compatible devices
Manufacturer	Winstars Technology Limited

9. WARRANTY AND SUPPORT

Information regarding specific warranty terms and software update guarantees for the WAVLINK WL-WN573HX3 is not available in the provided product data. For detailed warranty information, technical support, or to inquire about spare parts, please refer to the official WAVLINK website or contact their customer service directly. Always retain your proof of purchase for warranty claims.