

PoolMr MY-S2-01

PoolMr Cordless Robotic Pool Cleaner User Manual

Model: MY-S2-01 | Brand: PoolMr

1. INTRODUCTION

Thank you for choosing the PoolMr Cordless Robotic Pool Cleaner. This manual provides essential information for the safe and efficient operation, maintenance, and troubleshooting of your new pool cleaner. Please read this manual thoroughly before first use and retain it for future reference.

2. PRODUCT OVERVIEW

The PoolMr Cordless Robotic Pool Cleaner is designed for efficient cleaning of flat inground and above ground pools up to 1384 sq. ft. It features a cordless design, dual motors for strong suction, and smart route technology for effective cleaning.

Key Features:

- **Cordless & Fast Cleaning:** Hassle-free operation without cables, offering a cleaning speed of 52 Ft/min.
- **Powerful Suction & Deep Cleaning:** Equipped with newly upgraded powerful dual motors providing up to 15kpa of underwater suction. Includes two cleaning scrapers and large suction ports for effective sediment removal.
- **Smart Route Tech & Self-Parking:** Precision sensors enable quick reversal upon touching pool walls, preventing damage. The cleaner stops near the wall when the cleaning cycle ends or battery is low.
- **High Filter & Safety Design:** Features a 250um fine filter to capture leaves, branches, sand, and small stones. Designed to operate only when submerged in water, ensuring electrical safety.
- **Long Lasting Battery:** 5000mAh battery provides over 140 minutes of cleaning time.

Components:

- Main Unit (Robotic Pool Cleaner)

- Fine Filter Mesh
- Hook
- Charge Adapter
- Scrapers (2)
- Direction Controller



Image: The main unit of the PoolMr Cordless Robotic Pool Cleaner, dark black with blue accents, shown with water splashes.



Image: A visual representation of all included components: the main cleaner unit, fine filter mesh, hook, charge adapter, two scrapers, and a direction controller.

3. SETUP

The PoolMr Robotic Pool Cleaner is designed for easy assembly and setup. Follow these steps to prepare your cleaner for first use:

1. **Charge the Unit:** Before initial use, fully charge the robotic pool cleaner using the provided charge adapter. The charging time is approximately 3 hours.
2. **Install Scrapers:** Attach the two cleaning scrapers to the designated slots on the bottom of the cleaner. Ensure they are securely fastened.
3. **Prepare for Deployment:** Ensure the pool cleaner is fully assembled and the filter is clean and properly installed.



Image: Three steps illustrating easy installation: 1) Attaching the direction controller, 2) Securing the bottom plate, and 3) Placing the cleaner into the pool.

4. OPERATING INSTRUCTIONS

Operating your PoolMr Robotic Pool Cleaner is straightforward:

1. **Power On:** Locate the power switch on the unit and turn it on.
2. **Submerge:** Gently place the cordless pool vacuum into the water. The unit will begin its cleaning cycle automatically once submerged.
3. **Cleaning Cycle:** The cleaner will navigate your pool, utilizing its smart route technology to cover the entire flat surface. It will reverse direction upon contact with pool walls.
4. **Self-Parking:** Once the cleaning cycle is complete or the battery is low, the cleaner will automatically move to the nearest wall for easy retrieval.
5. **Retrieval:** Use the provided hook to safely retrieve the cleaner from the pool.

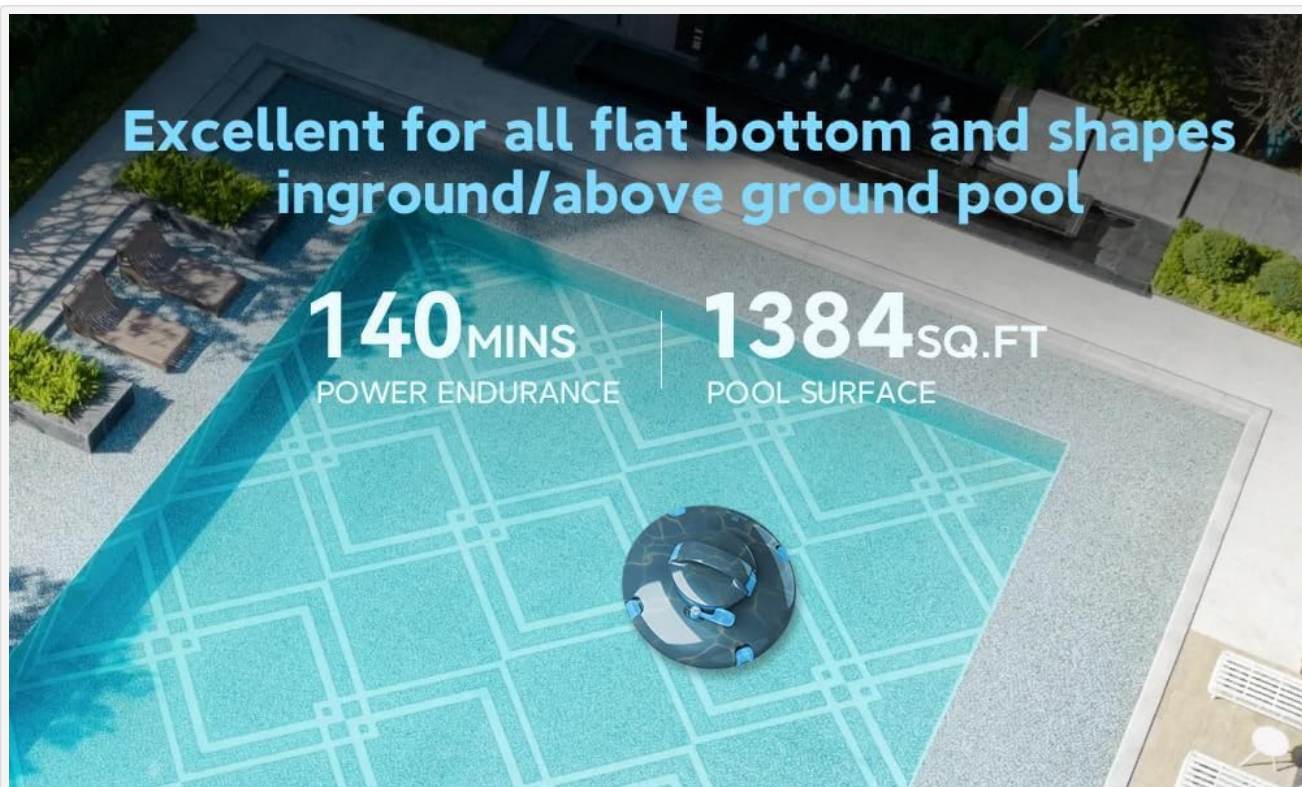

Image: The PoolMr Robotic Pool Cleaner operating in a large inground pool, demonstrating its coverage for various pool types and sizes.

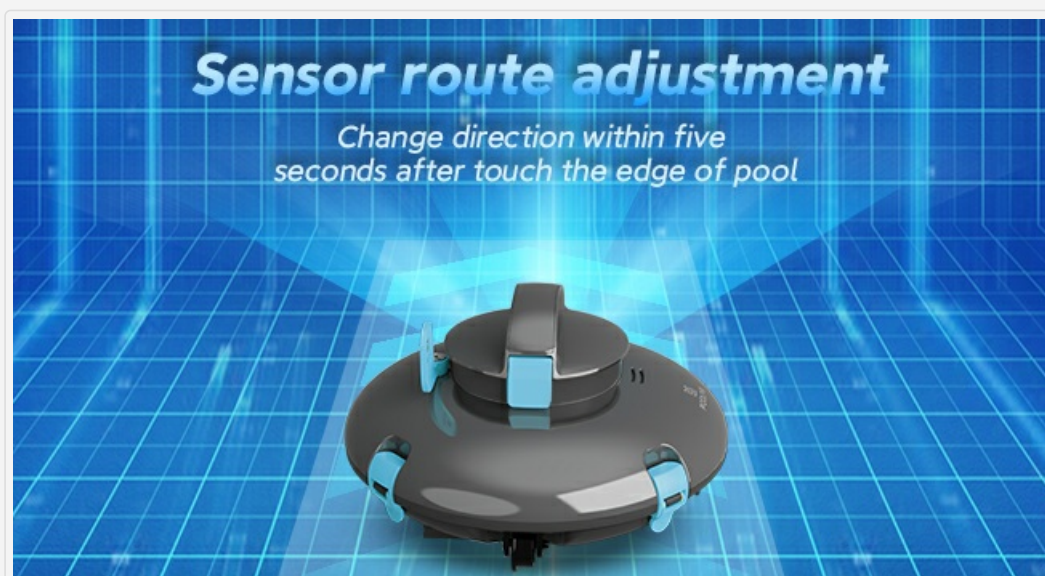

Image: The robotic cleaner changing direction within 5 seconds after touching the edge of the pool, illustrating its smart route

adjustment feature.

5. MAINTENANCE

Regular maintenance ensures optimal performance and longevity of your PoolMr Robotic Pool Cleaner:

1. **Clean the Filter:** After each cleaning cycle, remove the fine filter mesh and rinse it thoroughly with water to remove collected debris. Ensure the filter is completely clean before re-installing.
2. **Inspect Scrapers:** Check the cleaning scrapers for wear or damage. Replace if necessary to maintain effective cleaning.
3. **Store Properly:** When not in use, store the cleaner in a cool, dry place away from direct sunlight and extreme temperatures.
4. **Battery Care:** Do not leave the battery completely discharged for extended periods. Charge it periodically even during off-season storage.



Image: A hand holding the fine filter mesh under running water, demonstrating the ease of cleaning the filter to remove debris.

Easy to install

Easy to handle in just three steps

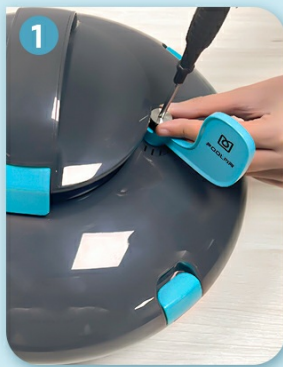

Image: A four-step visual guide showing the deep cleaning process: 1) Retrieving the cleaner, 2) Opening the unit to access the filter, 3) Rinsing the filter, and 4) Reassembling the cleaner.

6. TROUBLESHOOTING

If you encounter issues with your PoolMr Robotic Pool Cleaner, refer to the following common problems and solutions:

Problem	Possible Cause	Solution
Cleaner not moving or stuck.	Low battery, debris caught in wheels/motors, uneven pool surface.	Charge the unit. Clear any obstructions. Ensure pool surface is flat as recommended.
Poor cleaning performance.	Clogged filter, worn scrapers, insufficient charge.	Clean the filter thoroughly. Check and replace scrapers if needed. Ensure unit is fully charged.
Unit does not turn on.	Battery not charged, power switch off, unit not submerged.	Charge the battery. Ensure power switch is in the 'ON' position. The unit activates only when submerged in water.
Debris leaks out when removing from pool.	Filter flaps not closing properly.	Ensure the filter assembly is correctly seated and the flaps are free from obstruction. Remove the cleaner slowly and carefully.

7. SPECIFICATIONS

Specification	Detail
Model Number	MY-S2-01
Power Source	Battery Powered
Battery Capacity	5000mAh (55.5 Watt Hours)
Run Time	Up to 140 minutes
Charging Time	3 Hours

Specification	Detail
Cleaning Speed	52 Ft/min
Max Pool Area	1384 sq. ft.
Max Water Depth	8.2 Ft
Suction Power	Up to 15kpa
Filter Precision	250um
Waterproof Rating	IPX8
Item Weight	7.2 Pounds (3.27 kg)
Product Dimensions	13.78 x 13.78 x 7.78 inches
Material	Acrylonitrile Butadiene Styrene (ABS)
Control Method	Touch

8. WARRANTY AND SUPPORT

PoolMr offers a one-year free return and exchange policy on all products. We are committed to continuous improvements in quality and performance and aim to address any customer concerns promptly and professionally. Your satisfaction is our top priority.



For further assistance or inquiries, please refer to your purchase documentation or contact PoolMr customer support.

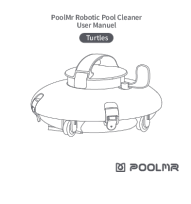
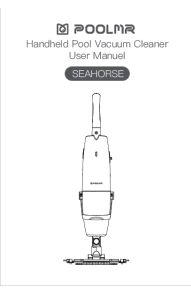

© 2024 PoolMr. All rights reserved.

Related Documents - MY-S2-01

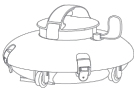
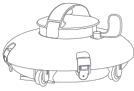
	<p>PoolMr Robotic Pool Cleaner User Manual</p> <p>User manual for the PoolMr Robotic Pool Cleaner, model Turtles (YM-S2-03, YM-S2-01). This guide provides instructions on product introduction, parameters, pre-use notes, operation, cleaning, and FAQs.</p>
	<p>POOLMR SEAHORSE Handheld Pool Vacuum Cleaner User Manual</p> <p>Comprehensive user manual for the POOLMR SEAHORSE handheld pool vacuum cleaner, providing instructions for use, charging, maintenance, and troubleshooting. Learn how to effectively clean your pool or spa.</p>

<div><div>Lydsto Robotic Pool Cleaner S2</div><div>Manuel</div><div></div><div>Lydsto</div></div>	<div><div>Lydsto Robotic Pool Cleaner S2 User Manual</div><div>Comprehensive user manual for the Lydsto Robotic Pool Cleaner S2, covering setup, operation, maintenance, and troubleshooting for efficient pool cleaning.</div></div>
<div><div>Lydsto Robotic Pool Cleaner</div><div>User Manual</div><div>P1 MINI PRO</div><div></div><div>Lydsto</div></div>	<div><div>Lydsto P1 MINI PRO Robotic Pool Cleaner User Manual</div><div>User manual for the Lydsto P1 MINI PRO robotic pool cleaner, detailing setup, operation, cleaning, parameters, and troubleshooting for efficient pool maintenance.</div></div>
<div><div>Robotic Pool Cleaner</div><div>User Manual</div><div></div><div>WYBOT</div></div>	<div><div>WYBOT S2 Solar Vision Robotic Pool Cleaner User Manual</div><div>Comprehensive user manual for the WYBOT S2 Solar Vision Robotic Pool Cleaner, covering setup, operation, safety warnings, maintenance, and troubleshooting. Includes product overview and specifications.</div></div>