

Idatalink HRN-SR-VW2

Idatalink Maestro HRN-SR-VW2 T-Harness Instruction Manual

Model: HRN-SR-VW2

1. INTRODUCTION AND OVERVIEW

The Idatalink Maestro HRN-SR-VW2 T-Harness is designed to facilitate the replacement of a factory radio with an aftermarket head unit in select Volkswagen vehicles manufactured between 2016 and 2020. This harness works in conjunction with the Idatalink Maestro ADS-MSR module (sold separately) to retain essential factory features such as steering wheel controls and the use of the factory amplifier. This manual provides detailed instructions for the proper installation and understanding of the HRN-SR-VW2 T-Harness, ensuring seamless integration with your vehicle's existing systems.

2. PRODUCT FEATURES

- **Simplified Installation:** Designed to simplify radio replacement in compatible Volkswagen vehicles when used with the iDatalink Maestro ADS-MSR module.
- **Steering Wheel Control Retention:** Retains original steering wheel controls for functions like volume adjustment and track seeking with an aftermarket radio.
- **Factory Amplifier Retention:** Maintains functionality of the factory amplifier, including turn-on, fader, and gain control.
- **Backup Camera Retention:** Retains the factory backup camera with parking guidelines.
- **Retained Accessory Power (RAP):** The vehicle's Retained Accessory Power feature is maintained.
- **Navigation Outputs:** Provides outputs for Parking Brake, Reverse Light, and Vehicle Speed Sense (VSS) for aftermarket navigation systems.
- **Accessory Power Output:** Offers a 12V/15A accessory power output.
- **Illumination Output:** Provides an illumination output for aftermarket head units.

3. COMPATIBILITY

The HRN-SR-VW2 T-Harness is compatible with the following Volkswagen vehicles when used in conjunction with the iDatalink Maestro ADS-MSR module:



Image 3.1: Compatibility chart showing supported Volkswagen models and years (2016-2020) for the HRN-SR-VW2 T-Harness. Models include Beetle, CC, Jetta, Jetta GLI, Passat, Tiguan, and Tiguan Limited.

Please refer to the chart above for specific model and year compatibility. An iDatalink Maestro ADS-MSR module is required for full functionality.

4. INSTALLATION REQUIREMENTS

Successful installation of the HRN-SR-VW2 T-Harness requires the following components (sold separately):

- **iDatalink Maestro ADS-MSR Module:** This interface module is essential for retaining factory features and communicating with the vehicle's systems.
- **Corresponding iDatalink Maestro Car Stereo Head-Unit ACC-HU Series T-Harness:** A specific head-unit harness is required to connect the Maestro module to your aftermarket radio. Examples include:
 - ACC-HU-ALP1 (Alpine)
 - ACC-HU-PIO1 (Pioneer)
 - ACC-HU-SON1 (Sony)

- ACC-HU-KEN1 (Kenwood/JVC with 22-Pin Connector)
- ACC-HU-KEN2 (Kenwood/JVC with 16-Pin Connector)
- ACC-HU-KEN3 (2024 & Newer Kenwood/JVC with 22-Pin Connector)
- ACC-HU-BOS1 (BOSS Radio)



Image 4.1: Display of various Idatalink Maestro ACC-HU series head unit specific harnesses, which are required to connect the Maestro module to different brands of aftermarket radios.



Image 4.2: An overview of Idatalink Maestro vehicle-specific T-harnesses, illustrating how they simplify the installation process. The HRN-SR-VW2 is part of this series.

5. SETUP AND INSTALLATION GUIDE

Important: Before beginning installation, ensure your iDataLink Maestro ADS-MSR module is flashed with the correct firmware using the Weblink Desktop application. Refer to the ADS-MSR module's instruction manual for detailed flashing procedures.



Image 5.1: The iDataLink Maestro HRN-SR-VW2 T-Harness, shown with its packaging, illustrating the main components of the product.

 VOLKSWAGEN	2020	2019	2018	2017	2016
Beetle All	✓	✓	✓	✓	✓
CC All				✓	✓
Jetta All			✓	✓	✓
Jetta GLI All			✓	✓	✓
Passat All		✓	✓	✓	✓
Tiguan All				✓	✓
Tiguan Limited All			✓		

Image 5.2: A detailed view of the HRN-SR-VW2 T-Harness, highlighting the various connectors and labeled wires for proper connection.

Installation Steps:

- 1. Disconnect Vehicle Battery:** Always disconnect the negative terminal of your vehicle's battery before starting any electrical work to prevent short circuits or damage.
- 2. Remove Factory Radio:** Carefully remove the factory radio from the dashboard. Refer to your vehicle's service manual for specific instructions on radio removal.
- 3. Connect HRN-SR-VW2 T-Harness:**
 - Connect the vehicle-specific connector of the HRN-SR-VW2 T-Harness to the corresponding harness in your Volkswagen vehicle.
 - Connect the other end of the HRN-SR-VW2 T-Harness to the iDatalink Maestro ADS-MSR module.
- 4. Connect Head-Unit Specific Harness:** Connect the appropriate ACC-HU series harness (e.g., ACC-HU-ALP1 for Alpine) to the iDatalink Maestro ADS-MSR module.
- 5. Connect Aftermarket Radio:** Connect the head-unit specific harness to your aftermarket radio. Ensure all connections are secure.
- 6. Wire Connections (if applicable):** If your aftermarket radio requires additional connections not covered by the plug-and-play harnesses (e.g., parking brake, reverse, VSS for navigation), utilize the labeled wires on the HRN-SR-VW2 T-Harness.
- 7. Test Connections:** Before reassembling the dashboard, temporarily reconnect the vehicle battery and test the functionality of the aftermarket radio, steering wheel controls, factory amplifier, and backup camera.
- 8. Secure Wiring and Reassemble:** Once all functions are verified, neatly secure all wiring to prevent

rattles or interference. Reassemble the dashboard components.

9. **Final Check:** Perform a final check of all retained features and radio functions.

For detailed wiring diagrams and specific vehicle integration instructions, please visit the official iDatalink Maestro website: [iDatalink Maestro Support](#)

6. OPERATING RETAINED FEATURES

Once the HRN-SR-VW2 T-Harness and ADS-MSR module are correctly installed and configured, the following factory features will operate with your aftermarket radio:

- **Steering Wheel Controls:** The buttons on your steering wheel will control basic functions of your aftermarket radio, such as volume up/down, track forward/back, and mode selection. Specific button assignments may be configurable through the aftermarket radio's settings or the Maestro module's programming.
- **Factory Amplifier:** The factory amplifier will power your vehicle's speakers. Fader and gain controls will typically be managed through the aftermarket radio's audio settings.
- **Backup Camera:** When the vehicle is shifted into reverse, the factory backup camera image will display on your aftermarket radio screen, complete with parking guidelines.
- **Retained Accessory Power (RAP):** The aftermarket radio will remain powered for a short period after the ignition is turned off, similar to the factory radio's behavior, until a door is opened.

7. TROUBLESHOOTING

If you encounter issues after installation, consider the following troubleshooting steps:

- **No Power to Radio:**
 - Check all power connections to the aftermarket radio and the Maestro module.
 - Ensure the vehicle battery is fully charged and properly connected.
 - Verify that the ADS-MSR module is correctly flashed and powered.
- **Steering Wheel Controls Not Working:**
 - Confirm the ADS-MSR module is flashed with the correct firmware for your vehicle and aftermarket radio.
 - Check the connection between the HRN-SR-VW2, ADS-MSR module, and the head-unit specific harness.
 - Consult the aftermarket radio's manual for steering wheel control setup options.
- **No Sound or Distorted Audio:**
 - Verify all speaker connections are secure and correctly polarized.
 - Ensure the factory amplifier is receiving power and turn-on signal from the Maestro module.
 - Check the audio output settings on your aftermarket radio.
- **Backup Camera Not Displaying:**
 - Confirm the camera input is correctly connected to the aftermarket radio.
 - Ensure the reverse trigger wire from the HRN-SR-VW2 is connected to the aftermarket radio's reverse input.
 - Verify the ADS-MSR module is configured to retain the factory camera.

For further assistance, refer to the iDatalink Maestro support resources or contact their technical support.

8. SPECIFICATIONS

Model Number	HRN-SR-VW2
Brand	Idatalink Maestro
Compatibility	Select Volkswagen Vehicles (2016-2020)
Required Module	iDatalink Maestro ADS-MSR (Sold Separately)
Material	Acrylonitrile Butadiene Styrene
Product Dimensions	7 x 4.75 x 1.5 inches
Item Weight	0.13 Kilograms (4.59 ounces)
Connector Type	OBD-II, Volkswagen-specific Connectors

9. WHAT'S IN THE BOX

The HRN-SR-VW2 package includes:

- 1x Idatalink Maestro HRN-SR-VW2 T-Harness



Please ensure all components are present upon opening the package.

10. SUPPORT AND WARRANTY

For technical support, detailed wiring diagrams, or additional information regarding the iDatalink Maestro HRN-SR-VW2 T-Harness, please visit the official iDatalink Maestro website or contact their customer service department.

Warranty information is typically provided with the product packaging or available on the manufacturer's official website. Please retain your proof of purchase for warranty claims.



	<p>iDatalink Maestro RR Install Guide for Volkswagen Arteon</p> <p>Comprehensive installation guide for the iDatalink Maestro RR and HRN-HRR-VW2 harness in 2019-2023 Volkswagen Arteon vehicles without an amplifier. This guide details wiring, connections, and troubleshooting for retaining steering wheel controls, factory amplifier, and analog outputs.</p>
	<p>iDatalink Maestro RR Install Guide for Mazda 3</p> <p>Comprehensive installation guide for the iDatalink Maestro RR and RR2 radio replacement interfaces for Mazda 3 (2014-2017 and 2018 models with amplifier). Includes wiring diagrams, troubleshooting, and module diagnostics.</p>
	<p>iDatalink Maestro RR2 Installation Guide for Subaru Vehicles</p> <p>Comprehensive installation guide for the iDatalink Maestro RR2 Radio Replacement Interface and HRN-RR-SU3 harness, covering 2017-2020 Subaru models. Learn how to retain steering wheel controls, factory amplifier, and more.</p>
	<p>iDatalink Maestro RR Installation Guide for Mazda Vehicles</p> <p>Detailed installation guide for iDatalink Maestro RR and RR2 radio replacement interfaces in various Mazda models, ensuring retention of steering wheel controls and factory vehicle settings.</p>
	<p>iDatalink Maestro RR Install Guide for Chrysler 300</p> <p>Comprehensive installation guide for the iDatalink Maestro RR and RR2 radio replacement interfaces for Chrysler 300 models from 2015-2019. Includes wiring diagrams, troubleshooting, and compatibility information.</p>
	<p>iDatalink Maestro RR Installation Guide for GM Vehicles</p> <p>Comprehensive installation guide for the iDatalink Maestro RR and RR2 radio replacement interfaces, detailing how to retain factory features like steering wheel controls, OnStar, and Bluetooth in various GM vehicles. Includes wiring diagrams, troubleshooting, and setup instructions.</p>



[\[pdf\]](#) User Manual Owner's Manual Installation Guide Guide

794HSRVW2 iDatalink HRN SR VW2 SWV2 Maestro GM Harness 2014 up Volkswagen select models
CRUTCHFIELD COM HNEWBERRY Vehicle specific owner s manual ADS MSR module also required
Connect a new car stereo and retain steering wheel controls factory amp in 2016 19 vehicles at
Crutchfield crutchfieldonline ImageBank v20240507130000 Manuals 794 |||

SELECT VEHICLE PRINT PAGES NEEDED HOW TO USE THIS INSTALL GUIDE 1

Open the Bookmarks menu and find your vehicle OR scroll down until you find the
install guide for your vehicle. 2 Print only the pages for your vehicle using the
advanced options in the Print menu. 3 Install your Maestro SR according ...
lang:en score:32 filesize: 1.92 M page_count: 100 document date: 2024-05-07

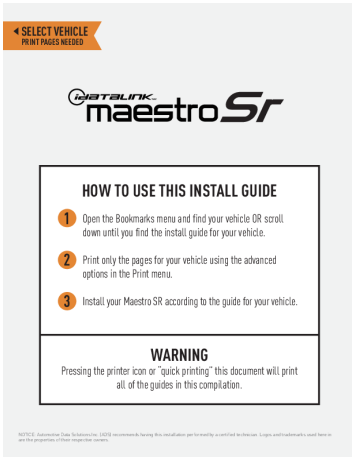

[\[pdf\]](#) User Manual Owner's Manual Installation Guide Guide

794HSRVW2 iDatalink HRN SR VW2 SWV2 Maestro GM Harness 2014 up Volkswagen select models
CRUTCHFIELD COM HNEWBERRY Vehicle specific owner s manual ADS MSR module also required
Connect a new car stereo and retain steering wheel controls factory amp in 2016 19 vehicles at
Crutchfield crutchfieldonline ImageBank v20240621114700 Manuals 794 |||

SELECT VEHICLE PRINT PAGES NEEDED HOW TO USE THIS INSTALL GUIDE 1

Open the Bookmarks menu and find your vehicle OR scroll down until you find the
install guide for your vehicle. 2 Print only the pages for your vehicle using the
advanced options in the Print menu. 3 Install your Maestro SR according ...
lang:en score:32 filesize: 1.92 M page_count: 100 document date: 2024-06-21