

100 BALANCE 100BALANCE 150A 8S-24S

100BALANCE BMS 150A Active Balance 8S-24S Smart Battery Protection Board

USER MANUAL

Model: 100BALANCE 150A 8S-24S | Brand: 100 BALANCE

1. Introduction

The 100BALANCE BMS (Battery Management System) is an intelligent active balance battery protection board designed for Li-ion, LiFePO₄, and LTO lithium battery packs. It provides comprehensive protection and management to ensure the safety and longevity of your battery system. This manual provides detailed instructions for installation, operation, and maintenance.

Key Features:

- **Enhanced Battery Safety:** Offers protection against overcharging, over-discharging, overcurrent, short circuits, and extreme temperatures.
- **Extra Protection Features:** Includes pre-charge protection, wrong connection/missing connection detection, parallel connection current limiting, and cell balancing.
- **Smart Battery Management:** Manage your battery easily with the Android or iOS mobile app. Bluetooth connectivity allows you to monitor status, adjust settings, and control charge/discharge from your device.
- **Active Balancing:** Features continuous 1A active balancing current for efficient cell equalization.
- **Wide Voltage Compatibility:** Compatible with 8S-24S battery packs, supporting 24V, 36V, 48V, 60V, 72V, and 84V systems.



Figure 1: 100BALANCE BMS 150A Active Balance 8S-24S Smart Battery Protection Board.

2. Specifications

General Specifications:

Attribute	Value
Brand	100 BALANCE
Model Number	100BALANCE 150A 8S-24S
Item Weight	1.1 Pounds
Input Voltage	100 Volts
Plug Format/Type	Type B
Manufacturer	Dongguan Balanced Management Technology Co., Ltd

Warranty

1 year

Performance Parameters:





Option	BMS Type	Accessories 1	Accessories 2	BMS Set	Example	Photo
1	BT BMS	+ WIFI Module		= BT Wifi BMS	4-8s 100A BT WIFI BMS	
2	BT CAN BMS	+ WIFI Module		= BT CAN Wifi BMS	4-8s 100A BT CAN WIFI BMS	
3	BT CAN BMS	+ WIFI Module	+ Rs485 3.0 LCD Display	= BT CAN Wifi 3.0 display BMS	4-8s 100A BT CAN Wifi 3.0 display BMS	
4	BT CAN BMS	+ WIFI Module	+ Rs485 4.3 LCD Display	= BT CAN Wifi 4.30 display BMS	4-8s 100A BT CAN Wifi 4.30 display BMS	
5	BT CAN BMS	+ WIFI Module	+ Inverter Cable	= BT CAN Inverter BMS	4-8s 100A BT CAN Inverter BMS	

Figure 2: Basic specifications of the BMS.



Figure 3: Current parameter correspondence table for various models.



Product Specification

【Intelligent strings 4~8S/8~17S/8~24S,
Continuous current 150A】



*Li-ion: 4~8S/8~17S/8~20S | Lifepo4: 4~8S/8~17S/8~24S
LTO: 6~8S/8~17S/8~24S

*Data tolerance range $\pm 0.5\text{mm}$.

Figure 4: Product dimensions and battery compatibility details.

3. Package Contents

The standard package for the 100BALANCE BMS includes the following items:

- Smart active balance BMS (x1)
- P-&B- cable (x1)
- Sampling cable (x1)
- B+ cable (x1)
- NTC (x1)

- Key switch cable (x1)
- Screws (x2)
- User Manual (x1)
- Packaging box (x1)

Note: RS485/CAN port cable and WiFi Module are standard only for BT RS485/CAN version BMS.



Figure 5: Contents included in the 100BALANCE BMS package.

4. Setup and Wiring Installation

Proper wiring is crucial for the safe and correct operation of the BMS. Please follow these instructions carefully.

Wiring Steps:

1. **Prepare Battery Pack:** Ensure your battery pack is assembled with total positive and total negative terminals clearly identified.
2. **Connect B- and P- Cables:** Connect the black B- cable to the total negative terminal of the battery pack. Connect the red P- cable to the positive terminal of the first string.
3. **Connect Sampling Wires:** Carefully connect the sampling wires to each cell in the correct sequence, starting from B0 (negative) to B+ (positive). Ensure each wire is soldered securely.
4. **Seal Excess Cables:** If using a BMS with fewer strings than the maximum supported (e.g., 8S BMS with a 17S sampling cable), seal any unused sampling cables with insulation tape to prevent short circuits.
5. **Verify Voltage:** Use a multimeter to measure the voltage across the wiring harness to ensure consistency and correctness before plugging into the BMS.
6. **Connect NTC Cable:** Plug the NTC (Negative Temperature Coefficient) cable into the NTC-A port on the BMS.
7. **Connect Sampling Harness to BMS:** Insert the sampling wire harness into the designated port on the BMS.

Important: Miswiring protection is limited to 6 strings. Connecting more than 6 strings incorrectly can damage your BMS. Always follow the wiring sequence strictly. If the wiring sequence is reversed, it will lead to BMS damage.



Support simultaneous multi-channel communication

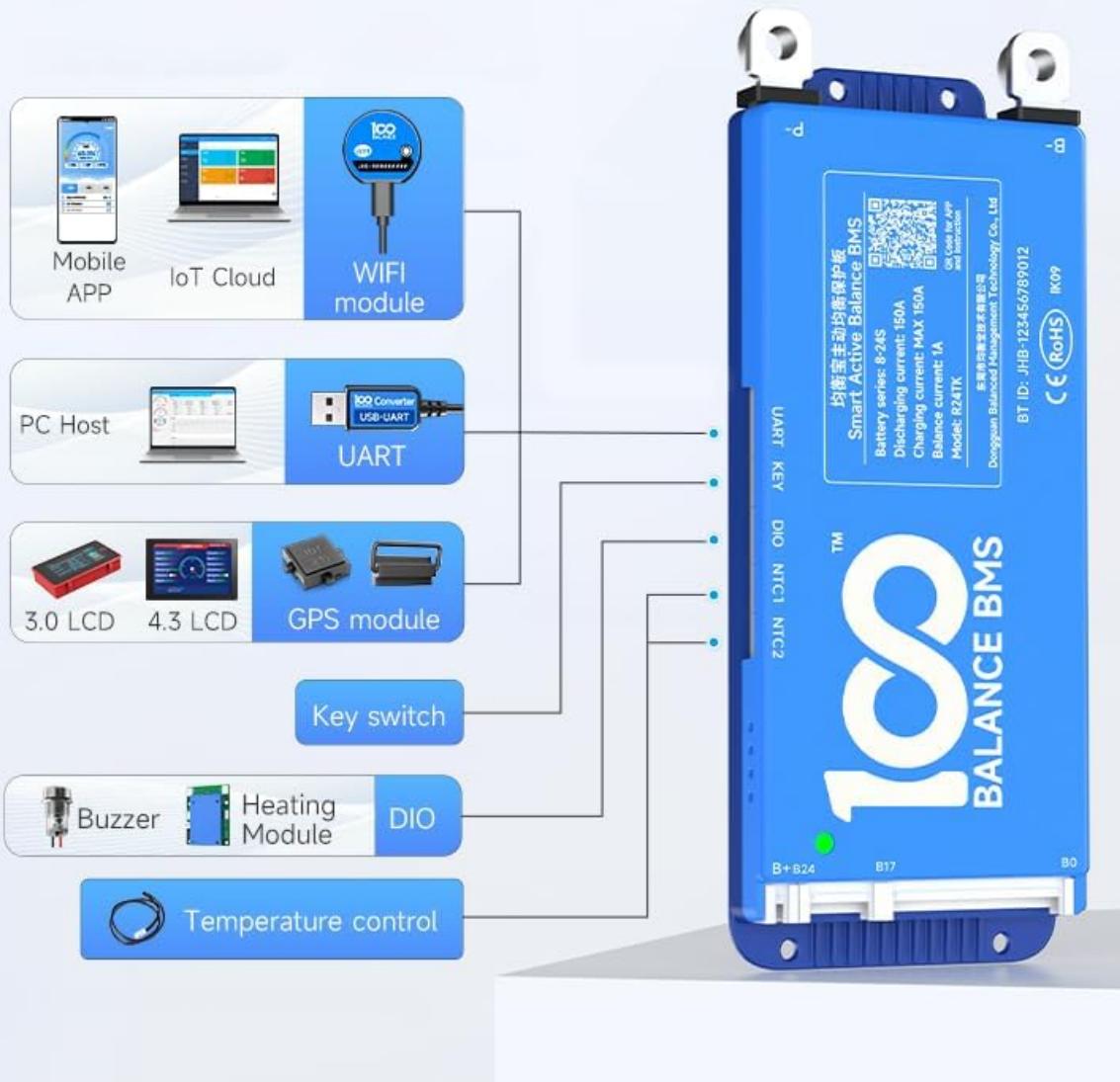

Figure 6: General wiring diagram for the BMS.

Specification parameter

1. Basic specification

Index	Specification
Battery pack type	Li-ion, LifePO4, LTO
Number of battery strings	Li-ion: 4-8S/8-17S/8-20S LifePO4: 4-8S/8-17S/8-24S LTO: 6-8S/8-17S/8-24S
Cell sampling voltage range	1.5V-4.9V
Operating voltage range	> 10V
Balance method	Active Balance
Working power consumption	≤1W
Sleep current	≤1.5mA
Working temperature	-40°C ~ 85°C
Indicator light	Green: works properly Red: Alarm or protection
Product size	167.5*65.5*15mm (40A/60A/80A/100A) 176.5*65.6*16mm (150A)

2. Current parameter correspondence table

Model	Compatible Strings	Continuous Discharge current	Max Discharge current	Continuous charge current	Max charge current
R24TK1A-8S 40A	4-8	40A	60A	40A	40A
R24TK1A-8S 60A	4-8	60A	90A	60A	60A
R24TK1A-8S 80A	4-8	80A	120A	80A	80A
R24TK1A-8S 100A	4-8	100A	150A	100A	100A
R24TM1A-8S 150A	4-8	150A	225A	150A	150A
R24TK1A-17S 40A	8-17	40A	60A	40A	40A
R24TK1A-17S 60A	8-17	60A	90A	60A	60A
R24TK1A-17S 80A	8-17	80A	120A	80A	80A
R24TK1A-17S 100A	8-17	100A	150A	100A	100A
R24TK1A-17S 150A	8-17	150A	225A	150A	150A
R24TK1A-24S 40A	8-24	40A	60A	40A	40A
R24TK1A-24S 60A	8-24	60A	90A	60A	60A
R24TK1A-24S 80A	8-24	80A	120A	80A	80A
R24TK1A-24S 100A	8-24	100A	150A	100A	100A
R24TK1A-24S 150A	8-24	150A	225A	150A	150A

Figure 7: Close-up view of BMS wiring connections.

Your browser does not support the video tag.

Video 1: This video provides an introduction to the 100BALANCE Smart Active Balance BMS and demonstrates the wiring process for battery packs.

5. Operation

The 100BALANCE BMS offers multiple ways to monitor and manage your battery pack, including a mobile app and PC host software.

5.1 Mobile App Operation

The mobile app allows for convenient monitoring and parameter adjustment via Bluetooth. Download the 'Balance BMS' app from your device's app store. Once installed, connect to your BMS via Bluetooth to view real-time battery data, including total voltage, current, temperature, SOC (State of Charge), cell voltages, and alarm information. You can also adjust various protection parameters and balancing settings.

5.2 PC Host Software Operation

For more detailed monitoring and advanced settings, use the PC host software. This requires a UART, RS485, or CAN communication cable (depending on your BMS version and accessories).

1. **Download PC Host Software:** Visit the official 100BALANCE website or contact customer service for the PC host software and necessary drivers (UART/RS485/CAN).
2. **Connect BMS to PC:** Connect the appropriate communication cable (e.g., UART cable) from the BMS to your PC.
3. **Launch Software:** Open the PC host software. Select the correct communication port (COM port for UART/RS485, or CAN settings) and baud rate (e.g., 9600 for UART/RS485, 250 for CAN).
4. **Monitor Data:** The 'Live Data' screen displays real-time battery information.
5. **Set Parameters:** Access the 'Set Param' page to modify balance current, sleep time, rated capacity, and protection parameters. You may need to enter a default password (e.g., 20211115) to enter management mode.
6. **Engineering Interface:** The 'Engineering' interface allows for current calibration to improve data accuracy and control various switches (charge, discharge, fan).
7. **History Data:** View battery alarm information on the 'His Data' page. You can read historical faults and clear history data.
8. **BMS Upgrade:** Use the 'BMS Upgrade' section to update the BMS firmware by loading the upgrade file and starting the process.

Support simultaneous multi-channel communication

Fulfill multiple communication requirement

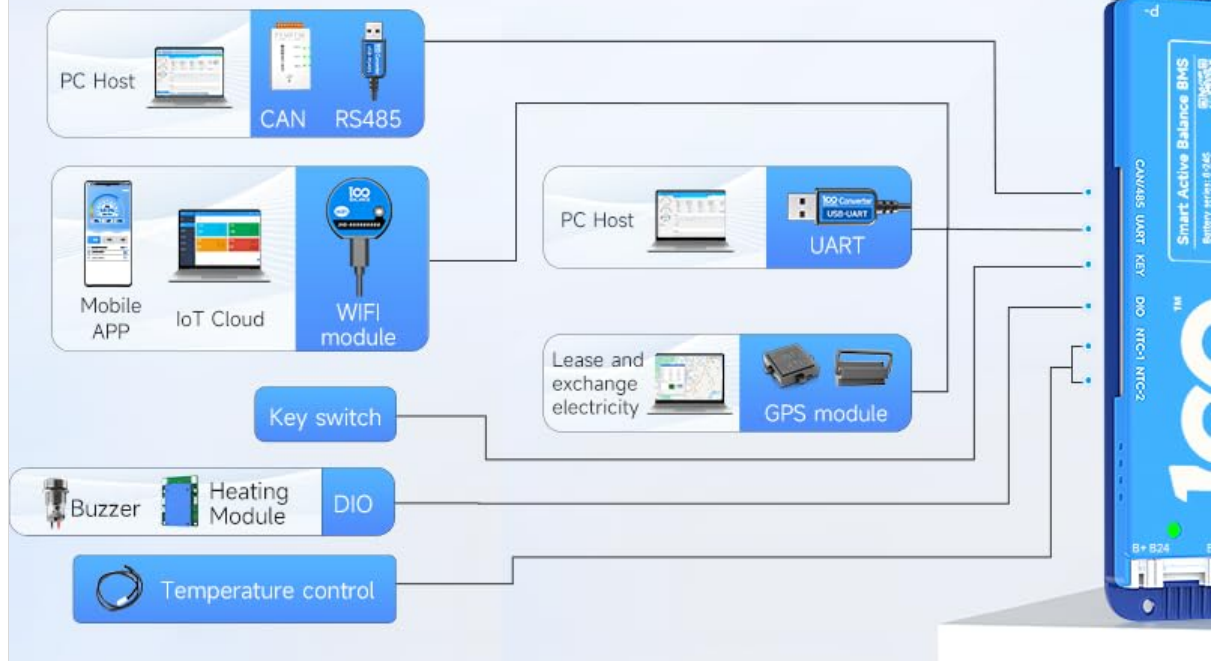

Figure 8: BMS supports simultaneous multi-channel communication including Mobile APP, PC Host, IoT Cloud, WiFi, GPS, and various modules.

Your browser does not support the video tag.

Video 2: This video demonstrates how to connect the 100BALANCE Smart BMS to the PC host software and navigate its interface.

6. Optional Accessories

The 100BALANCE BMS supports various optional accessories to extend its functionality:

- **UART Cable:** For PC connection and communication.
- **RS485 Cable:** For PC connection and communication, often used for longer distances or industrial applications.
- **CAN BUS:** For PC connection and communication, commonly used in automotive and industrial control systems.
- **WiFi Module:** Enables remote monitoring and control via IoT cloud.
- **LCD Display (3.0 inch / 4.3 inch Touch Display):** Provides real-time battery information and allows parameter changes directly on the display.
- **Heating Module:** Used in cold environments to pre-heat the battery pack, ensuring optimal performance.
- **Key Switch Button:** Can be used to switch the discharge MOSFET on and off.
- **Inverter Connection Line:** For direct connection to compatible inverters.
- **Parallel Interface Board / Parallel Module:** For managing parallel battery pack configurations.

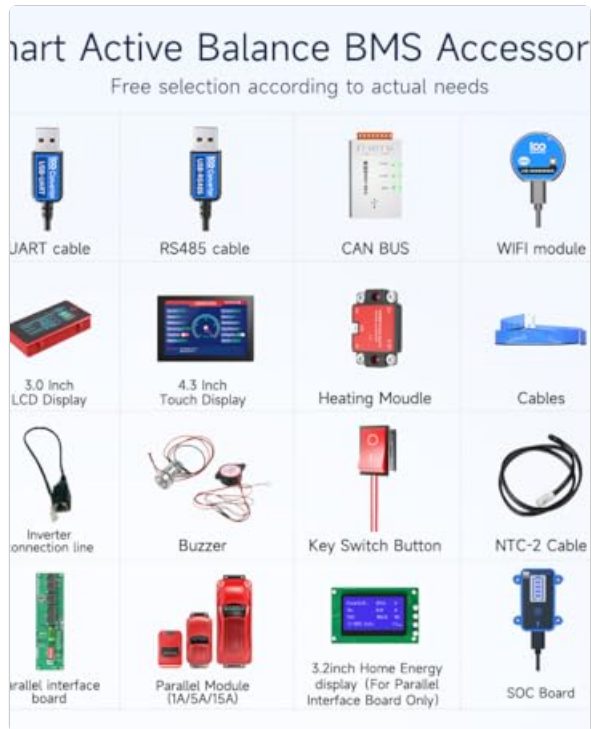

Figure 9: Various optional accessories for the 100BALANCE BMS.

7. Maintenance

To ensure the longevity and optimal performance of your 100BALANCE BMS, follow these maintenance guidelines:

- **Regular Inspection:** Periodically check all wiring connections for tightness and signs of corrosion or damage.
- **Keep Clean:** Ensure the BMS unit is free from dust, dirt, and moisture. Use a dry, soft cloth for cleaning.
- **Environmental Conditions:** Operate the BMS within its specified temperature range (-40°C to 85°C). Avoid exposure to extreme temperatures or humidity.
- **Firmware Updates:** Regularly check for and install any available firmware updates for the BMS to ensure you have the latest features and bug fixes.

8. Troubleshooting

If you encounter issues with your 100BALANCE BMS, consider the following:

- **No Power/No Indication:** Check all power connections and ensure the battery pack is providing sufficient voltage. Verify the BMS is correctly wired to the battery.
- **BMS Not Connecting to App/PC Host:** Ensure Bluetooth is enabled on your mobile device or the communication cable is securely connected to the PC. For PC host, verify correct COM port and baud rate settings.
- **Alarm Indications:** Refer to the mobile app or PC host software's 'Alarm List' or 'History Data' section for specific fault codes and descriptions. Common alarms include over-voltage, under-

voltage, over-current, and temperature warnings.

- **Balancing Issues:** If cells are not balancing, check the 'Set Param' page in the app/PC host to ensure balancing is enabled and the voltage difference threshold is correctly set. The minimum current that can be displayed is 0.1A. Balancing open conditions are triggered when cells reach the open voltage and there is a voltage difference (default 0.01V).
- **Battery Pack Parallel Connection:** When paralleling lithium battery packs, ensure the voltage difference between packs is less than 1 volt to prevent the BMS from triggering short circuit protection by high current. Manually disconnect the discharging MOS in the Bluetooth APP or PC software to prevent battery packs from firing during parallel connection.
- **SOC Calibration:** For 100% SOC calibration, when single cell overvoltage protection level 2 is triggered, the BMS will be calibrated to 100% SOC.

9. Safety Precautions

Always observe the following safety precautions when installing, operating, or maintaining the BMS:

- **Professional Installation:** Installation should ideally be performed by qualified personnel.
- **Correct Wiring:** Strictly follow the wiring diagrams and sequences provided in this manual. Incorrect wiring can lead to severe damage to the BMS, battery pack, or personal injury.
- **Voltage Compatibility:** Ensure the BMS model is compatible with your battery pack's cell count (S-number) and voltage.
- **Avoid Short Circuits:** Take extreme care to prevent short circuits during wiring and operation. Use insulated tools.
- **Environmental Protection:** Do not expose the BMS to water, fire, or corrosive substances.
- **Emergency Procedures:** In case of smoke, fire, or unusual odors, immediately disconnect the battery pack if safe to do so and evacuate the area.

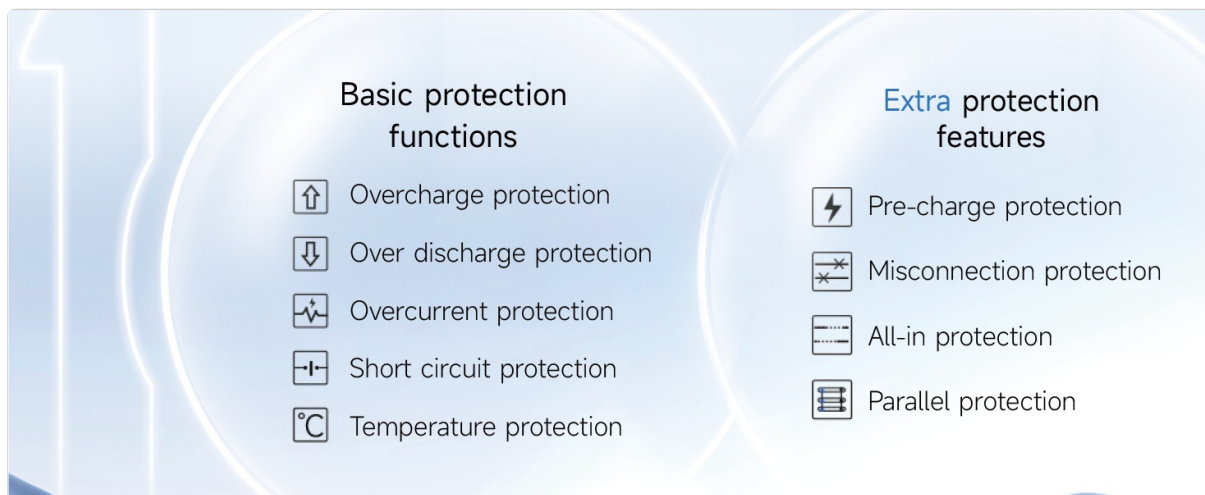

Figure 10: Overview of basic and extra protection functions provided by the BMS.

10. Warranty and Support

The 100BALANCE BMS 150A 8S-24S comes with a **1-year warranty** from the date of purchase, covering

manufacturing defects. This warranty does not cover damage caused by improper installation, misuse, unauthorized modifications, or external factors.

For technical support, warranty claims, or further inquiries, please refer to the contact information provided with your product packaging or visit the official 100BALANCE website.