

Dripex 52x52 Inch Playpen

Dripex Baby Playpen 52x52 Inch Instruction Manual

Model: 52x52 Inch Playpen

1. IMPORTANT SAFETY INFORMATION

Read all instructions before assembling and using the Dripex Baby Playpen. Failure to follow these instructions could result in serious injury or death. Keep this manual for future reference.

General Safety Guidelines:

- **Never leave your child unattended** in the playpen. Constant supervision is required.
- Ensure all components are correctly assembled and securely fastened before each use.
- Do not use the playpen if any parts are broken, torn, or missing. Contact customer support for replacement parts.
- Keep the playpen away from open flames, heaters, and other heat sources.
- Do not place the playpen near windows where cords from blinds or drapes could strangle a child.
- The playpen is designed for children who cannot climb out and are under the maximum weight limit.
- Only use accessories and replacement parts approved by Dripex.
- The playpen features **anti-collision corners**, **non-toxic fabric**, and an **anti-slip bottom** for enhanced safety.



Image: Anti-collision corner design for child safety.



Cozy Pregnancy

Providing comfort and support
every step of your pregnancy.

Image: Non-toxic fabric ensures a safe environment for your child.



Cozy Feeding

Let us be your ultimate companion
on this feeding journey.

Image: Anti-slip bottom provides stability on various floor types.

2. PACKAGE CONTENTS

Verify that all components listed below are present and undamaged before beginning assembly. If any parts are missing or damaged, do not proceed with assembly and contact Dripex customer support.



Image: Visual representation of all included parts.

- Handles (Pull-up Rings) x 2
- Top Corner Tee x 4
- 28.8 Inch Tube x 24
- Straight Tee x 8
- L Bottom Tee x 4
- Fabric Cover x 1

3. SETUP INSTRUCTIONS

The Dripex Baby Playpen is designed for quick and tool-free assembly, typically taking around 10 minutes. Follow these steps carefully:

1. Lay the cloth cover flat on the ground. Insert the bottom horizontal tubes into the cloth cover and connect them using the straight tees and L bottom tees.
2. Begin inserting the vertical tubes from one corner. Rotational insertion can make this step easier.
3. Finish inserting all 8 vertical tubes into the cloth cover.
4. Insert the top horizontal tubes into the cloth cover and connect them using the straight tees and top corner tees.
5. Flip all protective cloth in the middle and corners, and secure them with Velcro.



Image: Detailed installation steps for the playpen.

4. OPERATING INSTRUCTIONS

Using the Zipper Door:

The playpen features an external-only zipper door for controlled access. This design ensures your child remains safely inside while allowing easy entry and exit for adults. Always ensure the zipper is fully closed when your child is inside.



Image: Child using the external zipper door for entry/exit.

Utilizing Pull-Up Rings:

Two pull-up rings are included to assist babies aged 6 months and older in practicing standing and developing coordination. Attach these rings securely to the top rail of the playpen at desired locations.



Image: Child using the pull-up rings to aid in standing.

Visibility and Interaction:

The breathable mesh walls provide 360° visibility, allowing you to easily monitor your child and for your child to see their surroundings. This design promotes interaction and reduces feelings of isolation.



Image: Adult and child playing together inside the playpen.

5. MAINTENANCE AND CLEANING

Regular maintenance and cleaning will ensure the longevity and hygiene of your Dripex Baby Playpen.

Cleaning Instructions:

- The fabric cover can be removed for cleaning. It is recommended to machine wash the fabric cover on a gentle cycle with cold water.
- Do not use bleach or harsh detergents.

- Air dry the fabric cover completely before reassembling the playpen.
- Wipe down the steel frame and plastic connectors with a damp cloth and mild soap. Rinse thoroughly and dry completely.
- Regularly inspect the mesh for any tears or damage.

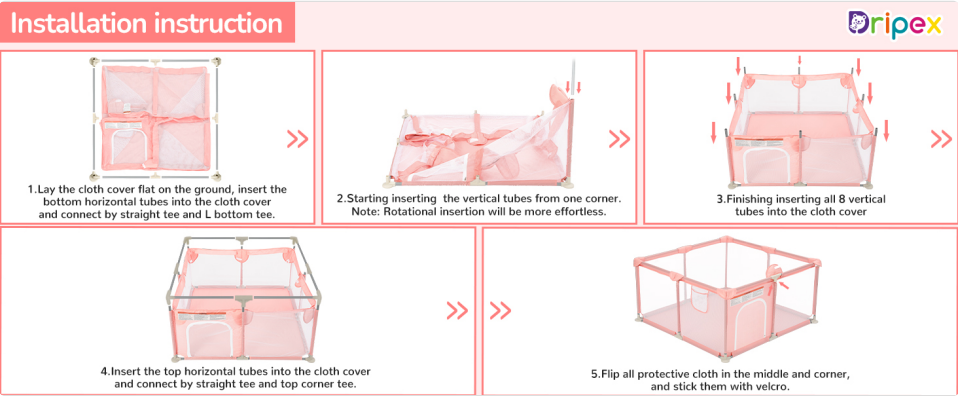

Image: The fabric cover is machine washable for easy cleaning.

6. TROUBLESHOOTING

This section addresses common issues you might encounter with your Dripex Baby Playpen.

Playpen Stability Issues:

- **Issue:** The playpen feels wobbly or unstable.
- **Solution:** Ensure all tubes are fully inserted into their connectors and that the L bottom tees are correctly positioned and making full contact with the floor. Verify that the anti-slip bottom pads are clean and free of debris.

Difficulty During Assembly:

- **Issue:** Tubes are difficult to insert or connect.
- **Solution:** Apply gentle, even pressure. Rotational insertion can help with vertical tubes. Ensure you are using the correct type of tee connector (straight tee, L bottom tee, top corner tee) for each joint as indicated in the setup instructions.

Damaged Mesh or Fabric:

- **Issue:** The mesh or fabric cover has a tear or hole.
- **Solution:** Discontinue use immediately to prevent injury. Contact Dripex customer support for replacement parts. Do not attempt to repair damaged fabric with tape or other temporary solutions.

7. SPECIFICATIONS

Feature	Detail
Product Dimensions	52 x 52 x 27 inches (L x W x H)
Material Type	Cotton, Steel
Material Composition	Oxford Cloth

Feature	Detail
Item Weight	11.92 pounds
Floor Area	17.36 Square Feet
Age Range (Description)	Toddler
Color	Princess Pink
UPC	840325631349

8. WARRANTY AND SUPPORT



For warranty information, product support, or to order replacement parts, please contact Dripex customer service. Refer to the product packaging or the official Dripex website for the most current contact details.



Manufacturer: Dripex

Model: 52x52 Inch Playpen

ASIN: B0CYLRTZXD

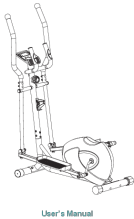
Related Documents - 52x52 Inch Playpen

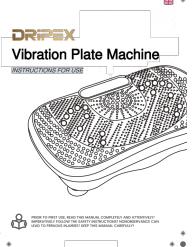
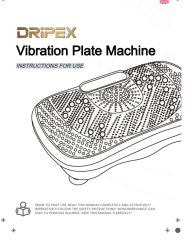
 <p>ROWING MACHINE USER'S MANUAL</p>	<p>Dripex X Rowing Machine User Manual</p> <p>Comprehensive user manual for the Dripex X Rowing Machine, covering safety information, assembly instructions, parts list, monitor operation, fitness guide, and suggested stretches for home use.</p>
	<p>Dripex Basketball Hoop Installation and Safety Guide</p> <p>Comprehensive instructions for assembling and safely using the Dripex Basketball Hoop, including parts list, safety warnings, and height adjustment guidance.</p>
 <p>Magnetic Elliptical Machine</p> <p>User's Manual</p>	<p>Magnetic Elliptical Machine User's Manual</p> <p>Comprehensive user's manual for the Magnetic Elliptical Machine, covering safety information, parts list, assembly instructions, monitor usage, and maintenance tips.</p>

 The image shows the top cover of a DRIPEX Vibration Plate Machine. It features a black and white line drawing of the machine's surface, which is covered in a grid of small circles representing vibration points. The DRIPEX logo is at the top left, and the text 'Vibration Plate Machine' and 'INSTRUCTION BOOK FOR USER' are at the top right.	<p>Dripex Vibration Plate Machine: User Manual and Safety Guide</p> <p>Comprehensive instructions for the Dripex Vibration Plate Machine, covering technical data, safety guidelines, care, maintenance, functional description, and exercise postures for effective home workouts.</p>
 This is an identical copy of the image in the first row, showing the top cover of the DRIPEX Vibration Plate Machine with the grid pattern and product information.	<p>Dripex Vibration Plate Machine: User Manual and Safety Guide</p> <p>Comprehensive user manual for the Dripex Vibration Plate Machine, covering technical specifications, safety instructions, care and maintenance, functional description, and various exercise postures for effective full-body workouts.</p>
 The image shows the cover of the DRIPEX VANITY MAKEUP MIRROR user manual. It features a black and white line drawing of a rectangular mirror with a simple frame. The DRIPEX logo is at the top left, and the text 'VANITY MAKEUP MIRROR' is at the top right. Below the drawing is a small warning box with text in Chinese and English.	<p>DRIPEX DP364-A Vanity Makeup Mirror User Manual</p> <p>User manual for the DRIPEX DP364-A Vanity Makeup Mirror, covering assembly, operation, safety warnings, maintenance, and FCC compliance information.</p>