



Manuals.plus /

› Hiseeu /

› Hiseeu 4K PoE Security Camera System with 12-inch Monitor, 6x 5MP PTZ Cameras, and 16-Channel NVR (Model PK-12V-6YHD985-CT)

Hiseeu PK-12V-6YHD985-CT

Hiseeu 4K PoE Security Camera System with 12-inch Monitor, 6x 5MP PTZ Cameras, and 16-Channel NVR (Model PK-12V-6YHD985-CT)

User Instruction Manual

1. INTRODUCTION

This manual provides detailed instructions for the installation, operation, and maintenance of your Hiseeu 4K PoE Security Camera System. This system includes a 12-inch monitor, six 5MP PTZ (Pan-Tilt-Zoom) cameras, and a 16-channel Network Video Recorder (NVR). Please read this manual thoroughly before using the product to ensure proper setup and functionality.



Figure 1.1: Overview of the Hiseeu 4K PoE Security Camera System components, including the NVR with integrated 12-inch monitor and six PTZ cameras.

2. WHAT'S IN THE BOX

Verify that all items listed below are present in your package. If any items are missing or damaged, please contact Hiseeu customer support.

- 1x 12" NVR Monitor
- 6x 5MP PoE Cameras
- 1x 3TB HDD Pre-installed
- 1x Power Adapter for NVR
- 6x 64ft Ethernet Cables
- 1x USB Mouse
- 1x HDMI Cable
- 1x 3ft Ethernet Cable
- 1x User Manual
- 2x Warning Stickers
- 6x Screws (for camera mounting)

What's in the Box?



Figure 2.1: Visual representation of the components included in the Hiseeu 4K PoE Security Camera System package.

3. SETUP INSTRUCTIONS

The Hiseeu PoE Security Camera System is designed for straightforward installation. Follow these steps for initial setup.

3.1 System Connection (Plug & Play)

1. **Connect NVR Power:** Connect the provided power adapter to the NVR monitor and plug it into an electrical outlet.
2. **Connect Cameras:** Connect each PoE camera to an available PoE port on the NVR using the provided network cables. The cameras will receive both power and video signal through a single Ethernet cable.
3. **Initial Display:** The NVR's integrated 12-inch monitor will display the live view from the connected cameras automatically.
4. **Optional External Monitor:** For a larger viewing experience, connect an external monitor (TV or PC monitor) to the NVR via an HDMI or VGA cable.

Power over Ethernet, Plug & Play



Figure 3.1: Illustration of the Power over Ethernet (PoE) connection for cameras and options for local and remote viewing.

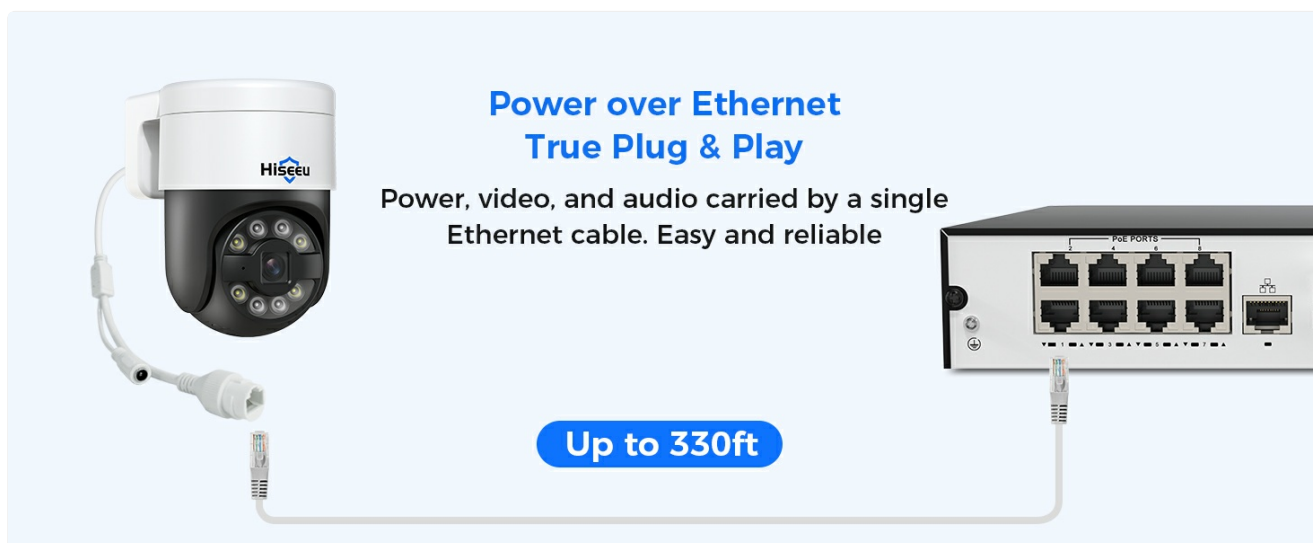

Figure 3.2: The simplicity of Power over Ethernet (PoE) connectivity, requiring only one cable for power, video, and audio transmission.

3.2 Remote Access Setup (Optional)

To access your security system remotely via a smartphone app or PC client software, the NVR must be connected to your router using a network cable.

1. **Connect NVR to Router:** Use the provided 3ft Ethernet cable to connect the NVR's WAN port to an available LAN port on your internet router.
2. **Download App/Software:** Download the free Hiseeu mobile application (e.g., "Guard Live") from your device's app store (App Store for iOS, Google Play for Android) or the PC client software from the Hiseeu official website.
3. **Register and Add Device:** Follow the in-app instructions to register an account and add your NVR device by scanning the QR code or manually entering the device ID.
4. **Live View:** Once connected, you can view live footage, playback recordings, and manage settings from your remote device.

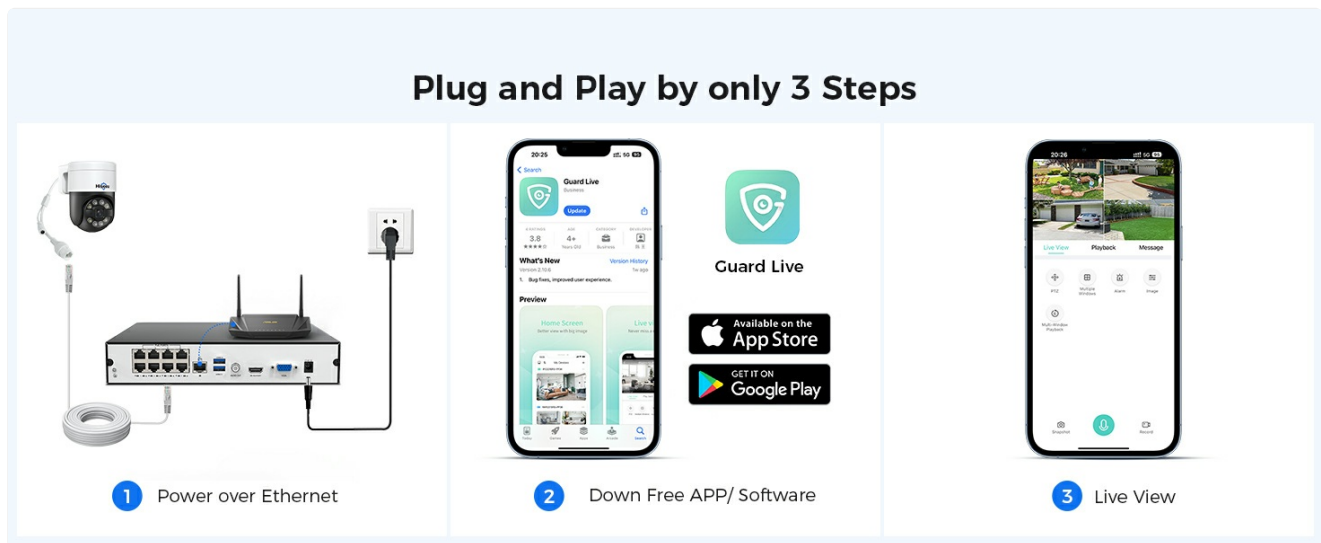

Figure 3.3: Simplified three-step process for setting up the system for remote access.

4. OPERATING INSTRUCTIONS

4.1 Camera Features

- **PTZ Control (Pan-Tilt-Zoom):** The cameras offer a 330° horizontal viewing angle (300° pan) and 90° vertical tilt. Use the NVR interface or the mobile app to remotely adjust the camera's direction and zoom.

330° Panorama



Figure 4.1: The camera's pan and tilt capabilities provide a wide 330° panoramic view.

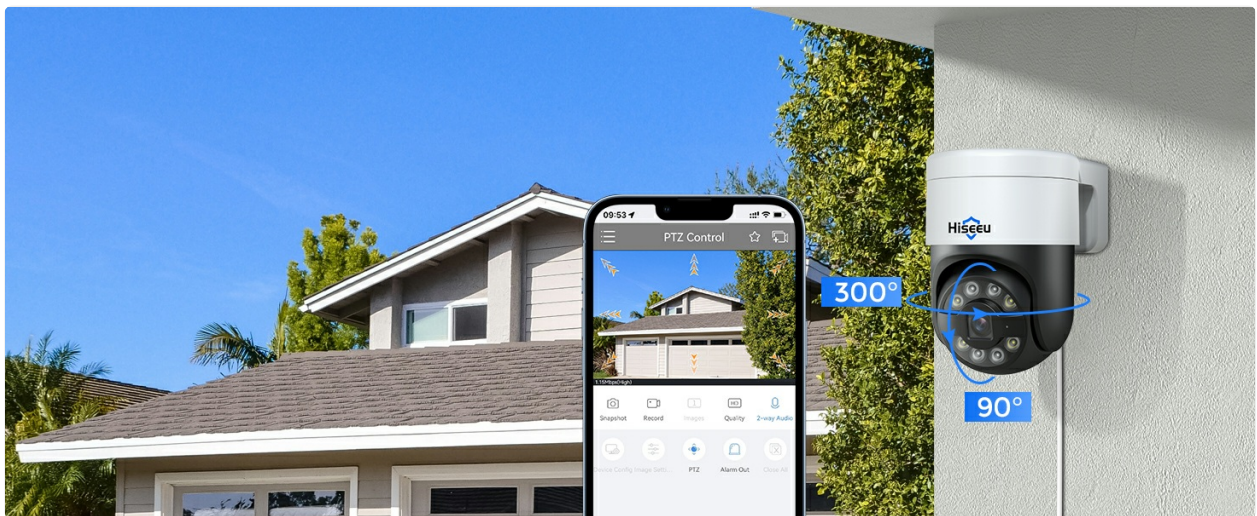

Figure 4.2: Remote PTZ control via the mobile application, allowing adjustment of camera orientation.

- **Human Tracking:** The AI auto-tracking function enables cameras to detect and follow suspicious human movement within the surveillance area.

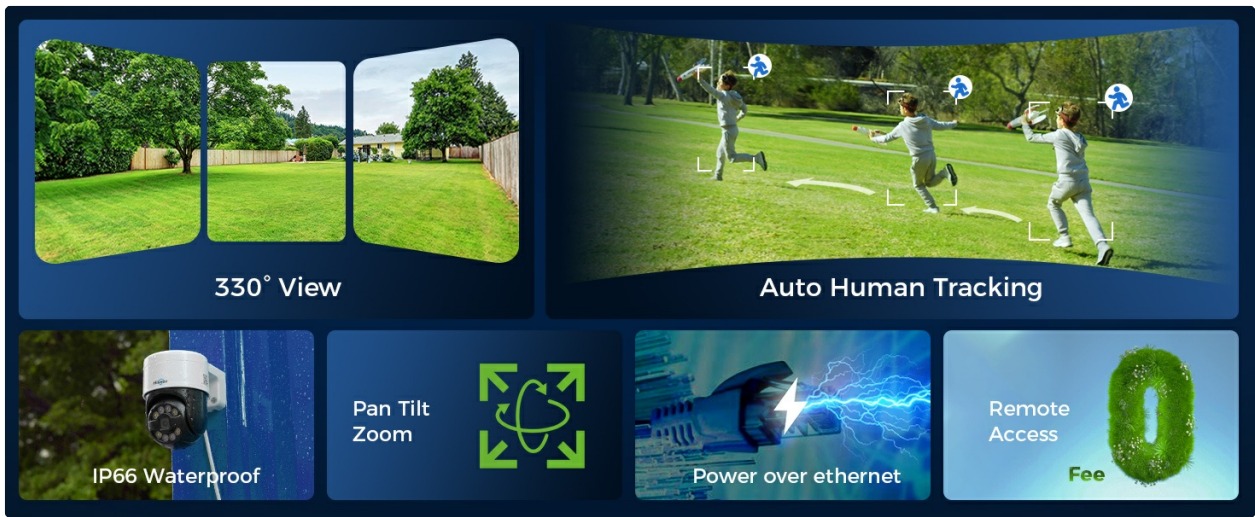

Figure 4.3: Overview of key camera features including human tracking, PTZ, and weather resistance.

- **Color Night Vision:** The cameras offer two night vision modes:
 - a. **Motion-Triggered Light:** The alarm light activates when human motion is detected, providing color night vision.
 - b. **Default On:** The light remains on by default, providing continuous color night vision.

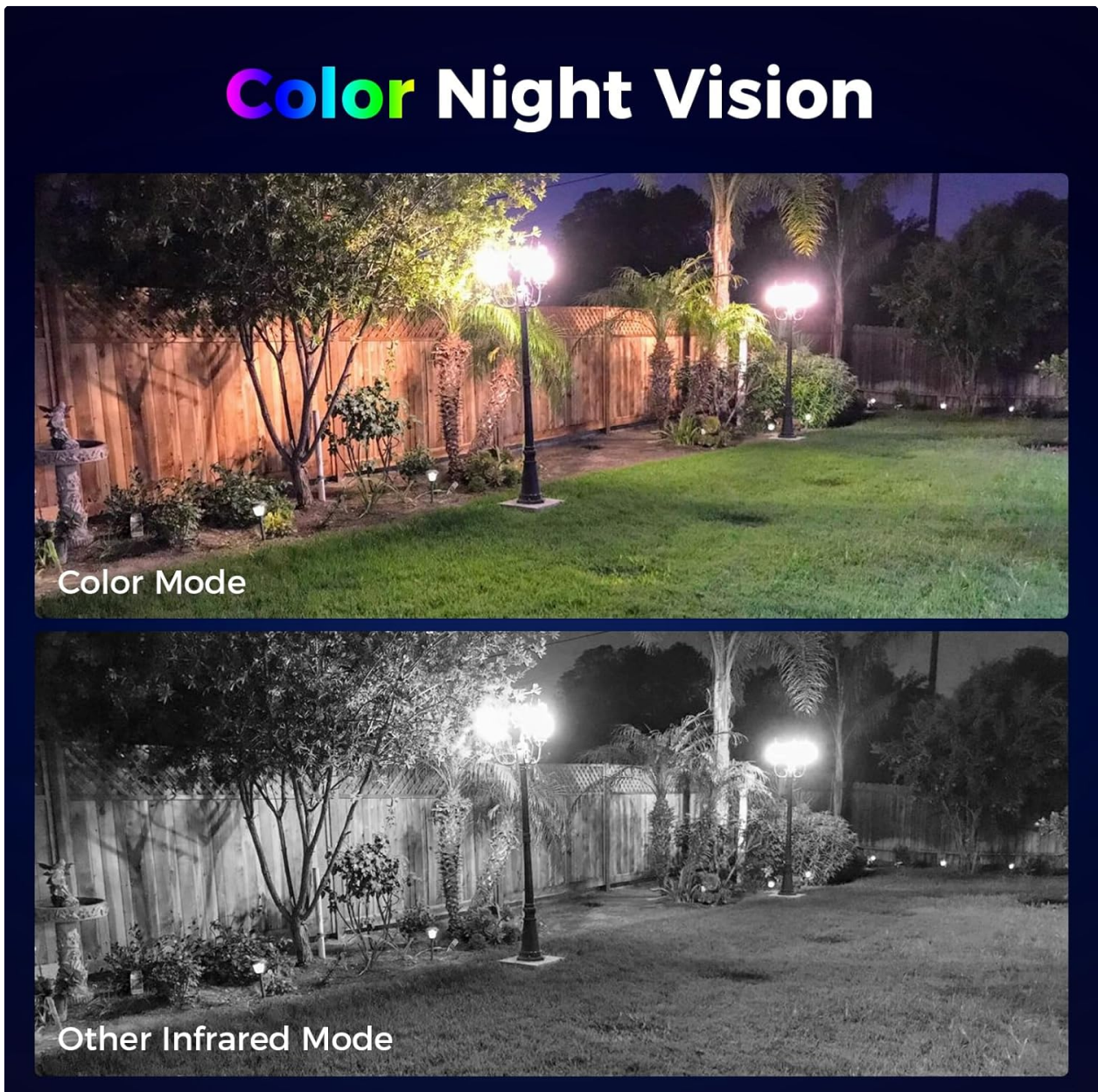

Figure 4.4: Comparison demonstrating the clarity and detail of color night vision versus traditional infrared night vision.

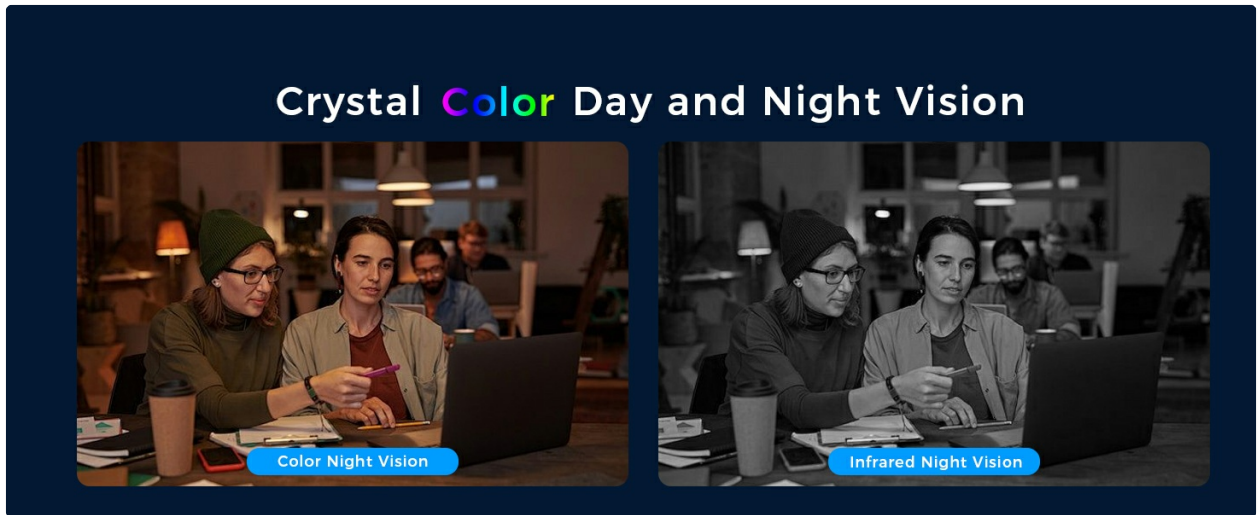

Figure 4.5: Illustrates the difference between crystal color night vision and standard infrared night vision.

- **Two-Way Audio:** Communicate directly through the camera using the mobile app. This allows you to speak to individuals near the camera and hear audio from the surveillance area.



Figure 4.6: Example of real-time two-way audio communication via the mobile application.

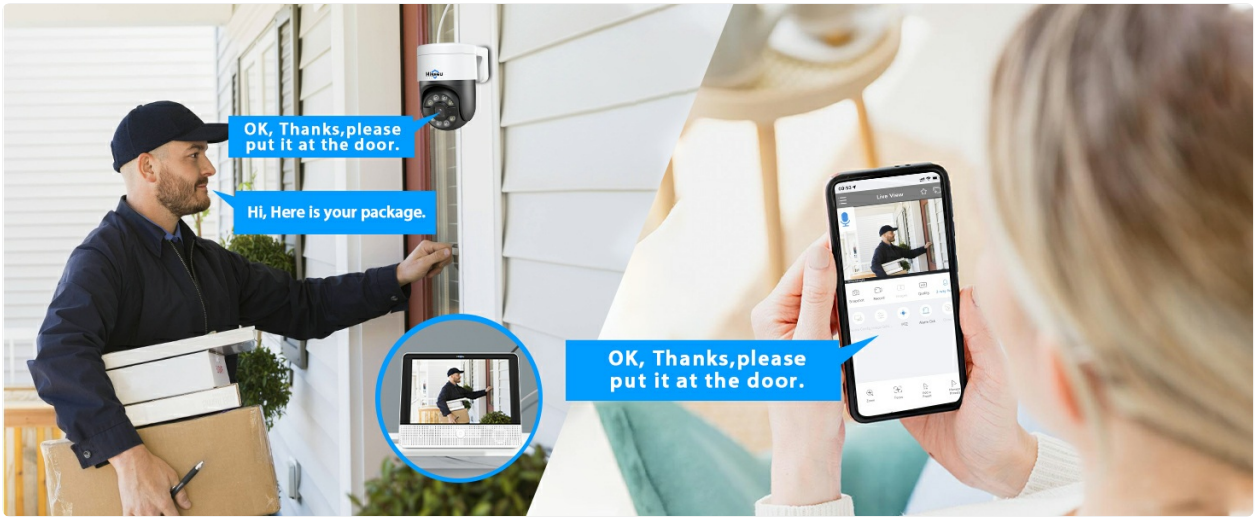

Figure 4.7: Practical application of two-way audio for interacting with visitors or delivery personnel.

- **IP66 Weatherproof:** The cameras are rated IP66, ensuring resistance to dust and water, suitable for outdoor installation in various weather conditions.



Figure 4.8: The IP66 rating ensures the camera's durability against environmental elements.



Figure 4.9: Detailed weather resistance specifications for the IP66 rated camera.

4.2 NVR Features

- **Integrated 12-inch Monitor:** The NVR features a built-in 12-inch monitor for direct live viewing without needing an external display.



Figure 4.10: The NVR's integrated monitor and its capability to connect to a larger external display.



Figure 4.11: Dual monitor surveillance setup, utilizing both the NVR's built-in screen and an external monitor.

- **Recording Modes:** The system supports various recording modes, including 24/7 continuous recording and motion detection recording. The pre-installed 3TB HDD provides ample storage.
- **Smart Playback:** Utilize the AI algorithm technology for smart playback, allowing you to quickly locate and review specific events or time periods.
- **Expandable Channels:** The 16-channel NVR supports up to 16 cameras. This system includes 6 cameras, allowing for future expansion. Additional PoE switches and cameras are not included.

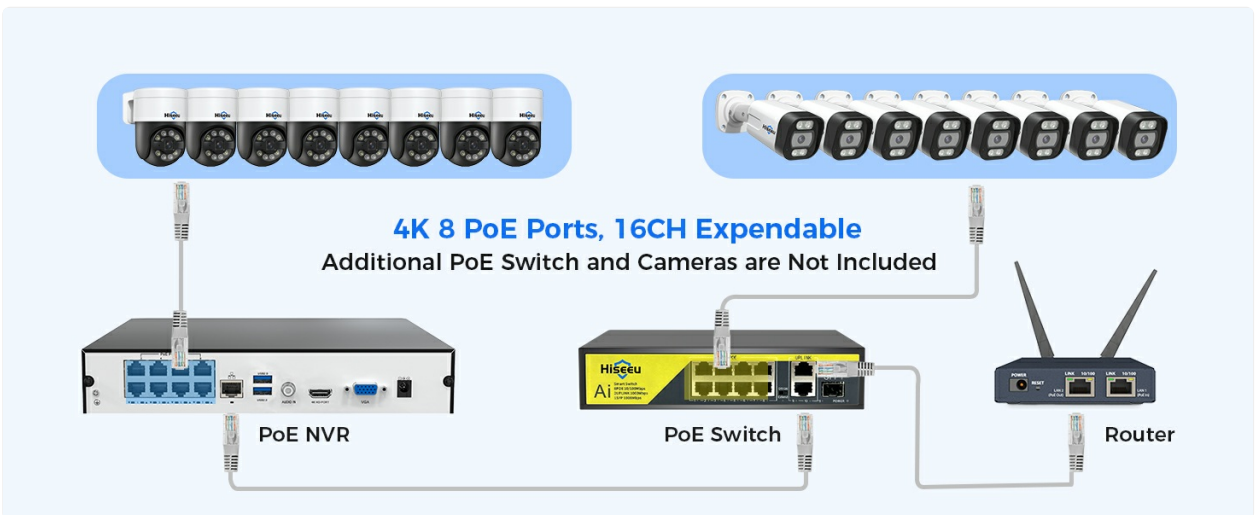

Figure 4.12: The NVR's expandability to support up to 16 channels with an optional PoE switch.

- **Multi-user Sharing:** The system supports multi-user access, allowing you to share live views and recordings with family members through the mobile application.



Figure 4.13: The multi-user sharing feature allows multiple individuals to access the system remotely.

5. MAINTENANCE

- **Regular Cleaning:** Periodically clean the camera lenses with a soft, damp cloth to ensure clear image quality. Avoid abrasive cleaners.
- **Cable Inspection:** Regularly inspect all network cables for any signs of wear, damage, or loose connections. Secure or replace damaged cables to maintain system integrity.
- **Software Updates:** Check the Hiseeu official website or the mobile app for available firmware updates for the NVR and cameras. Keeping your system updated ensures optimal performance and security.
- **Hard Drive Management:** The 3TB HDD provides significant storage. If continuous recording is enabled, consider reviewing and backing up important footage periodically. The system will automatically overwrite the oldest footage when the disk is full.

6. TROUBLESHOOTING

Problem	Possible Cause	Solution
No image on NVR monitor.	NVR not powered on; loose HDMI/VGA cable (if external monitor); camera not connected or powered.	Ensure NVR power adapter is securely connected. Check HDMI/VGA cable connection. Verify cameras are properly connected to PoE ports.
Cannot access system remotely via app.	NVR not connected to router; incorrect network settings; app not configured correctly; internet connection issue.	Ensure NVR is connected to your router via Ethernet cable. Check router's internet connection. Verify app registration and device addition steps. Consult app's help section for network configuration.
Poor image quality.	Dirty camera lens; low light conditions; network bandwidth issues.	Clean camera lens. Ensure sufficient lighting for optimal color night vision. Check network connection stability.
Two-way audio not working.	Microphone/speaker settings disabled; app permissions; network issues.	Check audio settings on NVR and in the mobile app. Ensure app has microphone permissions on your phone. Verify stable network connection.
Human tracking not functioning.	Feature disabled; camera placement; environmental factors.	Ensure human tracking is enabled in camera settings. Optimize camera placement for clear view of detection zones.

7. SPECIFICATIONS

Feature	Detail
Brand	Hiseeu
Model Number	PK-12V-6YHD985-CT
Connectivity Technology	Wired (PoE)
Video Capture Resolution	5MP (3K)
Special Feature	PTZ Control, Human Tracking, 2-Way Audio, Color Night Vision
Number of Channels	16 (NVR)
Memory Storage Capacity	3 TB (Pre-installed HDD)
Power Source	Corded Electric
Item Dimensions (L x W x H)	13 x 13 x 19 inches (Package/System)
Compatible Devices	Cameras, Laptops, Personal Computers, TV
Low Light Technology	Starlight
Night Vision Range	60 Feet
Frame Rate	15-30 fps
Recording Mode	Manual, Motion Detection, Continuous
Total USB Ports	2
Hardware Interface	Ethernet
Lens Type	Fixed (on PTZ cameras, refers to focal length)
Video Input	RJ45 (PoE)
Viewing Angle	330 Degrees (Pan/Tilt range)
Item Weight	21.5 pounds

8. WARRANTY AND SUPPORT

Hiseeu is committed to providing quality products and customer satisfaction. For warranty information, technical support, or any inquiries, please refer to the following:

- **Product Warranty:** Refer to the warranty card included in your package or visit the official Hiseeu website for detailed warranty terms and conditions.
- **Technical Support:** Hiseeu offers lifetime technical support. Contact information can be found on the official website or in the included documentation.
- **Returns:** The product typically includes a 30-day free return policy. Please check your purchase terms for specifics.

For the most up-to-date support resources, please visit the Hiseeu Store on Amazon or the official Hiseeu website.

