



[Manuals.plus](#) /

› [Canoly](#) /

› Canoly Masticating Juicer Machine User Manual

## Canoly Canoly-002

# Canoly Masticating Juicer Machine User Manual

Model: Canoly-002 | Brand: Canoly

### INTRODUCTION

Thank you for choosing the Canoly Masticating Juicer Machine. This powerful slow cold press juicer is designed to efficiently extract juice from a variety of fruits and vegetables, preserving nutrients and flavor. Featuring a 4.1-inch (104mm) large feed chute, it minimizes preparation time, making healthy juicing convenient for your daily routine. This manual provides essential information for safe operation, assembly, maintenance, and troubleshooting to ensure optimal performance and longevity of your juicer.



Figure 1: Canoly Masticating Juicer Machine - Front View

## SETUP AND ASSEMBLY

Before first use, ensure all parts are clean. The juicer is designed for easy assembly. Follow these steps to set up your juicer:

1. Place the motor base on a stable, flat surface.
2. Align the juicing bowl with the motor base and gently twist until it locks into place.
3. Insert the crushing screw (auger) into the center of the juicing bowl.
4. Place the filter basket over the auger, ensuring it sits securely.
5. Attach the feed chute cover by aligning it with the juicing bowl and twisting clockwise until it clicks into a locked position.
6. Position the pulp container and juice cup under their respective spouts.

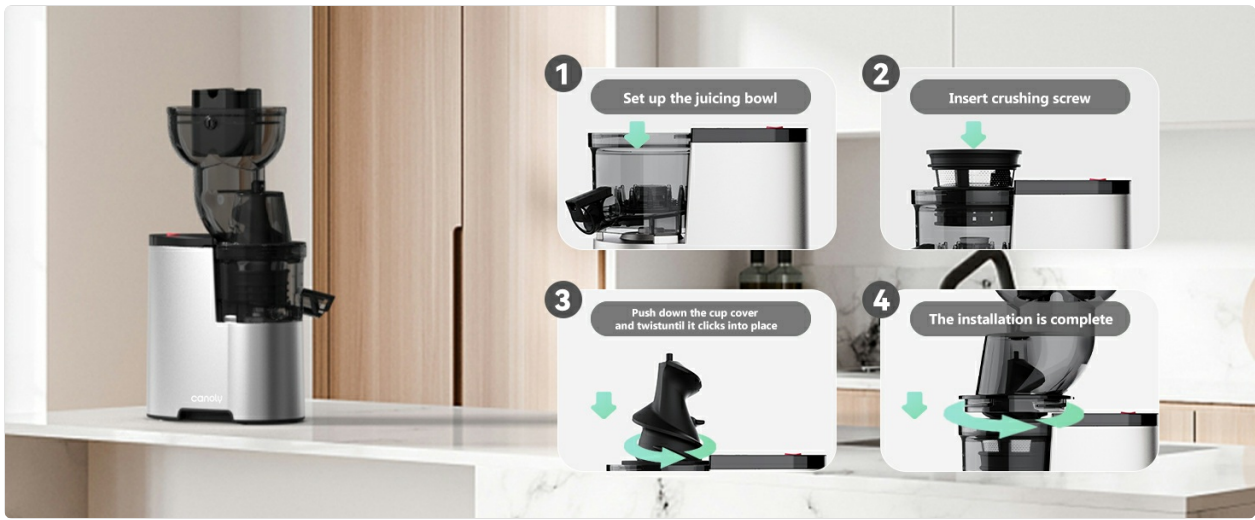

Figure 2: Step-by-step installation guide.

Video 1: Official product video demonstrating unboxing, assembly, and initial use.

## OPERATING INSTRUCTIONS

The Canoly Masticating Juicer is designed for efficient cold pressing, ensuring maximum juice yield and nutrient retention. Its large feed chute allows for whole fruits and vegetables, reducing prep time.

### Juicing Process:

1. Ensure the juicer is properly assembled and plugged into a power outlet.
2. Prepare your fruits and vegetables. While the large chute accommodates whole items, fibrous vegetables (like celery) or very large fruits may benefit from being cut into smaller pieces to prevent clogging and optimize juicing.
3. Turn on the juicer using the power switch.
4. Slowly feed the produce into the large chute. Use the food pusher to gently guide items down, but do not force them.
5. The juicer will automatically separate juice into the juice cup and pulp into the pulp container.
6. Once juicing is complete, turn off the machine.



Figure 3: The large feed inlet supports whole fruits and vegetables. Note: Fibrous vegetables may need to be cut.



Figure 4: The 80x160mm large spiral auger uses 7-stage cold pressing technology for high juice extraction.

## MAINTENANCE AND CLEANING

Regular cleaning is crucial for maintaining the performance and hygiene of your juicer. The detachable parts are designed for easy cleaning.

### Cleaning Steps:

1. Unplug the juicer from the power outlet before disassembling.
2. Disassemble the juicer by reversing the assembly steps.
3. Rinse all detachable parts (feed chute cover, juicing bowl, auger, filter basket, pulp container, juice cup) under running water.
4. Use the provided cleaning brush to remove any pulp residue from the filter basket and other components.
5. Wipe the motor base with a damp cloth. Do NOT immerse the motor base in water.
6. All detachable parts are NOT dishwasher safe. Hand wash only.
7. Allow all parts to air dry completely before reassembling or storing.

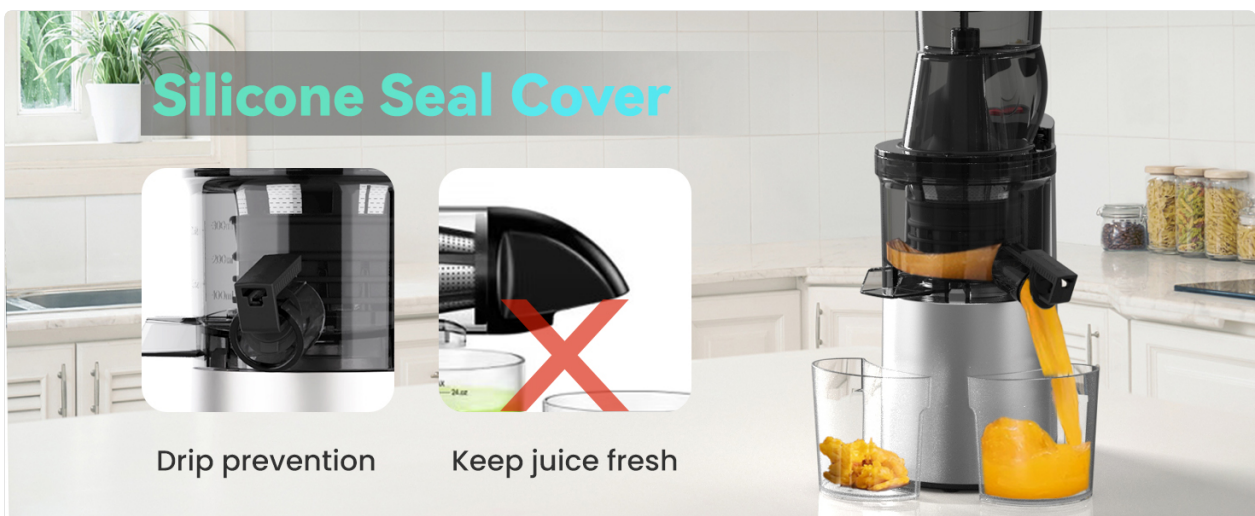

Figure 5: The silicone seal cover helps prevent drips and keeps juice fresh.

## TROUBLESHOOTING

If you encounter any issues with your Canoly Juicer, please refer to the following common problems and solutions:

- **Juicer not turning on:** Ensure the juicer is properly assembled and all parts are securely locked into place. Check that the power cord is firmly plugged into a working outlet.
- **Parts are difficult to disassemble:** If components like the juicing bowl or auger become stuck after use, ensure all pulp has been cleared from the machine. Try twisting the parts firmly but gently. Sometimes, a small amount of residual pulp can create a vacuum.
- **Low juice yield or excessive wet pulp:** Ensure you are feeding produce slowly and not overloading the juicer. For very fibrous ingredients, cutting them into smaller pieces can improve efficiency.
- **Unusual noise or vibration:** Turn off the juicer immediately and check for any foreign objects or blockages in the feed chute or juicing mechanism. Ensure all parts are correctly assembled.
- **Broken or cracked components (e.g., crushing screw, filter):** While the juicer is built with durable materials, accidental damage can occur. Unfortunately, replacement parts may not be readily available. In such cases, please contact Canoly customer support for assistance.

## SPECIFICATIONS

<b>Brand</b>	Canoly
<b>Model Number</b>	Canoly-002
<b>Capacity</b>	0.11 Quarts
<b>Maximum Power</b>	300 Watts
<b>Power Source</b>	Corded Electric
<b>Blade Material</b>	A type of plastic (e.g. ABS)
<b>Number of Speeds</b>	1
<b>Is Dishwasher Safe</b>	No
<b>Product Dimensions</b>	7.49 x 17.38 x 13.42 inches
<b>Item Weight</b>	8.82 pounds
<b>Date First Available</b>	March 18, 2024

## WARRANTY AND SUPPORT

The Canoly Masticating Juicer Machine comes with a manufacturer's warranty, typically valid for one year from the date of purchase. For any warranty claims, technical support, or inquiries regarding replacement parts, please contact Canoly customer service directly. Keep your proof of purchase for warranty validation.

For further assistance, visit the official Canoly Store on Amazon: [Canoly Store](#)

