

XCQQ XCQQ-S9BR

XCQQ Electric Heated Bidet Toilet Seat (Model XCQQ-S9BR) - Round

User Manual

1. INTRODUCTION

This manual provides comprehensive instructions for the installation, operation, and maintenance of your XCQQ Electric Heated Bidet Toilet Seat, Model XCQQ-S9BR. Designed for enhanced hygiene and comfort, this bidet seat offers a range of features including warm water wash, warm air drying, a heated seat, and a night light. Please read this manual thoroughly before use to ensure proper function and safety.

2. SAFETY INFORMATION

- Ensure the power supply is unplugged before cleaning or maintenance.
- Do not immerse the unit in water or spray water directly onto the electrical components.
- Verify that the electrical outlet meets the specified voltage (120 Volts) and wattage (1300 watts).
- Do not attempt to disassemble, repair, or modify the unit yourself. Contact qualified service personnel.
- This product is designed for household use only.

3. PACKAGE CONTENTS

Verify that all components are present before beginning installation:

- Bidet toilet seat
- 3-way valve + DMT pipe (Pre-Installed)
- Fixing plate
- Mounting hardware
- Instruction manual

4. PRODUCT FEATURES OVERVIEW

The XCQQ Electric Heated Bidet Toilet Seat offers a range of advanced features for a comfortable and hygienic experience:

- **Electronic Bidet Toilet Seat:** Features a soft-close lid, warm air dryer, adjustable water temperature and pressure, multiple cleaning modes, a display screen, LED night light, stainless steel nozzle with self-cleaning capabilities, and a modern side panel for easy control.
- **Versatile Cleaning Modes:** Enjoy tailored comfort with bidet warm water washing (adjustable between 92°F and 104°F). Choose from options like rear cleansing, feminine washing, and one-touch auto cleaning & drying. The self-cleaning nozzle activates before and after each use.
- **Customizable Nozzle Position:** Personalize your routine with adjustable nozzle positions and an oscillating spray feature. The system remembers your last nozzle position setting.
- **Heated Toilet Seat:** Provides gentle warmth with adjustable temperature settings for comfort, especially on cold days.
- **Warm Air Drying:** Reduces paper waste with an integrated warm air dryer, offering a convenient, hands-off experience. Adjustable temperature settings ensure comfort.
- **Quiet and Convenient:** Features a soft-closing lid and seat, along with an optional silent mode for beep sounds. A subtle nightlight offers illumination for nighttime use.



Figure 1: Top-down view of the XCQQ Electric Heated Bidet Toilet Seat with its remote control.



Figure 2: The bidet seat installed on a toilet, highlighting the blue night light feature.

MULTI-FUNCTION PANEL OPERATION



Figure 3: Detailed view of the multi-function control panel, illustrating various settings and options.

OPERATION PANEL

Integration of all functional controls in the side panel.



SOFT CLOSE TOILET LID

Minimises thumping when closing the toilet lid.



AUTOMATIC

Automatically completes the washing and drying process at the touch of a button.



WATER INSTANT HEATING

Unlimited warm water supply and constant temperature flushing.

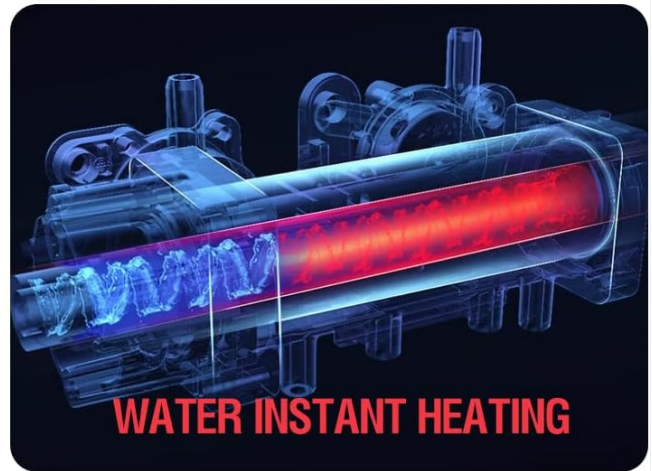

Figure 4: Visual representation of key features including the operation panel, soft-close lid, automatic wash and dry function, and instant water heating system.

WARM AIR DRYING

Reduce toilet paper usage with air drying hands-off options.



HEATED TOILET SEAT

Multiple temperature levels are available to suit your needs.

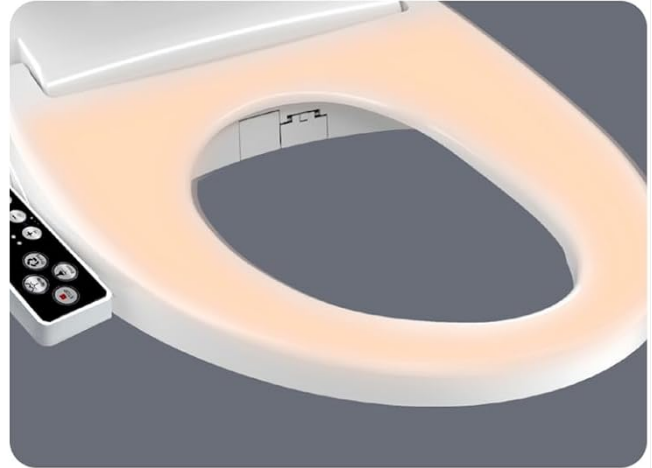

SMART DISPLAY SCREEN

High-resolution LED screen display real-time water and seat temperatures.



TOILET NIGHT LIGHT

No need for a harsh main light, which easier to use the bathroom at night.



Figure 5: Additional features shown: warm air drying, heated toilet seat, smart LED display, and the toilet night light.

Product Overview Video

Your browser does not support the video tag.

Video 1: An official overview of the XCQQ Heated Bidet Toilet Seat, demonstrating its various functions and design elements.

5. INSTALLATION GUIDE

Follow these steps to properly install your bidet toilet seat:

1. Hold down the side buckle to remove the fixing plate from the bidet seat.
2. Secure the fixing plate to the toilet using the provided screws and adjustment sheets.
3. Push the smart toilet seat onto the fixing plate by holding down the side buckle until it clicks into place.
4. Turn off the water supply valve to your toilet.
5. Attach the three-way valve to the threads of the toilet tank.
6. Connect the DMT pipe and filter to the three-way valve and the bidet seat.

7. Open the water supply valve.
8. Wait 3-5 minutes for the bidet to fill with water, then plug it into a 120V AC outlet.
9. When the power is activated, the LED light will start to blink, and the spray wand will automatically extend (without spray) and water will flow down into the toilet. This is a water spray check. The blue light will stop blinking in 1 minute.

Installation Guide

- 1** Hold down the side buckle to remove the fixing plate.

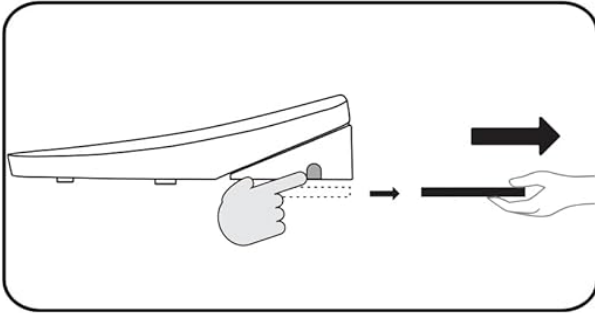

- 2** Secure the fixing plate to the toilet using the provided screws and adjustment sheets.

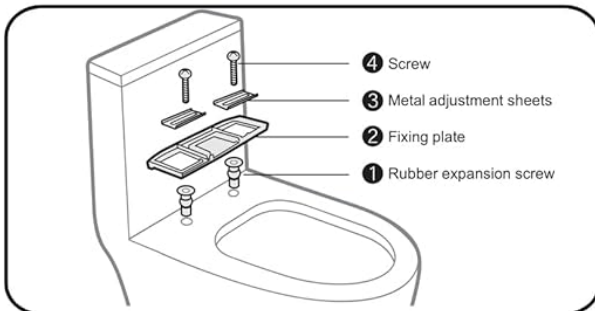

- 3** Push the smart toilet seat onto the fixing plate by hold down the side buckle.

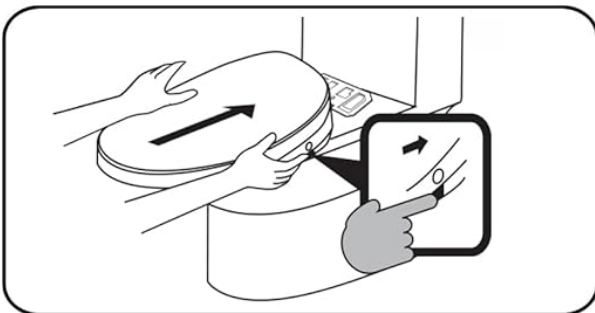

- 4** Turn off the water supply valve. Attach the three-way valve to the threads of the toilet tank. Connecting DMT pipe and filter.

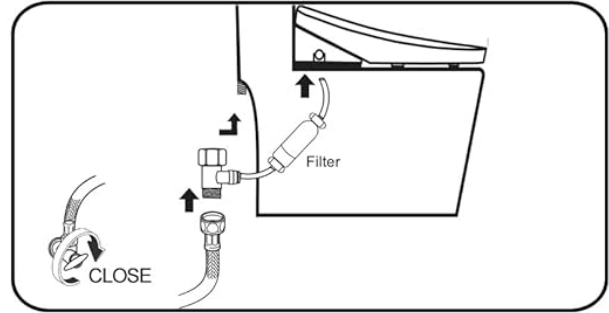

- 5** Please make sure to open the water supply valve first, wait 3 minutes for the water to fill the bidet, then plug it in.

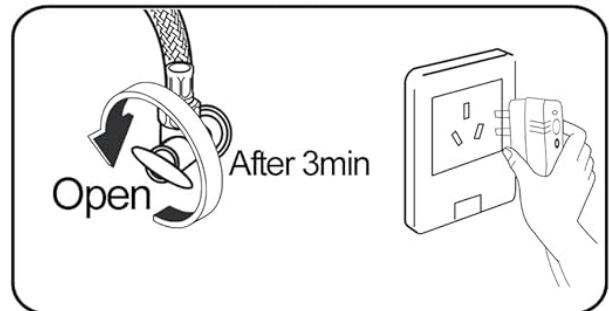

- 6** When the power is activated the LED light will start to blink, the spray wand will automatically extend (without spray) and the water will flow down the wand into the toilet.

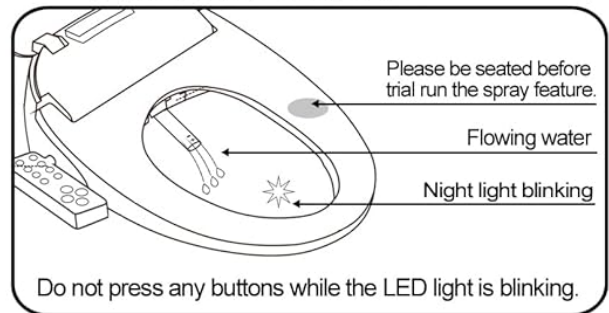

ATTENTION



Stop blinking the LED light (blue night light): If the LED light blinks continuously for more than 5 minutes, please unplug the bidet and turn off the water valve. Turn on the water valve first, wait 3-5 minutes, then plug it and do not operate any functions. The blue light will stop blinking in 1 minute.

Figure 6: Visual step-by-step instructions for installing the bidet toilet seat.

Figure 7: Important diagram to confirm your toilet size (round or elongated) and the necessity of an electrical outlet for installation.

Installation Video Guide

Your browser does not support the video tag.

Video 2: An official installation guide for the XCQQ Heated Bidet Toilet Seat, demonstrating the setup process.

6. OPERATION GUIDE

The bidet seat is operated via the side control panel. Refer to Figure 3 for button layout.

6.1. Basic Functions

- **Power/PSM Mode:** Turns the unit on/off or activates power-saving mode.
- **Seat Temp:** Adjusts the heated seat temperature.
- **Water Temp:** Adjusts the water temperature for washing.
- **Water Pressure/Air Temperature:** Adjusts the intensity of the water spray and the temperature of the warm air dryer.
- **Nozzle Position (FR/BK):** Moves the nozzle forward or backward to customize the spray area.
- **Spray:** Activates the rear cleansing function.
- **Bidet:** Activates the feminine washing function.
- **Drying:** Activates the warm air dryer.
- **Auto:** Initiates an automatic washing and drying cycle.
- **Stop:** Stops all active functions.
- **Night Light:** Toggles the LED night light.

6.2. Sensor-Based Operation

The bidet features a body sensor. Washing and drying functions will only activate when a user is seated on the bidet. This prevents accidental spraying.

7. MAINTENANCE

7.1. Nozzle Self-Cleaning

The stainless steel nozzle performs a self-cleaning cycle both before and after each use to maintain hygiene.

7.2. General Cleaning

- Unplug the bidet seat from the power outlet before cleaning.
- Wipe the exterior surfaces with a soft, damp cloth and a mild, non-abrasive cleaner.
- Do not use harsh chemicals, abrasive cleaners, or scrub brushes, as these can damage the surface.
- Ensure all surfaces are dry before plugging the unit back in.

8. TROUBLESHOOTING

If you encounter issues, please refer to the following common troubleshooting steps:

- **No power:** Check if the power cord is securely plugged into a working outlet. Ensure the circuit breaker has not tripped.
- **No water spray:** Confirm the water supply valve is fully open. Ensure the body sensor is engaged (you must be seated for the spray to activate).
- **Water not warm:** Allow a few minutes for the water heater to warm up. Check the water temperature setting on the control panel.
- **Seat not warm:** Check the heated seat temperature setting on the control panel.
- **LED light blinking continuously for more than 5 minutes:** Unplug the bidet and turn off the water valve. Turn on the water valve first, wait 3-5 minutes, then plug it in and do not operate any functions. The blue light should stop blinking in 1 minute.

For further assistance, please contact customer support.

9. SPECIFICATIONS

Manufacturer	XCQQ
Item Weight	11.97 pounds
Product Dimensions	18.9 x 15.4 x 5.5 inches
Item Model Number	XCQQ-S9BR
Style	S9BR-Round (Panel Control)
Material	ABS
Shape	Round
Power Source	AC
Voltage	120 Volts
Wattage	1300 watts
Temperature Range (Seat)	59 - 95 Degrees Fahrenheit
Maximum Weight Capacity	280 Pounds
Plug Format	B - US style with ground plug

10. WARRANTY AND SUPPORT

For warranty information and customer support, please refer to the documentation included with your product or visit the official XCQQ website. Keep your purchase receipt for warranty claims.