

## NEWFAST AC1200

# NEWFAST AC1200 Dual-Band WiFi Repeater User Manual

Model: AC1200

## 1. INTRODUCTION

This manual provides detailed instructions for the setup, operation, and maintenance of your NEWFAST AC1200 Dual-Band WiFi Repeater. This device is designed to extend your existing Wi-Fi network coverage, eliminate dead zones, and provide stable, high-speed internet access throughout your home or office. Please read this manual carefully before using the device to ensure proper installation and optimal performance.

## 2. PACKAGE CONTENTS

Please check the package contents carefully. If any items are missing or damaged, contact your retailer.

- 1 x NEWFAST AC1200 WiFi Repeater
- 1 x RJ-45 Network Cable
- 1 x User Instructions Manual

## 3. PRODUCT OVERVIEW

The NEWFAST AC1200 WiFi Repeater features a compact design with four external antennas for enhanced signal reception and transmission. It includes an OLED screen for intelligent status display and a WPS button for easy setup.



**Figure 1:** Front view of the NEWFAST AC1200 Dual-Band WiFi Repeater, showing the NEWFAST logo, four external antennas, and the OLED screen with status icons.

### 3.1 Device Components

- **External Antennas (x4):** Improve signal sensitivity and coverage.
- **OLED Screen:** Displays real-time status information such as signal strength, connection mode, and network activity.
- **WPS Button:** For quick and easy setup with WPS-enabled routers.

- **Ethernet Port (RJ-45):** For wired connections in Repeater or AP mode.
- **Power Plug:** Integrated for direct wall outlet connection.

## 4. SETUP INSTRUCTIONS

---

There are two primary methods to set up your NEWFAST AC1200 WiFi Repeater: using the WPS button or through a web browser.

### 4.1 WPS (Wi-Fi Protected Setup) Method

1. **Power On:** Plug the NEWFAST AC1200 Repeater into an electrical outlet near your main router. Wait for the device to power on and the OLED screen to display initial status.
2. **Activate WPS on Repeater:** Press and hold the WPS button on the NEWFAST AC1200 Repeater for 1-3 seconds. The WPS indicator on the OLED screen should start blinking.
3. **Activate WPS on Router:** Within two minutes, press the WPS button on your main Wi-Fi router. Refer to your router's manual for the exact location of its WPS button.
4. **Connect:** The repeater will automatically connect to your router. Once connected, the OLED screen will display a stable Wi-Fi signal icon, indicating a successful connection.
5. **Relocate (Optional):** You can now unplug the repeater and move it to a location between your router and the Wi-Fi dead zone. Ensure the OLED screen shows a good signal strength from your router for optimal performance.

***Note:** If your router does not support WPS, or if the WPS connection fails, please use the Web Browser Setup Method.*

### 4.2 Web Browser Setup Method

1. **Power On:** Plug the NEWFAST AC1200 Repeater into an electrical outlet near your main router.
2. **Connect to Repeater's Wi-Fi:** On your computer or smartphone, connect to the Wi-Fi network broadcast by the repeater (e.g., "NEWFAST\_Repeater" or similar). There will be no internet access at this stage.
3. **Access Web Interface:** Open a web browser and enter the default IP address or domain name (usually found in the included instructions or on a label on the device) into the address bar.
4. **Log In:** Enter the default username and password (typically "admin" for both, or as specified in the manual).
5. **Select Mode:** Choose the desired operating mode (Repeater, Router, or Access Point). For extending Wi-Fi, select "Repeater Mode".
6. **Scan for Networks:** The repeater will scan for available Wi-Fi networks. Select your main router's Wi-Fi network from the list.
7. **Enter Password:** Enter the Wi-Fi password for your main router's network.
8. **Configure Extended Network (Optional):** You can choose to keep the same network name (SSID) as your main router or create a new one for the extended network.
9. **Apply Settings:** Save the settings and wait for the repeater to restart. The OLED screen will indicate a successful connection.
10. **Relocate (Optional):** Move the repeater to an optimal location.

## 5. OPERATING MODES

---

The NEWFAST AC1200 WiFi Repeater supports multiple operating modes to suit various networking needs.

- **Repeater Mode (Default):** Extends the coverage of an existing wireless network. It connects to your main router wirelessly and rebroadcasts the signal, eliminating Wi-Fi dead zones.
- **Access Point (AP) Mode:** Transforms a wired network connection into a wireless one. Connect the repeater to your router via an Ethernet cable, and it will create a new Wi-Fi network.
- **Router Mode:** Functions as a primary router, creating a new private network. This mode is typically used when you have a modem but no router.

You can switch between these modes via the web browser setup interface.

## 6. OLED SCREEN INDICATORS

The intelligent OLED screen provides visual feedback on the device's status:

- **Wi-Fi Signal Icon:** Indicates the strength of the signal received from the main router. More bars mean a stronger signal.
- **Internet Globe Icon:** Shows internet connectivity status.
- **Mode Icon:** Displays the current operating mode (Repeater, AP, or Router).
- **Device Connection Icon:** Indicates if client devices are connected to the repeater.

Monitor the OLED screen to ensure optimal placement and operation of your repeater.

## 7. MAINTENANCE

To ensure the longevity and optimal performance of your NEWFAST AC1200 WiFi Repeater, follow these maintenance guidelines:

- **Cleaning:** Gently wipe the device with a soft, dry cloth. Do not use liquid cleaners or aerosols.
- **Ventilation:** Ensure the device's ventilation slots are not blocked to prevent overheating.
- **Placement:** Avoid placing the repeater in direct sunlight, near heat sources, or in excessively humid environments.
- **Firmware Updates:** Periodically check the manufacturer's website for firmware updates to improve performance and security.

## 8. TROUBLESHOOTING

If you encounter issues with your NEWFAST AC1200 WiFi Repeater, refer to the following common problems and solutions:

Problem	Solution
No power/OLED screen off	Ensure the repeater is securely plugged into a working electrical outlet. Try a different outlet.
Cannot connect to the repeater's Wi-Fi	Ensure the repeater is powered on. Check your device's Wi-Fi settings and try reconnecting. Reset the repeater if necessary.

Problem	Solution
No internet access after setup	Verify that your main router has internet access. Re-run the setup process, ensuring you enter the correct Wi-Fi password for your main router. Check the signal strength on the OLED screen; if it's weak, move the repeater closer to the router.
WPS setup failed	Ensure both WPS buttons are pressed within the two-minute window. Try the WPS process again. If it continues to fail, use the Web Browser Setup Method.
Slow Wi-Fi speed	Relocate the repeater to an optimal position, halfway between your router and the desired coverage area, where the OLED screen shows a strong signal. Minimize interference from other electronic devices.

If the problem persists, please contact NEWFAST customer support for further assistance.

## 9. SPECIFICATIONS

Brand	NEWFAST
Model	AC1200
Wireless Standard	IEEE 802.11 AC/A/B/G/N
Frequency Band	Dual Band (2.4GHz & 5GHz)
Wireless Speed	Up to 1200Mbps (867Mbps at 5GHz, 300Mbps at 2.4GHz)
Antennas	4 External Antennas
Ports	1 x RJ-45 Ethernet Port
Special Feature	OLED Screen Display
Color	Black

## 10. WARRANTY AND SUPPORT

Information regarding product warranty and specific support contact details is not available in this document. Please refer to the packaging or the official NEWFAST website for the most current warranty information and customer support options.

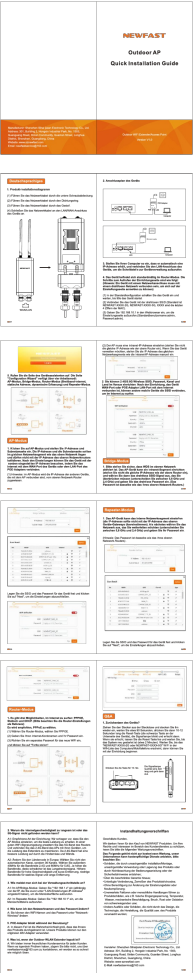

	<p><a href="#">NEWFAST Outdoor AP Quick Installation Guide - Setup and Configuration</a></p> <p>Comprehensive guide to installing and configuring the NEWFAST Outdoor AP (Access Point) and WiFi Extender, covering setup modes, network settings, and troubleshooting.</p>
	<p><a href="#">Quick Installation Guide for WiFi Extender/Repeater NF-RE513 V2</a></p> <p>A concise guide to installing and setting up the NF-RE513 V2 WiFi Extender/Repeater, including WPS installation and troubleshooting common issues.</p>
	<p><a href="#">NEWFAST NF-A882 Outdoor AP Quick Installation Guide</a></p> <p>A quick installation guide for the NEWFAST NF-A882 Outdoor WiFi Extender/Access Point, covering product installation, device connection, configuration modes (AP, Bridge, Router, Repeater), and troubleshooting.</p>
	<p><a href="#">NEWFAST Wireless Adapter Quick Installation Guide</a></p> <p>A quick installation guide for the NEWFAST Wireless Adapter, providing step-by-step instructions for setup and maintenance regulations.</p>



### [NF-RE523 Installation Manual by NEWFAST](#)

This document provides a comprehensive installation guide for the NEWFAST NF-RE523 device, including setup instructions, operational guidelines, safety precautions, and troubleshooting tips.



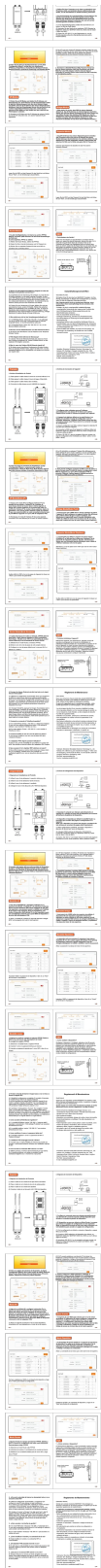

### [NEWFAST NF-A882 Installation Manual - Step-by-Step Guide](#)

Comprehensive installation manual for the NEWFAST NF-A882. Includes safety instructions, detailed setup steps, troubleshooting tips, and technical specifications.





